



Chipsmall Limited consists of a professional team with an average of over 10 year of expertise in the distribution of electronic components. Based in Hongkong, we have already established firm and mutual-benefit business relationships with customers from,Europe,America and south Asia,supplying obsolete and hard-to-find components to meet their specific needs.

With the principle of “Quality Parts,Customers Priority,Honest Operation,and Considerate Service”,our business mainly focus on the distribution of electronic components. Line cards we deal with include Microchip,ALPS,ROHM,Xilinx,Pulse,ON,Everlight and Freescale. Main products comprise IC,Modules,Potentiometer,IC Socket,Relay,Connector.Our parts cover such applications as commercial,industrial, and automotives areas.

We are looking forward to setting up business relationship with you and hope to provide you with the best service and solution. Let us make a better world for our industry!



Contact us

Tel: +86-755-8981 8866 Fax: +86-755-8427 6832

Email & Skype: info@chipsmall.com Web: www.chipsmall.com

Address: A1208, Overseas Decoration Building, #122 Zhenhua RD., Futian, Shenzhen, China



THIS DRAWING IS UNPUBLISHED. RELEASED FOR PUBLICATION
 © COPYRIGHT BY TYCO ELECTRONICS CORPORATION. ALL RIGHTS RESERVED.

LOC		DIST		REVISIONS			
P	LTR	DESCRIPTION	DATE	DWN	APVD		
	Z	REVISED PER ECO-07-010234	5/2/07	SS	GS		
	Z1	REVISED PER ECO-09-020935	09SEP09	KK	AEG		

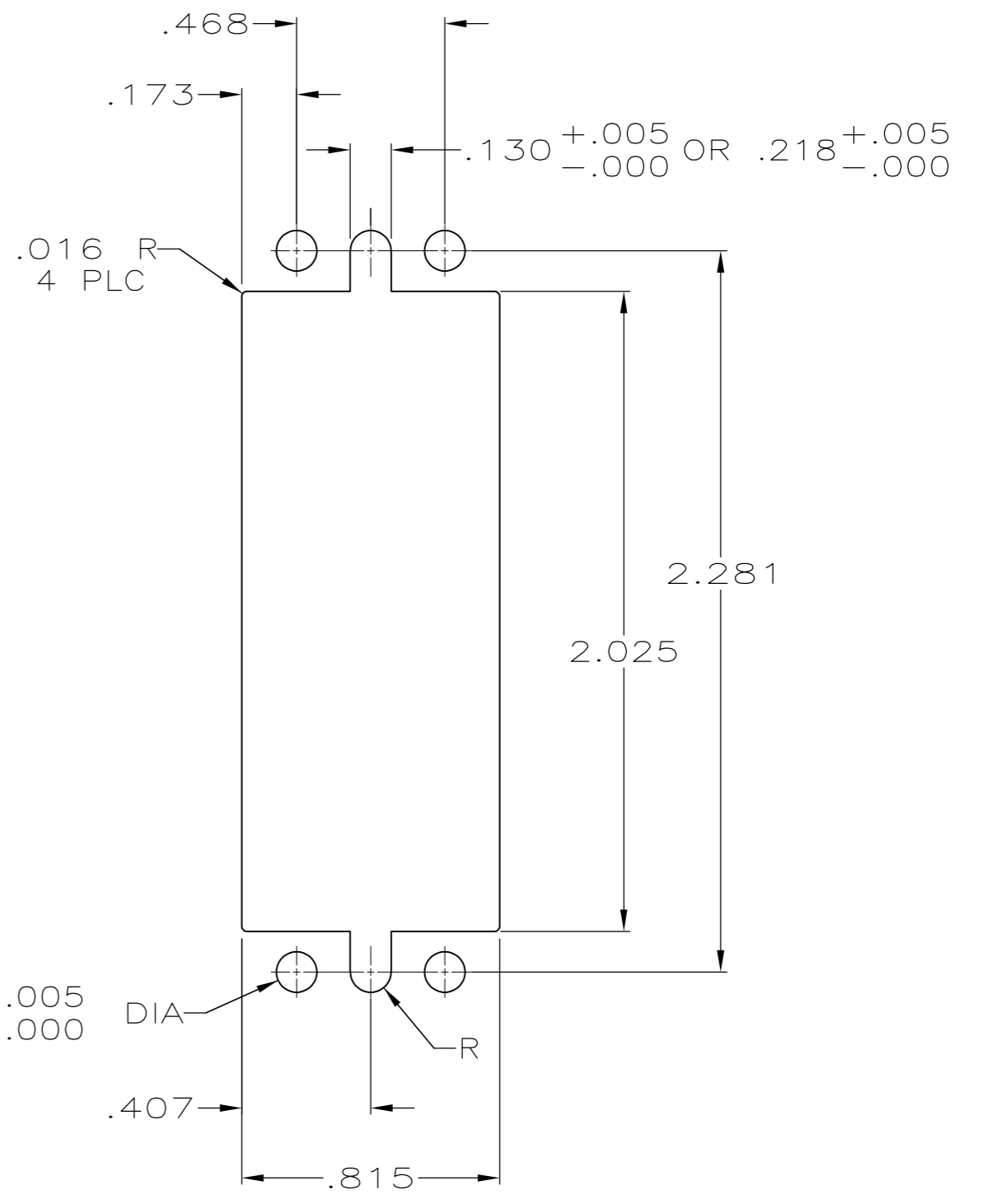
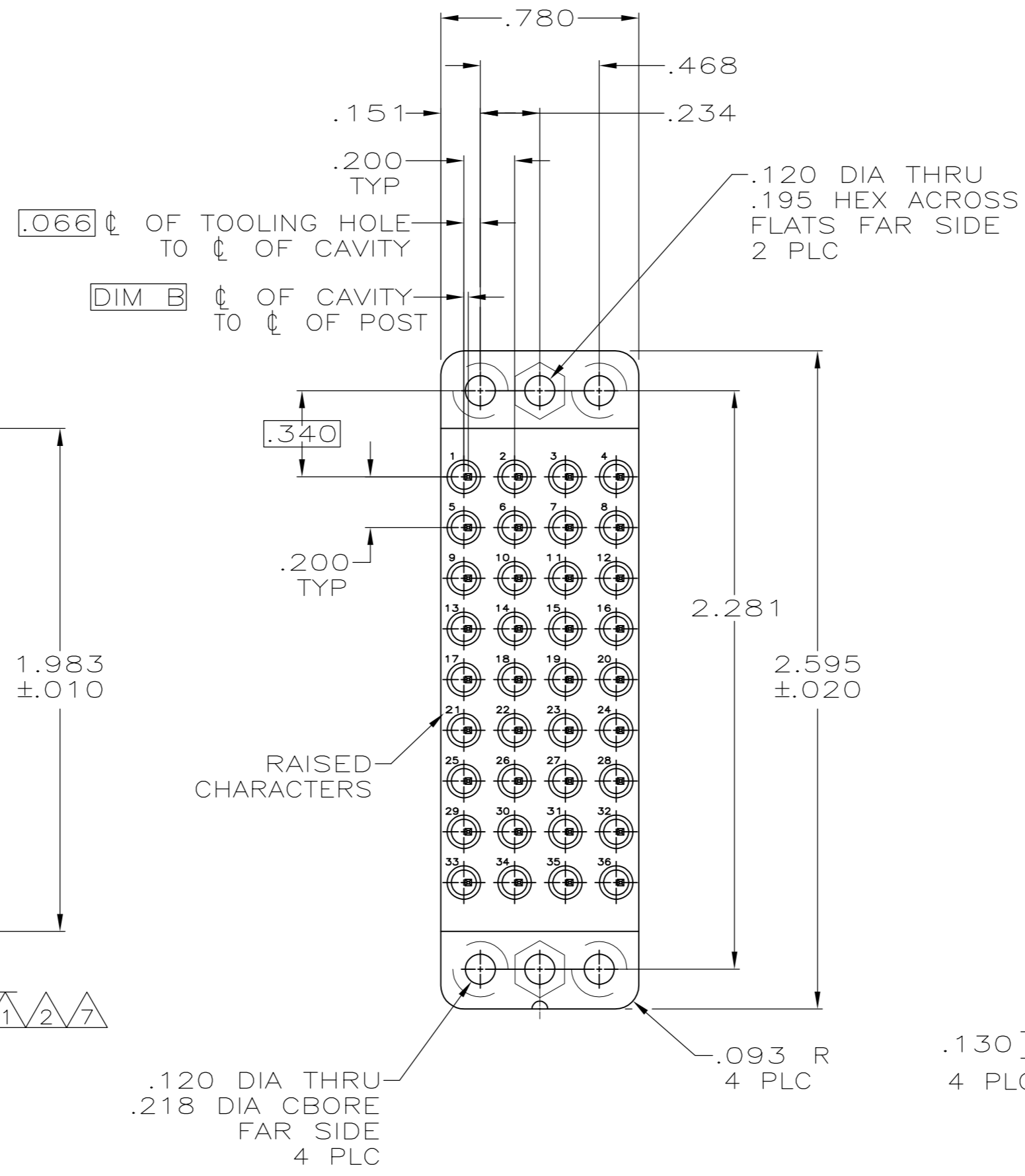
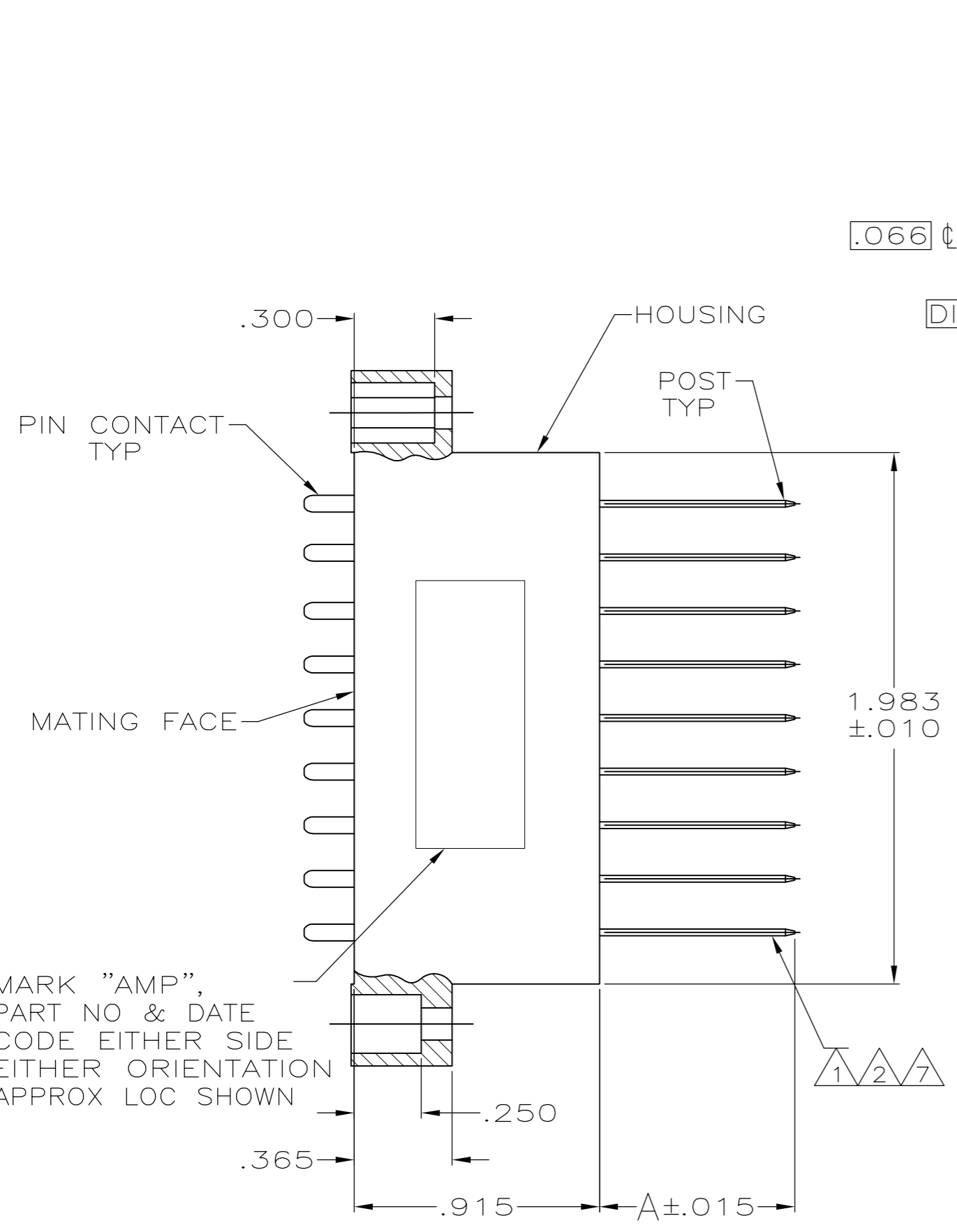

SUGGESTED PANEL CUTOUT

- 1 CONTACTS ARE AUTOMATICALLY WIREABLE.
- 2 POST LENGTH WILL ACCEPT 3 TERMINATIONS.
- 3. THE MAX WIRE TO BE USED WITH THIS CONNECTOR IS #24 AWG.
- 4 .000100 MIN TIN-LEAD OVER .000050 MIN NICKEL.
- 5 GOLD PLATED PER MIL-G-45204 OVER NICKEL PER QQ-N-290.
- 6 TIN-LEAD PLATED PER MIL-T-10727.
- 7 SELECTIVELY LOADED; POSITIONS 1 THRU 12, 17 THRU 20, AND 25 THRU 36, FOR 205629-2 ONLY.
- 8 .000100 MIN TIN OVER .000050 MIN NICKEL.
- 9 OBSOLETE PARTS: OBSOLETE CIS STREAMLINING PER D.RENAUD/D.SINISI

NOTES	POST PLATING	DIM B	DIM A	CONTACT FINISH	PART NUMBER	
9	-	8	.017	.659	5	1-205629-2
OBSOLETE	-	8	.017	.215	5	1-205629-1
	7	8	.000	.810	5	1-205629-0
	-	8	.000	.810	5	205629-9
OBSOLETE	-	-	.005	.810	6	205629-8
OBSOLETE	-	-	.017	.160	5	205629-7
9	-	4	.017	.659	5	205629-5
INACTIVATED	-	-	.000	.810	6	205629-4
	-	4	.017	.215	5	205629-3
9	-	4	.000	.810	5	205629-2
	-	4	.000	.810	5	205629-1

THIS DRAWING IS A CONTROLLED DOCUMENT.		DWN B. MOYER 04/24/91	Tyco Electronics Corporation Harrisburg, Pa 17105-3608	
DIMENSIONS: INCHES		CHK R. STONE 5-8-91	NAME	
TOLERANCES UNLESS OTHERWISE SPECIFIED:		APVD -	PRODUCT SPEC	
0 PLC ± -		APVD -	APPLICATION SPEC	
1 PLC ± -		WEIGHT -	SIZE A2	CAGE CODE 00779
2 PLC ± -		DRAWING NO C-205629		
3 PLC ± .005		RESTRICTED TO		
4 PLC ± -		SCALE 2:1 SHEET 1 OF 1 REV Z1		
ANGLES ± -		CUSTOMER DRAWING		
FINISH CONTACTS: SEE TABLE				
POSTS: SEE TABLE				