



Chipsmall Limited consists of a professional team with an average of over 10 year of expertise in the distribution of electronic components. Based in Hongkong, we have already established firm and mutual-benefit business relationships with customers from,Europe,America and south Asia,supplying obsolete and hard-to-find components to meet their specific needs.

With the principle of “Quality Parts,Customers Priority,Honest Operation,and Considerate Service”,our business mainly focus on the distribution of electronic components. Line cards we deal with include Microchip,ALPS,ROHM,Xilinx,Pulse,ON,Everlight and Freescale. Main products comprise IC,Modules,Potentiometer,IC Socket,Relay,Connector.Our parts cover such applications as commercial,industrial, and automotives areas.

We are looking forward to setting up business relationship with you and hope to provide you with the best service and solution. Let us make a better world for our industry!



Contact us

Tel: +86-755-8981 8866 Fax: +86-755-8427 6832

Email & Skype: info@chipsmall.com Web: www.chipsmall.com

Address: A1208, Overseas Decoration Building, #122 Zhenhua RD., Futian, Shenzhen, China





Features

- Size: 11.8 mm diameter, 17 mm length
- 100 kA surge rating
- High power handling
- Low leakage
- RoHS compliant*
-  UL Recognized

Applications

- Telecommunications equipment
- Industrial equipment/electronics

2063 Series High-Current 2-Electrode Gas Discharge Tube

Characteristics

Test Methods per ITU-T K.12 and IEC 61643-311.

| Characteristic | Model No. | | | | |
|-----------------------------------|-----------|---------|---------|---------|----------|
| | 2063-23 | 2063-25 | 2063-30 | 2063-35 | 2063-42 |
| DC Sparkover $\pm 20\%$ @ 100 V/s | 230 V | 250 V | 300 V | 350 V | 420 V |
| Impulse Sparkover ⁽¹⁾ | | | | | |
| 100 V/ μ s | < 600 V | < 600 V | < 700 V | < 800 V | < 900 V |
| 1000 V/ μ s | < 700 V | < 700 V | < 800 V | < 900 V | < 1000 V |

| Characteristic | Model No. | | | |
|-----------------------------------|-----------|----------|----------|----------|
| | 2063-47 | 2063-60 | 2063-70 | 2063-80 |
| DC Sparkover $\pm 20\%$ @ 100 V/s | 470 V | 600 V | 700 V | 800 V |
| Impulse Sparkover ⁽¹⁾ | | | | |
| 100 V/ μ s | < 900 V | < 1100 V | < 1200 V | < 1300 V |
| 1000 V/ μ s | < 1100 V | < 1300 V | < 1400 V | < 1500 V |

⁽¹⁾ Impulse Sparkover voltage is defined as typical values of distribution.

| | | |
|---|-------------------------|------------------|
| Insulation Resistance (IR) ⁽²⁾ | 100 / 250 Vdc | > 1 G Ω |
| Glow Voltage | 10 mA | ~ 70 V |
| Arc Voltage | 1 A | ~ 10 V |
| Glow-Arc Transition Current | | < 1 A |
| Maximum Capacitance | 1 MHz | < 10 pF |
| Maximum Impulse Discharge Current | 100,000 A, 8/20 μ s | 1 operation |
| | 60,000 A, 8/20 μ s | 5 operations |
| Nominal Alternating Discharge Current | 60 A, 50 Hz, 1 second | 1 operation |
| | 300 A, 9 cycles | 1 operation |
| Impulse Life | 500 A, 10/1000 μ s | > 400 operations |
| DC Holdover Voltage ⁽³⁾ | | < 150 ms |
| Operating Temperature | | -30 to +85 °C |
| Storage Temperature | | -40 to +115 °C |
| Climatic Category (IEC 60068-1) | | 40 / 90 / 21 |

Notes:

- UL Recognized component, UL File E313168.
- At delivery AQL 0.65, level II DIN ISO 2859

| | |
|-------------------------------------|----------------------|
| ⁽²⁾ DC Sparkover Voltage | IR Measuring Voltage |
| 230–400 V | 100 V |
| 420–800 V | 250 V |

| | |
|--------------------------------|---------------------|
| ⁽³⁾ Network Applied | DC Holdover Voltage |
| DC Sparkover Voltage | |
| 230–250 V | 135 V |
| 300–800 V | 150 V |

*RoHS Directive 2002/95/EC Jan. 27, 2003 including annex and RoHS Recast 2011/65/EU June 8, 2011.

Specifications are subject to change without notice.

The device characteristics and parameters in this data sheet can and do vary in different applications and actual device performance may vary over time. Users should verify actual device performance in their specific applications.

2063 Series High-Current 2-Electrode Gas Discharge Tube

BOURNS®

Product Dimensions

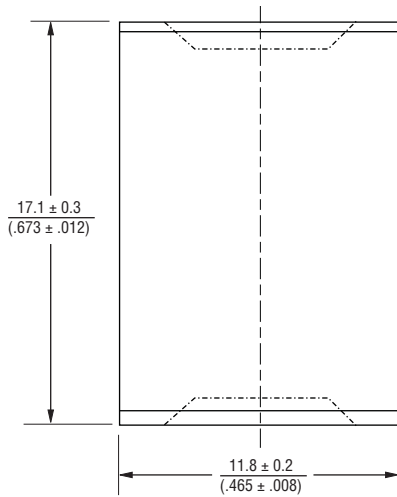

DIMENSIONS: $\frac{\text{MM}}{\text{(INCHES)}}$

How to Order

Model Number Designator **2063 - xx - A LF**

Voltage (Divided by 10)

| | |
|------------|------------|
| 23 = 230 V | 47 = 470 V |
| 25 = 250 V | 60 = 600 V |
| 30 = 300 V | 70 = 700 V |
| 35 = 350 V | 80 = 800 V |
| 42 = 420 V | |

Leads _____

A = No Leads

Packaging _____

(Blank) = Bulk Packaging - 35 pcs./tray (Standard)

RoHS Compliancy _____

LF = RoHS Compliant Product

Packaging Specifications

Model 2063 ships standard bulk, 35 pcs. per tray; 105 pcs. per box.

BOURNS®

Asia-Pacific: Tel: +886-2 2562-4117 • Fax: +886-2 2562-4116

EMEA: Tel: +36 88 520 390 • Fax: +36 88 520 211

The Americas: Tel: +1-951 781-5500 • Fax: +1-951 781-5700

www.bourns.com

REV. E 08/15

Specifications are subject to change without notice.
The device characteristics and parameters in this data sheet can and do vary in different applications and actual device performance may vary over time.
Users should verify actual device performance in their specific applications.