



Chipsmall Limited consists of a professional team with an average of over 10 year of expertise in the distribution of electronic components. Based in Hongkong, we have already established firm and mutual-benefit business relationships with customers from,Europe,America and south Asia,supplying obsolete and hard-to-find components to meet their specific needs.

With the principle of “Quality Parts,Customers Priority,Honest Operation,and Considerate Service”,our business mainly focus on the distribution of electronic components. Line cards we deal with include Microchip,ALPS,ROHM,Xilinx,Pulse,ON,Everlight and Freescale. Main products comprise IC,Modules,Potentiometer,IC Socket,Relay,Connector.Our parts cover such applications as commercial,industrial, and automotives areas.

We are looking forward to setting up business relationship with you and hope to provide you with the best service and solution. Let us make a better world for our industry!



Contact us

Tel: +86-755-8981 8866 Fax: +86-755-8427 6832

Email & Skype: info@chipsmall.com Web: www.chipsmall.com

Address: A1208, Overseas Decoration Building, #122 Zhenhua RD., Futian, Shenzhen, China



DRAWING MADE IN THIRD ANGLE PROJECTION



NO	LOC	QTY	REVISIONS				DATE	APPROVED
23	BD	39	P	F	LTR	DESCRIPTION		
			✓	✓	B	REDRAWN	4/23/91	-

THIS DRAWING IS UNPUBLISHED. RELEASED FOR PUBLICATION BY AMP INCORPORATED. ALL INTERNATIONAL RIGHTS RESERVED. © COPYRIGHT 19

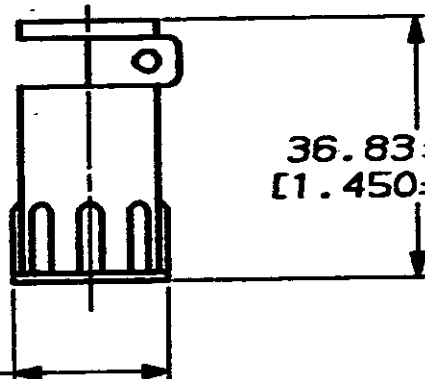
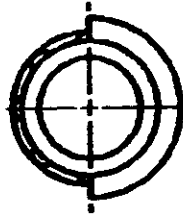

21.59 ± 0.64 DIA
[0.850 ± 0.025]

36.83 ± 0.76
[1.450 ± 0.030]

206357-1

PART NO

DO NOT SCALE PRINT.
UNLESS SPECIFIED
DIMENSIONS IN IN (IN)
TOLERANCES ON:
2 PLC DEC ± -
19 PLC DEC ± -
ANGLES ± -

MATERIAL
THERMOPLASTIC
BLACK

FINISH
-

DR 4/23/91	A. GRAY
CHK 3-4-92	B. LINDEN
APPD 3-4-92	K. BEASER
APPD 3-4-92	C. ROSE
PRODUCT SPEC	-
APPLICATION SPEC	-
WEIGHT	-

AMP

AMP Incorporated
Harrisburg, PA 17105-3608

NAME
CABLE CLAMP BODY,
LARGE, SHELL SIZE 11, CPC

SIZE A	CAGE CODE 00779	DRAWING NO 206357
SCALE 1:1	SHEET 1 of 1	

CUSTOMER DRAWING