



Chipsmall Limited consists of a professional team with an average of over 10 year of expertise in the distribution of electronic components. Based in Hongkong, we have already established firm and mutual-benefit business relationships with customers from,Europe,America and south Asia,supplying obsolete and hard-to-find components to meet their specific needs.

With the principle of "Quality Parts,Customers Priority,Honest Operation,and Considerate Service",our business mainly focus on the distribution of electronic components. Line cards we deal with include Microchip,ALPS,ROHM,Xilinx,Pulse,ON,Everlight and Freescale. Main products comprise IC,Modules,Potentiometer,IC Socket,Relay,Connector.Our parts cover such applications as commercial,industrial, and automotives areas.

We are looking forward to setting up business relationship with you and hope to provide you with the best service and solution. Let us make a better world for our industry!



Contact us

Tel: +86-755-8981 8866 Fax: +86-755-8427 6832

Email & Skype: info@chipsmall.com Web: www.chipsmall.com

Address: A1208, Overseas Decoration Building, #122 Zhenhua RD., Futian, Shenzhen, China



DESCRIPTION: 2MM RECEPTACLES

"L" = NO. OF CONTACTS PER ROW X .079

MATERIAL:
 HOUSING: GLASS FILLED
 THERMOPLASTIC UL 94V-0
 COLOR: BLACK
 CONTACT: PHOSPHOR BRONZE ALLOY 521
 RoHS COMPLIANT

ELECTRICAL:
 CURRENT RATING: 1 AMP
 CONTACT RESISTANCE: 2 mOHM MAX.
 DWV: 1000 Vrms/MIN.
 OPERATING TEMP:
 -55°C TO +125°C

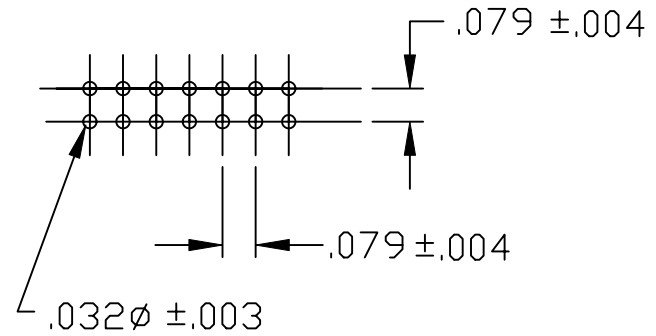
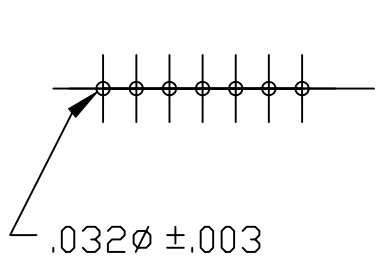
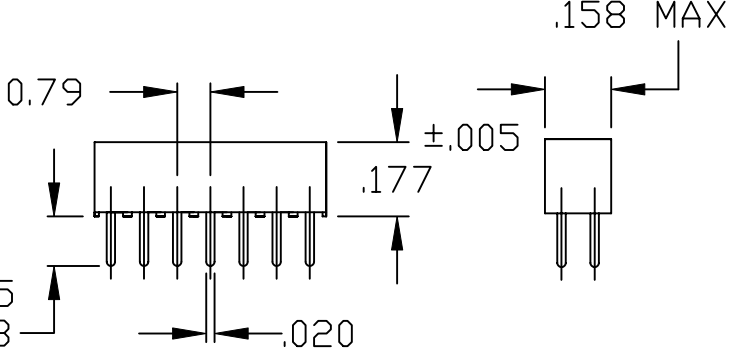
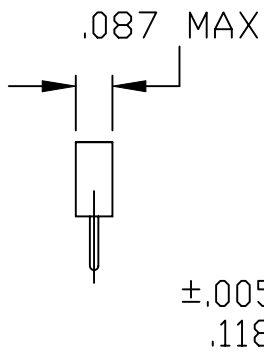
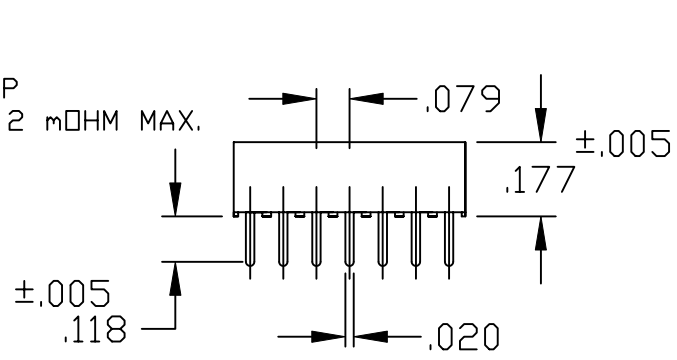
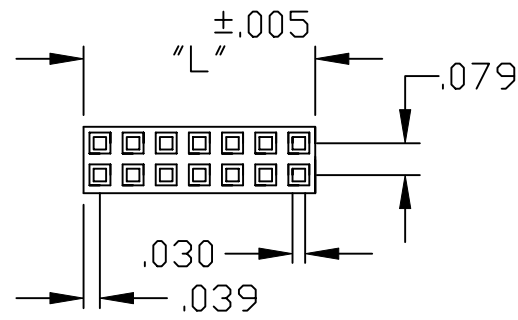
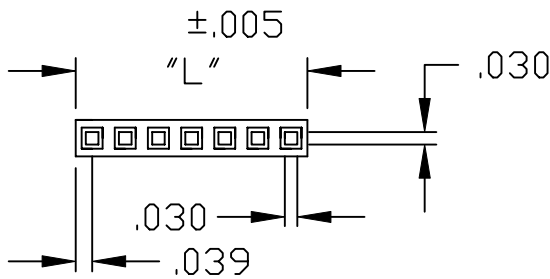

SERIES 206X - XX-01RPX
 2063 = SINGLE ROW
 2064 = DUAL ROW
POSITIONS
 SINGLE - INCREMENTS OF 1
 DUAL = INCREMENTS OF 2
TYPE:
 01 = STRAIGHT
PLATING:
 P2 = 15 u" GOLD MATING AREA,
 100U" MIN. MATTE TIN ON TAILS

	THESE DRAWINGS AND SPECIFICATIONS ARE THE PROPERTY OF NorComp AND SHALL NOT BE REPRODUCED, COPIED OR USED AS THE BASIS FOR THE MANUFACTURE OF APPARATUS WITHOUT WRITTEN PERMISSION.		DRAWN: PAM JENKINS	DATE: 7-28-05
	<h1>NorComp</h1>		CHECKED:	DATE:
SCALE:			SHEET 1 OF 1	REV 1
DWG NO. 206X-XX-01RPX				