



Chipsmall Limited consists of a professional team with an average of over 10 year of expertise in the distribution of electronic components. Based in Hongkong, we have already established firm and mutual-benefit business relationships with customers from,Europe,America and south Asia,supplying obsolete and hard-to-find components to meet their specific needs.

With the principle of "Quality Parts,Customers Priority,Honest Operation,and Considerate Service",our business mainly focus on the distribution of electronic components. Line cards we deal with include Microchip,ALPS,ROHM,Xilinx,Pulse,ON,Everlight and Freescale. Main products comprise IC,Modules,Potentiometer,IC Socket,Relay,Connector.Our parts cover such applications as commercial,industrial, and automotives areas.

We are looking forward to setting up business relationship with you and hope to provide you with the best service and solution. Let us make a better world for our industry!



Contact us

Tel: +86-755-8981 8866 Fax: +86-755-8427 6832

Email & Skype: info@chipsmall.com Web: www.chipsmall.com

Address: A1208, Overseas Decoration Building, #122 Zhenhua RD., Futian, Shenzhen, China



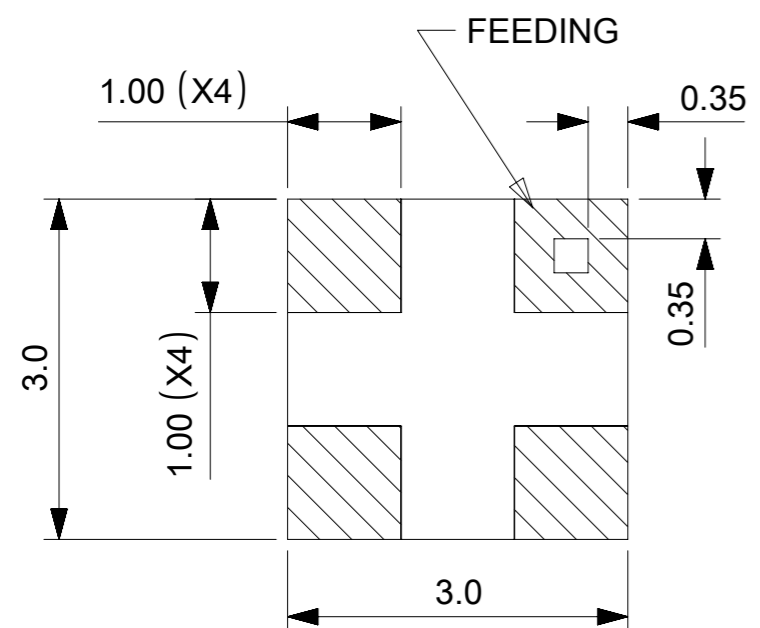
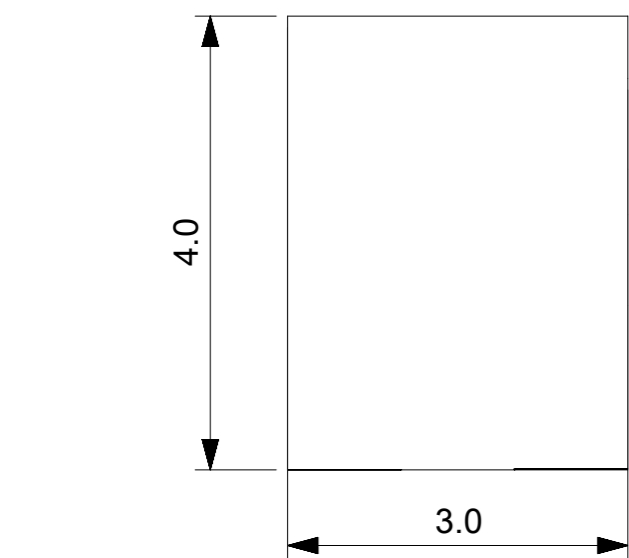

PADS OF PRODUCT FOR SOLDER

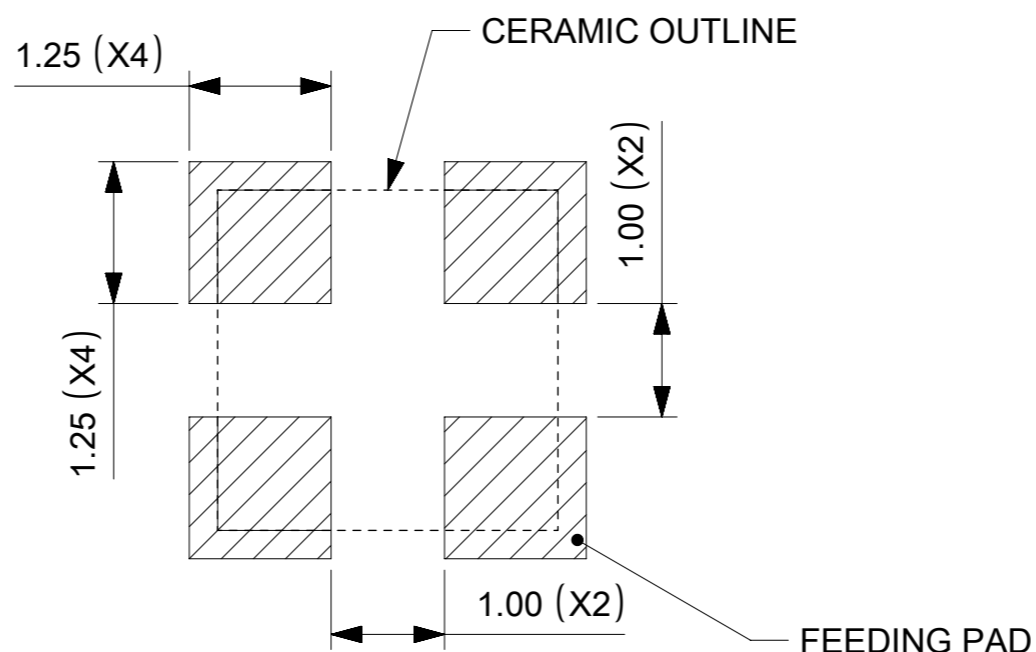

RECOMMENDED PCB LAYOUT

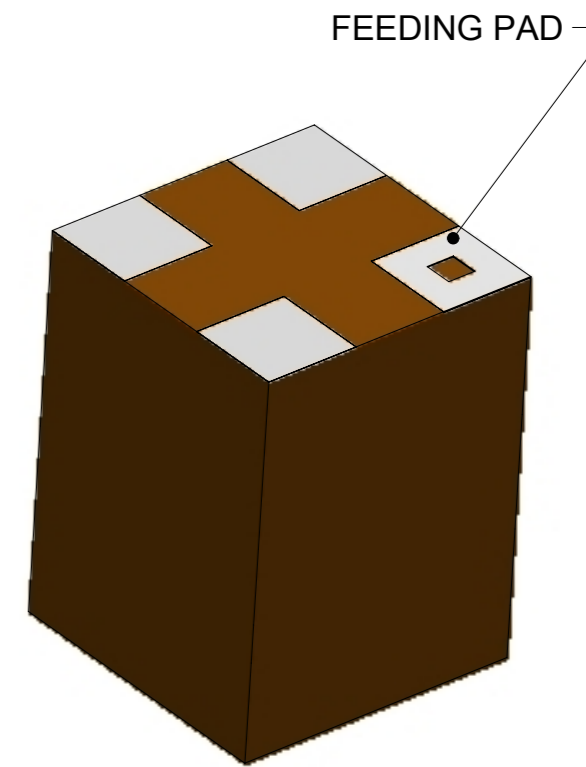

3D VIEW

NOTE:

1. BODY MATERIAL: CERAMIC.
2. PLATING THICKNESS: Ag THICKNESS 4~12um.
3. GENERAL COSMETIC APPEARANCE AS DEFINED BY MOLEX COSMETIC SPECIFICATION.
4. PACKAGE SPEC REFER TO PK OF 2065130001
5. PRODUCT SPEC REFER TO PS OF 2065130001
6. APPLICATION SPEC REFER TO AS OF 2065130001

THIS DRAWING CONTAINS INFORMATION THAT IS PROPRIETARY TO MOLEX ELECTRONIC TECHNOLOGIES, LLC AND SHOULD NOT BE USED WITHOUT WRITTEN PERMISSION															
SYMBOLS		DIMENSION UNITS		SCALE		CURRENT REV DESC:									
▽ = 0		mm		10 : 1		EC NO: 174874									
▽ = 0		GENERAL TOLERANCES (UNLESS SPECIFIED)						DRWN: KCHENG06 2018/02/07							
▽ = 0		ANGULAR TOL ± 0.5°						CHK'D: KCHENG06 2018/04/17							
▽ = 0		4 PLACES ± 0.03						APPR: XJSONG 2018/04/18							
▽ = 0		3 PLACES ± 0.1						INITIAL REVISION:							
▽ = 0		2 PLACES ± 0.2						DRWN: KCHENG06 2018/02/07							
▽ = 0		1 PLACE ± 0.3						APPR: XJSONG 2018/04/18							
▽ = 0		0 PLACES ± 0.5						DOCUMENT NUMBER		DOC TYPE		DOC PART		REVISION	
□ = 0		DRAFT WHERE APPLICABLE MUST REMAIN WITHIN DIMENSIONS						2065130001		PSD		SD		A	
▽ = 0		THIRD ANGLE PROJECTION		DRAWING		SERIES		MATERIAL NUMBER		CUSTOMER		SHEET NUMBER			
		A3-SIZE		206513		2065130001		GENERAL MARKET		1 OF 1					