



Chipsmall Limited consists of a professional team with an average of over 10 year of expertise in the distribution of electronic components. Based in Hongkong, we have already established firm and mutual-benefit business relationships with customers from,Europe,America and south Asia,supplying obsolete and hard-to-find components to meet their specific needs.

With the principle of “Quality Parts,Customers Priority,Honest Operation,and Considerate Service”,our business mainly focus on the distribution of electronic components. Line cards we deal with include Microchip,ALPS,ROHM,Xilinx,Pulse,ON,Everlight and Freescale. Main products comprise IC,Modules,Potentiometer,IC Socket,Relay,Connector.Our parts cover such applications as commercial,industrial, and automotives areas.

We are looking forward to setting up business relationship with you and hope to provide you with the best service and solution. Let us make a better world for our industry!



Contact us

Tel: +86-755-8981 8866 Fax: +86-755-8427 6832

Email & Skype: info@chipsmall.com Web: www.chipsmall.com

Address: A1208, Overseas Decoration Building, #122 Zhenhua RD., Futian, Shenzhen, China



LOC	DIST	REVISIONS					
GP	00	P	LTN	DESCRIPTION	DATE	DWN	APVD
		E		PER ECR-12-015568	03SEP2012	DZ	JY
		F		RELEASED PER ECO-13-010325	19JUN2013	RG	AC
		F1		REVISED PER ECR-15-013279	8SEP2015	RG	SH
		F2		REVISED PER ECO-16-013640	9SEP2016	RG	SH

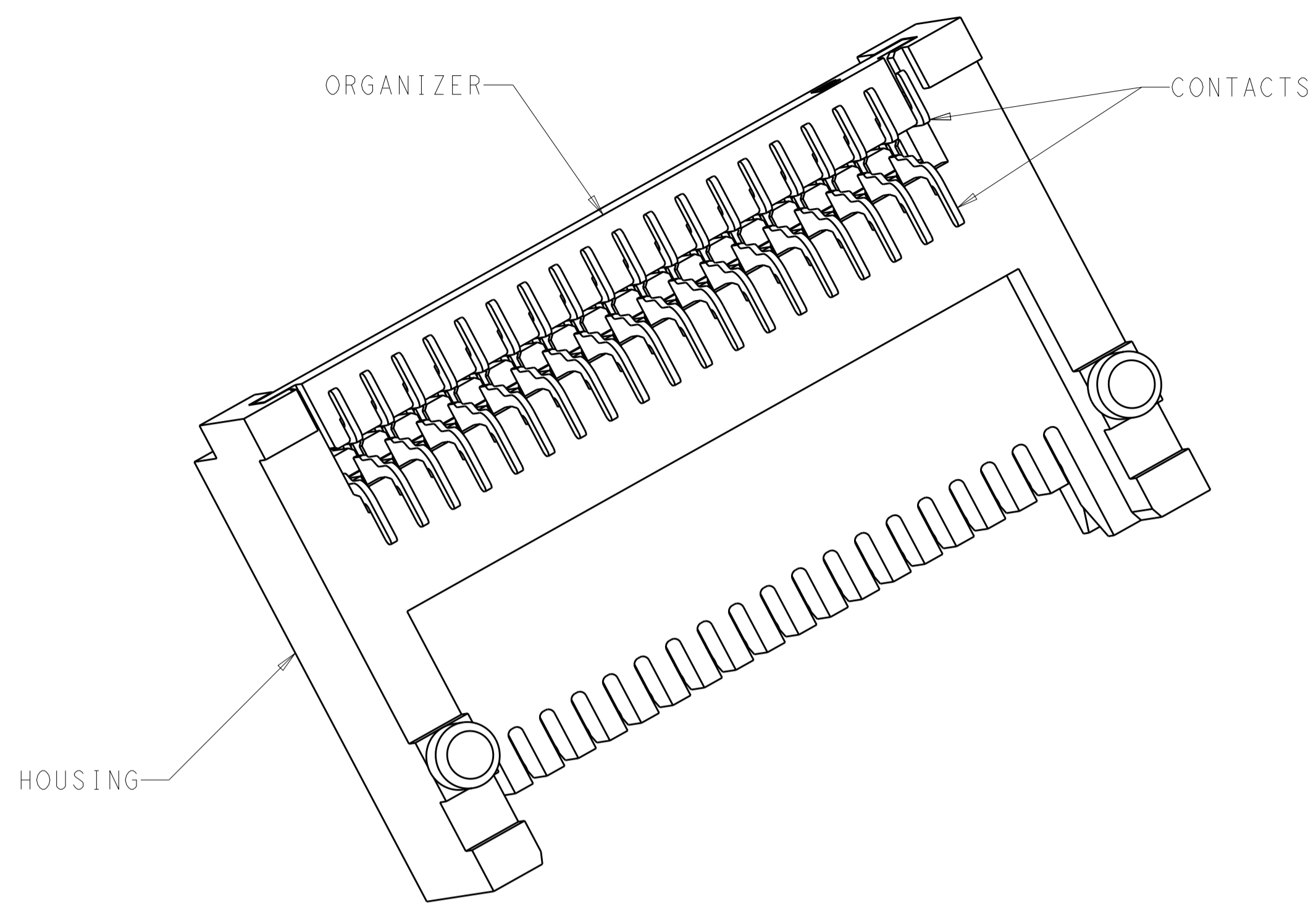

- ⚠ MATERIAL: HOUSING AND ORGANIZER: LCP, UL94V-0 RATED, BLACK.
 CONTACTS: COPPER ALLOY, 0.15 THICK.
- ⚠ FINISH: CONTACTS: CONFORMS TO THE REQUIREMENTS OF TYCO ELECTRONICS PRODUCT SPECIFICATION 108-2425, BASED ON EIA/ECA-364-1000.01A, (CONTROLLED ENVIRONMENT APPLICATIONS) ON MATING INTERFACE.
 TIN ON SOLDER TAILS
- 3. MATES WITH SFF-8436 COMPLIANT MODULES.
- ⚠ DATUM AND BASIC DIMENSION ESTABLISHED BY CUSTOMER.
- 5. DATUM R IS THE TOP SURFACE OF THE HOST PC BOARD.

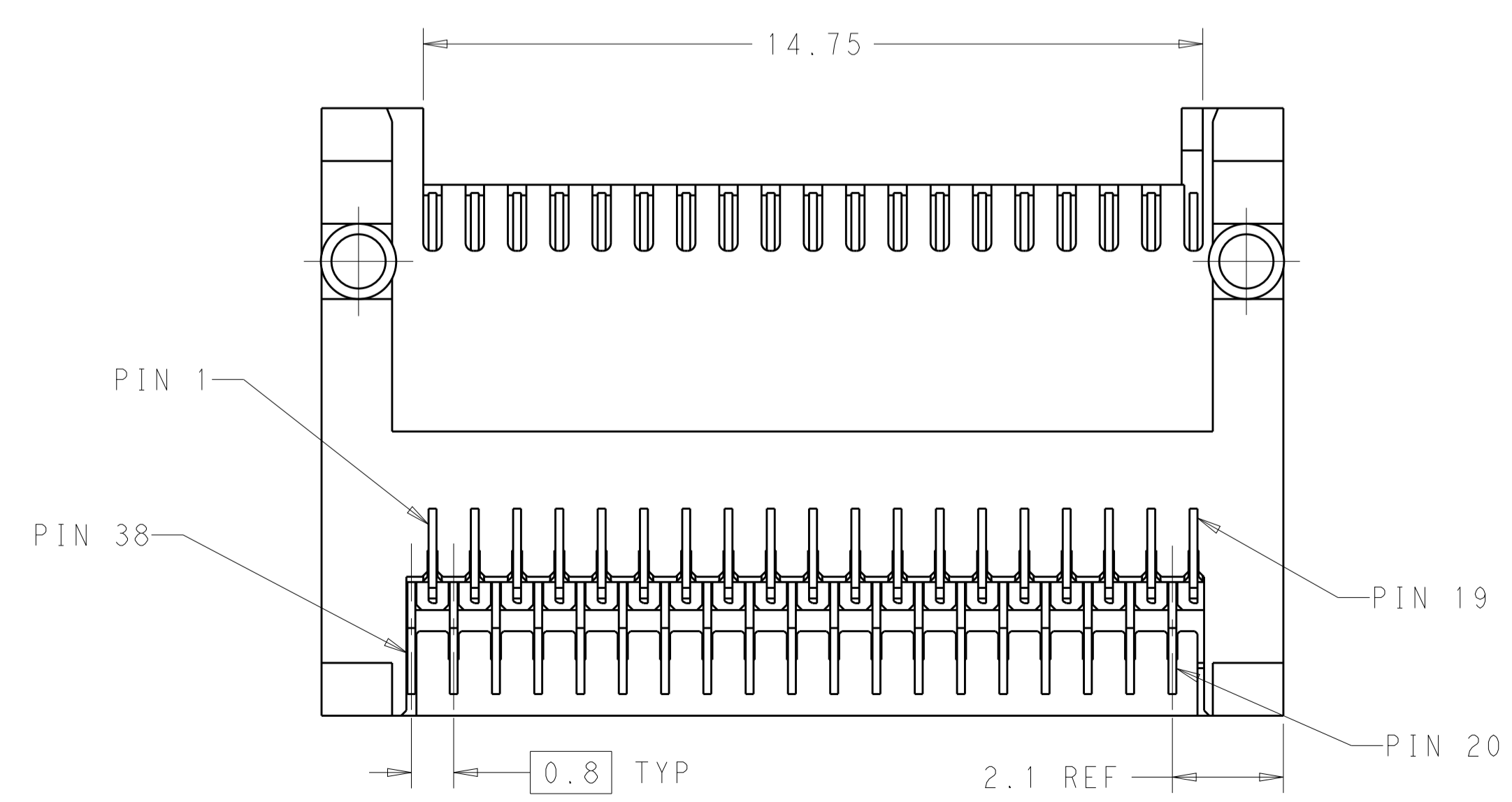
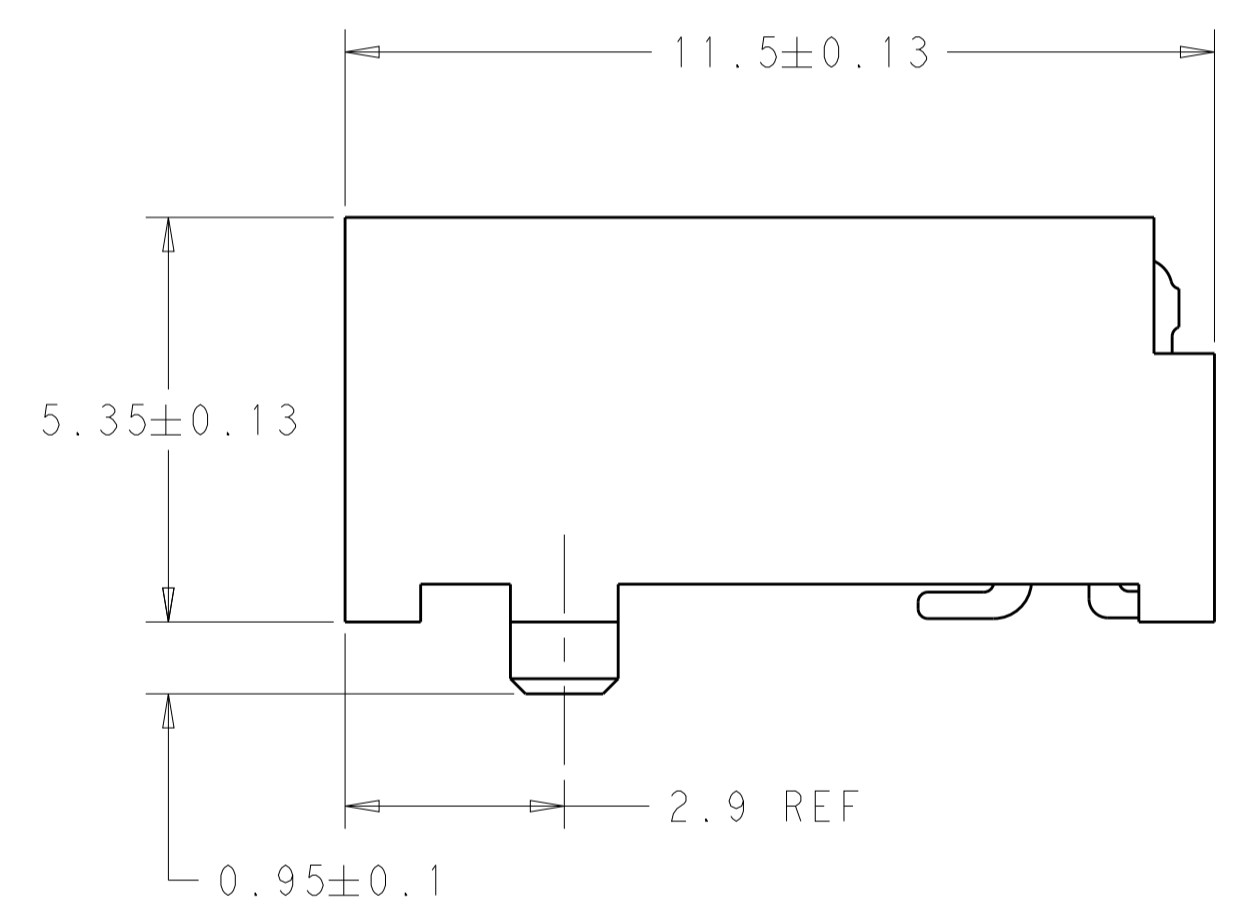
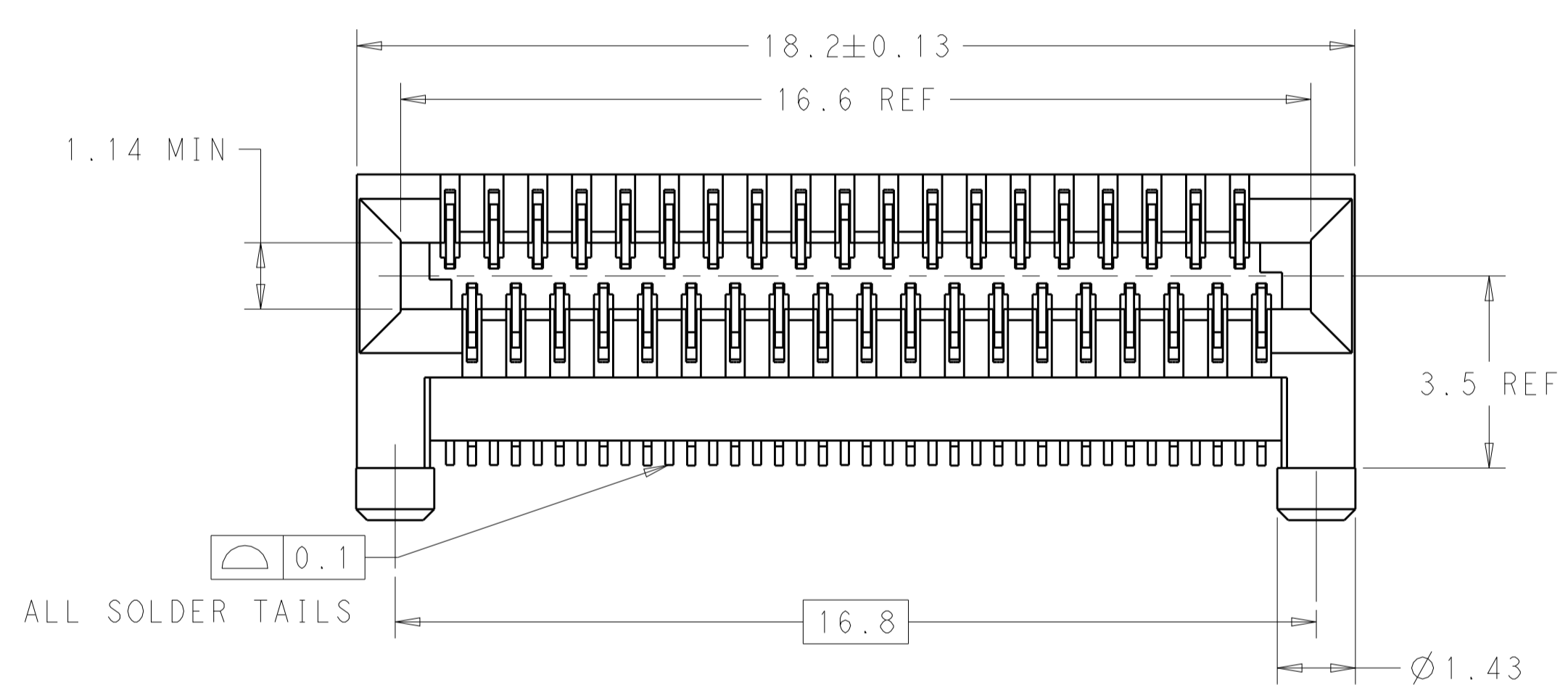

CARRIER TAPE WIDTH 32mm, PITCH 16mm	⚠	2110819-4
CARRIER TAPE WIDTH 32mm, PITCH 20mm	⚠	2110819-1
PACKAGE SPECIFICATION	FINISH	PART NUMBER

THIS DRAWING IS A CONTROLLED DOCUMENT.

DWN: C. VALENTINI 27OCT2009
 CHK: J. PETERSON 27OCT2009
 APVD: J. PETERSON 27OCT2009

TE Connectivity

NAME: QSFP+ ENHANCED EVERCLEAR, PT CONNECTOR, RIGHT ANGLE

PRODUCT SPEC: 108-2425
 APPLICATION SPEC: 114-13221

SIZE: A1
 CAGE CODE: 00779
 DRAWING NO: 2110819

RESTRICTED TO: -

MATERIAL: ⚠
 FINISH: ⚠

Customer Drawing

SCALE: 10:1 SHEET 1 OF 2 REV: F2

LOC	DIST	REVISIONS			
P	LTN	DESCRIPTION	DATE	DWN	APVD
-	-	SEE SHEET 1	-	-	-

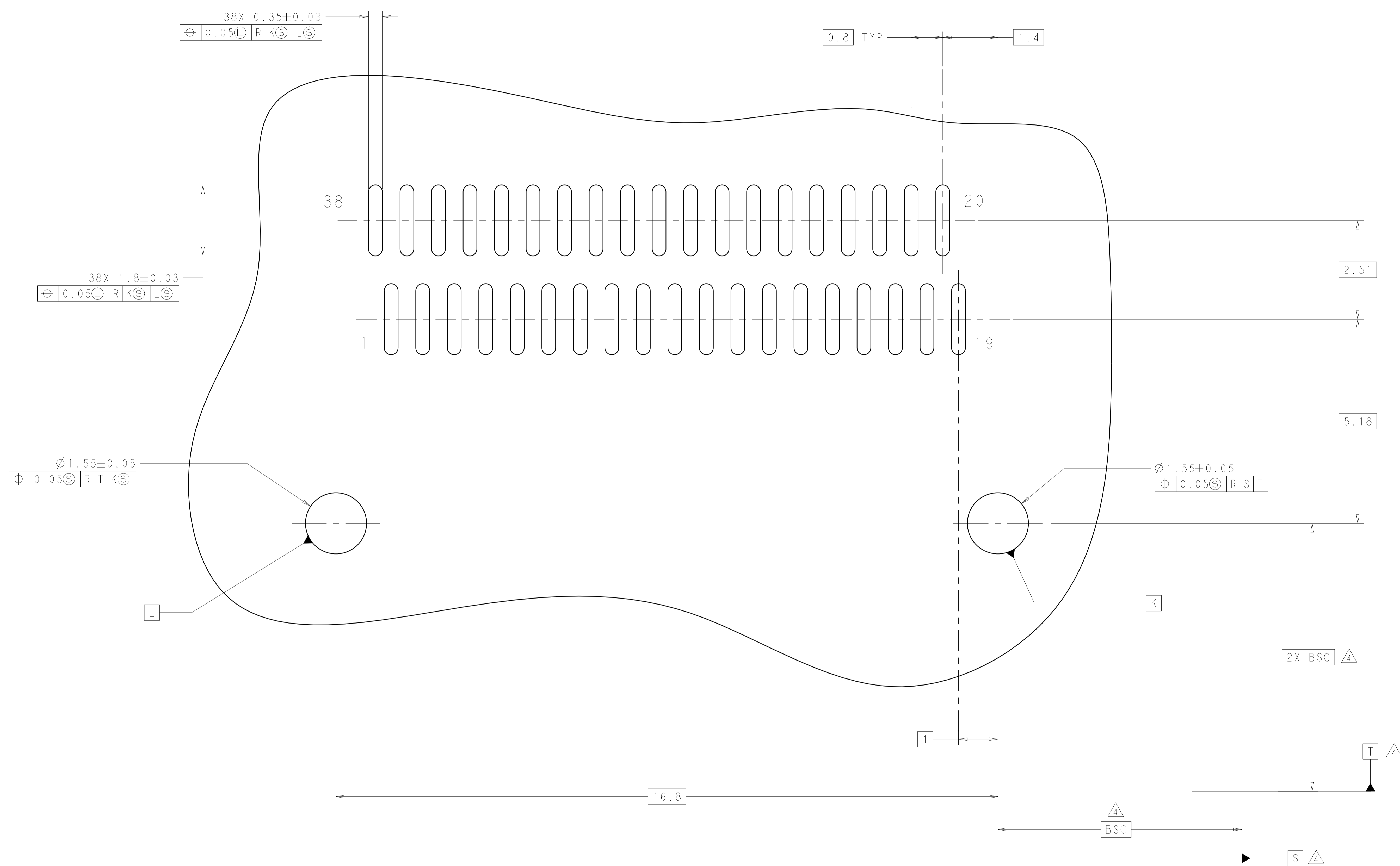

SCALE 20:1

THIS DRAWING IS A CONTROLLED DOCUMENT.		DWN C. VALENTINI 2/OCT2009	TE Connectivity
DIMENSIONS: mm		CHK J. PETERSON 2/OCT2009	
TOLERANCES UNLESS OTHERWISE SPECIFIED:		APVD J. PETERSON 2/OCT2009	NAME OSFP+ ENHANCED EVERCLEAR, PT CONNECTOR, RIGHT ANGLE PRODUCT SPEC 108-2425 APPLICATION SPEC 114-13221 WEIGHT - Customer Drawing
0 PLC ±0.1		SIZE A1	
1 PLC ±0.1		CAGE CODE 00779	
2 PLC ±0.1		DRAWING NO. 2110819	
3 PLC ±0.1		RESTRICTED TO	SCALE 10:1
4 PLC ±0.1		REVISIONS	SHEET 2 OF 2
ANGLES ±0.1		REV F2	
FINISH			