



Chipsmall Limited consists of a professional team with an average of over 10 year of expertise in the distribution of electronic components. Based in Hongkong, we have already established firm and mutual-benefit business relationships with customers from,Europe,America and south Asia,supplying obsolete and hard-to-find components to meet their specific needs.

With the principle of "Quality Parts,Customers Priority,Honest Operation,and Considerate Service",our business mainly focus on the distribution of electronic components. Line cards we deal with include Microchip,ALPS,ROHM,Xilinx,Pulse,ON,Everlight and Freescale. Main products comprise IC,Modules,Potentiometer,IC Socket,Relay,Connector.Our parts cover such applications as commercial,industrial, and automotives areas.

We are looking forward to setting up business relationship with you and hope to provide you with the best service and solution. Let us make a better world for our industry!



Contact us

Tel: +86-755-8981 8866 Fax: +86-755-8427 6832

Email & Skype: info@chipsmall.com Web: www.chipsmall.com

Address: A1208, Overseas Decoration Building, #122 Zhenhua RD., Futian, Shenzhen, China



DRAWING MADE IN THIRD ANGLE PROJECTION
 THIS DRAWING IS UNPUBLISHED. RELEASED FOR PUBLICATION BY AMP INCORPORATED. ALL INTERNATIONAL RIGHTS RESERVED.
 OPERATOR 19

NO	REV	DATE	DESCRIPTION	APPROVED
1	BD 39		REDRAIN AND REV EGN B05024	A

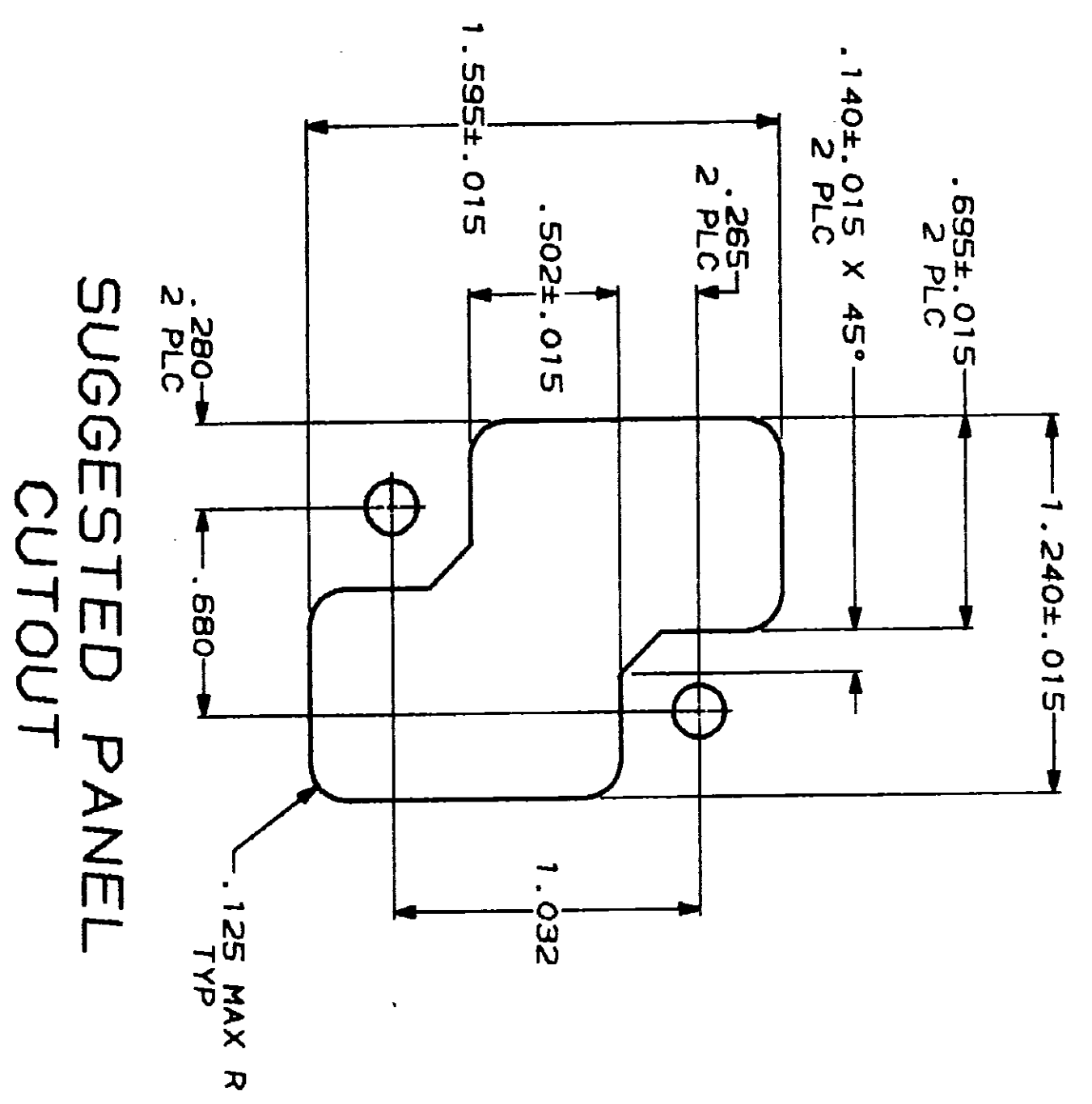
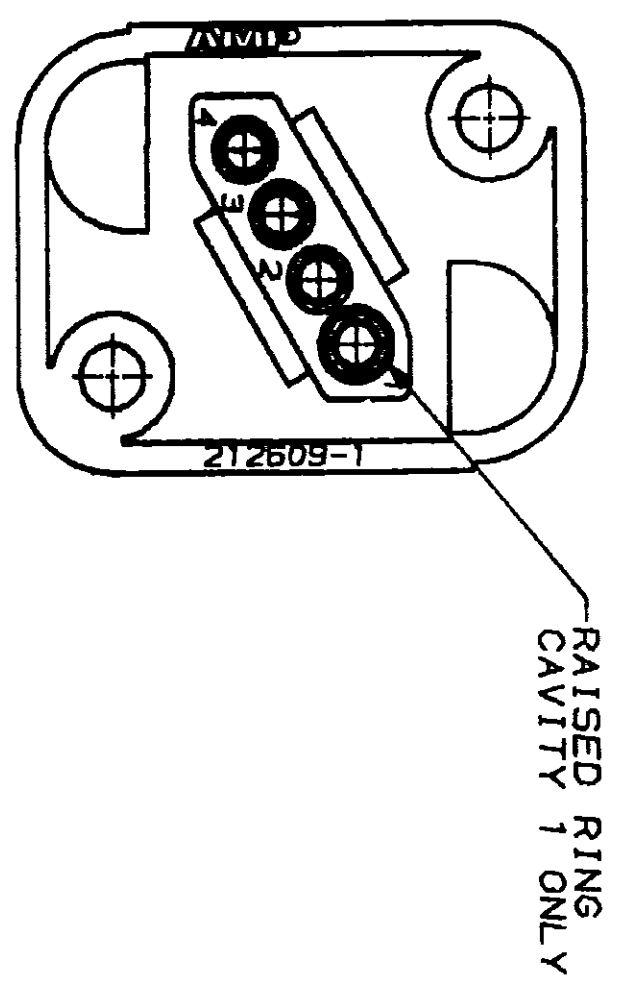
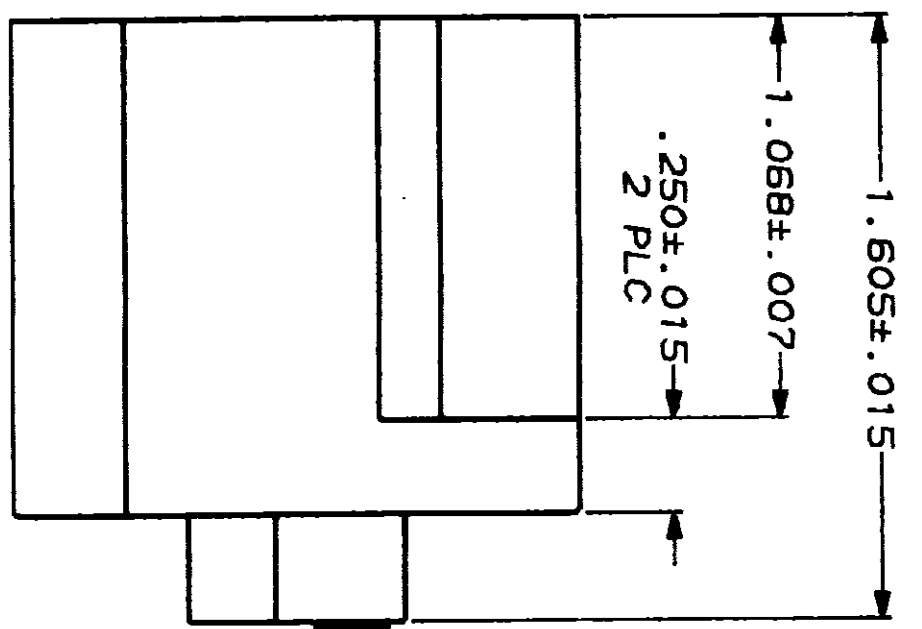
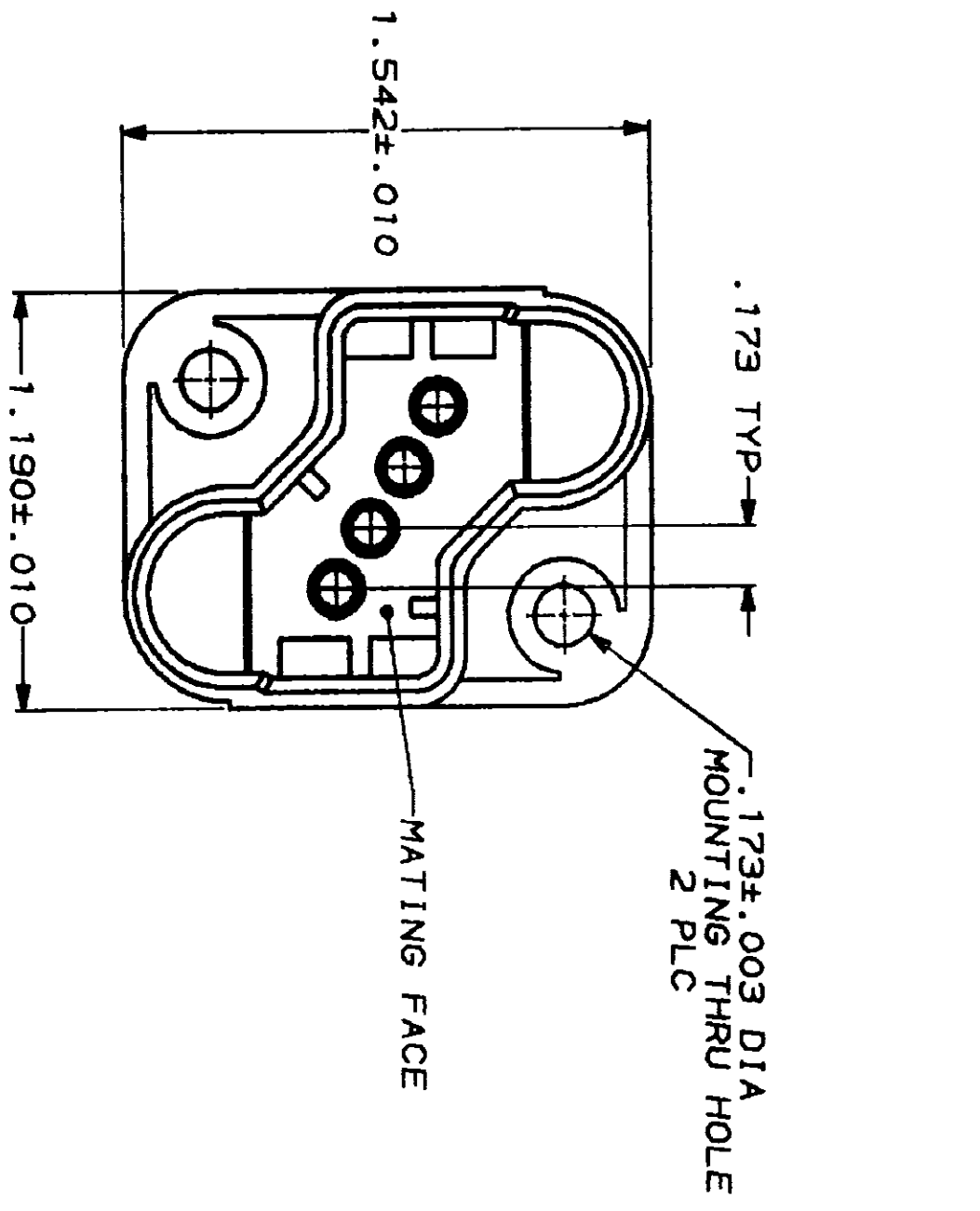

1. THIS CONNECTOR MATES WITH SOCKET HOUSING DRAWING NUMBER 212608.
2. CAVITIES 1 AND 4 SHOULD NOT BE USED WITH GROUND PIN.

DO NOT SCALE PRINT. DIMENSIONS SPECIFIED IN INCHES TOLERANCES ON: 2 PLC DEC ± .005 3 PLC DEC ± .010 ANGLES ± 1° MATERIAL THERMOPLASTIC BLACK FINISH		DR 05/07/91 R. SHINEY 5-13-91 APPD A. TRAVIS 5/14/91 APPD T. SHINEY PRODUCT SPEC APPLICATION SPEC WEIGHT		AMP AMP Incorporated Harrisburg, PA 17105-3608 NAME RECEPTACLE HOUSING, DRAWER CONNECTOR, 4 POSN, METRIMATE SIZE CAGE CODE DRAWING NO 00779 212609 SCALE 2:1 SHEET 1 OF 1	
--	--	---	--	--	--

212609-1
 PART NO

212609

CUSTOMER DRAWING

07 MAY 1991 15:35:34 AMPTRAC2 C:\R02501\02304\METRIMATE