



Chipsmall Limited consists of a professional team with an average of over 10 year of expertise in the distribution of electronic components. Based in Hongkong, we have already established firm and mutual-benefit business relationships with customers from,Europe,America and south Asia,supplying obsolete and hard-to-find components to meet their specific needs.

With the principle of “Quality Parts,Customers Priority,Honest Operation,and Considerate Service”,our business mainly focus on the distribution of electronic components. Line cards we deal with include Microchip,ALPS,ROHM,Xilinx,Pulse,ON,Everlight and Freescale. Main products comprise IC,Modules,Potentiometer,IC Socket,Relay,Connector.Our parts cover such applications as commercial,industrial, and automotives areas.

We are looking forward to setting up business relationship with you and hope to provide you with the best service and solution. Let us make a better world for our industry!



## Contact us

Tel: +86-755-8981 8866 Fax: +86-755-8427 6832

Email & Skype: info@chipsmall.com Web: www.chipsmall.com

Address: A1208, Overseas Decoration Building, #122 Zhenhua RD., Futian, Shenzhen, China



THIS DRAWING IS UNPUBLISHED. RELEASED FOR PUBLICATION ,19 .  
 © COPYRIGHT 19 BY AMP INCORPORATED, HARRISBURG, PA. ALL INTERNATIONAL RIGHTS RESERVED. AMP PRODUCTS MAY BE COVERED BY U.S. AND FOREIGN PATENTS AND/OR PATENTS PENDING.

LOC DIST  
 GP 00

		REVISIONS				
P	F	ZONE	LTR	DESCRIPTION	DATE	APPROVED
			C	REVISED & REDRAWN AF-2227	10-2-86	JRGY
			D	REVISED PER AF-3539	3/2/87	JRGY
			E	REV PER AF-4722	5/12/87	JRGY
			F	REV PER AF-4684	6/30/87	DH
			G	OBSOLETE -2 ECN BD6064	04/01/92	BF
			H	OBS -3 PER EC 0020-1416-94	11/28/94	AT
			J	REACTIVATED -3 PER EC 0020-142-95	02/14/95	GS
			K	REV PER EC 0320-90-96	23 OCT 96	GS
			L	REV PER EC 0513-0403-04	21 MAR 05	JR

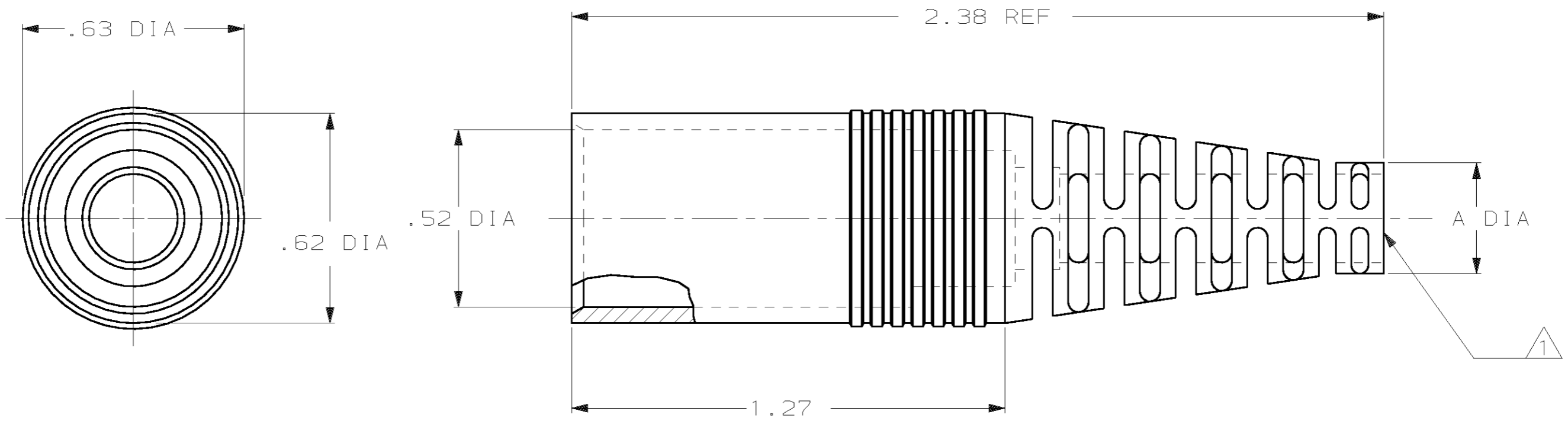

	.37	GRAY	2	212800-4
OBSOLETE	.37	BLACK	2	212800-3
OBSOLETE	.31	GRAY	1	212800-2
	.31	BLACK	1	212800-1
	A DIA	COLOR		PART NO

- 1 INSIDE DIA TO ACCEPT .190/.250 DIA CABLE.
- 2 INSIDE DIA TO ACCEPT .250/.300 DIA CABLE.
- 3 USED WITH ONE PIECE SHIELDED DIN PLUG CONNECTORS.

UNLESS OTHERWISE SPECIFIED DIMENSIONS ARE IN INCHES TOLERANCES ON: 2 PL DEC ± .02 3 PL DEC ± - ANGLES ± -	DR 10-02-86 L.R.RUTH	AMP INCORPORATED Harrisburg, Pa. 17105		
	CHK 10-02-86 G.YETTER			
MATERIAL POLYETHER-ESTER ELASTOMER	APPD 10-02-86 M.VISELLI	NAME CIRCULAR DIN, CORD GUARD		
FINISH -	APPD 10-02-86 C.ROHDE	SIZE B	FSCM NO 00779	DRAWING NO 212800
	PRODUCT SPEC -	SCALE NTS	SHEET 1 OF 1	
	APPLICATION SPEC -			
	WEIGHT -			