



Chipsmall Limited consists of a professional team with an average of over 10 year of expertise in the distribution of electronic components. Based in Hongkong, we have already established firm and mutual-benefit business relationships with customers from,Europe,America and south Asia,supplying obsolete and hard-to-find components to meet their specific needs.

With the principle of “Quality Parts,Customers Priority,Honest Operation,and Considerate Service”,our business mainly focus on the distribution of electronic components. Line cards we deal with include Microchip,ALPS,ROHM,Xilinx,Pulse,ON,Everlight and Freescale. Main products comprise IC,Modules,Potentiometer,IC Socket,Relay,Connector.Our parts cover such applications as commercial,industrial, and automotives areas.

We are looking forward to setting up business relationship with you and hope to provide you with the best service and solution. Let us make a better world for our industry!



Contact us

Tel: +86-755-8981 8866 Fax: +86-755-8427 6832

Email & Skype: info@chipsmall.com Web: www.chipsmall.com

Address: A1208, Overseas Decoration Building, #122 Zhenhua RD., Futian, Shenzhen, China



4

3

2

1

THIS DRAWING IS UNPUBLISHED. RELEASED FOR PUBLICATION 20

© COPYRIGHT 20 BY ALL RIGHTS RESERVED.

LOC	DIST	REVISIONS			
P	LTR	DESCRIPTION	DATE	DWN	APVD
GP	00				
	3	UPDATE VIEW	03MAY2011	AL	CW
	4	UPDATE TOLERANCE	15MAR2012	KS	AC

△ MATERIAL: NICKEL/COPPER CONDUCTIVE FOAM WITH CONDUCTIVE ADHESIVE BACKING.

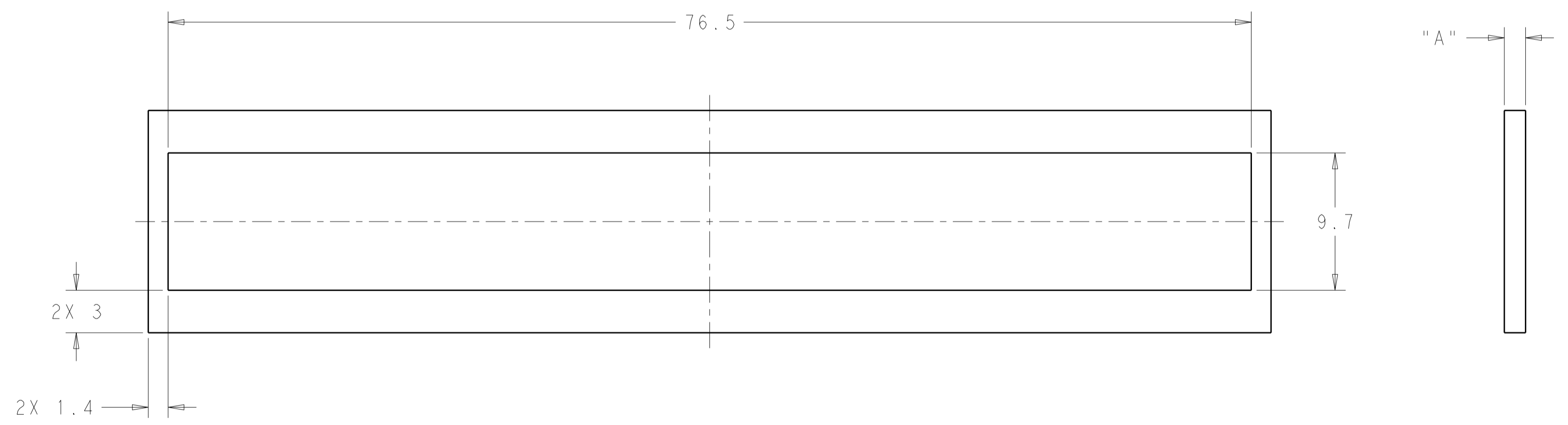

3.2	2132188-2
1.5	2132188-1
A	PART NUMBER

THIS DRAWING IS A CONTROLLED DOCUMENT.		DWN C. ROHLER 23NOV2009	STE TE Connectivity	
DIMENSIONS: mm		CHK M. SCHMITZ 23NOV2009		
TOLERANCES UNLESS OTHERWISE SPECIFIED:		APVD B. WERTZ 23NOV2009	NAME SHIELDING GASKET, 1X4 QSFP	
0 PLC ±0.45		PRODUCT SPEC	-	
1 PLC ±0.45		APPLICATION SPEC	-	
2 PLC ±0.45		WEIGHT	-	
3 PLC ±		SCALE	4:1	
4 PLC ±		SHEET	1 OF 1	
ANGLES ±0.5°		REV	4	
FINISH		CUSTOMER DRAWING		
MATERIAL △		SIZE	A200779C-2132188	
		CAGE CODE	C-2132188	
		DRAWING NO	-	
		RESTRICTED TO	-	