



Chipsmall Limited consists of a professional team with an average of over 10 year of expertise in the distribution of electronic components. Based in Hongkong, we have already established firm and mutual-benefit business relationships with customers from,Europe,America and south Asia,supplying obsolete and hard-to-find components to meet their specific needs.

With the principle of “Quality Parts,Customers Priority,Honest Operation,and Considerate Service”,our business mainly focus on the distribution of electronic components. Line cards we deal with include Microchip,ALPS,ROHM,Xilinx,Pulse,ON,Everlight and Freescale. Main products comprise IC,Modules,Potentiometer,IC Socket,Relay,Connector.Our parts cover such applications as commercial,industrial, and automotives areas.

We are looking forward to setting up business relationship with you and hope to provide you with the best service and solution. Let us make a better world for our industry!



## Contact us

Tel: +86-755-8981 8866 Fax: +86-755-8427 6832

Email & Skype: info@chipsmall.com Web: www.chipsmall.com

Address: A1208, Overseas Decoration Building, #122 Zhenhua RD., Futian, Shenzhen, China



**Model 2143**  
**Double Miniature Banana Jack**

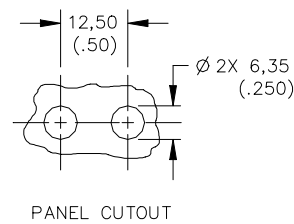
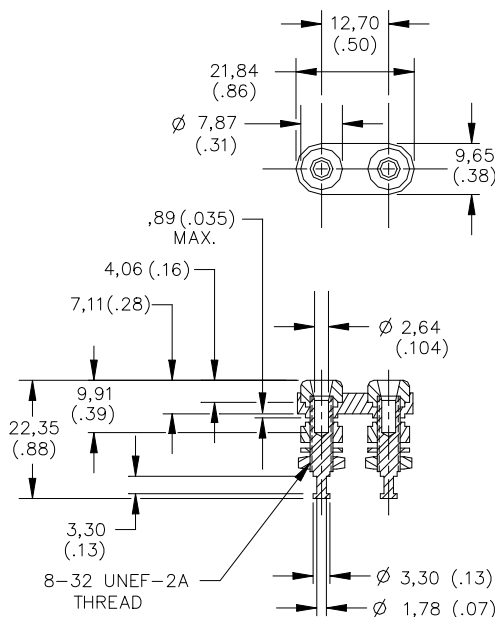
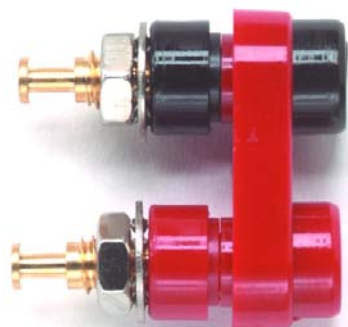

MODEL NO.	MTG. PLATE COLOR
2143-0	BLACK PLATE
2143-2	RED PLATE

**Features**

- Accepts miniature banana plugs.
- Mounts in panels up to .188" thick.

**Materials**

Miniature Banana Jack:  
 Body – Gold plated brass  
 Lockwasher #8 – Nickel Plated Steel  
 Hex Nut #8-32 – Nickel Plated Brass  
 Insulation – Polycarbonate, Color: One Red and one Black  
 Panel Insulator – Polycarbonate

**Ratings**

Operating Voltage: For CE Compliance and for personal safety, do not hold in hand when voltages exceed 30 Vrms/60 Vdc. Maximum voltage for *hands free use*: 1500 Vrms.  
 Do not use on circuits where transient stresses can exceed the rated voltage.

Operating Temperature: +115°C (+239°F) Max.

Operating Current: 5 Amperes Max.

**Ordering Information**

Model: 2143-  
 \* = Standard Mounting Base Color: -0 Black, -2 Red  
 Ordering Example: 2143-2, Mounting Base Color is Red.

USA: Sales: 800-490-2361  
 Technical Support: [technicalsupport@pomonatest.com](mailto:technicalsupport@pomonatest.com)  
 Fax: 425-446-5844

Europe: 31-(0) 40 2675 150 International: 425-446-5500  
 Where to Buy: [www.pomonaelectronics.com](http://www.pomonaelectronics.com)

All dimensions are in inches. Tolerances (except noted): .xx =  $\pm$ .02" (.51 mm), .xxx =  $\pm$ .005" (.127 mm). All specifications are to the latest revisions. Specifications are subject to change without notice. Registered trademarks are the property of their respective companies.