



Chipsmall Limited consists of a professional team with an average of over 10 year of expertise in the distribution of electronic components. Based in Hongkong, we have already established firm and mutual-benefit business relationships with customers from,Europe,America and south Asia,supplying obsolete and hard-to-find components to meet their specific needs.

With the principle of “Quality Parts,Customers Priority,Honest Operation,and Considerate Service”,our business mainly focus on the distribution of electronic components. Line cards we deal with include Microchip,ALPS,ROHM,Xilinx,Pulse,ON,Everlight and Freescale. Main products comprise IC,Modules,Potentiometer,IC Socket,Relay,Connector.Our parts cover such applications as commercial,industrial, and automotives areas.

We are looking forward to setting up business relationship with you and hope to provide you with the best service and solution. Let us make a better world for our industry!



Contact us

Tel: +86-755-8981 8866 Fax: +86-755-8427 6832

Email & Skype: info@chipsmall.com Web: www.chipsmall.com

Address: A1208, Overseas Decoration Building, #122 Zhenhua RD., Futian, Shenzhen, China



LOC		DIST		REVISIONS			
P	LTN	DESCRIPTION	DATE	DMN	APVD		
11		REVISED	09NOV2012	MEC	JS		
12		REVISED	21DEC2012	MEC	JS		

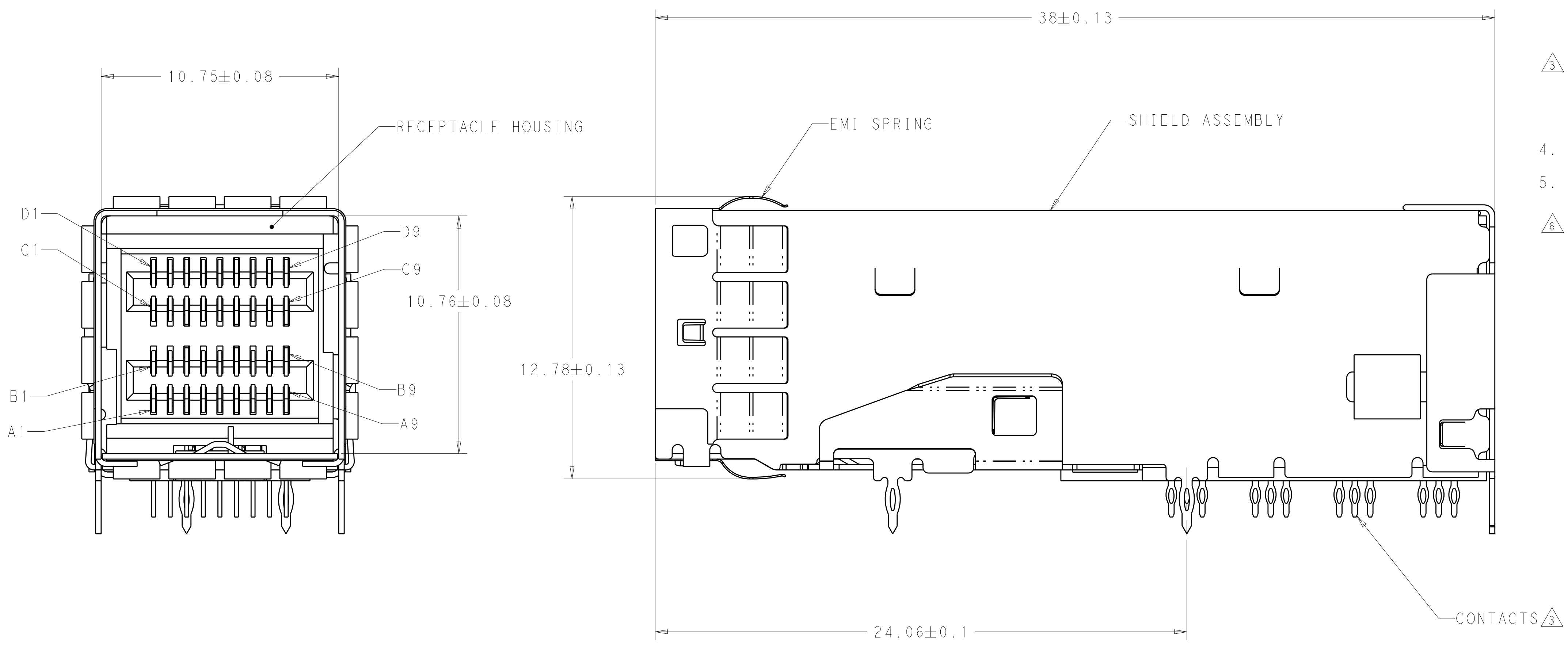

1. MATERIALS
 RECEPTACLE HOUSING, LCP, BLACK, UL94V-O RATED
 SHIELD ASSEMBLY: NICKEL SILVER COPPER ALLOY
 CONTACTS: COPPER ALLOY
 EMI SPRING: COPPER ALLOY
 THREADED NUT: BRASS
 CHICKLETS: LCP, BLACK, UL 94V-O RATED
2. FINISH
 EMI SPRING: TIN PLATE OVER NICKEL PLATE
 NON-PLATED EDGES PERMISSABLE
 THREADED NUT: NICKEL PLATE
3. CONTACT FINISH: CONFORMS TO THE REQUIREMENTS OF TE PRODUCT SPECIFICATION, 108-2462. BASED ON EIA/ECA-364-1000.01A. (CONTROLLED ENVIRONMENT APPLICATIONS) ON MATING END. TIN PLATED ON PCB TAIL
4. THREAD LENGTH OF FASTENER = PCB THICKNESS + 1.45 MAX
5. THIS PRODUCT HAS NOT COMPLETED VALIDATION/QUALIFICATION TESTING
6. RECOMMENDED TRACE KEEP OUT ZONE

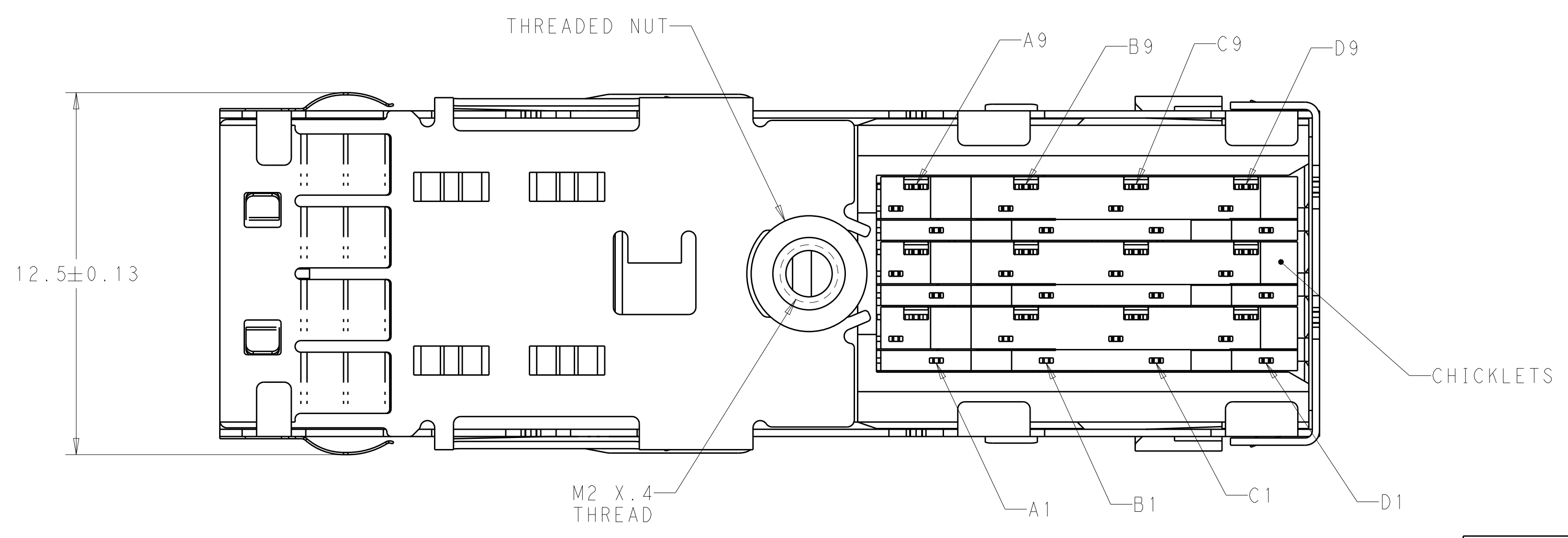

2149027-1
 PART NUMBER

THIS DRAWING IS A CONTROLLED DOCUMENT.		DMN P. KERLIN 27JUL2010	TE Connectivity	
DIMENSIONS:		CHK J. SECHRIST 27JUL2010	NAME RECEPTACLE ASSEMBLY, MINI-SASS HD	
mm	TOLERANCES UNLESS OTHERWISE SPECIFIED:	APVD -	PRODUCT SPEC	108-2462
	0 PLC ± 0.13		APPLICATION SPEC	114-13316
	2 PLC \pm		WEIGHT	-
	3 PLC \pm		Customer Drawing	SCALE 8:1 SHEET 1 OF 2 REV 12
	4 PLC \pm			
	ANGLES \pm			
MATERIAL	FINISH			

LOC	DIST	REV	DATE	BY	APPV
AG	00				

REVISIONS			
NO.	DESCRIPTION	DATE	BY
1	SEE SHEET 1		

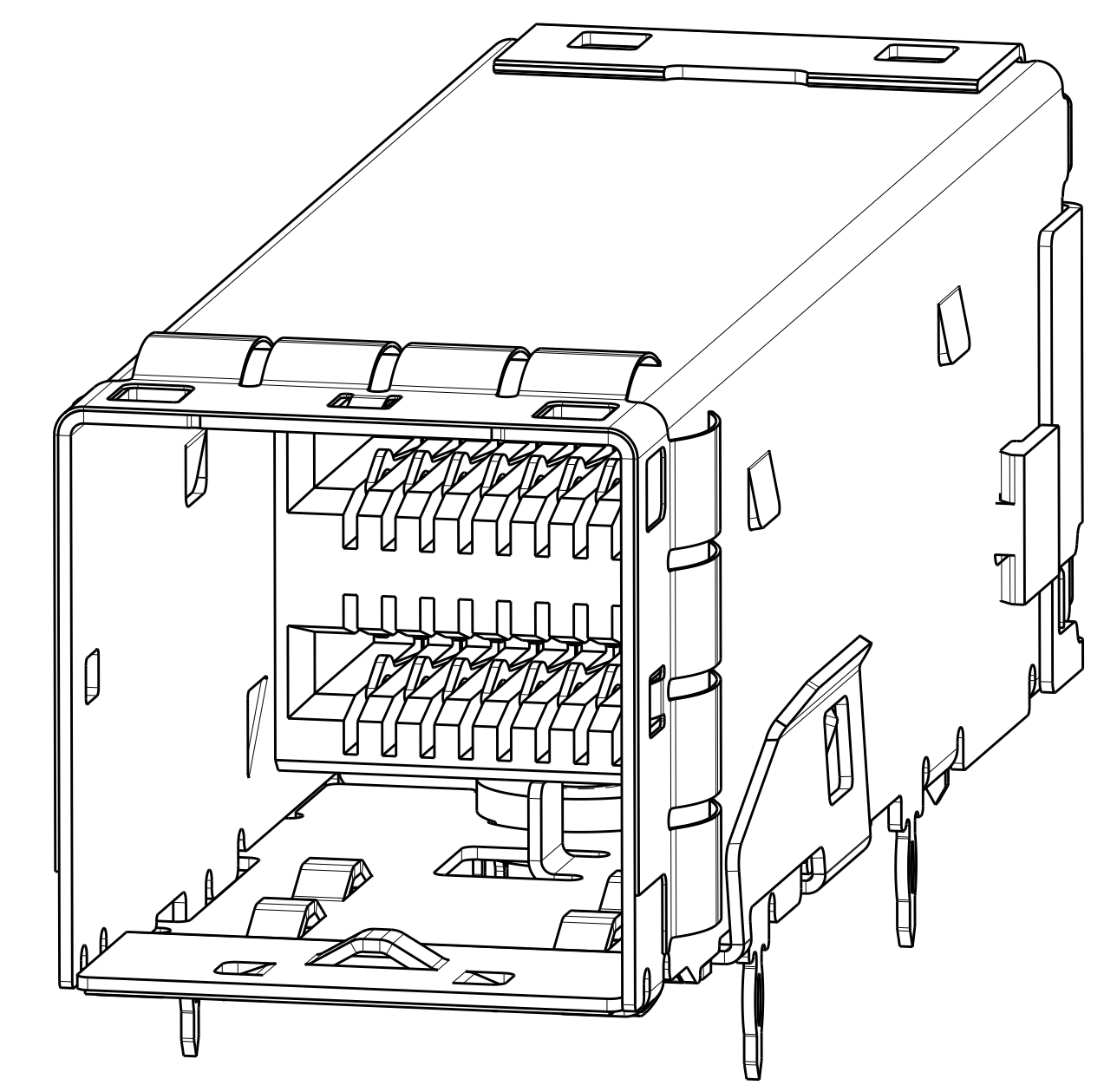
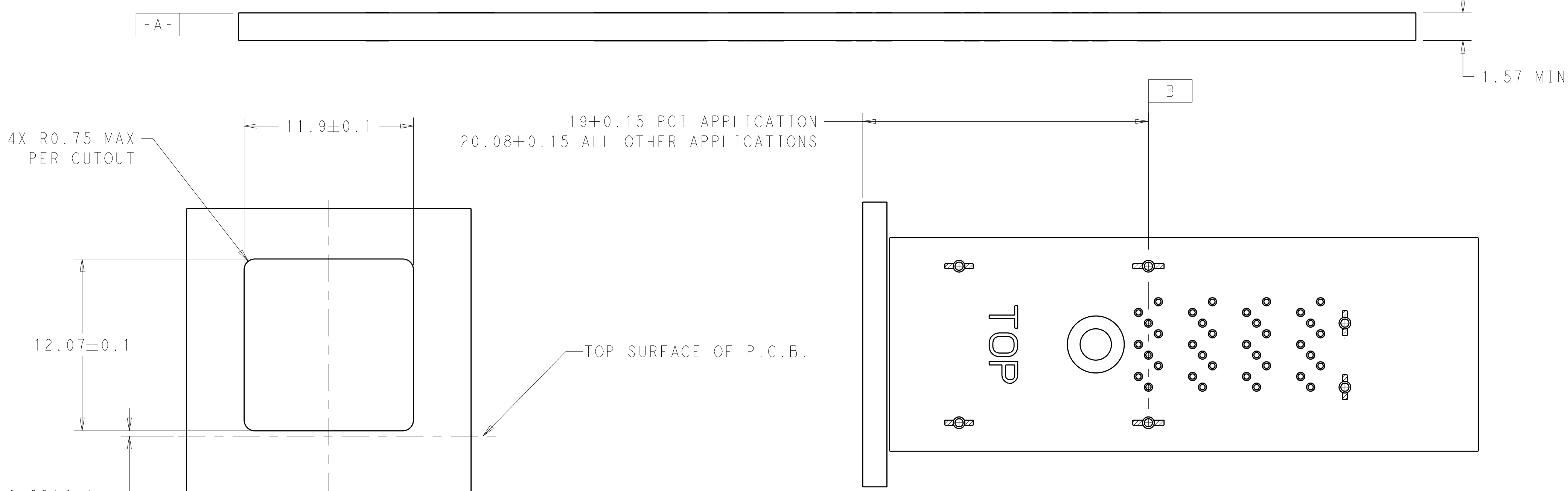
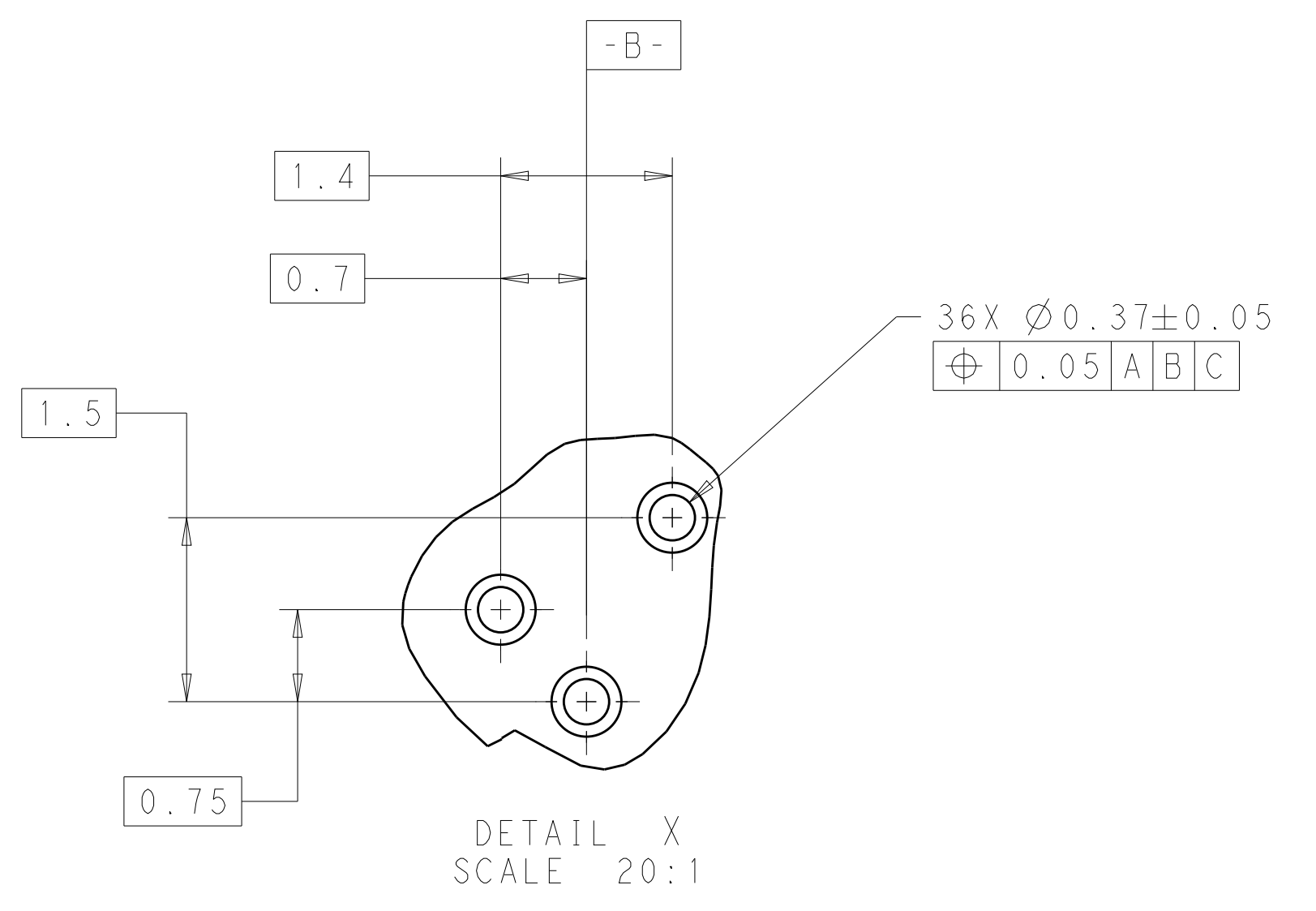
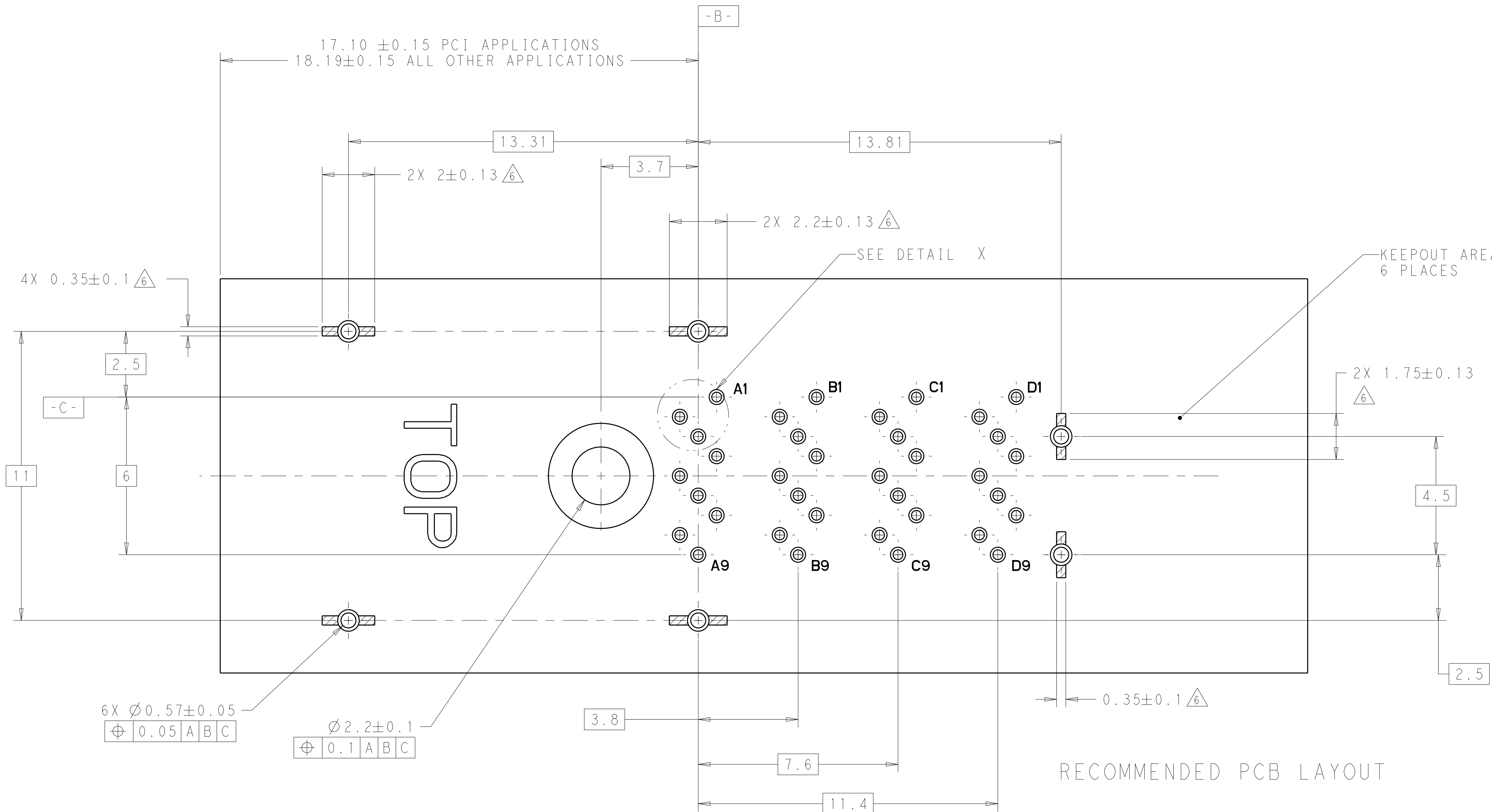

RECOMMENDED I/O PANEL CUTOUT

PANEL/PCB ASSEMBLY SCALE 5:1

THIS DRAWING IS A CONTROLLED DOCUMENT.		OWN P. KERLIN 27JUL2010	TE Connectivity
DIMENSIONS: mm		CHK J. SECHRIST 27JUL2010	
TOLERANCES UNLESS OTHERWISE SPECIFIED:		APVD	NAME RECEPTACLE ASSEMBLY, MINI-SASS HD
0 PLC	±0.13	PRODUCT SPEC	
1 PLC	±	108-2462	
2 PLC	±	APPLICATION SPEC	
3 PLC	±	114-13316	
4 PLC	±	WEIGHT	
ANGLES	±	Customer Drawing	
MATERIAL	FINISH	SCALE 8:1	SHEET 2 OF 2
		SIZE CAGE CODE DRAWING NO	REV 12
		A100779C=2149027	