



Chipsmall Limited consists of a professional team with an average of over 10 year of expertise in the distribution of electronic components. Based in Hongkong, we have already established firm and mutual-benefit business relationships with customers from,Europe,America and south Asia,supplying obsolete and hard-to-find components to meet their specific needs.

With the principle of "Quality Parts,Customers Priority,Honest Operation,and Considerate Service",our business mainly focus on the distribution of electronic components. Line cards we deal with include Microchip,ALPS,ROHM,Xilinx,Pulse,ON,Everlight and Freescale. Main products comprise IC,Modules,Potentiometer,IC Socket,Relay,Connector.Our parts cover such applications as commercial,industrial, and automotives areas.

We are looking forward to setting up business relationship with you and hope to provide you with the best service and solution. Let us make a better world for our industry!



Contact us

Tel: +86-755-8981 8866 Fax: +86-755-8427 6832

Email & Skype: info@chipsmall.com Web: www.chipsmall.com

Address: A1208, Overseas Decoration Building, #122 Zhenhua RD., Futian, Shenzhen, China



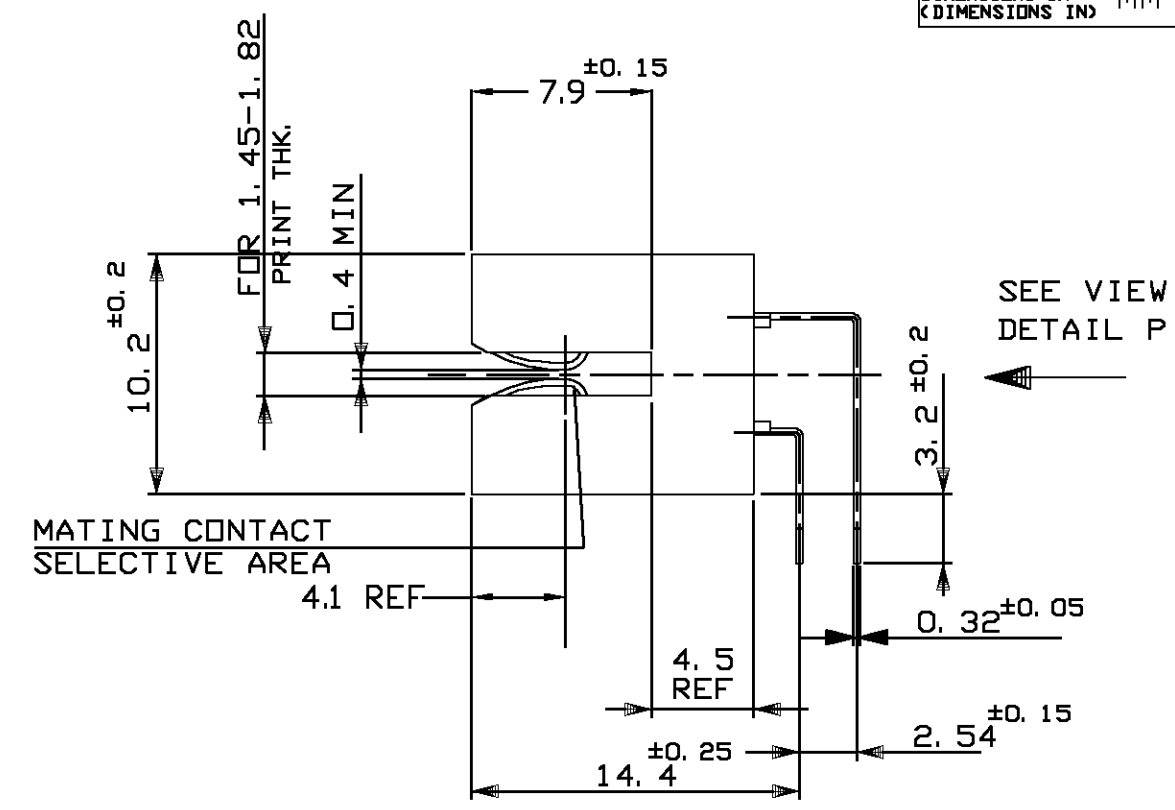
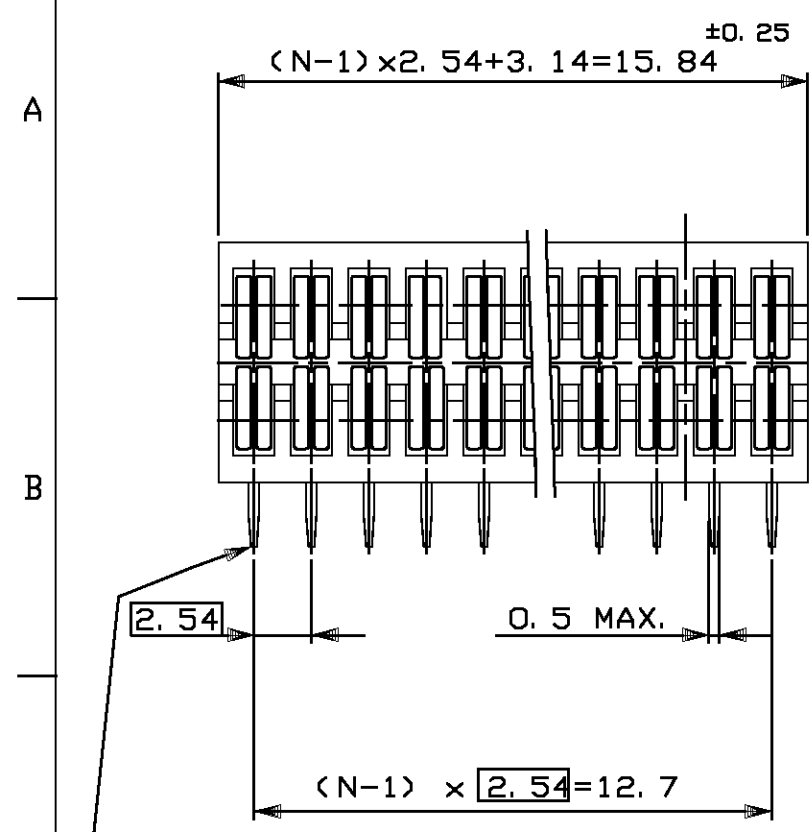

BOARD TO BOARD CONTACT POST
FOR 0.8 MIN. DIA HOLE

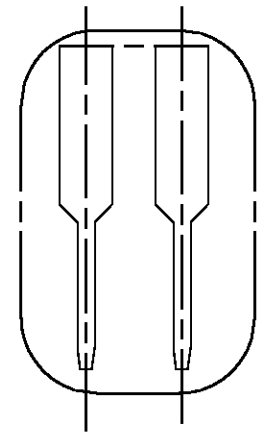
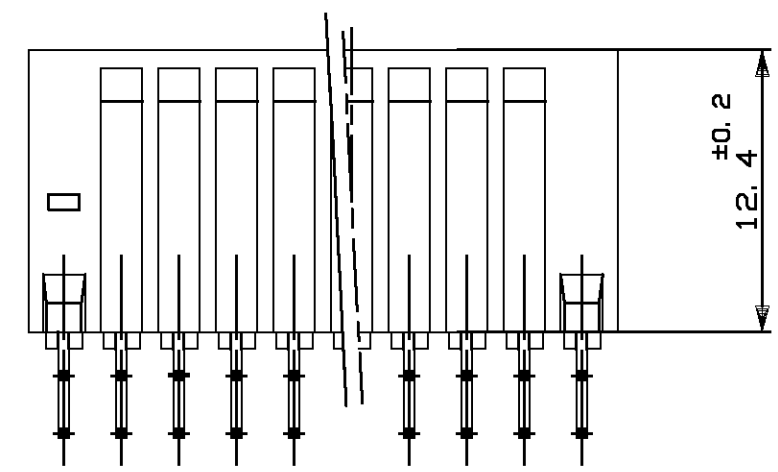

ENLARGE VIEW
DETAIL P

NOTES:

1. PRODUCT SPECIFICATION : 108-19041
2. PACKAGING: ON PLASTIC TUBES, BOXED

CONTACT: 0,4µm MIN SELECTIVE GOLD PLTD ON MATING CONTACT AREA AND 3,0µm MIN TIN PLTD ON CONTACT POST, OVER 1,25µm MIN NI PLTD UNDERLAYER	HOUSING: THERMOPLASTIC POLYESTER 20% GF, UL94-v0 COLOUR GREEN	215391-6
FINITURA / COLORE (FINISH / COLOUR)	MATERIALE (MATERIAL)	NUMERO (PART NUMBER)

CUSTOMER DWG. FOR REFERENCE ONLY DISEGNO PER CLIENTE SOLD PER RIFERIMENTO

THIS DRAWING IS UNPUBLISHED RELEASE FOR PUBLICATION 19

© COPYRIGHT 19 BY AMP INCORPORATED, HARRISBURG, PA. ALL INTERNATIONAL RIGHT RESERVED. AMP PRODUCTS MAY BE COVERED BY U.S. AND FOREIGN PATENT AND/OR PATENT PENDING

TOLLERANZE: SE NON DIVERSAMENTE SPECIFICATO DIAM. ISOLANTE (INS. DIA. RANGE) RANGO FILE (WIRE RANGE) SCALA (SCALE)

± 0,3 tyco AMP ITALIA S.p.A. Corso F.lli Cervi, 15 COLLEGNANO (TORINO)

DESCRIZIONE (DESCRIPTION) 6 POS. 2.54 CENTRE AMP-EDGE CONN. ASS'Y DUAL LOADED WITH B.T.B. CONT. 90° VERSION

LOC. SIZE NUMERO (DWG NO) REV. FOGLIO (SHEET)

REV.	REVISIONI (REVISION RECORD)	DIS. (DR)	DATA (DATE)	APP. (APP.)
J3	REVISED FOR ET00-0047-04	D. C.	05 MAR 2004	OSMAR
J2	REVISED FOR ET00-0147-03	D. C.	01 MAR 2003	BIANE
J1	REVISED FOR ET00-0115-03	D. C.	04 JUL 2003	DR.
J	REVISED FOR ET00-0068-03	PB	15 NOV 01	OR. / G. SINCHETTO
H	REDRAWN BY CAD ET00-0278-01	GS	15 NOV 01	CT. / C. TARTARI

I A3 C-215391 J3 1 (OF) 1

DISTRIBUZIONE (PRINT DIST.)