



Chipsmall Limited consists of a professional team with an average of over 10 year of expertise in the distribution of electronic components. Based in Hongkong, we have already established firm and mutual-benefit business relationships with customers from,Europe,America and south Asia,supplying obsolete and hard-to-find components to meet their specific needs.

With the principle of “Quality Parts,Customers Priority,Honest Operation,and Considerate Service”,our business mainly focus on the distribution of electronic components. Line cards we deal with include Microchip,ALPS,ROHM,Xilinx,Pulse,ON,Everlight and Freescale. Main products comprise IC,Modules,Potentiometer,IC Socket,Relay,Connector.Our parts cover such applications as commercial,industrial, and automotives areas.

We are looking forward to setting up business relationship with you and hope to provide you with the best service and solution. Let us make a better world for our industry!



## Contact us

Tel: +86-755-8981 8866 Fax: +86-755-8427 6832

Email & Skype: info@chipsmall.com Web: www.chipsmall.com

Address: A1208, Overseas Decoration Building, #122 Zhenhua RD., Futian, Shenzhen, China



LOC	DIST	REV	DESCRIPTION	DATE	OWN	APVD
		E	REV PER ECO 11-024889	12-13-11	CT	WB

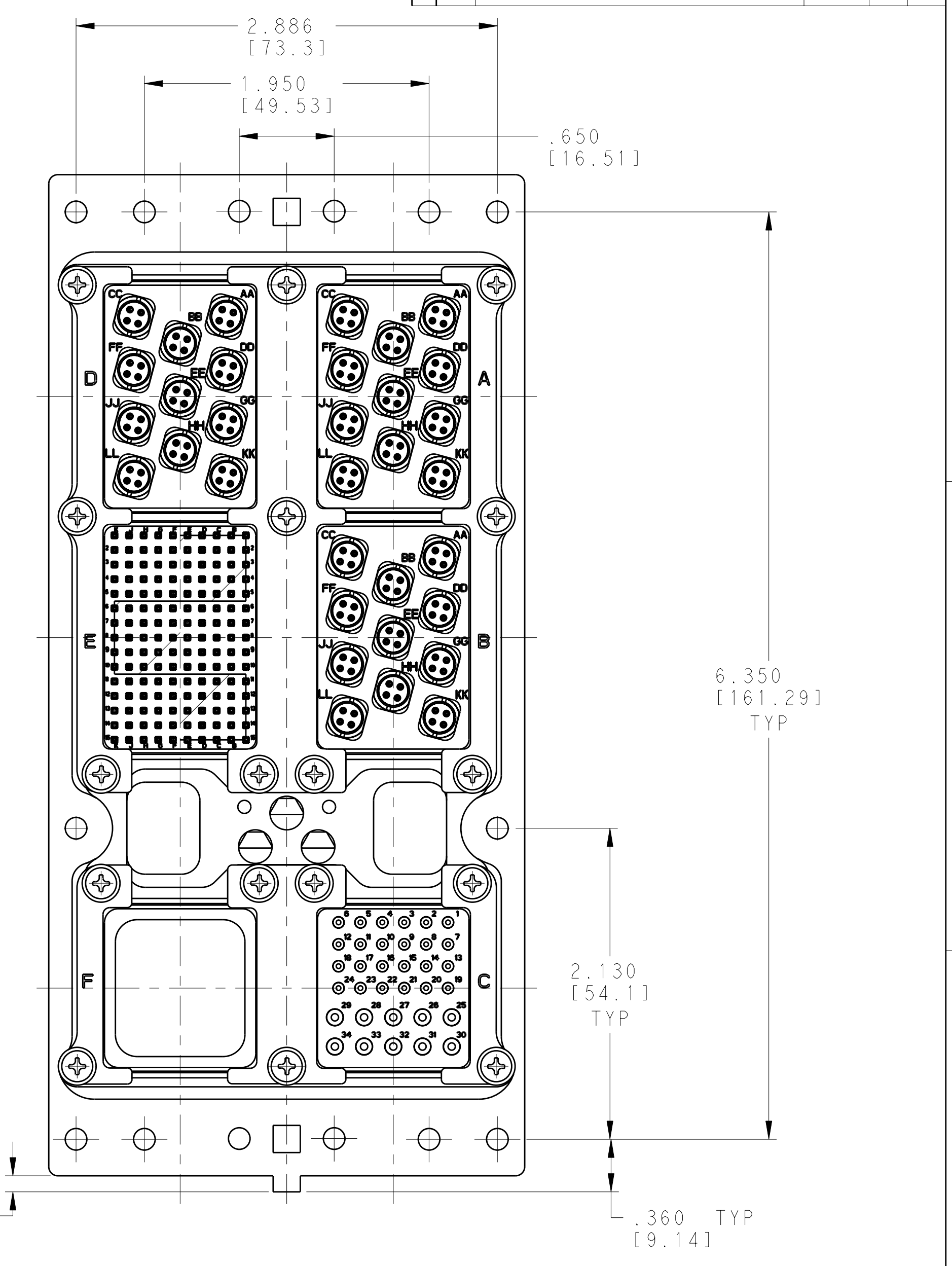
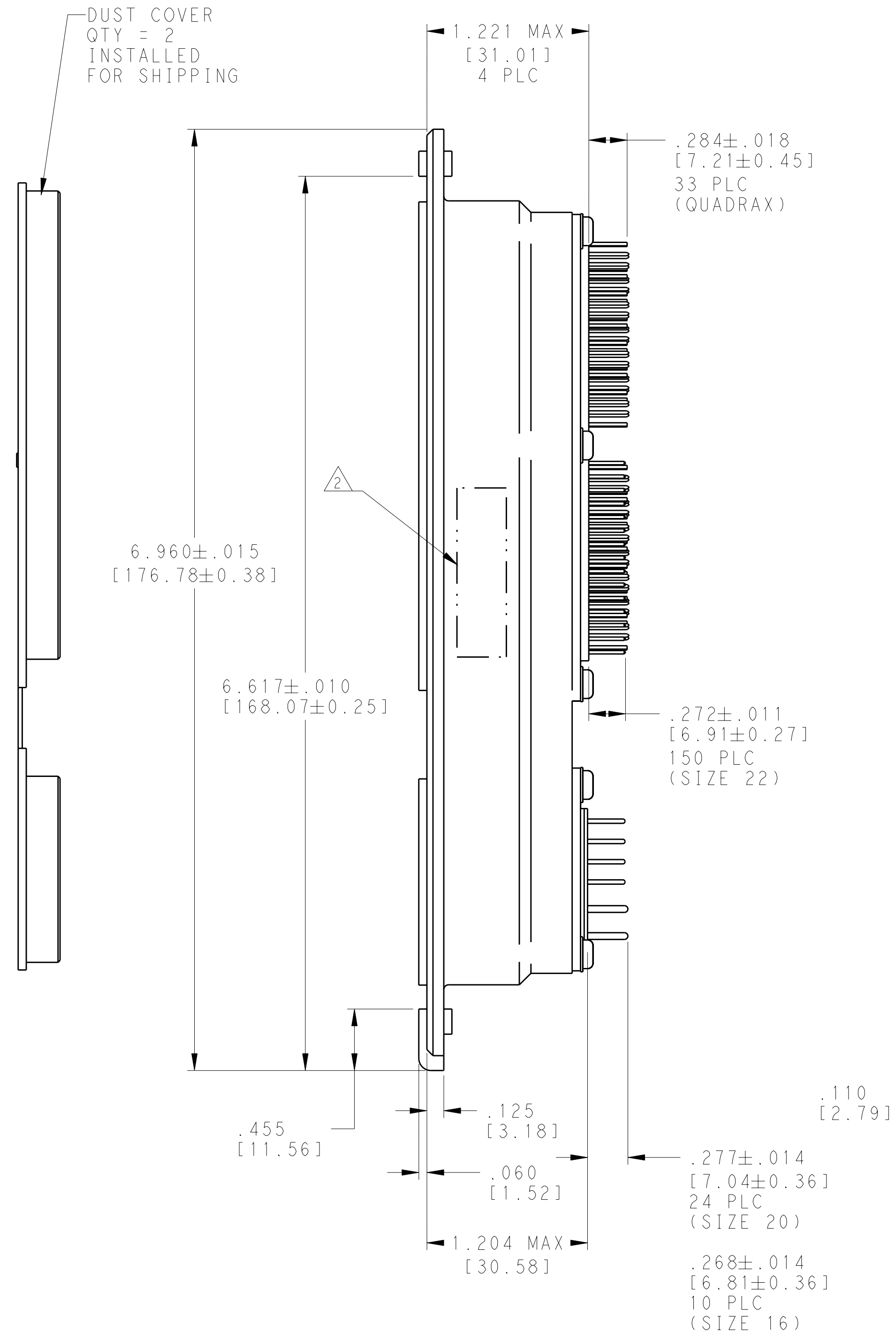
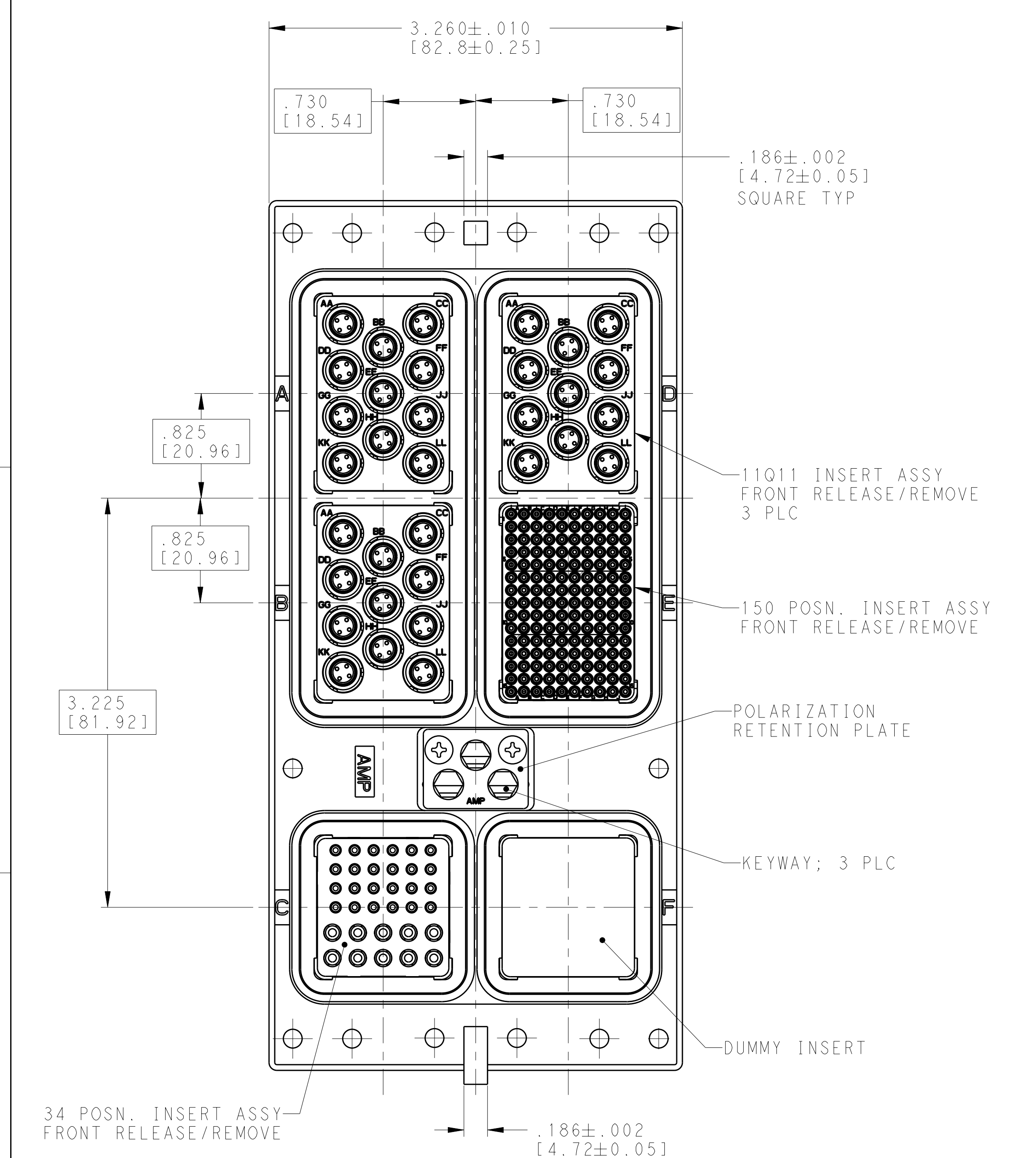

COMPONENT	MATERIAL	FINISH
DUMMY INSERT	ALUMINUM ALLOY PER ASTM B 209	ELECTROLESS NICKEL PER AMS-C-26074
11Q11 INSERT 3 PLC	ALUMINUM ALLOY PER QQ-A225/6	ELECTROLESS NICKEL PER AMS-C-26074
150 & 34 POSITION INSERTS	THERMOSET OR THERMOPLASTIC	NONE
POLARIZATION KEYWAY	ZINC ALLOY PER ASTM-B-86	--
KEYWAY RETAINER PLATE	ALUMINUM ALLOY	BLUE ANODIZED PER MIL-A-8625
INSERT RETAINER PLATE SCREWS & LOCKWASHERS	STEEL OR STAINLESS STEEL	CHROMATE OVER ZINC OR PASSIVATED
SHELL AND RETENTION PLATES	ALUMINUM ALLOY PER ASTM-B-85	ELECTROLESS NICKEL PER AMS-C-26074 CLASS 4, GRADE B
COMPONENT	MATERIAL	FINISH

- ASSEMBLED CONNECTOR FEATURES COMPLY WITH ARINC 600 SPECIFICATION.
- MANUFACTURERS PART NO. AND DATE CODE (YY-WW) MARKED IN AREA SHOWN.
- KEYING INSTALLED IN POSITION "01". FOR POSITION "00" KEYING SHIPPED UNASSEMBLED.
- CONNECTOR IS SUPPLIED WITH A DUST COVER INSTALLED FOR SHIPPING. (2 PLC)
- THE FOLLOWING CONTACTS ARE INSTALLED:  
 CAVITY A: QUADRAX PCB CONTACTS; TE PART NO. 1445626-4; QTY = 11  
 CAVITY B: QUADRAX PCB CONTACTS; TE PART NO. 1445626-4; QTY = 11  
 CAVITY C: SIZE 20 POSTED PIN CONTACT; TE PART NO. 1-448138-2; QTY = 24  
 SIZE 16 POSTED PIN CONTACT; TE PART NO. 1-448139-4; QTY = 10  
 CAVITY D: QUADRAX PCB CONTACTS; TE PART NO. 1445626-4; QTY = 11  
 CAVITY E: SIZE 22 POSTED SOCKET CONTACT; TE PART NO. 211431-4; QTY = 150  
 CAVITY F: NONE

"01"	2157336-1
KEYING POSITION	PART NO.

THIS DRAWING IS A CONTROLLED DOCUMENT. DWN C.C. THOMAS 7-20-11  
 CHK W. BERNHART 7-20-11  
 APVD W. BERNHART 7-20-11

**STE** TE Connectivity

RECEPTACLE ASSEMBLY, SIZE 3, ARINC 600 (11Q11/11Q11/34/11Q11/150/DUMMY)

SCALE 3:2 SHEET 1 OF 2 REV E

LOC	DIST	REV	DATE	BY	APPD
-	-	1	-	-	-
DESCRIPTION			DATE	BY	APPD
SEE SHEET 1			-	-	-

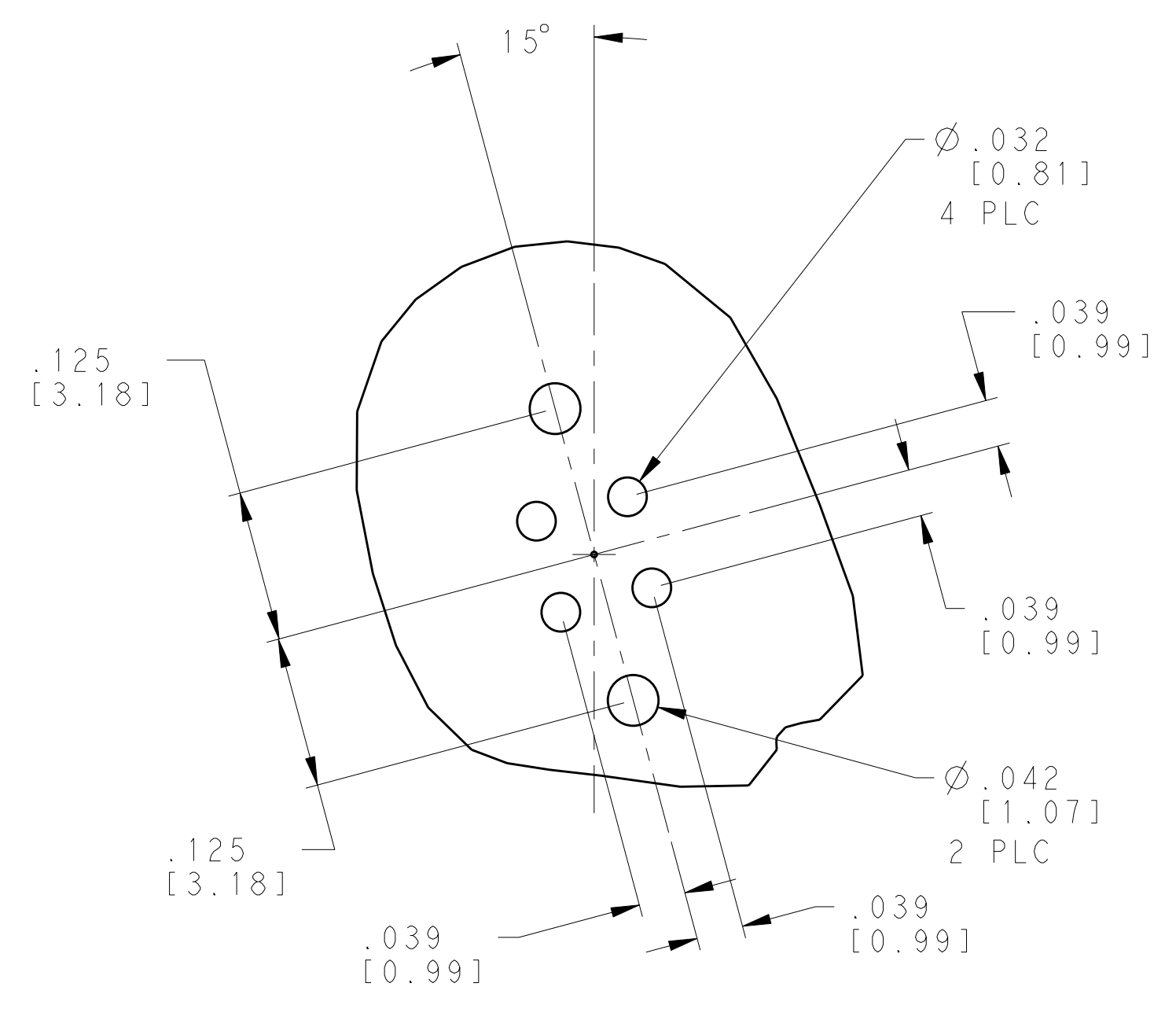
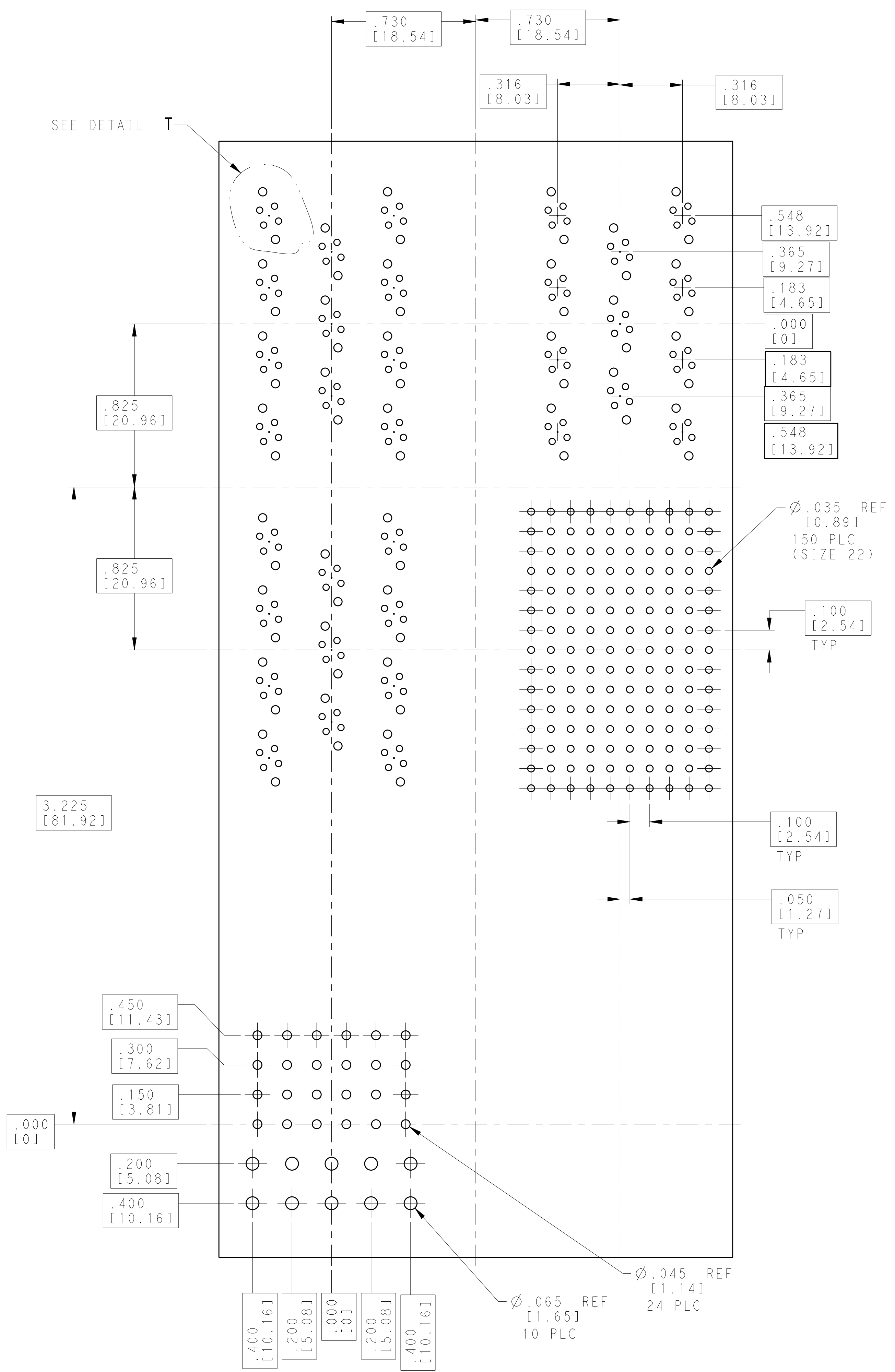

DETAIL T  
SCALE 8:1  
33 PLC

RECOMMENDED P.C. BOARD LAYOUT  
SCALE 3:1

THIS DRAWING IS A CONTROLLED DOCUMENT.		DWN C.C. THOMAS 7-20-11	TE Connectivity
DIMENSIONS: INCHES(mm)		CHK W. BERNHART 7-20-11	
TOLERANCES UNLESS OTHERWISE SPECIFIED:		APVD W. BERNHART 7-20-11	NAME RECEPTACLE ASSEMBLY, SIZE 3, ARINC 600 (11011/11011/34/11011/150/DUMMY)
9 PLC ± 8 PLC ± 5 PLC ±.005 (0.13) 4 PLC ± ANGLES ±		PRODUCT SPEC	APPLICATION SPEC
MATERIAL SEE CALLOUTS		WEIGHT	RESTRICTED TO
FINISH SEE CALLOUTS		CUSTOMER DRAWING	SCALE 3:2 SHEET 2 OF 2 REV E