



Chipsmall Limited consists of a professional team with an average of over 10 year of expertise in the distribution of electronic components. Based in Hongkong, we have already established firm and mutual-benefit business relationships with customers from,Europe,America and south Asia,supplying obsolete and hard-to-find components to meet their specific needs.

With the principle of “Quality Parts,Customers Priority,Honest Operation,and Considerate Service”,our business mainly focus on the distribution of electronic components. Line cards we deal with include Microchip,ALPS,ROHM,Xilinx,Pulse,ON,Everlight and Freescale. Main products comprise IC,Modules,Potentiometer,IC Socket,Relay,Connector.Our parts cover such applications as commercial,industrial, and automotives areas.

We are looking forward to setting up business relationship with you and hope to provide you with the best service and solution. Let us make a better world for our industry!



Contact us

Tel: +86-755-8981 8866 Fax: +86-755-8427 6832

Email & Skype: info@chipsmall.com Web: www.chipsmall.com

Address: A1208, Overseas Decoration Building, #122 Zhenhua RD., Futian, Shenzhen, China



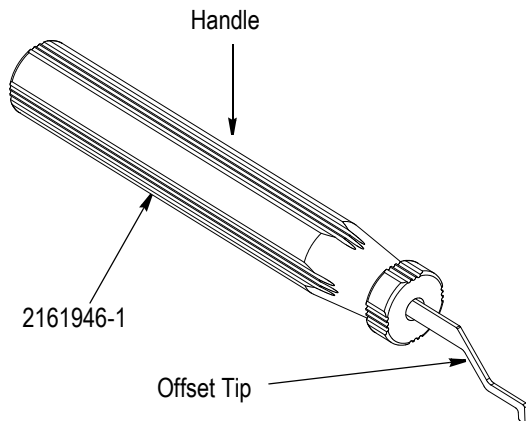

Figure 1

1. INTRODUCTION

Insertion tool 2161946-1 is designed to insert DATA DART pin and socket contact kits (assemblies) into GbE Power Modules (refer to Figure 2).

Each of the DATA DART assemblies contains one housing (pin or socket) and four contacts (pin or socket).

Read these instructions thoroughly before attempting to insert ANY contacts.

NOTE



All dimensions are in millimeters [followed by inches in brackets]. Figures and illustrations are not drawn to scale.

2. DESCRIPTION

The tool is made up of a handle and insertion tip. See Figure 1. The tip of the tool is designed to slide between the wires along the raised surface of the DATA DART assembly and push the DATA DART connector into the GbE Power Module.

3. USING THE TOOL

NOTE



Figures on this instruction sheet illustrate the socket DATA DART assemblies. The function of the tool is identical for pins and sockets used with DATA DART assemblies.

1. Wipe the tool and be sure there is no dirt or foreign particles on the tool.
2. Position the cables so that the tool can be positioned as shown in Figure 2 without causing unwanted interference between the tool and the wire.

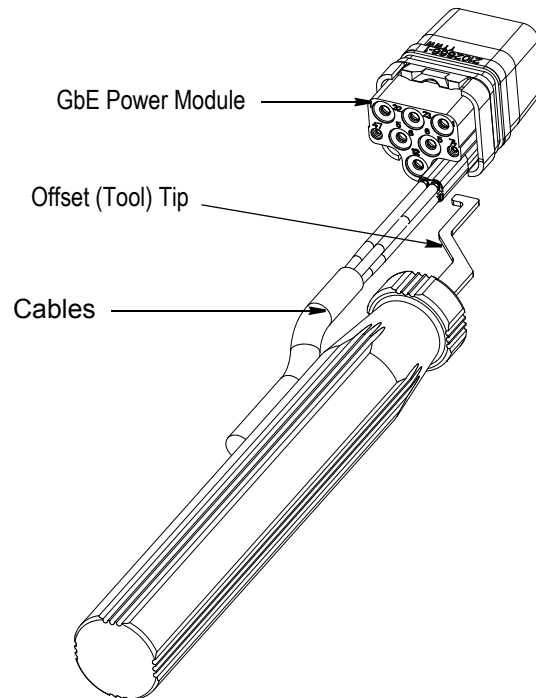

Figure 2

3. Slide the tip of the tool along the raised surface of the DATA DART (Figure 3) and push the DATA DART inside the power module housing until it bottoms and latches in place. Refer to Figure 4.

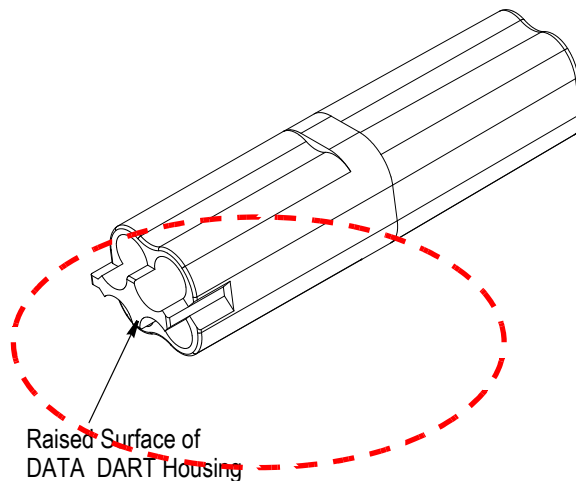

Figure 3

4. Gently slide the tip of the tool back and out of the area of the wires.

Push the DATA DART Housing Inside the GbE Power Module Until It Bottoms and Latches in Place.

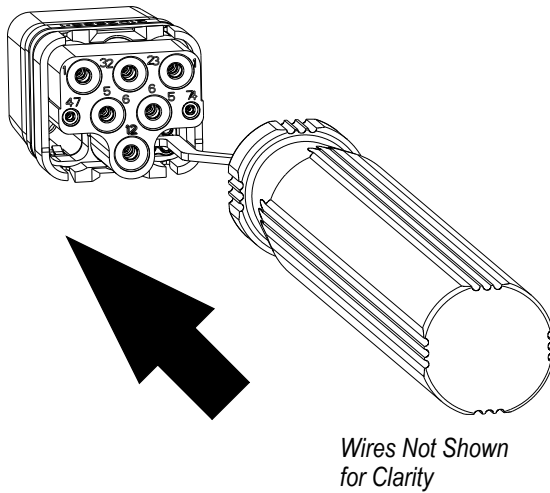

Figure 4

4. MAINTENANCE AND INSPECTION

It is recommended that each tool be inspected upon arrival to be sure it has not been damaged in transit. It should also be inspected at regularly scheduled intervals to be sure it remains functional.

Be sure to keep the tool clean. Keep the tool lightly oiled when not in use.

5. REVISION SUMMARY

Since the previous release, 2161946-2 was removed