



Chipsmall Limited consists of a professional team with an average of over 10 year of expertise in the distribution of electronic components. Based in Hongkong, we have already established firm and mutual-benefit business relationships with customers from,Europe,America and south Asia,supplying obsolete and hard-to-find components to meet their specific needs.

With the principle of “Quality Parts,Customers Priority,Honest Operation,and Considerate Service”,our business mainly focus on the distribution of electronic components. Line cards we deal with include Microchip,ALPS,ROHM,Xilinx,Pulse,ON,Everlight and Freescale. Main products comprise IC,Modules,Potentiometer,IC Socket,Relay,Connector.Our parts cover such applications as commercial,industrial, and automotives areas.

We are looking forward to setting up business relationship with you and hope to provide you with the best service and solution. Let us make a better world for our industry!



Contact us

Tel: +86-755-8981 8866 Fax: +86-755-8427 6832

Email & Skype: info@chipsmall.com Web: www.chipsmall.com

Address: A1208, Overseas Decoration Building, #122 Zhenhua RD., Futian, Shenzhen, China



LOC	DIST	REVISIONS			
P	LTN	DESCRIPTION	DATE	DWN	APVD
A		ECR-11-018212	26MAR2012	DZ	AC
B			18JUN2013	CW	SH

1. MATERIAL:
 HOUSING: BLACK, THERMOPLASTIC, RATED UL 94V-0.
 SHIELD: COPPER ALLOY WITH NICKEL PLATING.
 CONTACTS: PHOSPHER BRONZE.
 CONTACT PLATING: 0.05um MIN GOLD OVER
 0.76um MIN PALLADIUM-NICKEL, AT MATING
 INTERFACE CONTACT AREA.
2. DATE CODE SHOWN APPROXIMATE AREA.
3. LIGHT PIPE MATERIAL: CLEAR POLYCARBONATE
4. RECOMMENDED MIN PCB THICKNESS 1.5mm (.062").
5. DATUM AND BASIC DIMENSION ESTABLISHED BY CUSTOMER
6. FOR HOLE SIZE AND PLATINGS, SEE SHEET 3.
7. ISOLATION VOLTAGE: 2250VDC(MAX) FOR 60 SECONDS WITH
 A RISE TIME OF 500V/SEC.
8. RECOMMENDED SMT LED MANUFACTURERS AND PN:
 EVERLIGHT P/N: 18-225/R6G6C-A01/3T OR
 PARALIGHT P/N: L-CI85KFKGWT

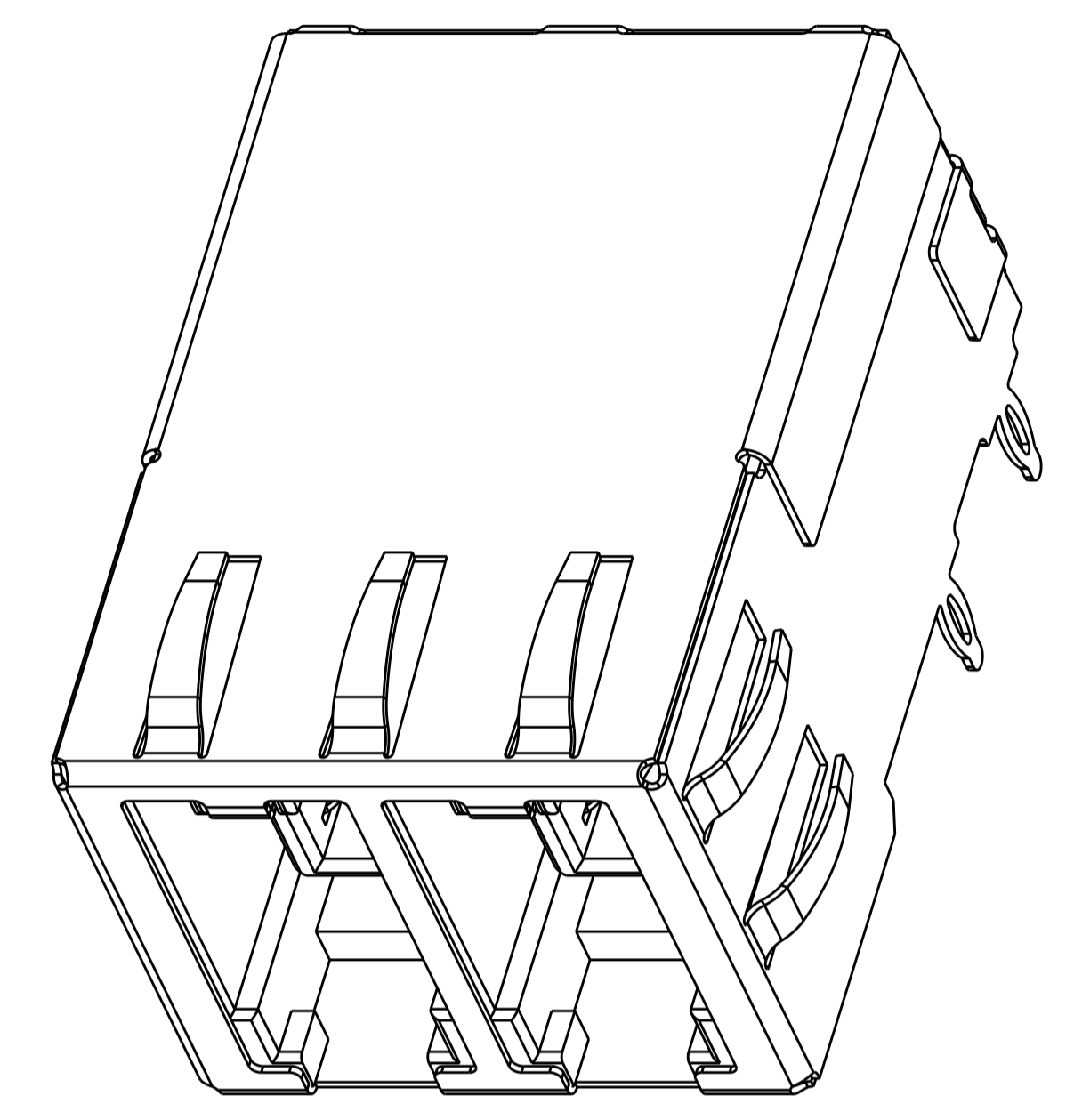
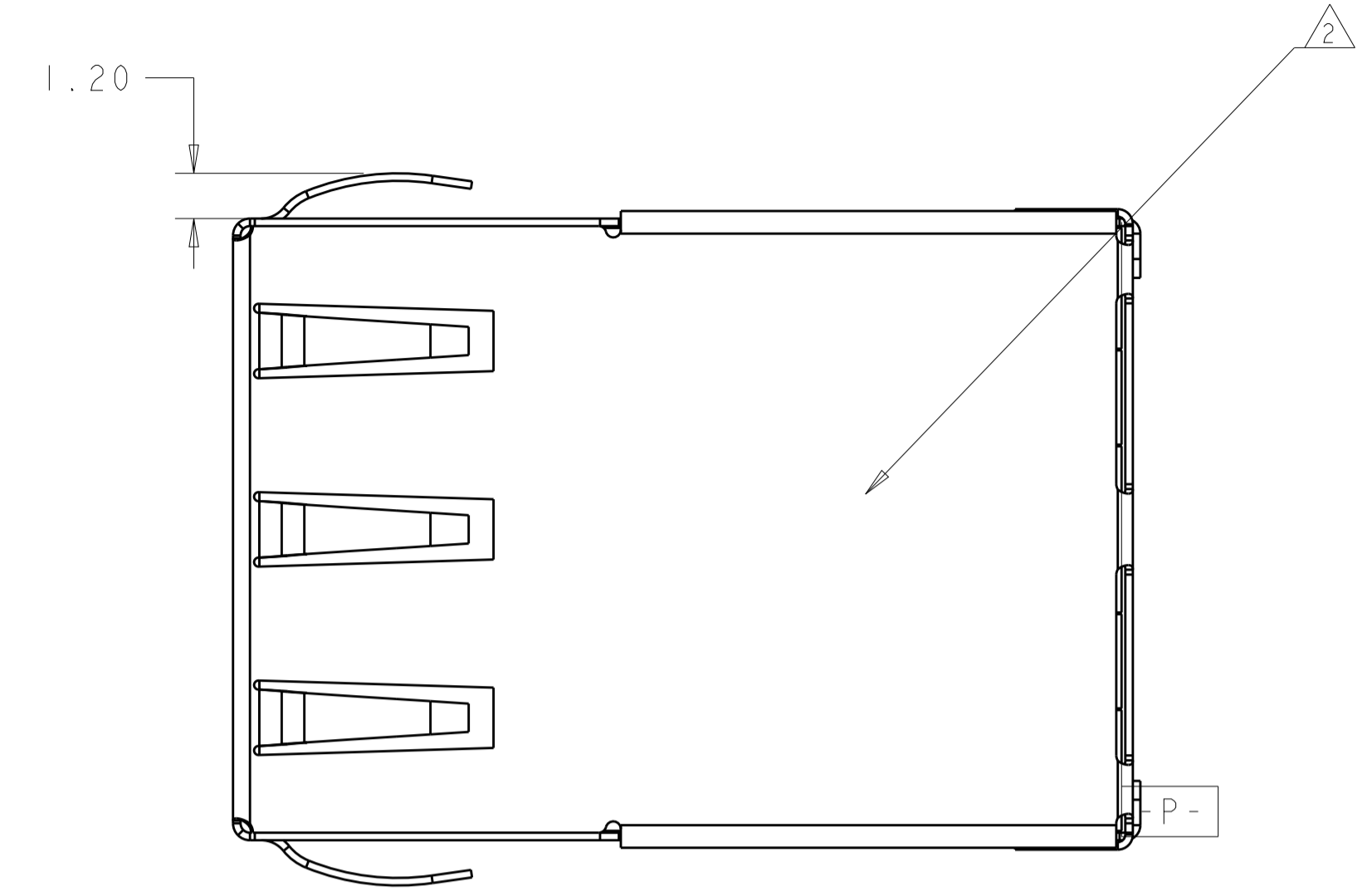

SCALE 6:1

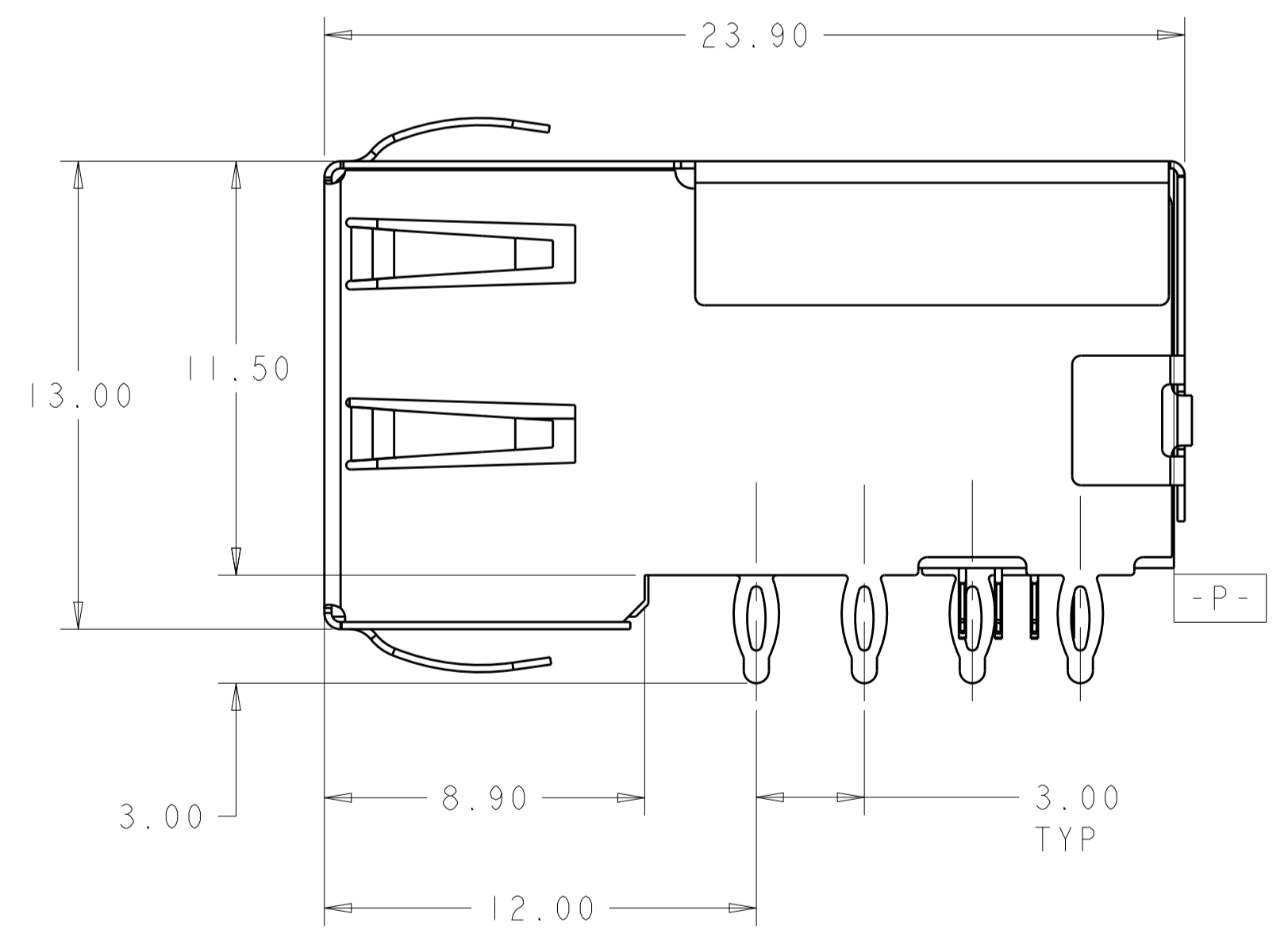
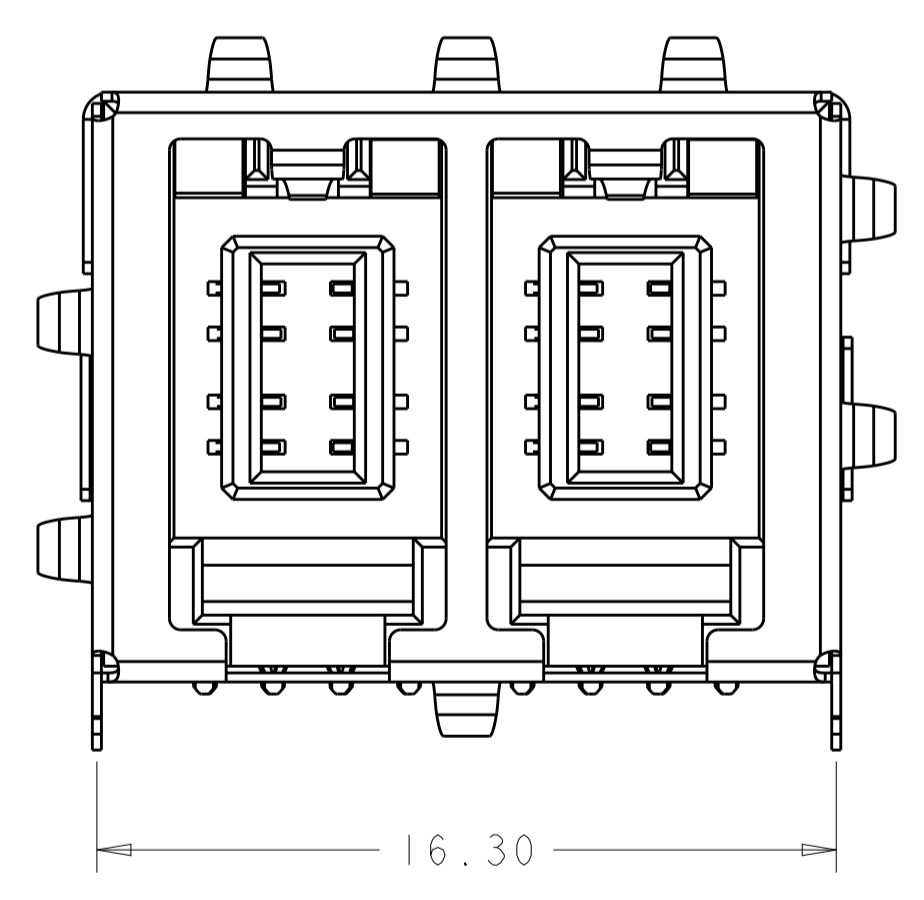

SCALE 6:1

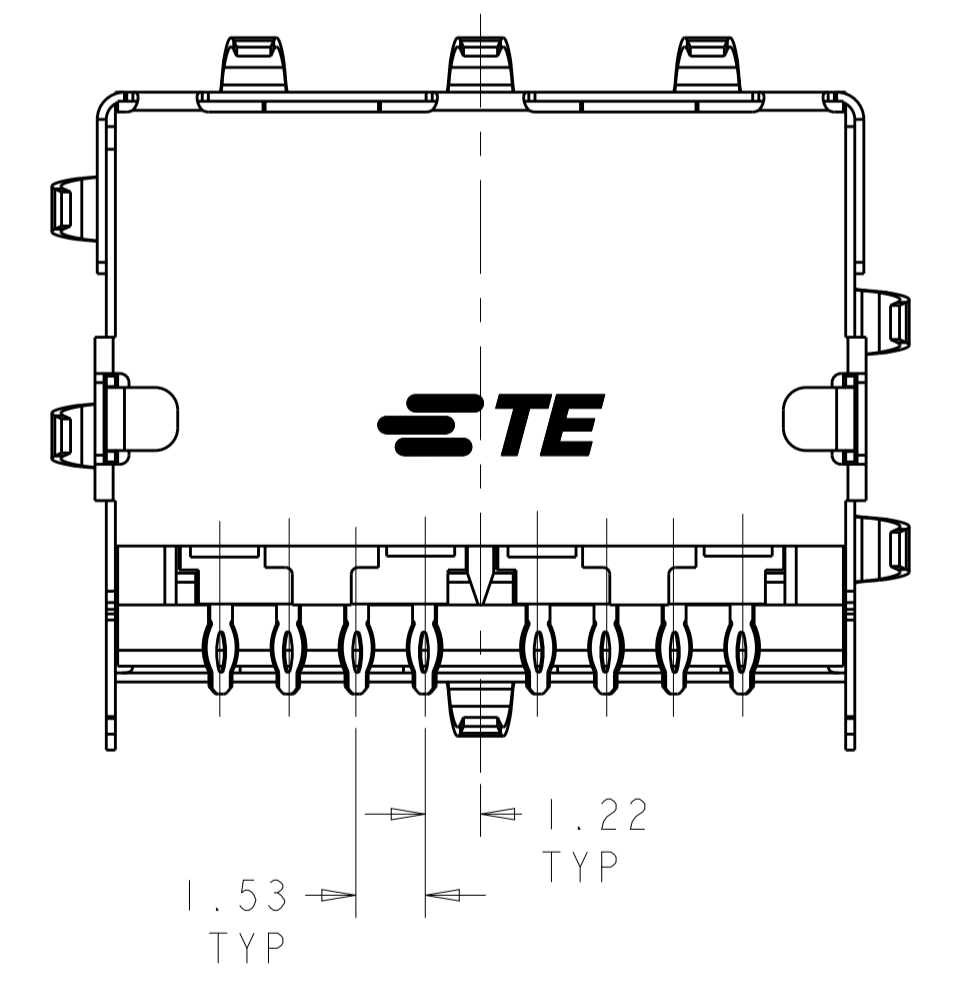

2170129-1 P/N

THIS DRAWING IS A CONTROLLED DOCUMENT.		DWN D. ZHU 15MAY2011	2170129-1 P/N	
DIMENSIONS:		CHK MANOJIAN.W 15MAY2011	STE TE Connectivity	
TOLERANCES UNLESS OTHERWISE SPECIFIED:		APVD MANOJIAN.W 15MAY2011	NAME RECEPTACLE ASSEMBLY 1X2 OFFSET, NON MAGNETICS RJ POINT FIVE	
mm	0 PLC ±	PRODUCT SPEC	SIZE CAGE CODE DRAWING NO RESTRICTED TO	
	1 PLC ±0.25	108-60097	A100779C=2170129	
	3 PLC ±	APPLICATION SPEC	SCALE 1:1 SHEET 1 OF 3 REV B	
	4 PLC ±	114-60014		
	ANGLES ±2°	WEIGHT		
MATERIAL	FINISH	Customer Drawing		

LOC	DIST	REV	DATE	BY	APPV
AG	00				

REVISIONS			DATE	BY	APPV
		SEE SHEET 1			

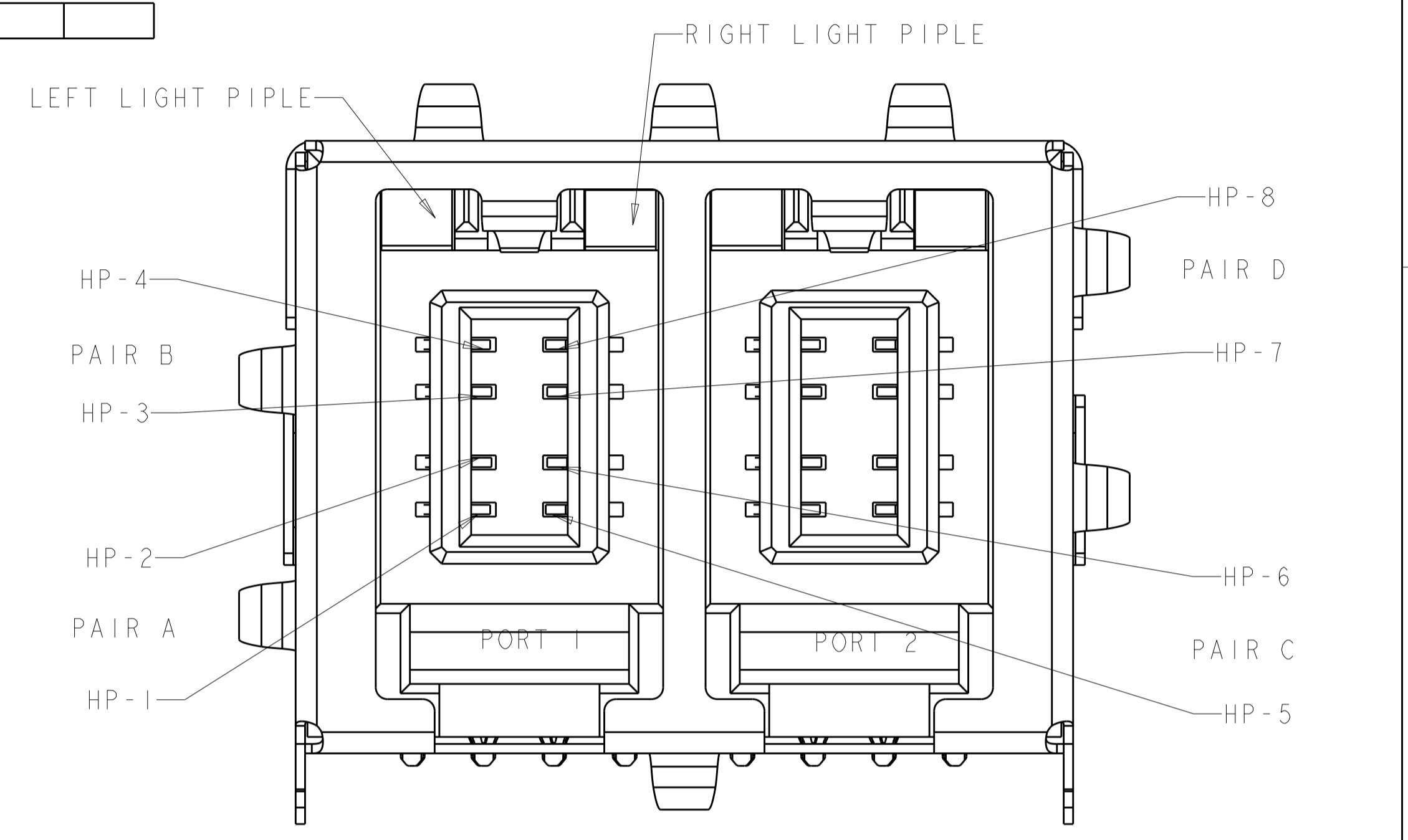
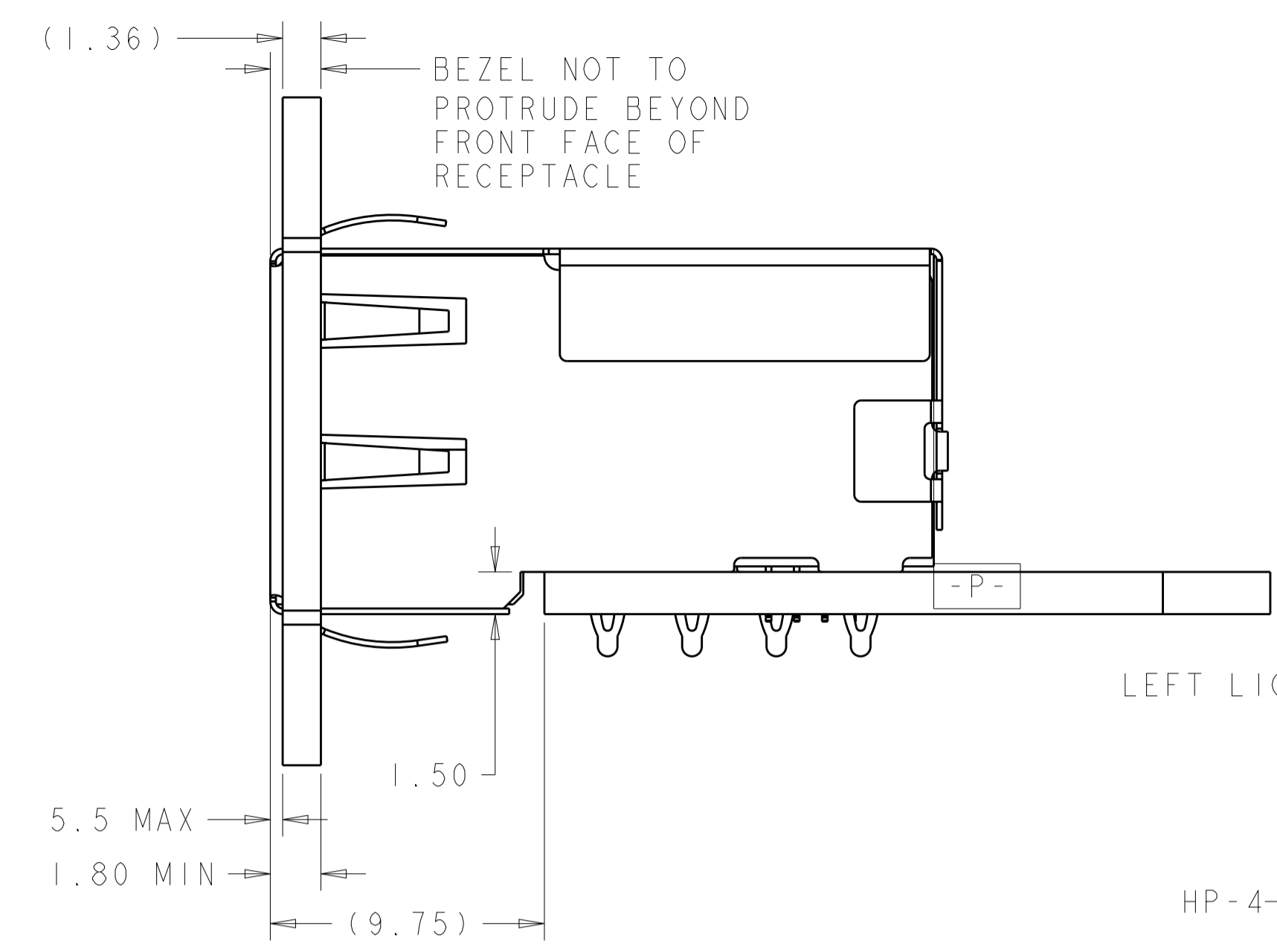
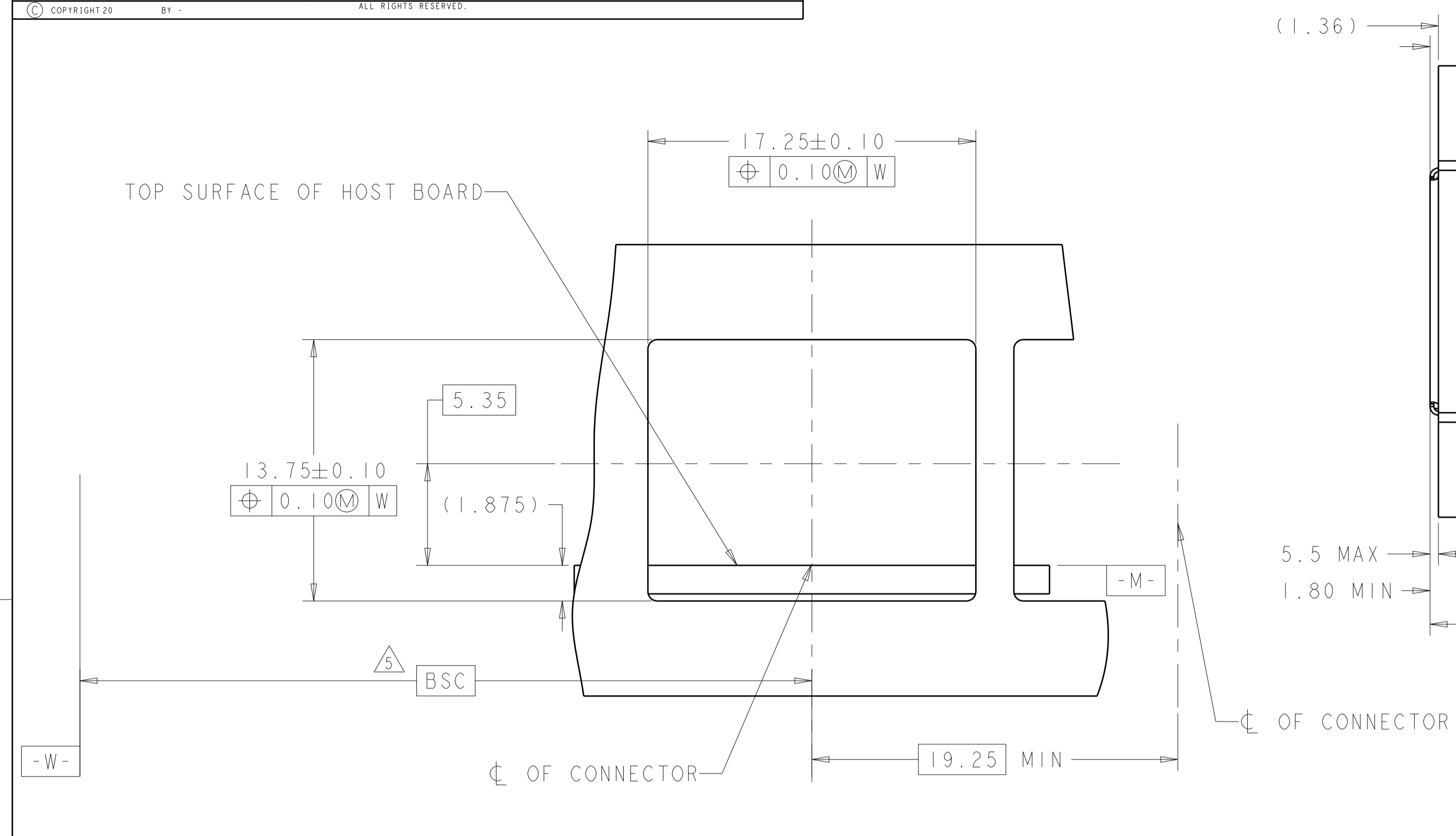

RECOMMENDED PANEL CUTOUT
 SCALE 5:1

SCALE 10:1

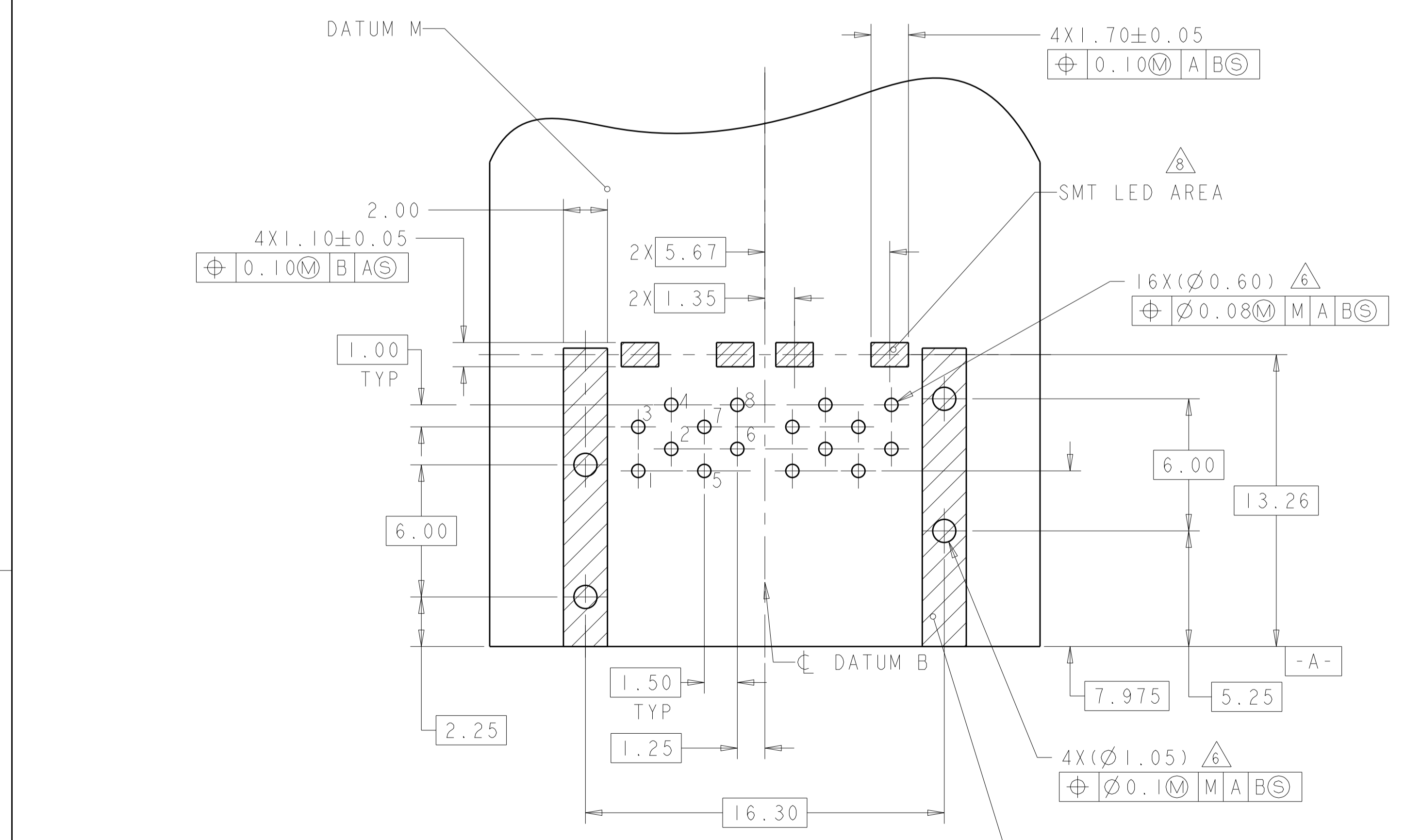
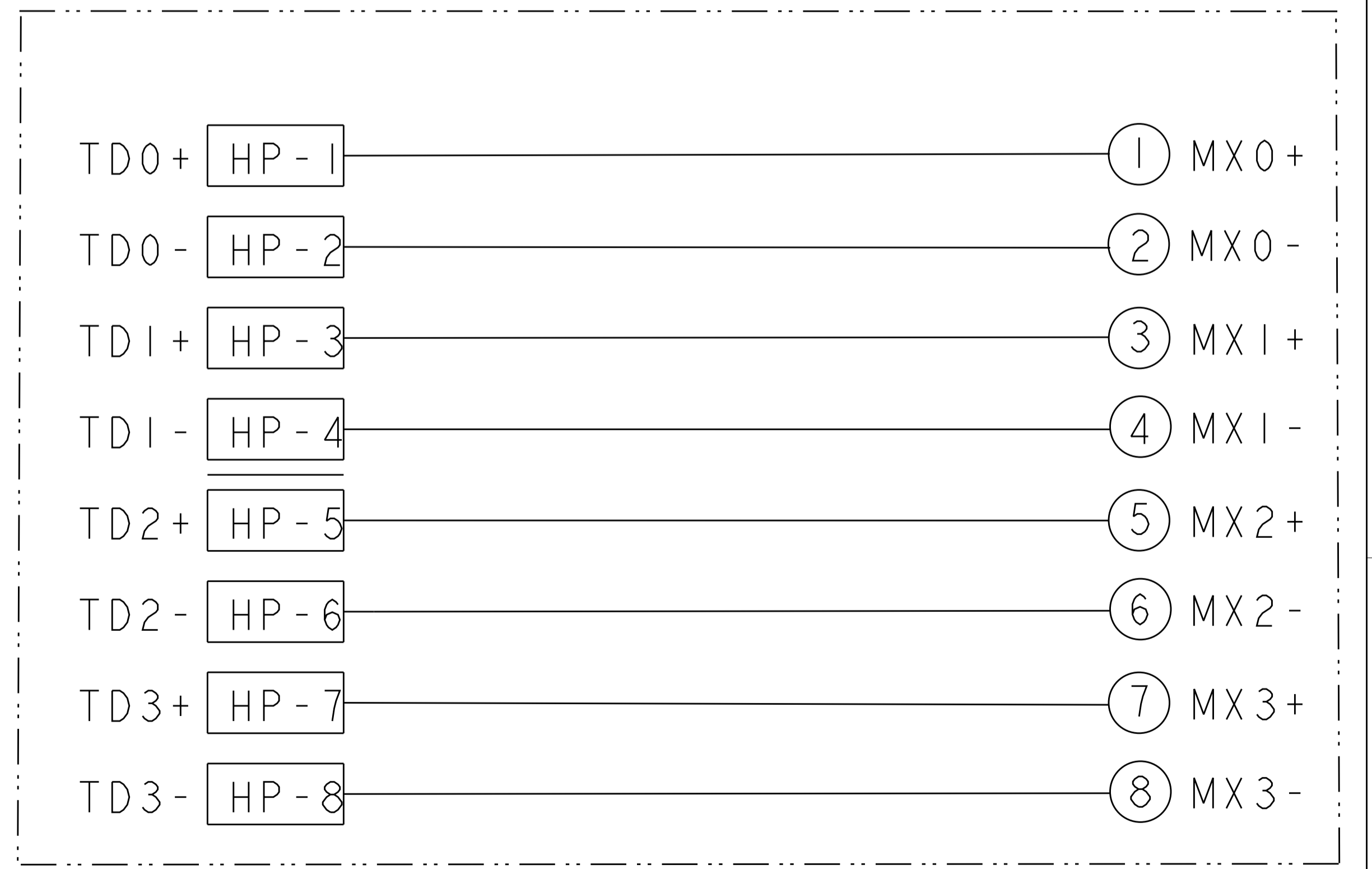

CROSS-HATCHED AREA DENOTES COMPONENT AND TRACE KEEP-OUT (EXCEPT CHASSIS GROUND)

RECOMMENDED PCB LAYOUT VIEWED FROM COMPONENT SIDE
 SCALE 6:1

THIS DRAWING IS A CONTROLLED DOCUMENT.

DIMENSIONS:	TOLERANCES UNLESS OTHERWISE SPECIFIED:	OWN: D_ZHU 15MAY2011	CHK: MANOJAN_W 15MAY2011	APV: MANOJAN_W 15MAY2011
mm	0 PLC ±	NAME: RECEPTACLE ASSEMBLY 1X2 OFFSET, NON MAGNETICS RJ POINT FIVE		
	1 PLC ±0.25	PRODUCT SPEC: 108-60097		
	2 PLC ±	APPLICATION SPEC: 114-60014		
	3 PLC ±	SIZE: A1		
	4 PLC ±	CAGE CODE: 2170129		
	ANGLES ±	WEIGHT: -		
MATERIAL:	FINISH:	Customer Drawing		

TE Connectivity

SCALE 1:1 SHEET 2 OF 3 REV B

LOC		DIST		REVISIONS			
P	LTN	DESCRIPTION	DATE	DMN	APVD		
-	-	SEE SHEET 1	-	-	-		

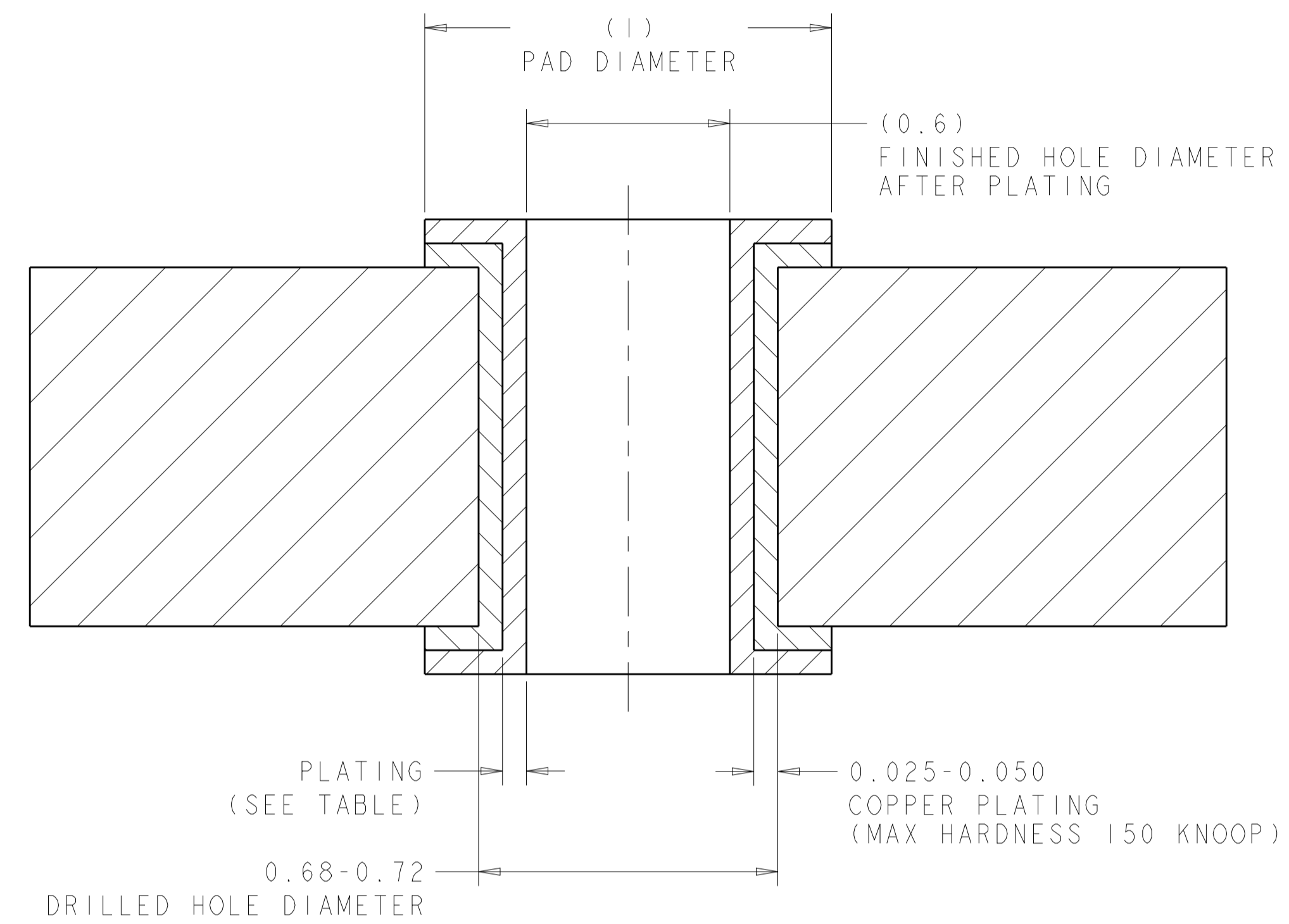

RECOMMENDED HOLE DIMENSIONS FOR SIGNAL CONTACTS

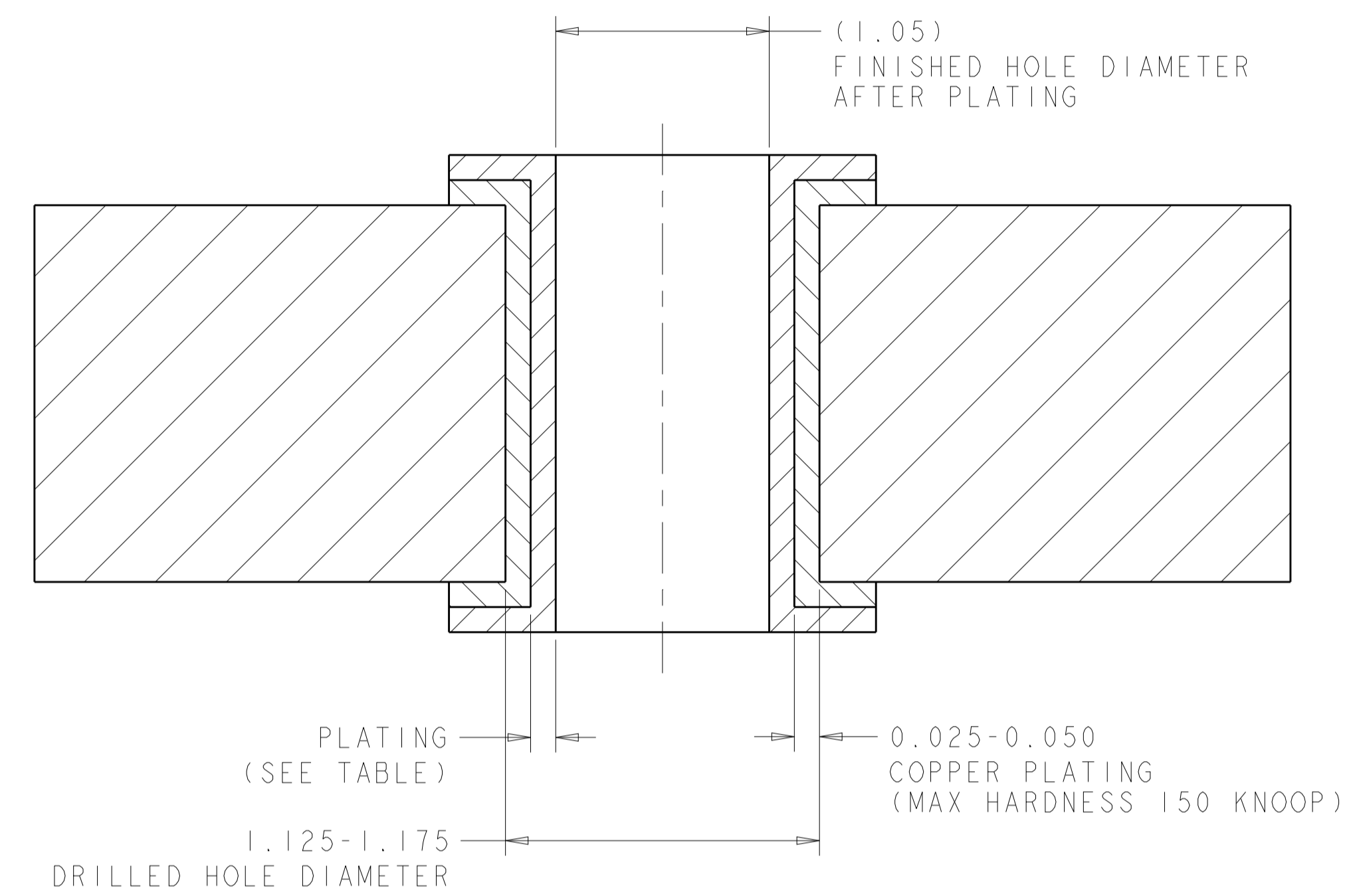

RECOMMENDED HOLE DIMENSIONS FOR SHIELD PINS

THICKNESS	PLATING
0.004-0.010	HOT AIR SOLDER LEVELING (HASL) TIN-LEAD (Sn Pb)
0.0005-0.001	IMMERSION TIN (Sn)
0.0002-0.0005	ORGANIC SOLDERABILITY PRESERVATIVE (OSP)
0.0001-0.0005 Au, 0.004-0.0076 Ni	IMMERSION GOLD (Au) OVER NICKEL (Ni) (ENIG)
0.010-0.025	TIN LEAD PLATING (Sn Pb)
0.0001-0.00015	IMMERSION SILVER (Ag)

THIS DRAWING IS A CONTROLLED DOCUMENT.

DIMENSIONS:	TOLERANCES UNLESS OTHERWISE SPECIFIED:	DMN: D. ZHU 15MAY2011	TE Connectivity NAME: RECEPTACLE ASSEMBLY 1X2 OFFSET, NON MAGNETICS RJ POINT FIVE
mm	0 PLC ±	CHK: MANOJAN. W 15MAY2011	
	1 PLC ±0.25	APVD: MANOJAN. W 15MAY2011	
	2 PLC ±	PRODUCT SPEC	
MATERIAL	FINISH	108-60097	SIZE: CAGE CODE DRAWING NO
		APPLICATION SPEC	RESTRICTED TO
		114-60014	A100779C=2170129
		WEIGHT	Customer Drawing
			SCALE: 4:1 SHEET 3 OF 3 REV B