



Chipsmall Limited consists of a professional team with an average of over 10 year of expertise in the distribution of electronic components. Based in Hongkong, we have already established firm and mutual-benefit business relationships with customers from,Europe,America and south Asia,supplying obsolete and hard-to-find components to meet their specific needs.

With the principle of “Quality Parts,Customers Priority,Honest Operation,and Considerate Service”,our business mainly focus on the distribution of electronic components. Line cards we deal with include Microchip,ALPS,ROHM,Xilinx,Pulse,ON,Everlight and Freescale. Main products comprise IC,Modules,Potentiometer,IC Socket,Relay,Connector.Our parts cover such applications as commercial,industrial, and automotives areas.

We are looking forward to setting up business relationship with you and hope to provide you with the best service and solution. Let us make a better world for our industry!



Contact us

Tel: +86-755-8981 8866 Fax: +86-755-8427 6832

Email & Skype: info@chipsmall.com Web: www.chipsmall.com

Address: A1208, Overseas Decoration Building, #122 Zhenhua RD., Futian, Shenzhen, China



LOC	DIST	REVISIONS					
		P	LYR	DESCRIPTION	DATE	DWN	APVD
GP	00	1		PRELIMINARY	19SEP2012	DZ	JY

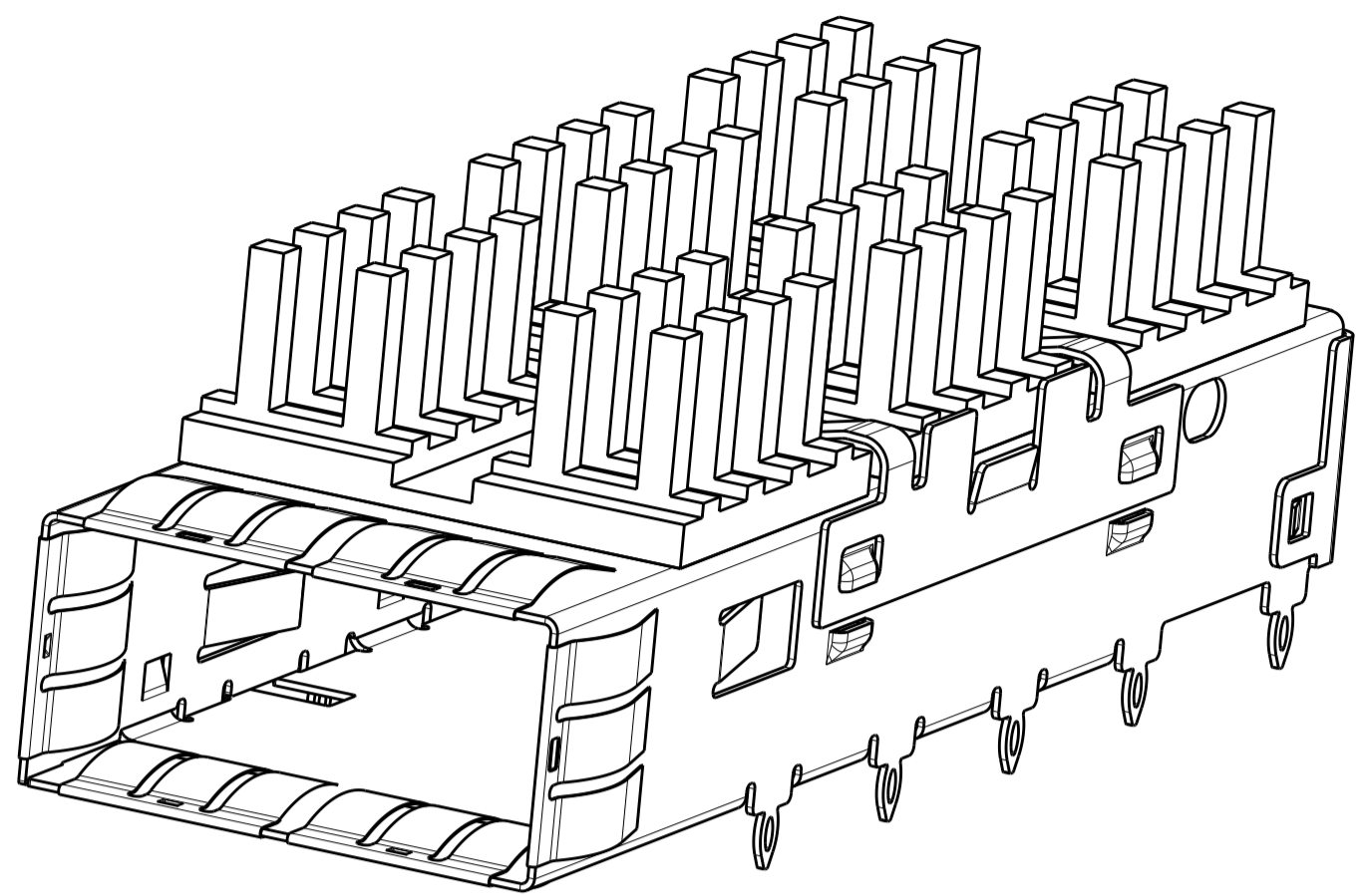

SCALE 4:1

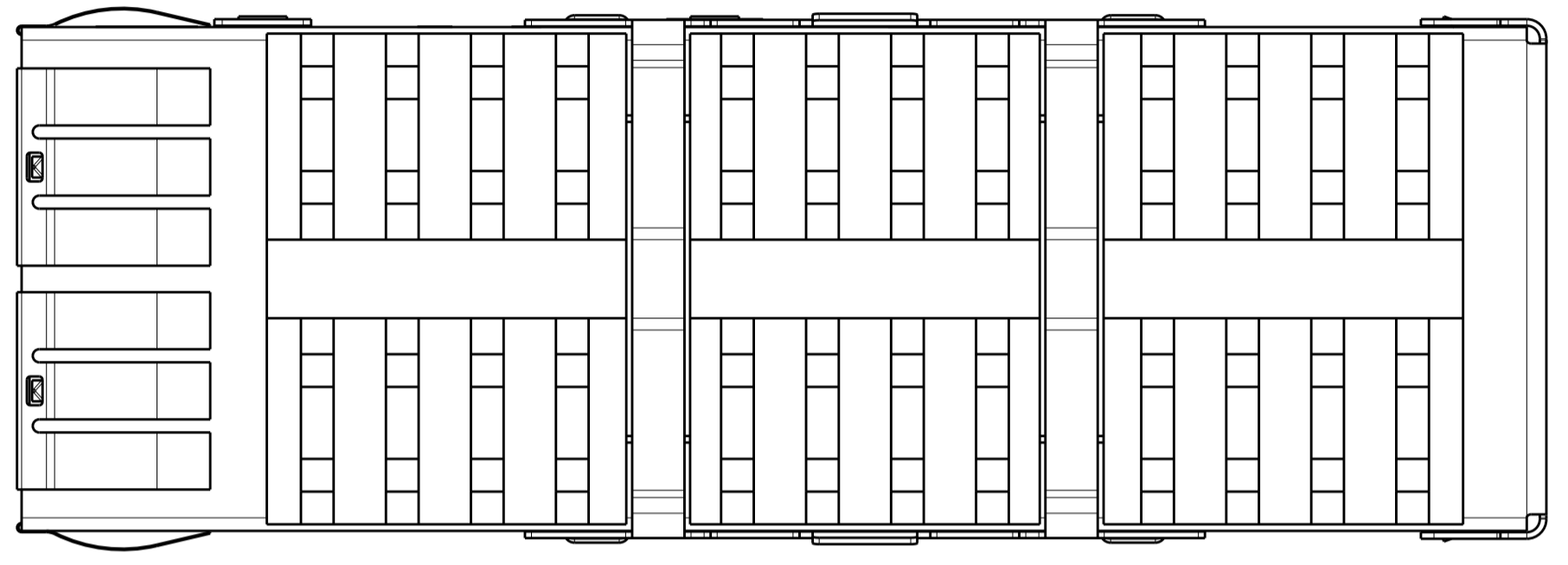

- 1. CAGE MATERIAL: NICKEL SILVER, 0.25 THICK
 HEAT SINK MATERIAL: ALUMINUM
 HEAT SINK CLIP MATERIAL: STAINLESS STEEL
 EMI SPRINGS MATERIAL: COPPER ALLOY
- 2. MINIMUM PITCH DIMENSION.
- 3. MATES WITH QSFP MSA COMPATIBLE TRANSCEIVER.
- 4. REFERENCE APPLICATION SPEC 114-13217 FOR RECOMMENDED DRILL HOLE DIAMETER AND PLATING THICKNESS.
- 5. DATUMS AND BASIC DIMENSIONS ESTABLISHED BY CUSTOMER.
- 6. MINIMUM PC BOARD THICKNESS:
 SINGLE SIDED = 1.45mm (shown, pg. 4)
 DOUBLE SIDED = 2.2mm
- 7. HEATSINK AND CLIP SHIPPED ASSEMBLED TO CAGE ASSEMBLY. CAGE ASSEMBLY MAY BE PRESSED INTO THE PCB AS SHIPPED.
- 8. DATUM **-A-** IS TOP SURFACE OF HOST BOARD.
- 9. SURFACE TRACES PERMITTED WITHIN THIS AREA EXCEPT WHERE CAGE STANDOFFS, SHOWN IN DETAIL J, CONTACT PC BOARD.
- 10. DIMENSION APPLIES WITH MODULE INSTALLED IN THE CAGE.
- 11. DATE CODE MARKED ON TOP OF CAGE AND CONCEALED BY HEAT SINK APPLIES TO CAGE ASSEMBLY ONLY.
- 12. SPRING FINISH: 0.8um MIN TIN OVER 0.8um MIN NICKEL. NON-PLATED EDGES PERMISSIBLE.
 HEAT SINK FINISH: 0.076 um MIN NICKEL.

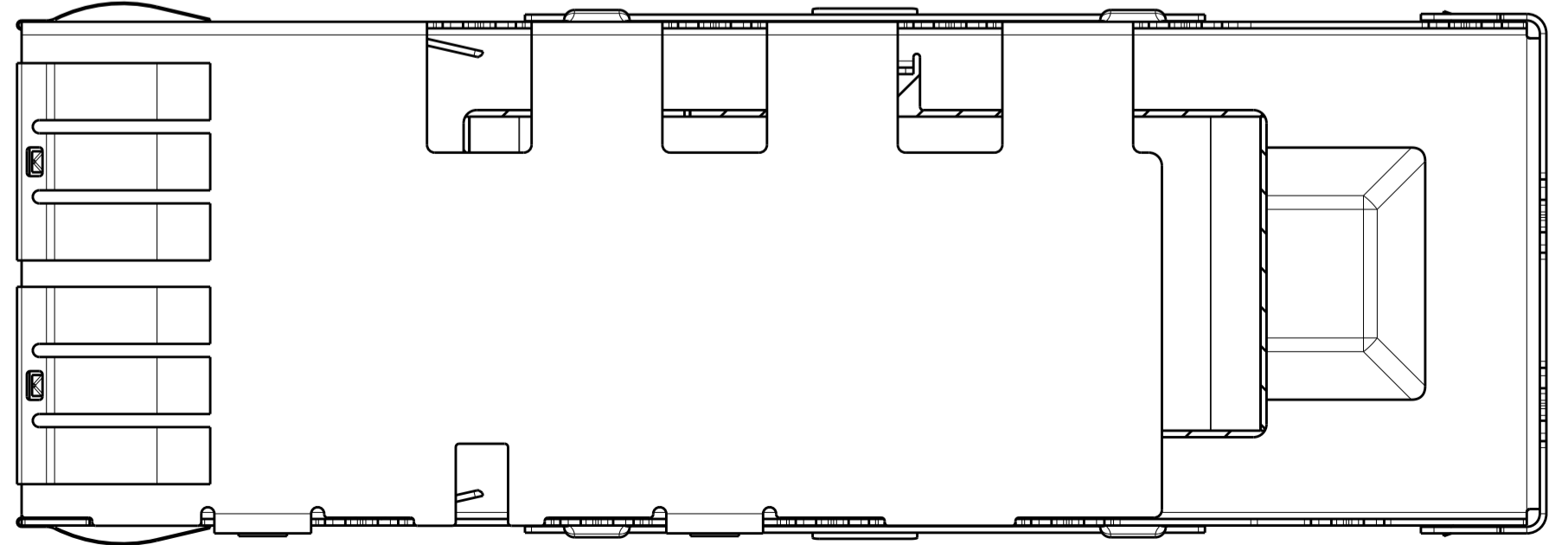
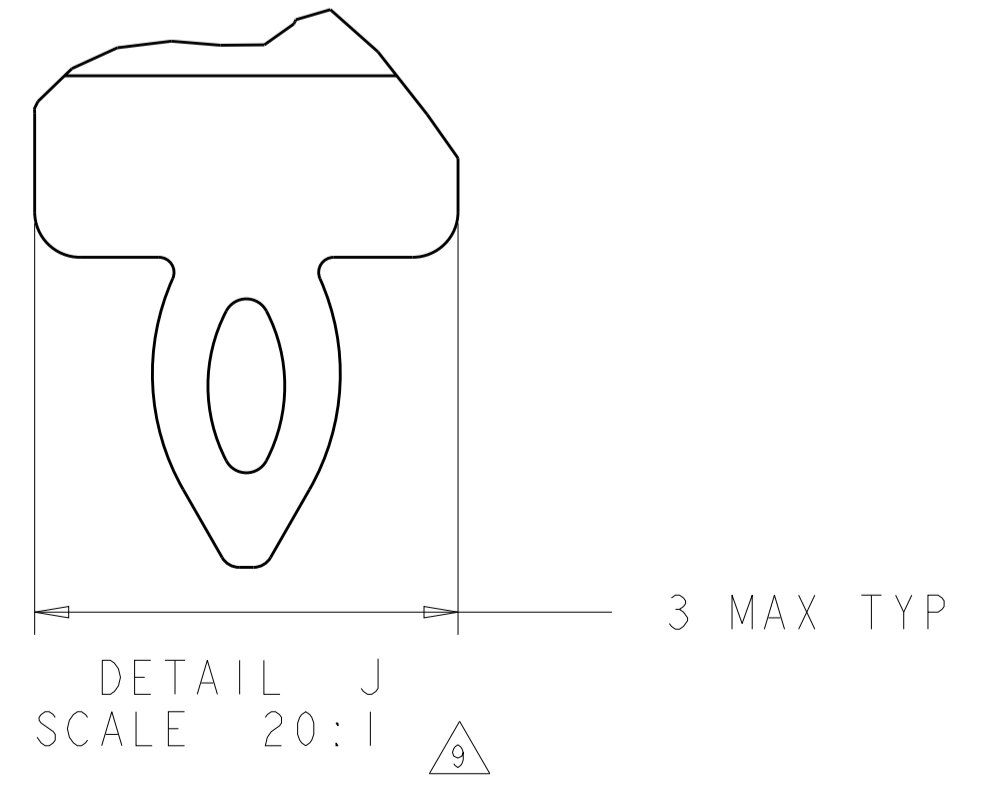
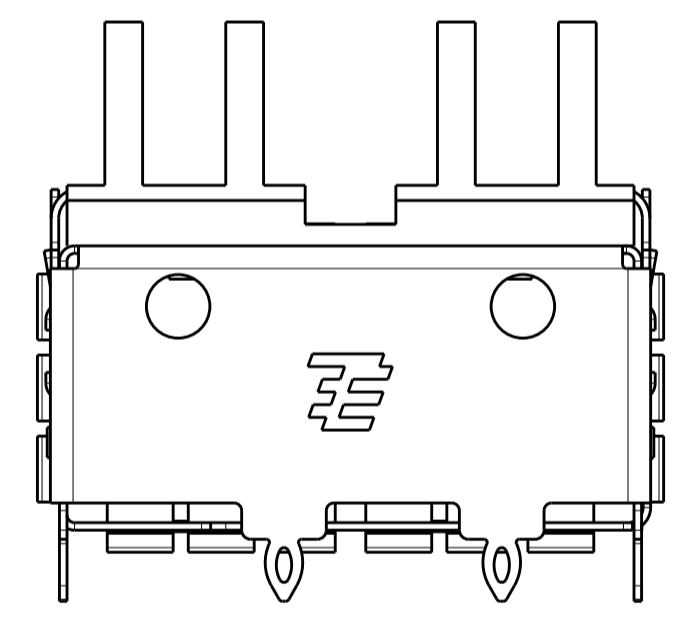
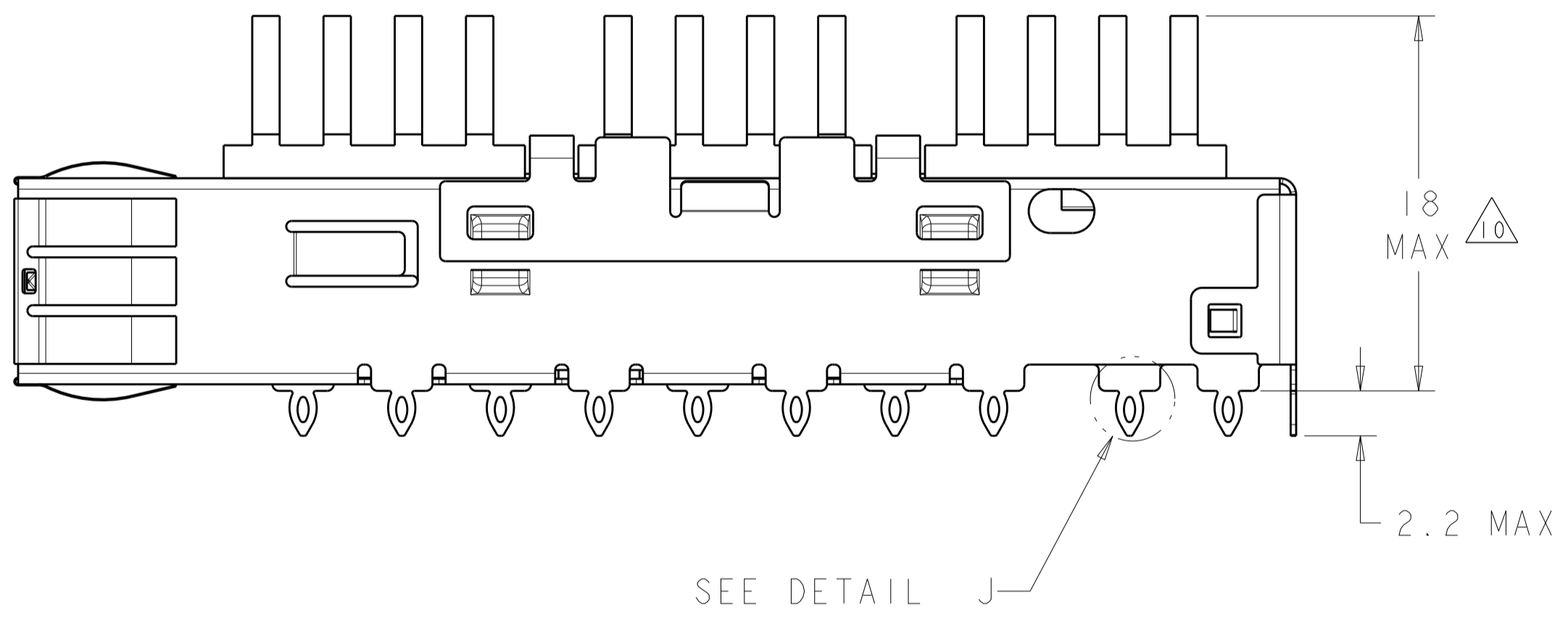
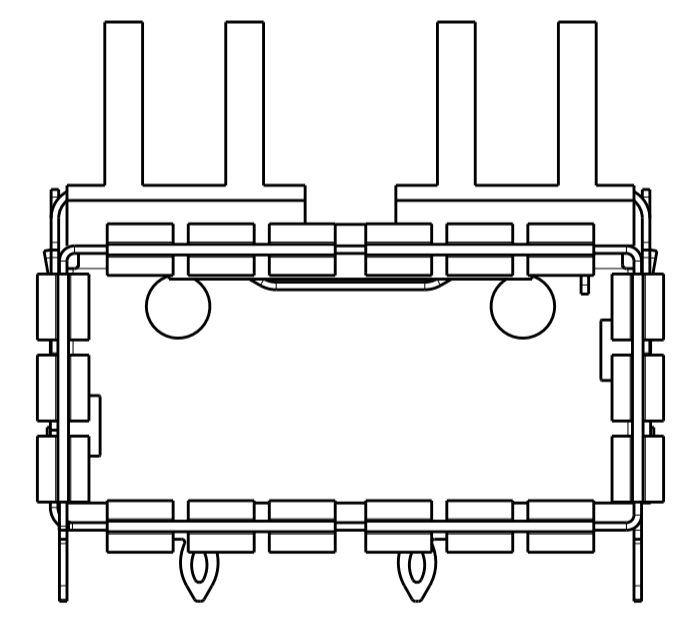

PART NUMBER
2170450-1

THIS PRINT IS
PRELIMINARY
UNQUALIFIED PRODUCT
CONTACT PRODUCT ENGINEERING
BEFORE USING THIS PRINT

THIS DRAWING IS A CONTROLLED DOCUMENT.		DWN: D. ZHU 19SEP2012	TE Connectivity NAME: CAGE ASSEMBLY, THRU BEZEL, QSFP WITH HEAT SINK PRODUCT SPEC: 108-2286 APPLICATION SPEC: 114-13217 SIZE: A1 CAGE CODE: 00779 DRAWING NO: C=2170450 RESTRICTED TO: - WEIGHT: - Customer Drawing
DIMENSIONS:		CHK: J. YANG 19SEP2012	
TOLERANCES UNLESS OTHERWISE SPECIFIED:		APVD: A. CAI 19SEP2012	
mm			
0 PLC	±		SCALE 2:1
1 PLC	±0.25		SHEET 1
2 PLC	±0.13		OF 4
3 PLC	±		REV 1
4 PLC	±		
ANGLES	±		
MATERIAL	FINISH		

LOC	DIST	REVISIONS					
		P.	LTN	DESCRIPTION	DATE	DWN	APVD
GP	00	-	-	SEE SHEET 1	-	-	-

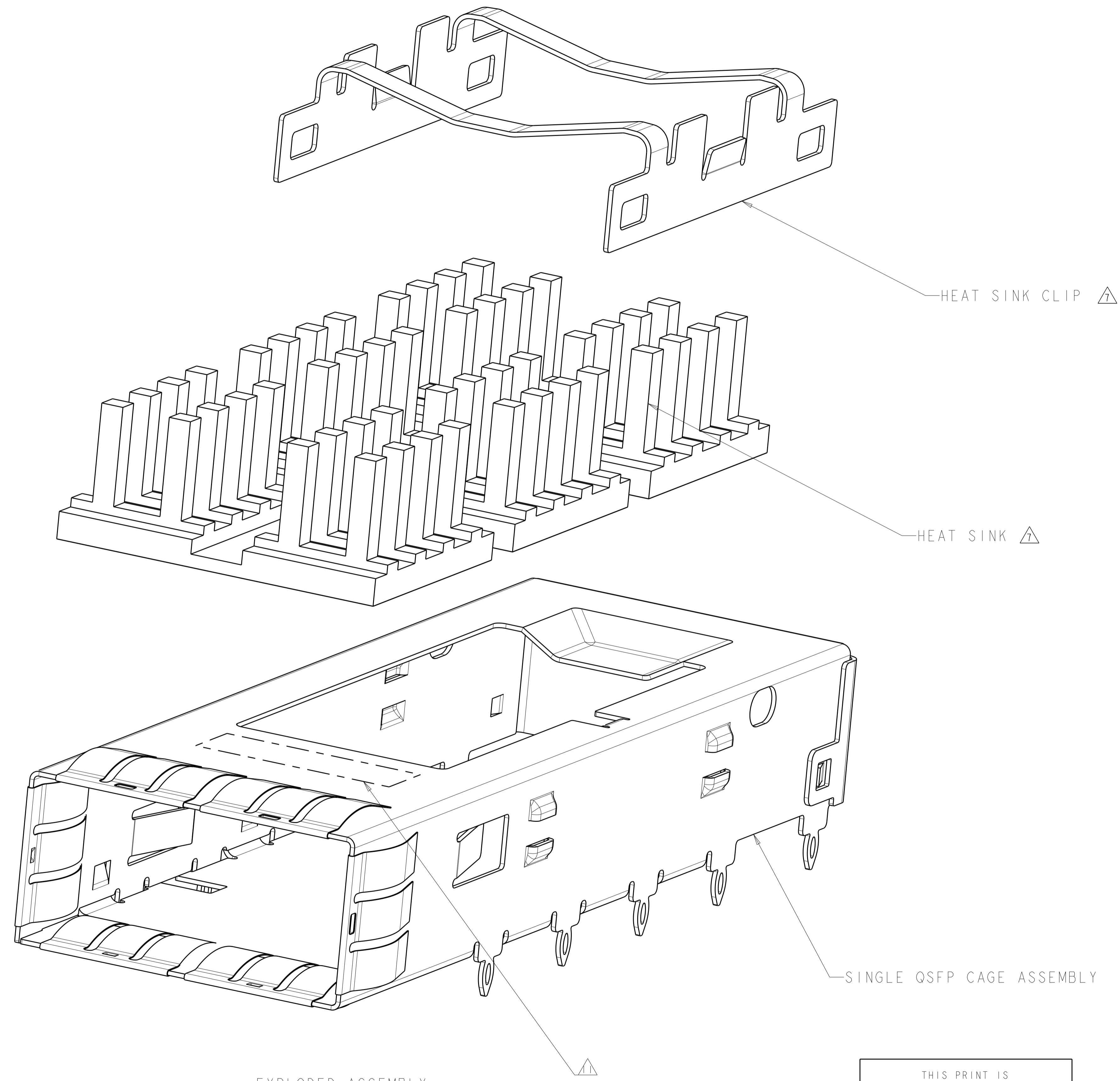

EXPLODED ASSEMBLY
 SCALE 8:1

THIS PRINT IS
PRELIMINARY
 UNQUALIFIED PRODUCT
 CONTACT PRODUCT ENGINEERING
 BEFORE USING THIS PRINT

THIS DRAWING IS A CONTROLLED DOCUMENT.		DWN D. ZHU	19SEP2012	TE Connectivity NAME CAGE ASSEMBLY, THRU BEZEL , QSFP WITH HEAT SINK PRODUCT SPEC 108-2286 APPLICATION SPEC 114-13217 WEIGHT - Customer Drawing	RESTRICTED TO		
DIMENSIONS:		CHK J. YANG	19SEP2012		SIZE	CAGE CODE	DRAWING NO
mm		APVD A. CAI	19SEP2012		A1	00779	C=2170450
0 PLC ± 1 PLC ±0.25 2 PLC ±0.13 3 PLC ± 4 PLC ± ANGLES ± FINISH ±					SCALE	SHEET	OF
MATERIAL				2:1	2	4	REV
							1

THIS DRAWING IS UNPUBLISHED. RELEASED FOR PUBLICATION 2007
 © COPYRIGHT 2007 BY - ALL RIGHTS RESERVED.

LOC	DIST	REVISIONS			
P	LTN	DESCRIPTION	DATE	DMN	APVD
GP	00	SEE SHEET 1	-	-	-

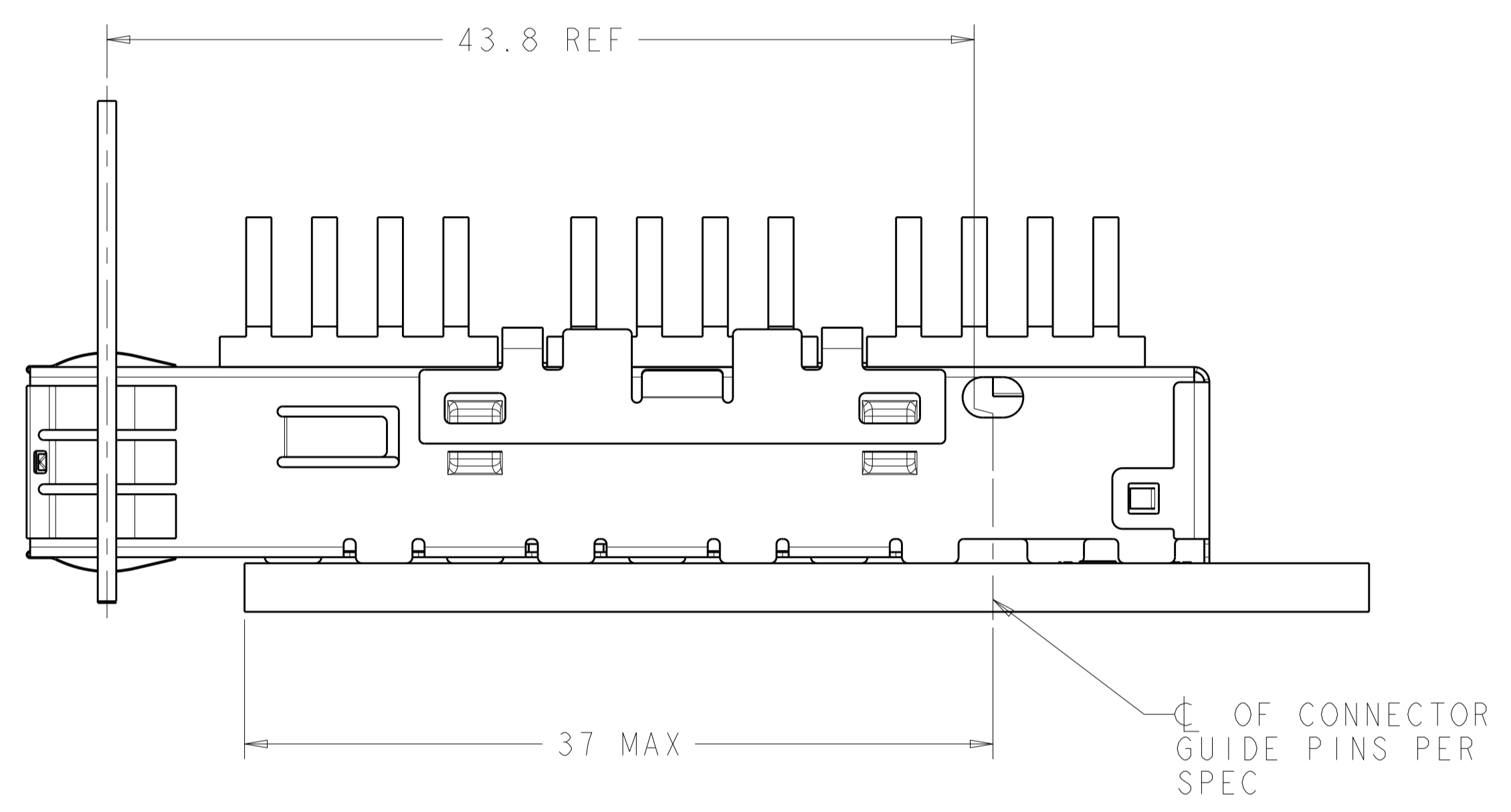
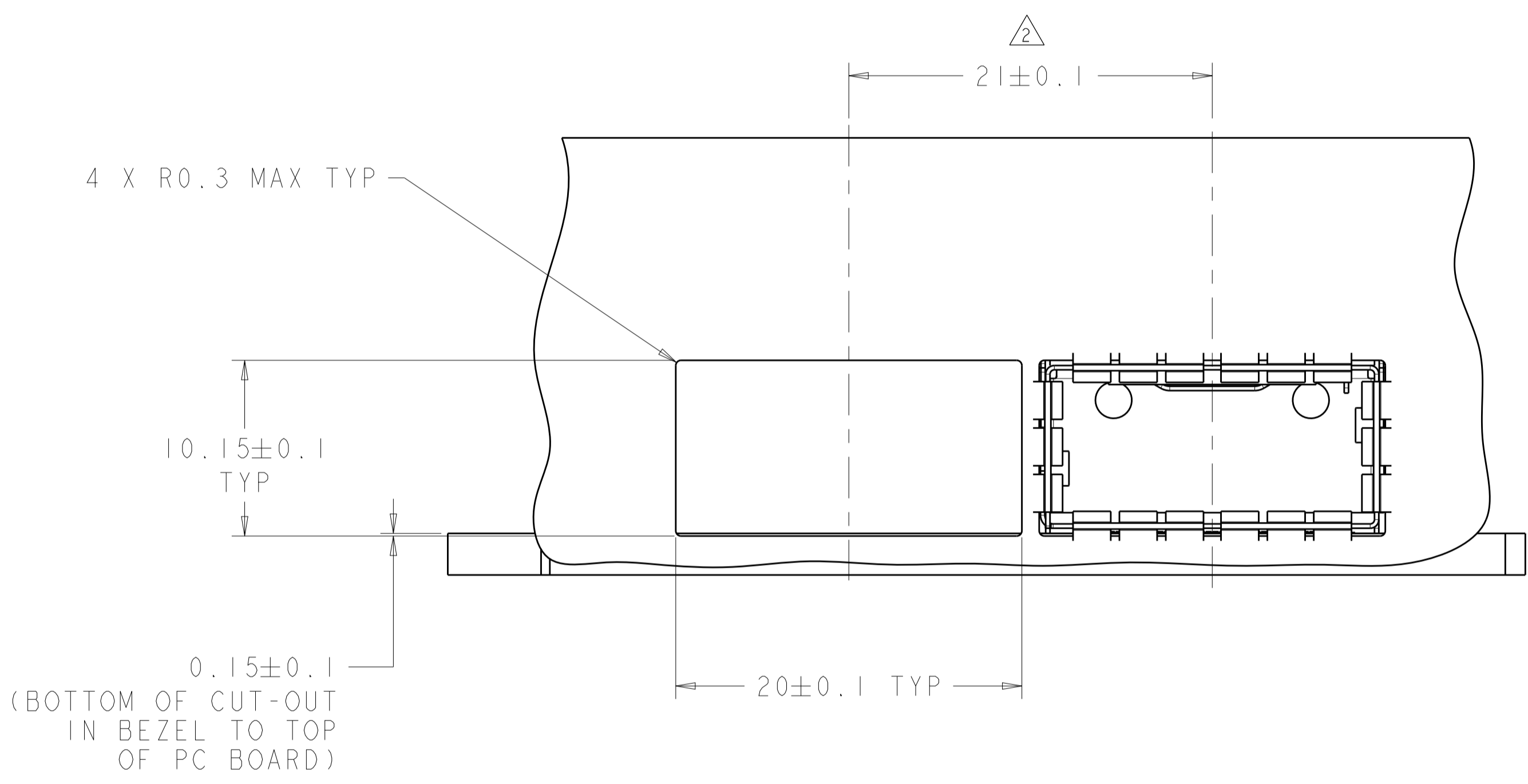

THIS PRINT IS
PRELIMINARY
 UNQUALIFIED PRODUCT
 CONTACT PRODUCT ENGINEERING
 BEFORE USING THIS PRINT

THIS DRAWING IS A CONTROLLED DOCUMENT.		DMN: D. ZHU 19SEP2012	
DIMENSIONS: mm		CHK: J. YANG 19SEP2012	
TOLERANCES UNLESS OTHERWISE SPECIFIED:		APVD: A. CAI 19SEP2012	
0 PLC ± 1 PLC ±0.25 2 PLC ±0.13 3 PLC ± 4 PLC ± ANGLES ±		NAME: CAGE ASSEMBLY, THRU BEZEL, QSPF WITH HEAT SINK	
MATERIAL: -	FINISH: -	PRODUCT SPEC: 108-2286	SIZE: A1
		APPLICATION SPEC: 114-13217	CAGE CODE: 00779
		WEIGHT: -	DRAWING NO: 2170450
		Customer Drawing	RESTRICTED TO: -
		SCALE: 2:1	SHEET 3 OF 4
			REV 1

LOC	DIST	REV	DATE	BY	APPD
GP	00				

REVISIONS			
NO.	DESCRIPTION	DATE	BY
1	SEE SHEET 1	-	-

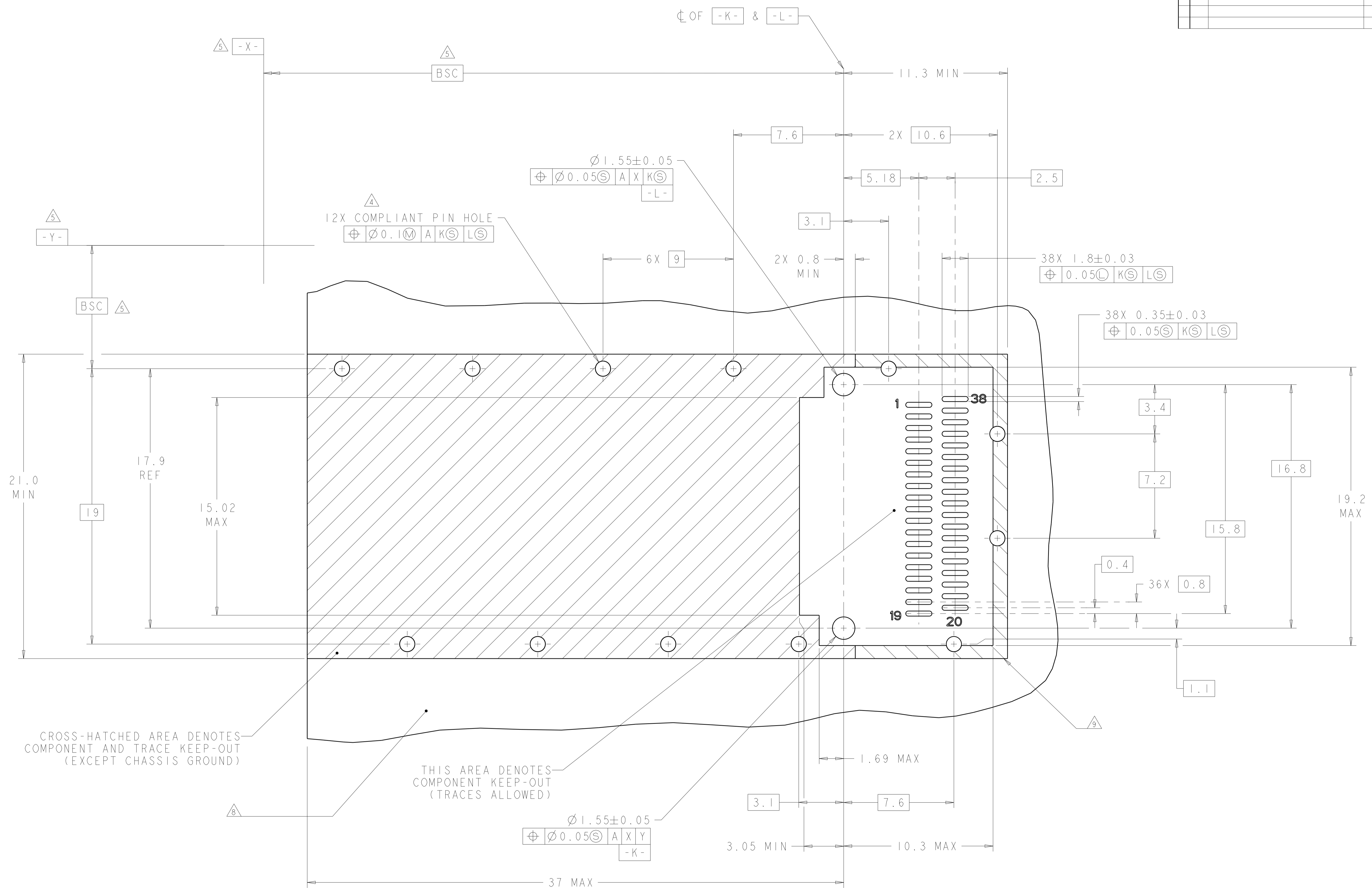

RECOMMENDED PCB LAYOUT
 SCALE 8:1

THIS PRINT IS
PRELIMINARY
 UNQUALIFIED PRODUCT
 CONTACT PRODUCT ENGINEERING
 BEFORE USING THIS PRINT

THIS DRAWING IS A CONTROLLED DOCUMENT.		OWN: D. ZHU 19SEP2012	TE Connectivity NAME: CAGE ASSEMBLY, THRU BEZEL, QSPF WITH HEAT SINK PRODUCT SPEC: 108-2286 APPLICATION SPEC: 114-13217 WEIGHT: - Customer Drawing
DIMENSIONS: mm		CHK: J. YANG 19SEP2012	
TOLERANCES UNLESS OTHERWISE SPECIFIED:		APVD: A. CAL 19SEP2012	
0 PLC ±0.25 1 PLC ±0.13 2 PLC ±0.13 3 PLC ±0.13 4 PLC ±0.13 ANGLES ±0.13		SIZE: A1 CAGE CODE: 00779 DRAWING NO: C=2170450 RESTRICTED TO: - SCALE: 2:1 SHEET 4 OF 4 REV 1	