



Chipsmall Limited consists of a professional team with an average of over 10 year of expertise in the distribution of electronic components. Based in Hongkong, we have already established firm and mutual-benefit business relationships with customers from,Europe,America and south Asia,supplying obsolete and hard-to-find components to meet their specific needs.

With the principle of “Quality Parts,Customers Priority,Honest Operation,and Considerate Service”,our business mainly focus on the distribution of electronic components. Line cards we deal with include Microchip,ALPS,ROHM,Xilinx,Pulse,ON,Everlight and Freescale. Main products comprise IC,Modules,Potentiometer,IC Socket,Relay,Connector.Our parts cover such applications as commercial,industrial, and automotives areas.

We are looking forward to setting up business relationship with you and hope to provide you with the best service and solution. Let us make a better world for our industry!



## Contact us

Tel: +86-755-8981 8866 Fax: +86-755-8427 6832

Email & Skype: info@chipsmall.com Web: www.chipsmall.com

Address: A1208, Overseas Decoration Building, #122 Zhenhua RD., Futian, Shenzhen, China



THIS DRAWING IS UNPUBLISHED. RELEASED FOR PUBLICATION 20  
 © COPYRIGHT 20 BY - ALL RIGHTS RESERVED.

| LOC | DIST | REVISIONS |     |             |           |     |      |
|-----|------|-----------|-----|-------------|-----------|-----|------|
| GP  | 00   | P         | LTR | DESCRIPTION | DATE      | DWN | APVD |
|     |      |           | A   | RELEASE     | 31DEC2015 | JY  | SH   |
|     |      |           |     |             |           |     |      |

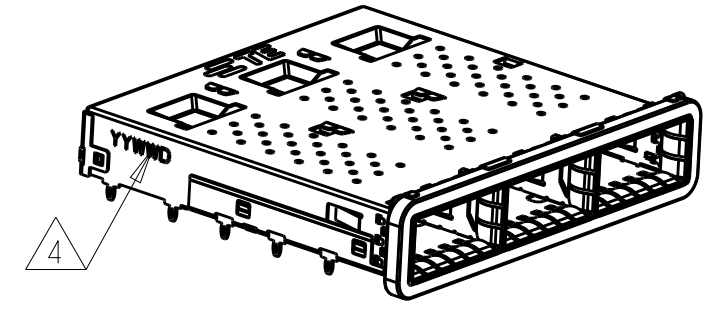

2170767-1 AS SHOWN

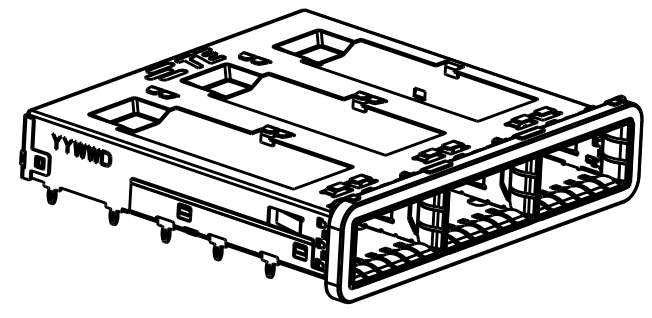

2170767-2 AS SHOWN

- COMPONENTS  
 CAGE ASSEMBLY: NICKEL-SILVER ALLOY  
 EMI GASKET: CONDUCTIVE RUBBER
- REFERENCE APPLICATION SPECIFICATION 114-32023 FOR RECOMMENDED DRILL HOLE DIAMETER AND PLATING THICKNESS
- DATUM AND BASIC DIMENSION ESTABLISHED BY CUSTOMER
- DATE CODE (YYWWD) MARKED APPROXIMATELY AS SHOWN.
- MATES WITH QSFP28 MSA COMPATIBLE TRANSCEIVER.
- MINIMUM PC BOARD THICKNESS:  
 SINGLE SIDED: 1.57 MIN  
 DOUBLE SIDED: 3.00 MIN
- DATUM -A- IS TOP SURFACE OF THE HOST BOARD.
- THESE HOLES ARE OPTIONAL WHEN THE REAR PINS ARE REMOVED.

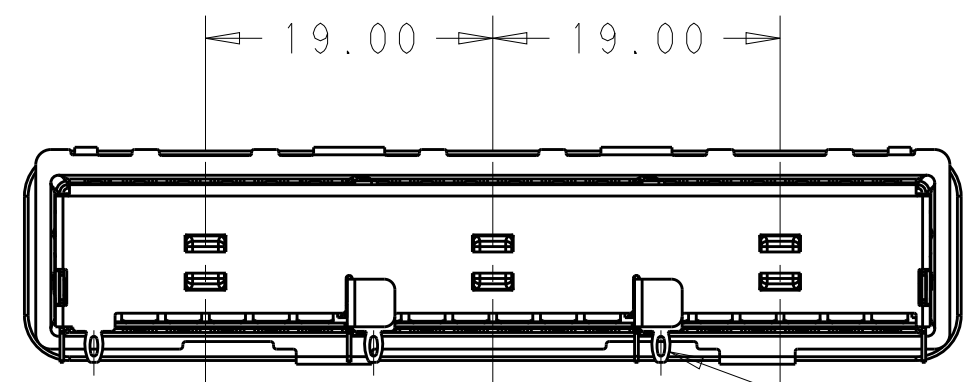
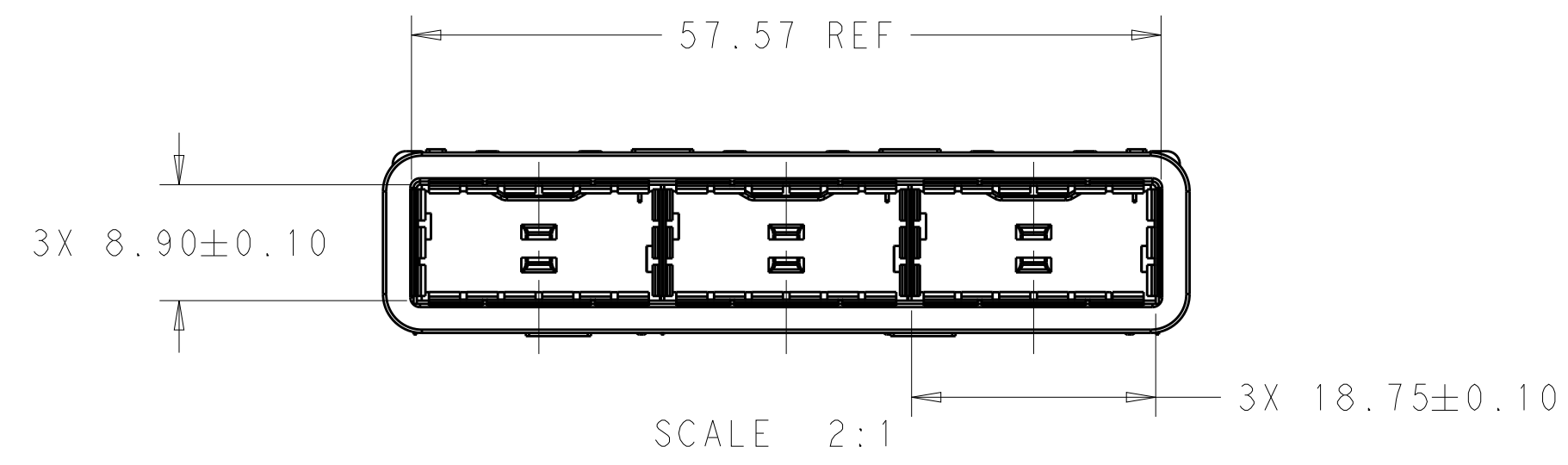

19.00 19.00 18.50 7.88 REAR PIN OPTIONAL

VIEW V-V

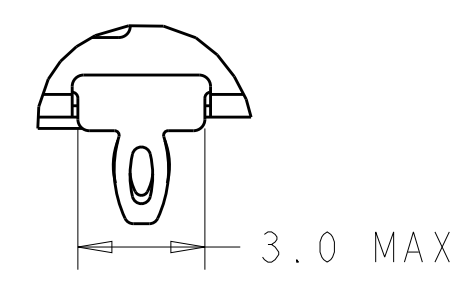
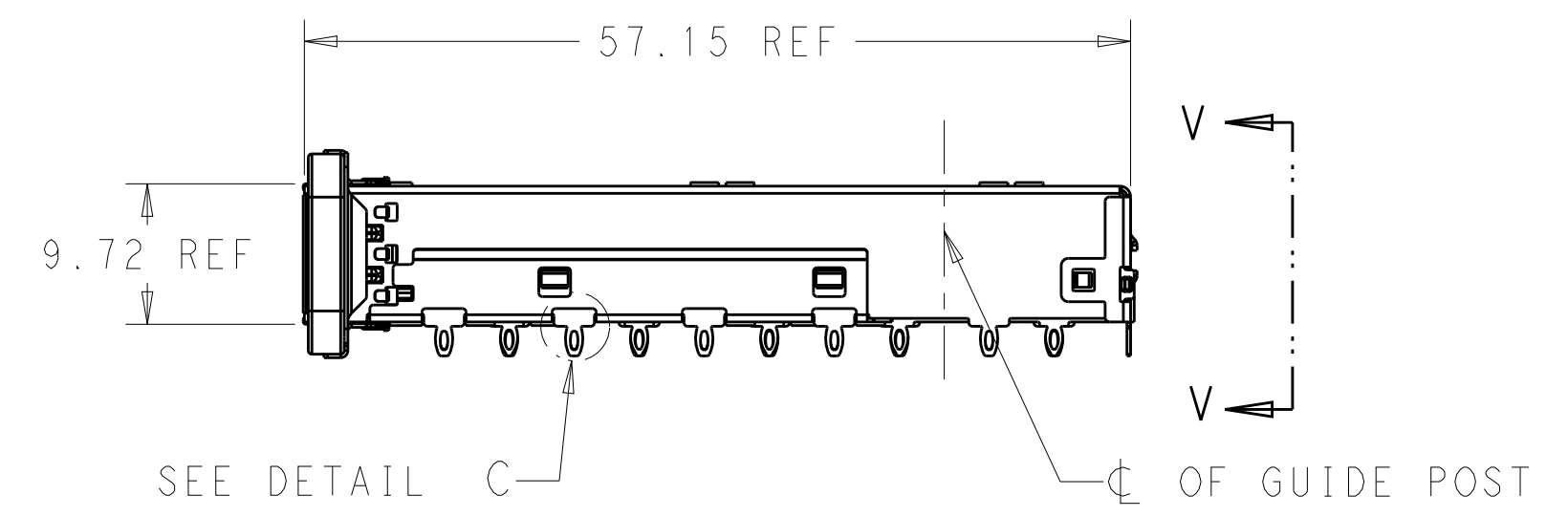

DETAIL C SCALE 6:1

|                   |                         |             |
|-------------------|-------------------------|-------------|
| WITHOUT           | WITH                    | 2170767-5   |
| WITHOUT           | WITHOUT                 | 2170767-4   |
| WITH              | WITH                    | 2170767-2   |
| WITH              | WITHOUT                 | 2170767-1   |
| REAR PIN OPTIONAL | HEAT SINK OPEN OPTIONAL | PART NUMBER |

|  |  |                            |   |  |
|--|--|----------------------------|---|--|
| THIS DRAWING IS A CONTROLLED DOCUMENT. |  | DWN BING LIU 18APR2014     | TE Connectivity                                       |  |
| DIMENSIONS: mm                         |  | CHK JASON YANG 18APR2014   |   |  |
| TOLERANCES UNLESS OTHERWISE SPECIFIED: |  | APVD SEAN HAN 31DEC2015    | NAME RECEPTACLE CAGE ASSEMBLY THRU BEZEL, 1X3, QSFP28 |  |
| 0 PLC ±-                               |  | PRODUCT SPEC 108-19428     | SIZE CAGE CODE DRAWING NO RESTRICTED TO               |  |
| 1 PLC ±0.25                            |  | APPLICATION SPEC 114-32023 | A200779 C-2170767                                     |  |
| 2 PLC ±0.2                             |  | WEIGHT -                   | SCALE 1:1 SHEET 1 OF 5 REV A                          |  |
| 3 PLC ±-                               |  | CUSTOMER DRAWING           |   |  |
| 4 PLC ±-                               |  |                            |   |  |
| ANGLES ±-                              |  |                            |   |  |
| FINISH ±-                              |  |                            |   |  |
| SEE NOTES                              |  | SEE NOTES                  |   |  |

THIS DRAWING IS UNPUBLISHED. RELEASED FOR PUBLICATION 20  
 © COPYRIGHT 20 BY - ALL RIGHTS RESERVED.

| LOC |     | DIST        |      | REVISIONS |      |  |  |
|-----|-----|-------------|------|-----------|------|--|--|
| P   | LTR | DESCRIPTION | DATE | DWN       | APVD |  |  |
| -   |     | SEE SHEET 1 | -    | -         | -    |  |  |
|     |     |             |      |           |      |  |  |
|     |     |             |      |           |      |  |  |

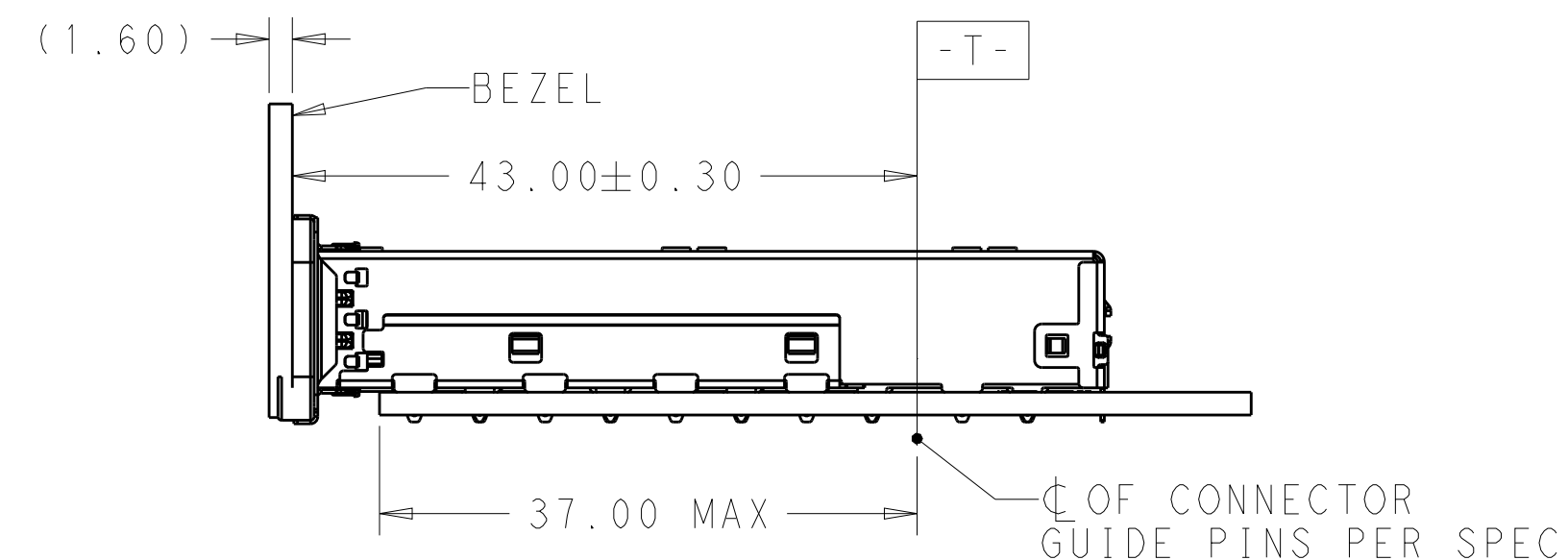
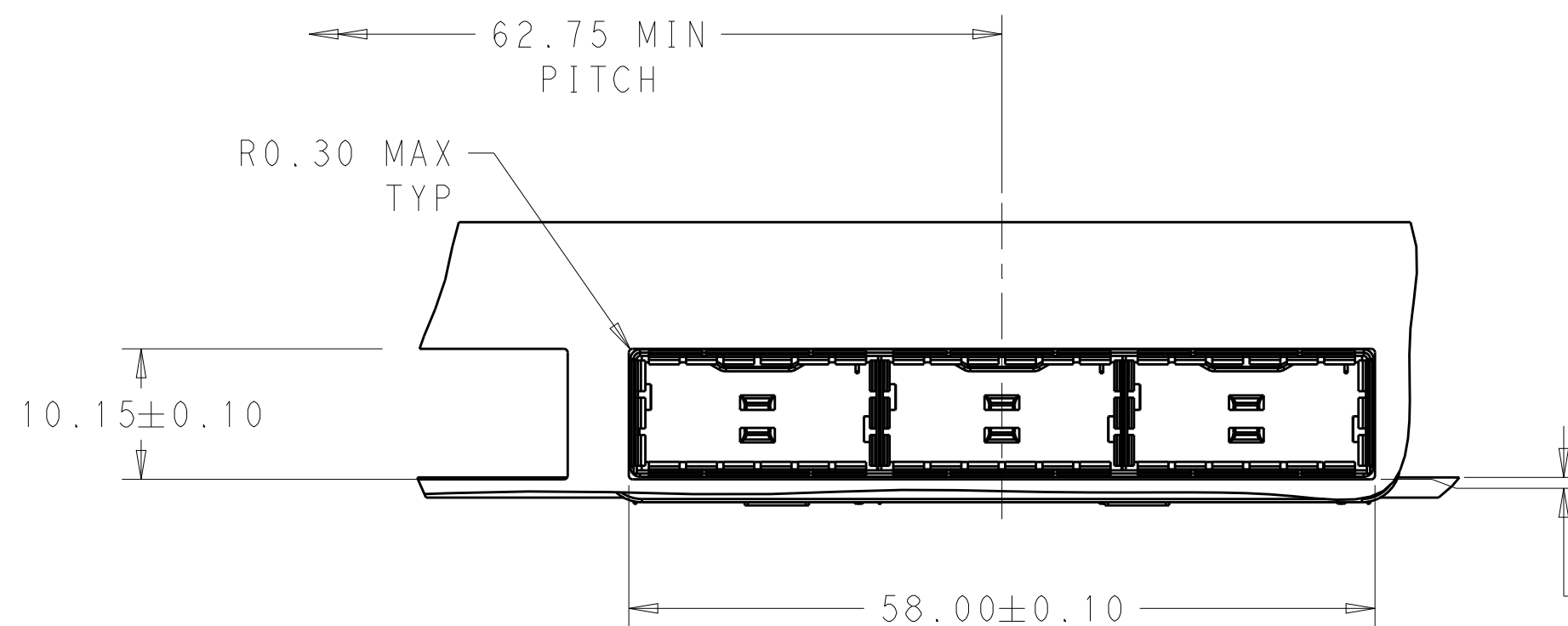

SINGLE SIDE MOUNTING  
 SCALE 2:1

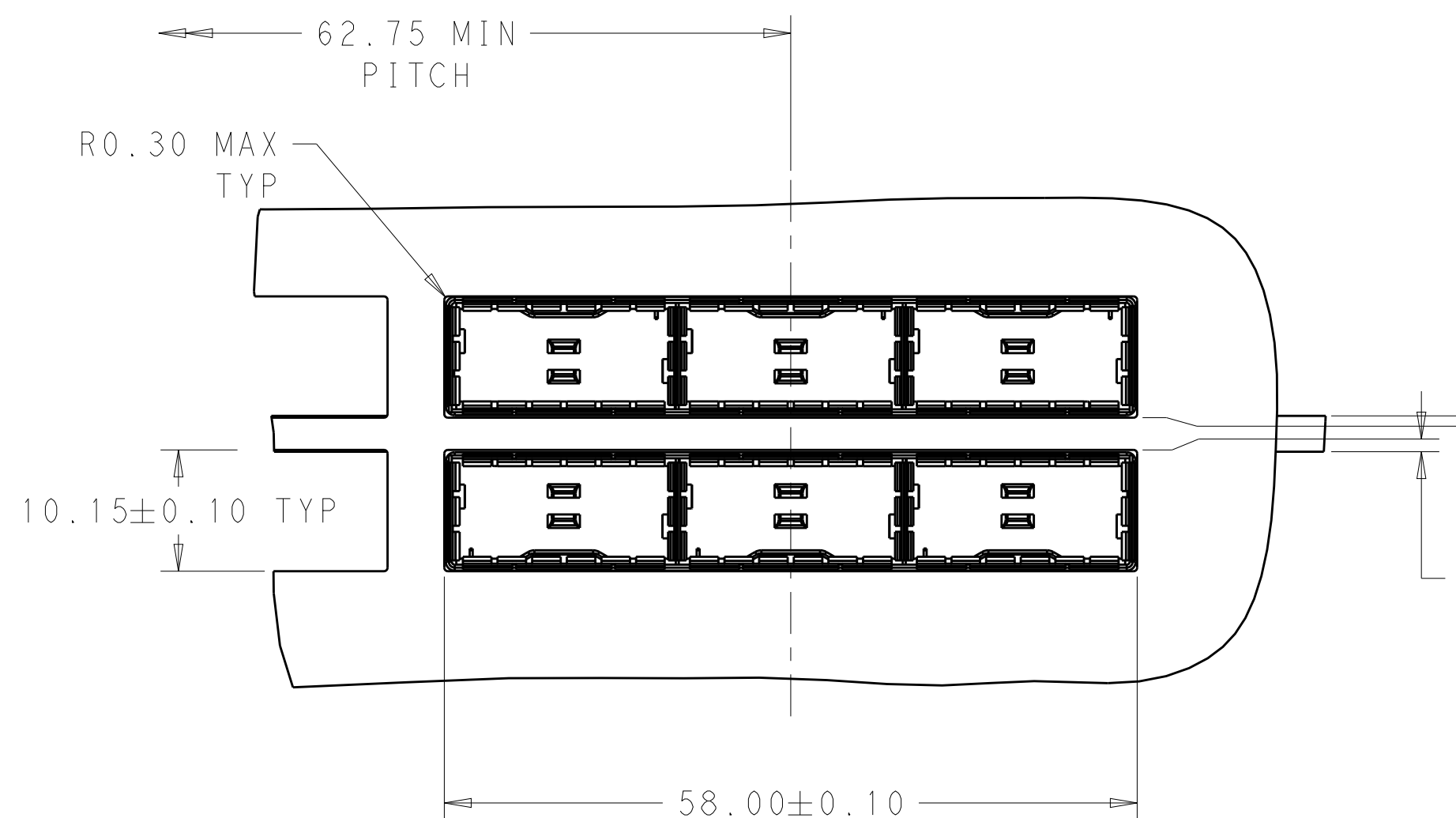

0.15±0.10 (BOTTOM OF CUT-OUT IN BEZEL TO TOP PCB)  
 0.15±0.10 (TOP OF CUT-OUT IN BEZEL TO BOTTOM PCB)

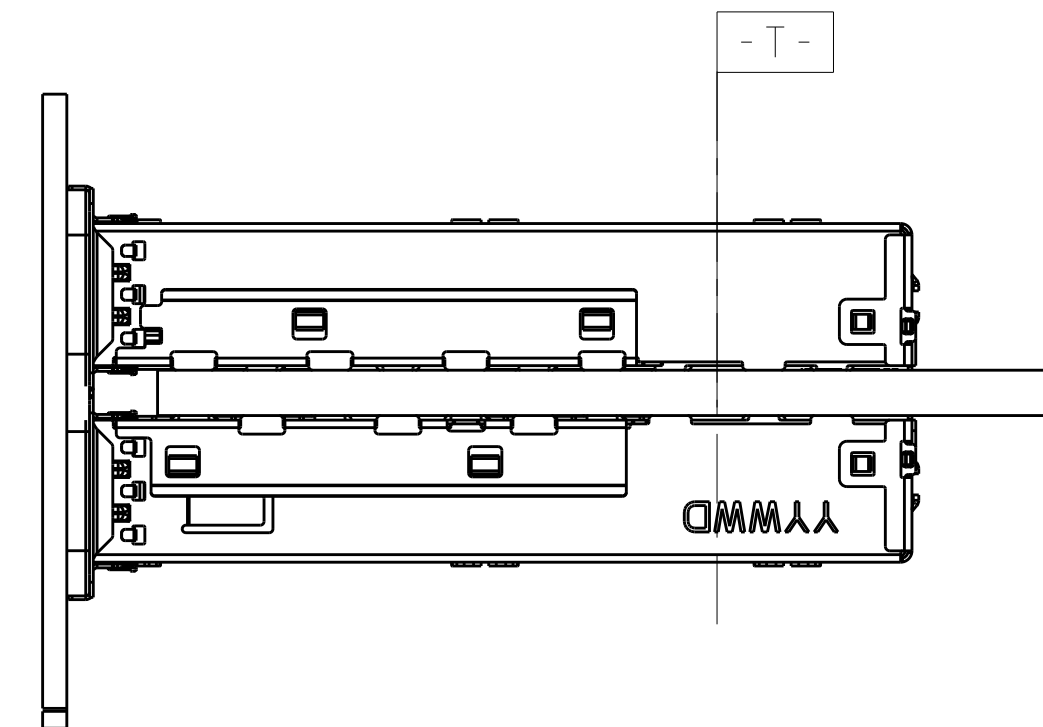

BELLY TO BELLY MOUNTING  
 SCALE 2:1

|  |                         |                            |   |  |
|--|-------------------------|----------------------------|---|--|
| THIS DRAWING IS A CONTROLLED DOCUMENT. |                         | DWN BING LIU 18APR2014     | <b>STE</b> TE Connectivity                            |  |
|  |                         | CHK JASON YANG 18APR2014   |   |  |
| DIMENSIONS: mm                         |                         | APVD SEAN HAN 31DEC2015    | NAME RECEPTACLE CAGE ASSEMBLY THRU BEZEL, 1X3, QSFP28 |  |
| TOLERANCES UNLESS OTHERWISE SPECIFIED: |                         | PRODUCT SPEC 108-19428     | SIZE CAGE CODE DRAWING NO RESTRICTED TO               |  |
| 0 PLC ±                                |                         | APPLICATION SPEC 114-32023 | A200779 C-2170767                                     |  |
| 1 PLC ±0.25                            |                         | WEIGHT -                   | SCALE 1:1 SHEET 2 OF 5 REV A                          |  |
| 2 PLC ±0.2                             |                         | CUSTOMER DRAWING           |   |  |
| 3 PLC ±                                |                         |                            |   |  |
| 4 PLC ±                                |                         |                            |   |  |
| ANGLES ±                               |                         |                            |   |  |
| FINISH                                 |                         |                            |   |  |
| MATERIAL SEE NOTES material_2          | SEE NOTES finish_spec_2 |                            |   |  |

THIS DRAWING IS UNPUBLISHED. RELEASED FOR PUBLICATION 20  
 © COPYRIGHT 20 BY - ALL RIGHTS RESERVED.

| LOC | DIST | REVISIONS   |      |     |      |
|-----|------|-------------|------|-----|------|
| P   | LTR  | DESCRIPTION | DATE | DWN | APVD |
| -   | -    | SEE SHEET 1 | -    | -   | -    |
|     |      |             |      |     |      |
|     |      |             |      |     |      |

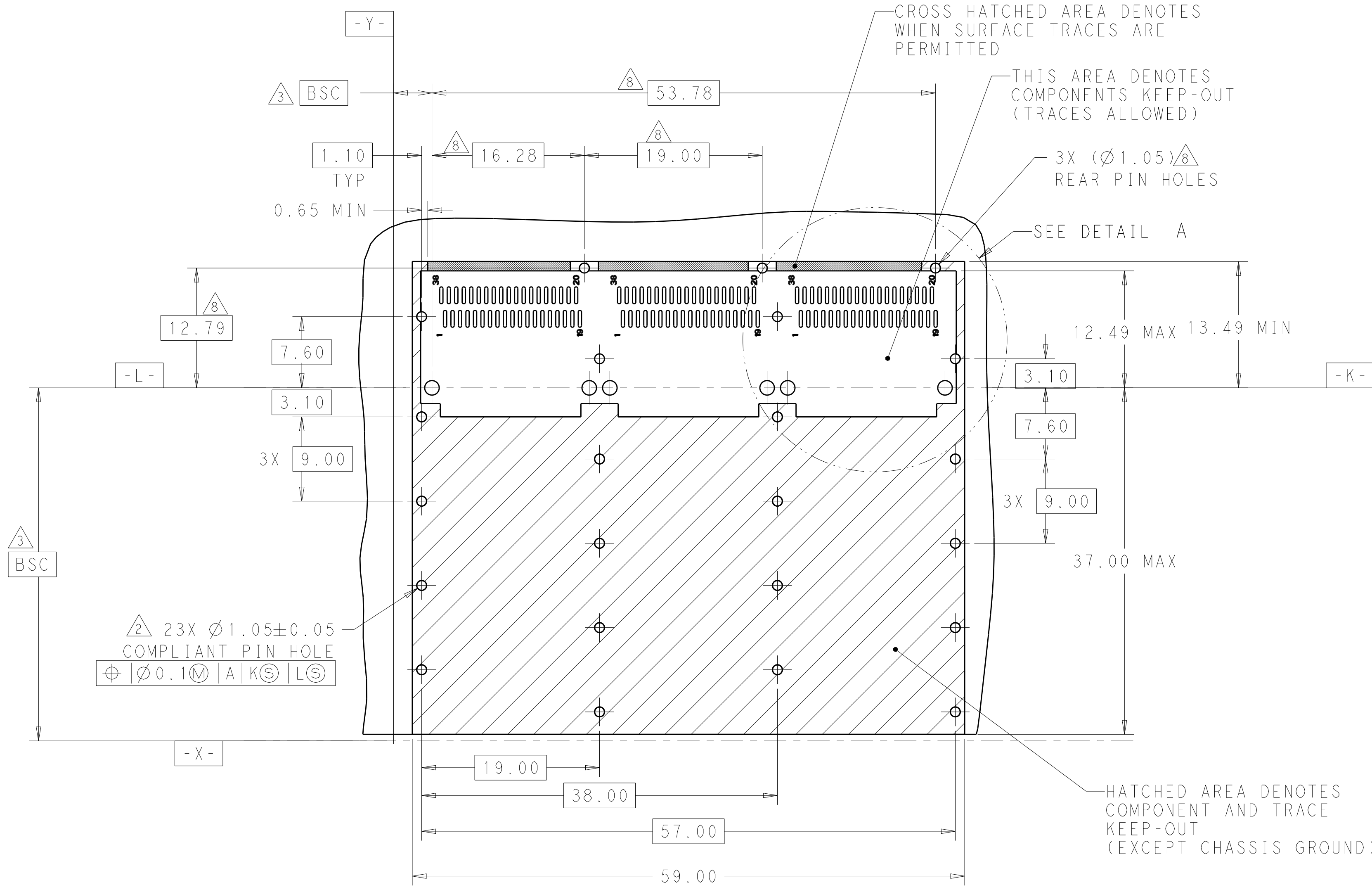

2 23X  $\varnothing 1.05 \pm 0.05$   
 COMPLIANT PIN HOLE  
 $\varnothing 0.1$  M A K S L S

RECOMMENDED PCB LAYOUT  
 SINGLE TYPE  
 PCB TOLERANCE:  $\pm 0.05$   
 SCALE 3:1

|  |  |                                |   |                         |
|--|--|--------------------------------|---|-------------------------|
| THIS DRAWING IS A CONTROLLED DOCUMENT.   |  | DWN<br>BING LIU<br>18APR2014   | TE Connectivity   |                         |
| DIMENSIONS:<br>mm  |  | CHK<br>JASON YANG<br>18APR2014 |   |                         |
| TOLERANCES UNLESS OTHERWISE SPECIFIED:<br>0 PLC $\pm$<br>1 PLC $\pm 0.25$<br>2 PLC $\pm 0.2$<br>3 PLC $\pm$<br>4 PLC $\pm$<br>ANGLES $\pm$ |  | APVD<br>SEAN HAN<br>31DEC2015  | NAME<br>RECEPTACLE CAGE ASSEMBLY<br>THRU BEZEL, 1X3, QSFP28 |                         |
| MATERIAL<br>SEE NOTES<br>material_2  |  | PRODUCT SPEC<br>108-19428      | SIZE<br>A200779   | DRAWING NO<br>C-2170767 |
| FINISH<br>SEE NOTES<br>finish_spec_2   |  | APPLICATION SPEC<br>114-32023  | RESTRICTED TO<br>-  | SCALE 1:1               |
| CUSTOMER DRAWING   |  | WEIGHT<br>-                    | SHEET 3 OF 5  |                         |
|  |  | REV A                          |   |                         |



THIS DRAWING IS UNPUBLISHED. RELEASED FOR PUBLICATION 20  
 © COPYRIGHT 20 BY - ALL RIGHTS RESERVED.

| LOC | DIST | REVISIONS   |      |     |      |
|-----|------|-------------|------|-----|------|
| P   | LTR  | DESCRIPTION | DATE | DWN | APVD |
| -   | -    | SEE SHEET 1 | -    | -   | -    |
|     |      |             |      |     |      |
|     |      |             |      |     |      |

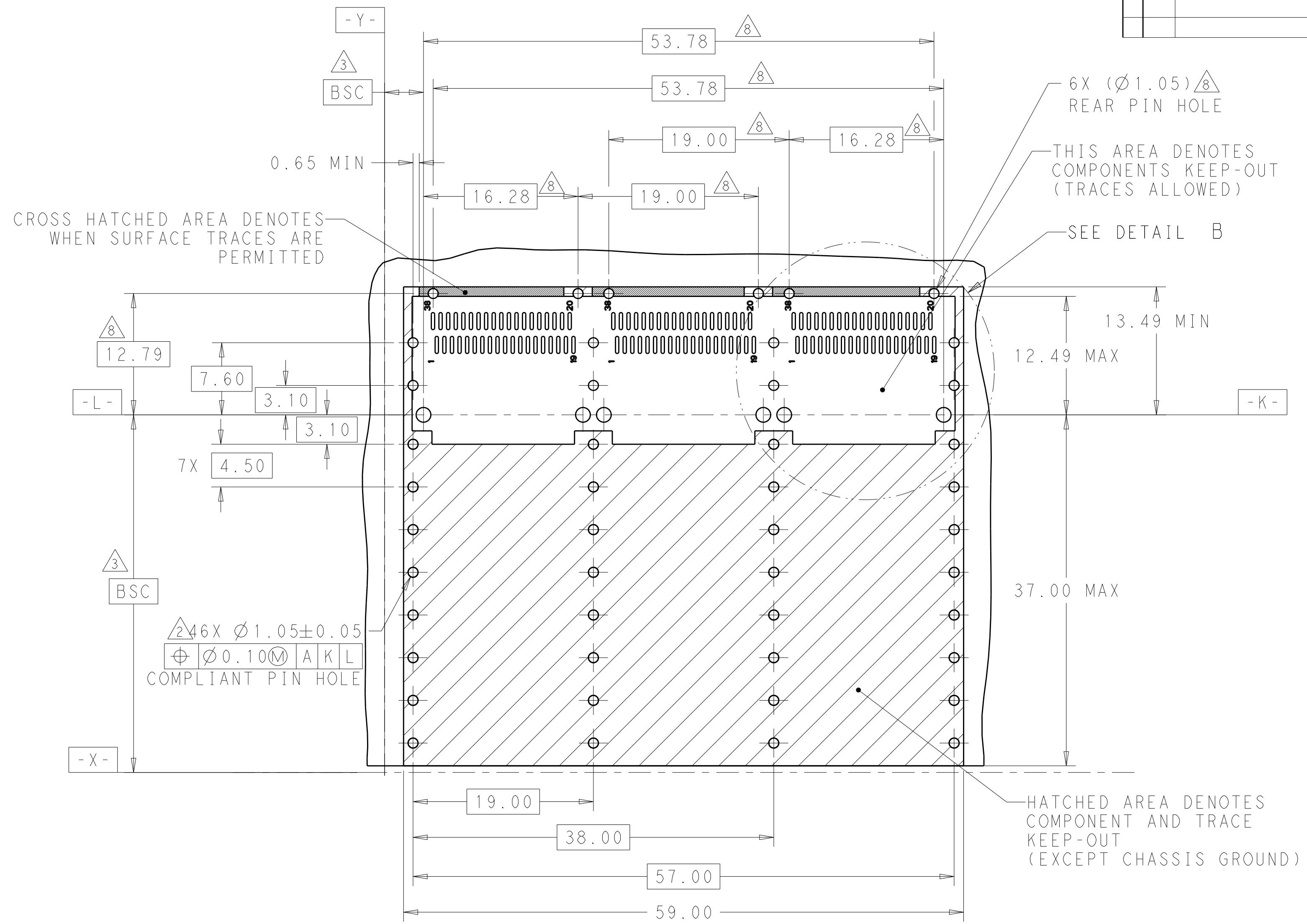

246X Ø1.05±0.05  
 Ø0.10 A K L  
 COMPLIANT PIN HOLE

RECOMMENDED PCB LAYOUT  
 BELLY TO BELLY TYPE  
 PCB TOLERANCE: ±0.05  
 SCALE 3:1

|  |  |                                      |   |                        |
|--|--|--------------------------------------|---|------------------------|
| THIS DRAWING IS A CONTROLLED DOCUMENT.                                 |  | DWN<br>BING LIU<br>18APR2014         | TE Connectivity   |                        |
| DIMENSIONS:<br>mm  |  | CHK<br>JASON YANG<br>18APR2014       |   |                        |
| TOLERANCES UNLESS OTHERWISE SPECIFIED:                                 |  | APVD<br>SEAN HAN<br>31DEC2015        | NAME<br>RECEPTACLE CAGE ASSEMBLY<br>THRU BEZEL, 1X3, QSFP28 |                        |
| 0 PLC ±<br>1 PLC ±0.25<br>2 PLC ±0.2<br>3 PLC ±<br>4 PLC ±<br>ANGLES ± |  | PRODUCT SPEC<br>108-19428            | SIZE<br>A200779   | CAGE CODE<br>C-2170767 |
| MATERIAL<br>SEE NOTES<br>material_2                                    |  | FINISH<br>SEE NOTES<br>finish_spec_2 | APPLICATION SPEC<br>114-32023                               | DRAWING NO<br>-        |
|  |  | WEIGHT<br>-                          | RESTRICTED TO<br>-  | SCALE 1:1              |
|  |  | CUSTOMER DRAWING                     | SHEET 4 OF 5  | REV A                  |

THIS DRAWING IS UNPUBLISHED. RELEASED FOR PUBLICATION 20  
 © COPYRIGHT 20 BY - ALL RIGHTS RESERVED.

| LOC | DIST | REVISIONS   |      |     |      |
|-----|------|-------------|------|-----|------|
| P   | LTR  | DESCRIPTION | DATE | DWN | APVD |
| -   | -    | SEE SHEET 1 | -    | -   | -    |

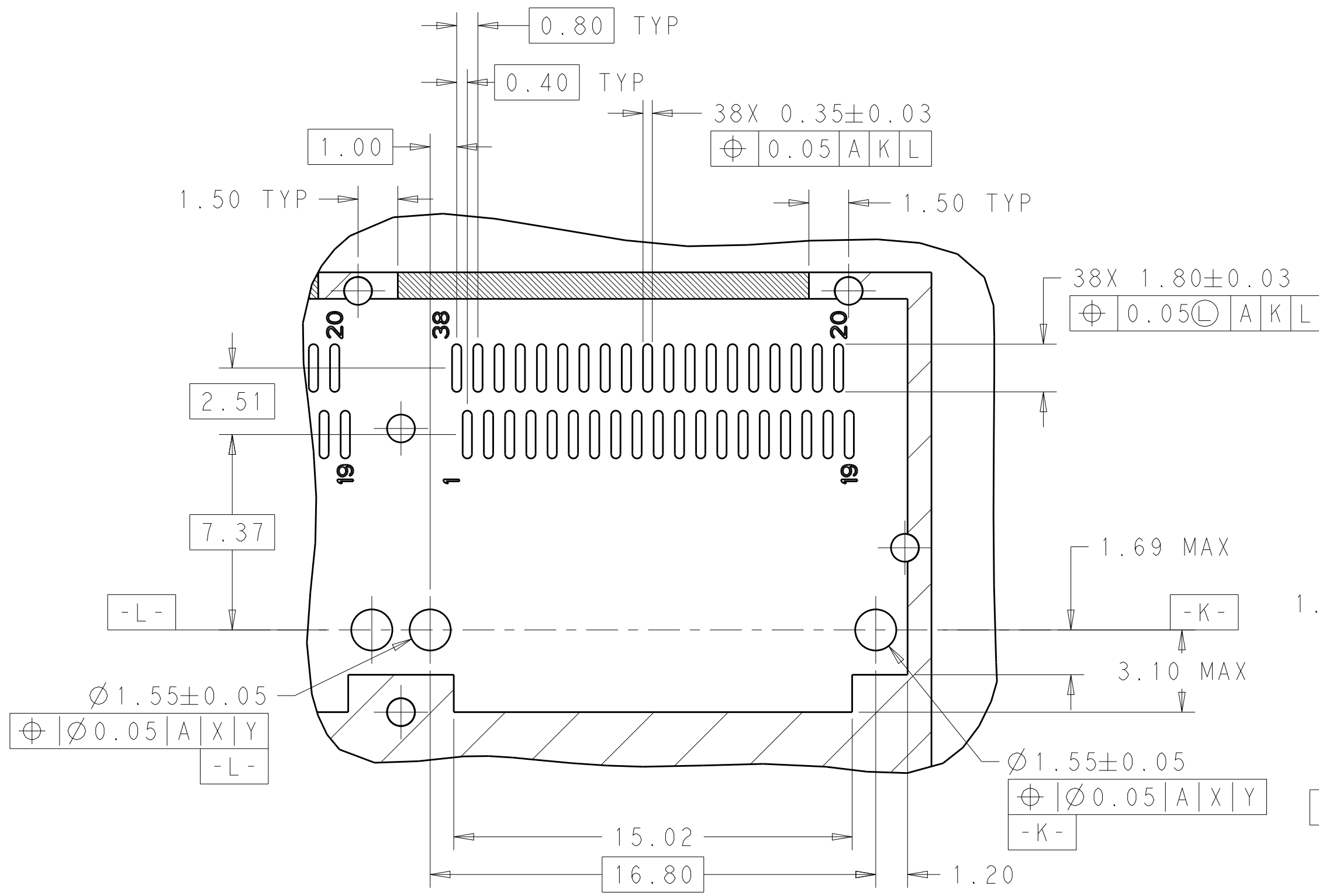

DETAIL A  
SCALE 6:1

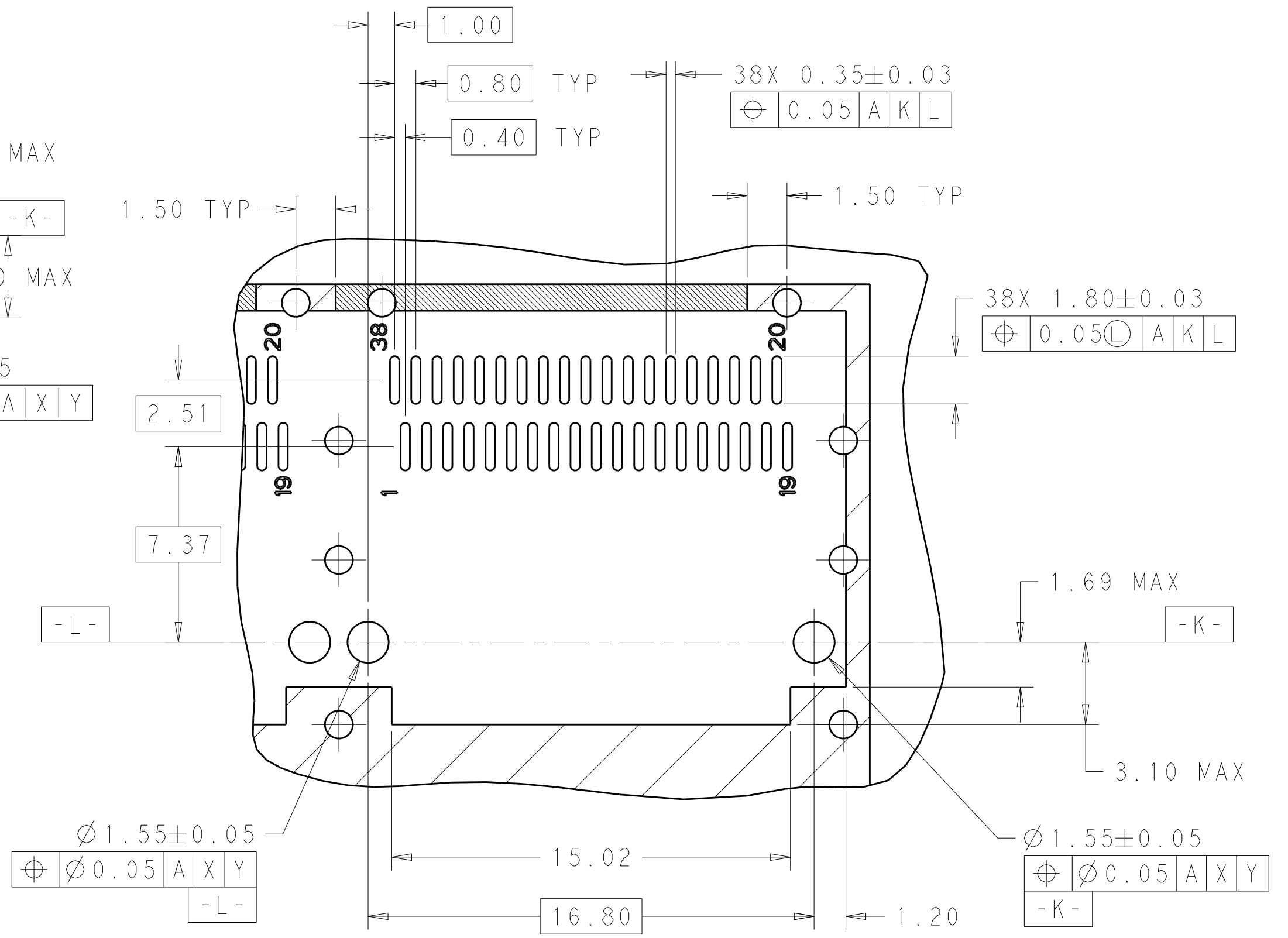

DETAIL B  
SCALE 6:1

|  |                                      |                                |   |
|--|--------------------------------------|--------------------------------|---|
| THIS DRAWING IS A CONTROLLED DOCUMENT. |                                      | DWN<br>BING LIU<br>18APR2014   | <b>STE</b> TE Connectivity                                  |
| DIMENSIONS:<br>mm                      |                                      | CHK<br>JASON YANG<br>18APR2014 |   |
| TOLERANCES UNLESS OTHERWISE SPECIFIED: |                                      | APVD<br>SEAN HAN<br>31DEC2015  | NAME<br>RECEPTACLE CAGE ASSEMBLY<br>THRU BEZEL, 1X3, QSFP28 |
| 0 PLC ±                                | 1 PLC ±0.25                          | PRODUCT SPEC<br>108-19428      | SIZE<br>A200779   |
| 2 PLC ±0.2                             | 3 PLC ±                              | APPLICATION SPEC<br>114-32023  | CAGE CODE<br>C-2170767                                      |
| 4 PLC ±                                | ANGLES ±                             | WEIGHT<br>-                    | DRAWING NO<br>-   |
| MATERIAL<br>SEE NOTES<br>material_2    | FINISH<br>SEE NOTES<br>finish_spec_2 | CUSTOMER DRAWING               | RESTRICTED TO<br>-  |
| SCALE 1:1                              |                                      |                                | SHEET 5 OF 5  |
| REV A                                  |                                      |                                |   |