



Chipsmall Limited consists of a professional team with an average of over 10 year of expertise in the distribution of electronic components. Based in Hongkong, we have already established firm and mutual-benefit business relationships with customers from,Europe,America and south Asia,supplying obsolete and hard-to-find components to meet their specific needs.

With the principle of “Quality Parts,Customers Priority,Honest Operation,and Considerate Service”,our business mainly focus on the distribution of electronic components. Line cards we deal with include Microchip,ALPS,ROHM,Xilinx,Pulse,ON,Everlight and Freescale. Main products comprise IC,Modules,Potentiometer,IC Socket,Relay,Connector.Our parts cover such applications as commercial,industrial, and automotives areas.

We are looking forward to setting up business relationship with you and hope to provide you with the best service and solution. Let us make a better world for our industry!



## Contact us

Tel: +86-755-8981 8866 Fax: +86-755-8427 6832

Email & Skype: info@chipsmall.com Web: www.chipsmall.com

Address: A1208, Overseas Decoration Building, #122 Zhenhua RD., Futian, Shenzhen, China



THIS DRAWING IS UNPUBLISHED. RELEASED FOR PUBLICATION

© COPYRIGHT - BY TYCO ELECTRONICS CORPORATION. ALL RIGHTS RESERVED.

LOC	DIST	REVISIONS					
		P	LTR	DESCRIPTION	DATE	DWN	APVD
H	-		A	RELEASED PER ECR 13-005016	22MAR2013	PP	OL
			A1	REVISED PER ECR-14-000133	22JAN2014	YR	OL

NOTES:

1. MATERIAL: STAINLESS STEEL
2. MUST COMPLY WITH DIRECTIVE 2002/95/EC (ROHS)08 MAX.
3. TO BE USED INLINE WITH z50 ZHAGA COVERS.
4. TO BE USED OPTIC INTERFACE, SEE LAST SHEET.

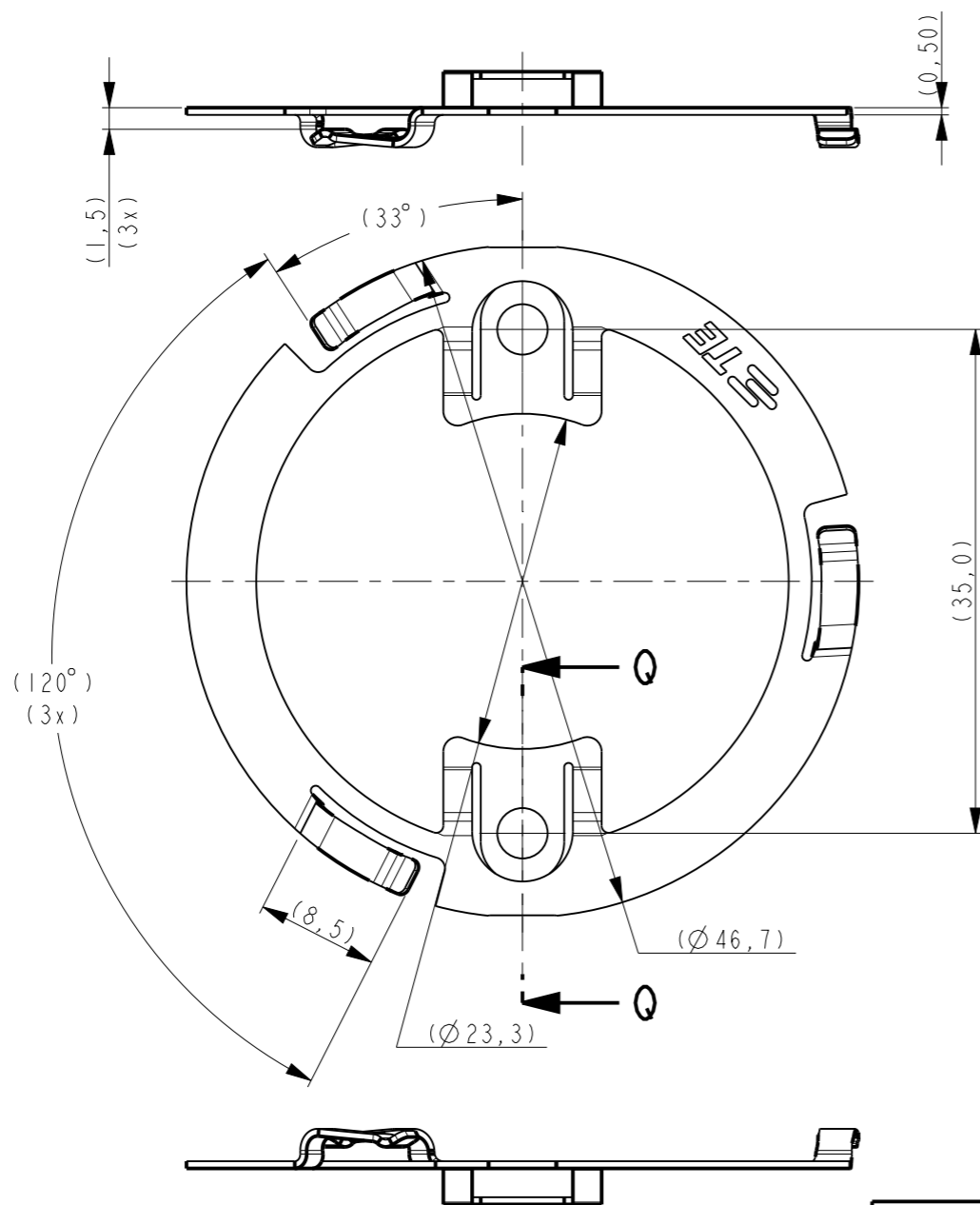

SECTION Q-Q

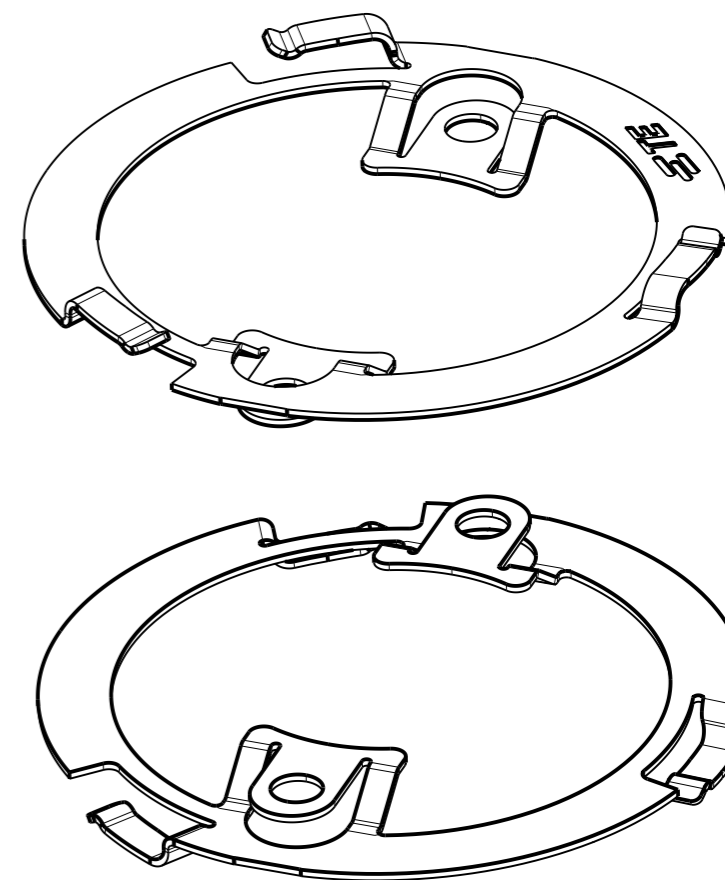
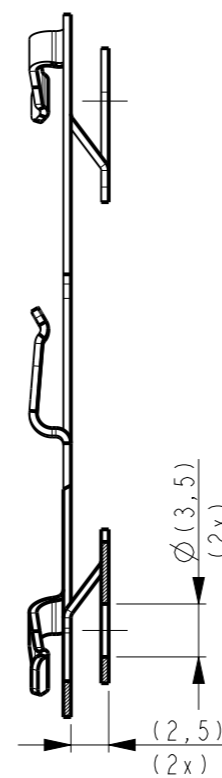

PART NUMBER  
2213194-1

THIS DRAWING IS A CONTROLLED DOCUMENT.

DIMENSIONS: mm	TOLERANCES UNLESS OTHERWISE SPECIFIED:
	0 PLC $\pm$
	1 PLC $\pm$
	2 PLC $\pm$
	3 PLC $\pm$
	4 PLC $\pm$
	ANGLES $\pm$
MATERIAL -	FINISH -

DWN	P. POORTER	02NOV2012
CHK	O. LEIJNSE	06NOV2012
APVD	O. LEIJNSE	06NOV2012
PRODUCT SPEC	-	-
APPLICATION SPEC	-	-
WEIGHT	-	-
CUSTOMER DRAWING		

TE Connectivity		NAME		RESTRICTED TO
		LUMAWISE LED HOLDER OPTIC CLIP Z50, TYPE I		
SIZE	CAGE CODE	DRAWING NO	-	
A3	00779	C-2213194	-	
SCALE	SHEET	OF	REV	
2:1	1	2	A1	

THIS DRAWING IS UNPUBLISHED. RELEASED FOR PUBLICATION  
 © COPYRIGHT - BY TYCO ELECTRONICS CORPORATION. ALL RIGHTS RESERVED.

LOC	DIST	REVISIONS					
H	-	P	LTR	DESCRIPTION	DATE	DWN	APVD
				SEE SHEET 1			

### RECOMMENDED OPTIC INTERFACE:

TOP VIEW

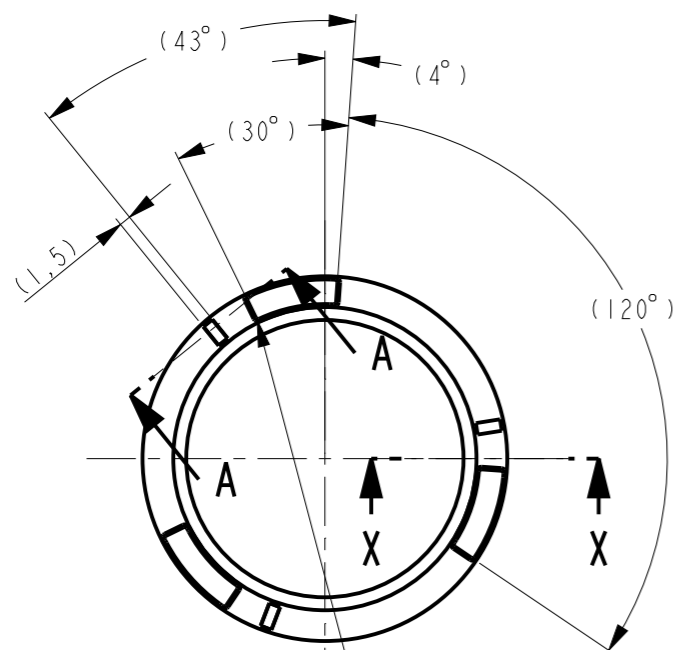

SCALE 1:1 CHAMFER 0.4 MIN. x 45°

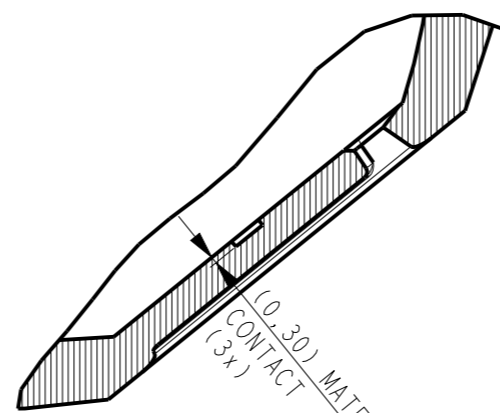

SECTION A-A  
SCALE 3:1

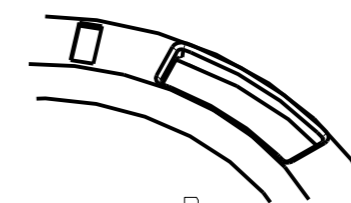

DETAIL B  
SCALE 2:1

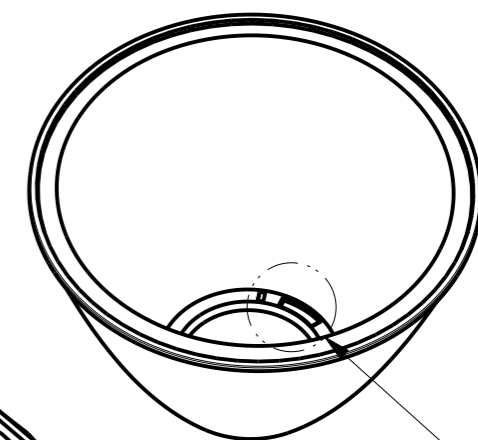

SEE DETAIL B

SECTION X-X

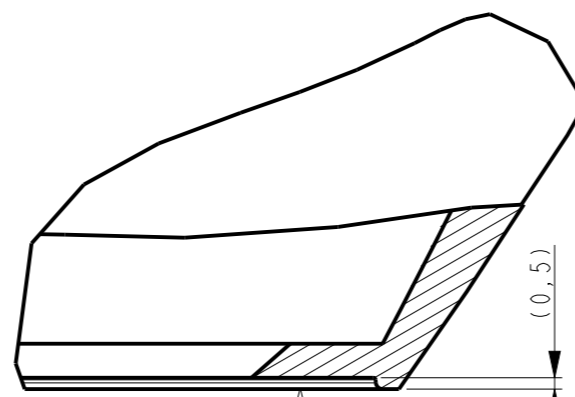
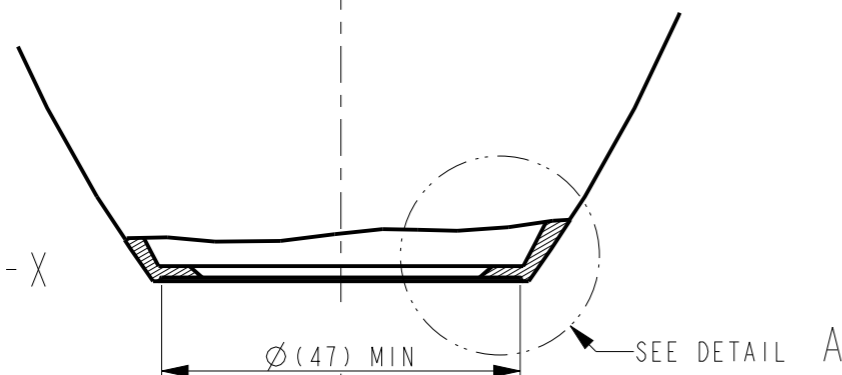

DETAIL A  
SCALE 3:1

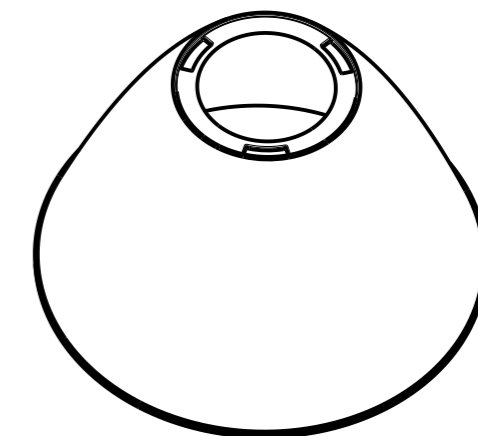

BOTTOM VIEW

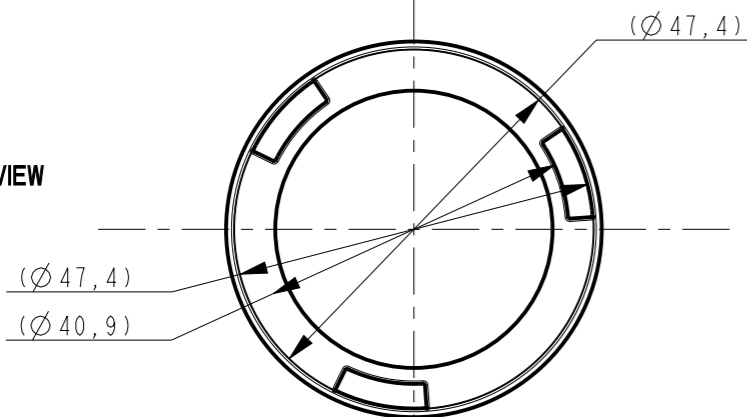

THIS DRAWING IS A CONTROLLED DOCUMENT.

DIMENSIONS:  
mm

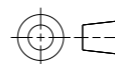

TOLERANCES UNLESS OTHERWISE SPECIFIED:  
 0 PLC ±.  
 1 PLC ±.  
 2 PLC ±.  
 3 PLC ±.  
 4 PLC ±.  
 ANGLES ±.

MATERIAL -

FINISH -

DWN P. POORTER 02NOV2012  
 CHK O. LEIJNSE 06NOV2012  
 APVD O. LEIJNSE 06NOV2012

PRODUCT SPEC -  
 APPLICATION SPEC -

WEIGHT -

CUSTOMER DRAWING



NAME LUMAWISE LED HOLDER OPTIC CLIP Z50, TYPE I

SIZE CAGE CODE DRAWING NO RESTRICTED TO

A3 00779 C-2213194

SCALE 2:1 SHEET 2 OF 2 REV A1