



Chipsmall Limited consists of a professional team with an average of over 10 year of expertise in the distribution of electronic components. Based in Hongkong, we have already established firm and mutual-benefit business relationships with customers from,Europe,America and south Asia,supplying obsolete and hard-to-find components to meet their specific needs.

With the principle of "Quality Parts,Customers Priority,Honest Operation,and Considerate Service",our business mainly focus on the distribution of electronic components. Line cards we deal with include Microchip,ALPS,ROHM,Xilinx,Pulse,ON,Everlight and Freescale. Main products comprise IC,Modules,Potentiometer,IC Socket,Relay,Connector.Our parts cover such applications as commercial,industrial, and automotives areas.

We are looking forward to setting up business relationship with you and hope to provide you with the best service and solution. Let us make a better world for our industry!



## Contact us

Tel: +86-755-8981 8866 Fax: +86-755-8427 6832

Email & Skype: info@chipsmall.com Web: www.chipsmall.com

Address: A1208, Overseas Decoration Building, #122 Zhenhua RD., Futian, Shenzhen, China



THIS DRAWING IS UNPUBLISHED. RELEASED FOR PUBLICATION 20  
 © COPYRIGHT 20 BY - ALL RIGHTS RESERVED.

REVISIONS				
P	LTR	DESCRIPTION	DATE	APVD
A		REVISED PER ECR-14-005938	24APR2014	RS DD

NOTES:

- 1. MATERIALS AND FINISH
  - HOUSING: LCP
  - CONTACTS: COPPER ALLOY, FINISH: GOLD
- 2. PRODUCT TO COMPLY WITH DIRECTIVE 2002/95/EC (ROHS)
- 3. PACKAGED IN TAPE AND REEL PER EIA-481 SPECIFICATIONS

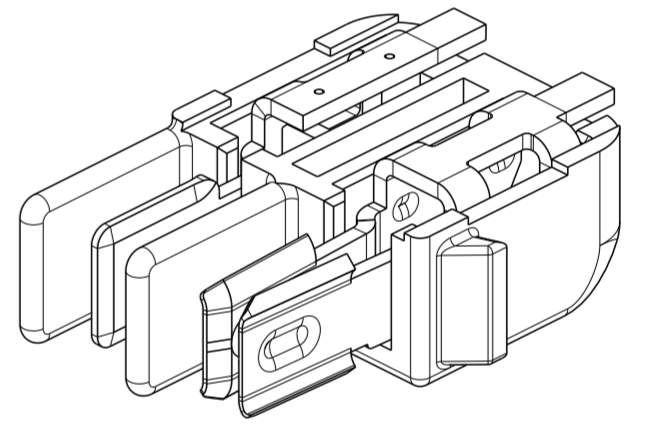
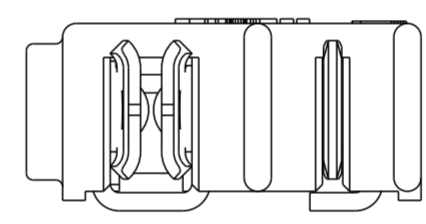
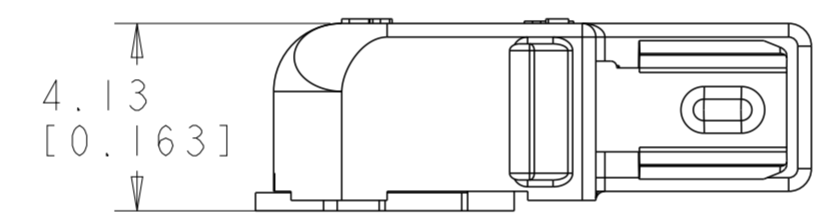
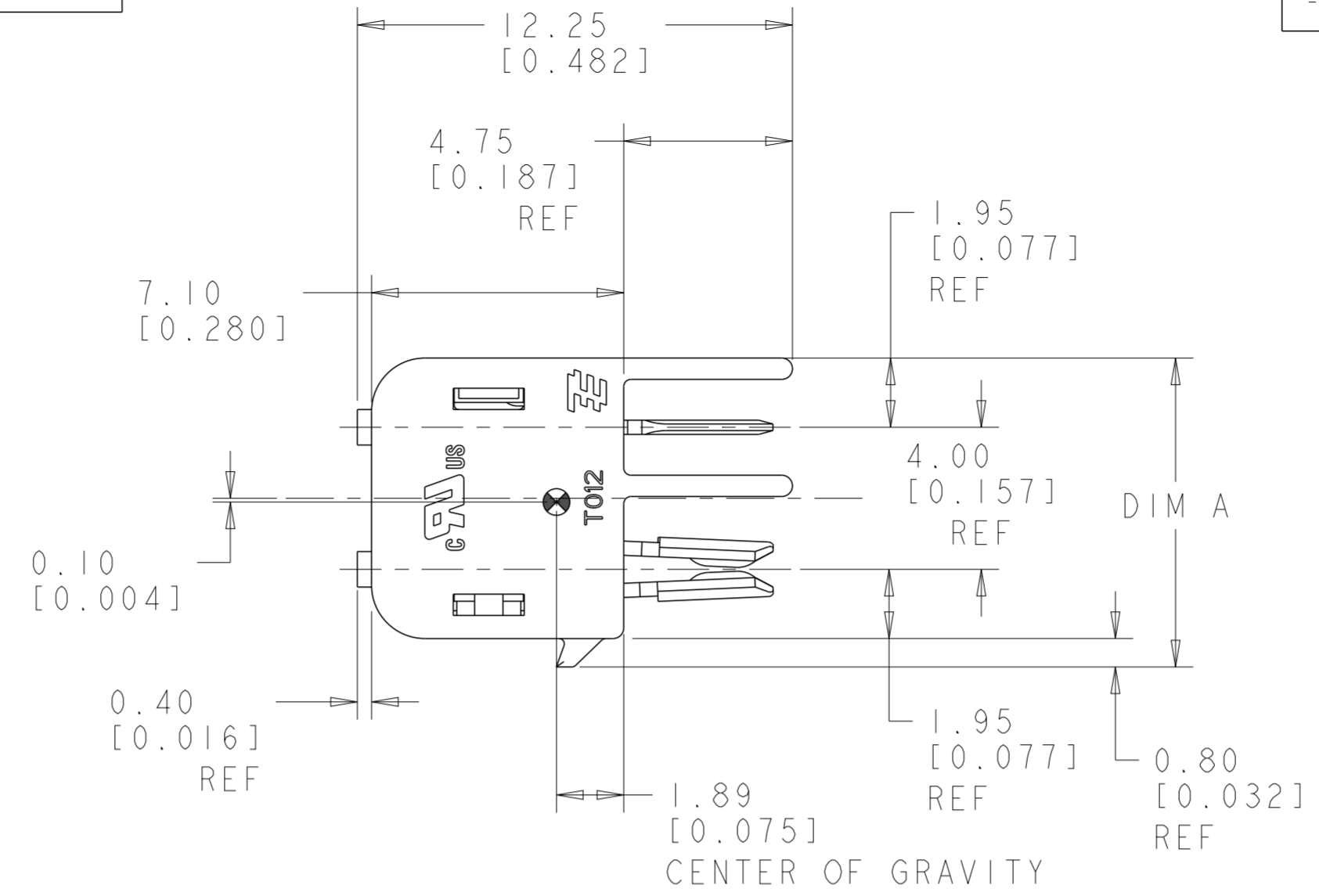

2213288-1/  
1-2213288-1  
SHOWN

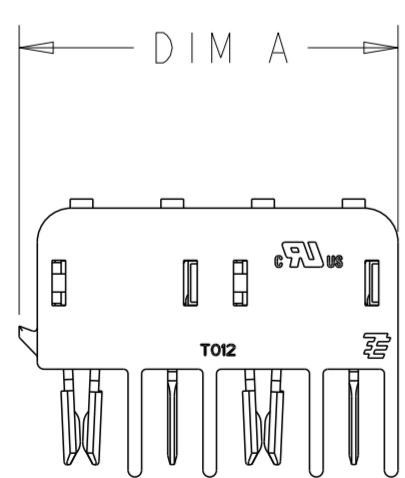
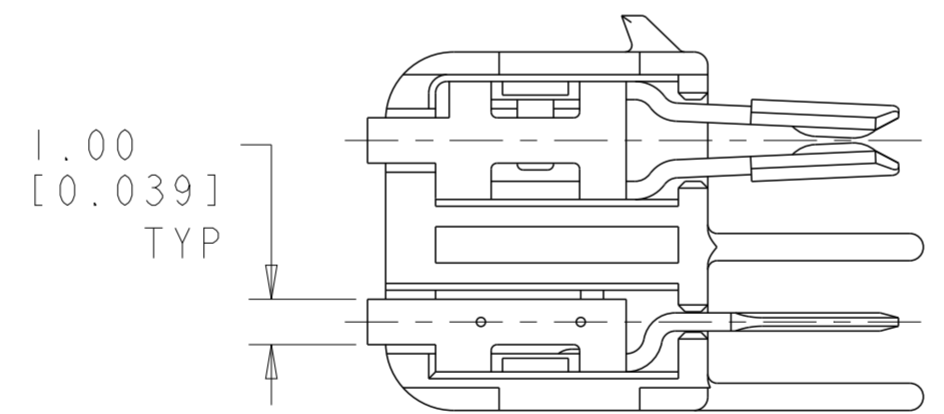

2213288-2/  
1-2213288-2  
SCALE 3:1

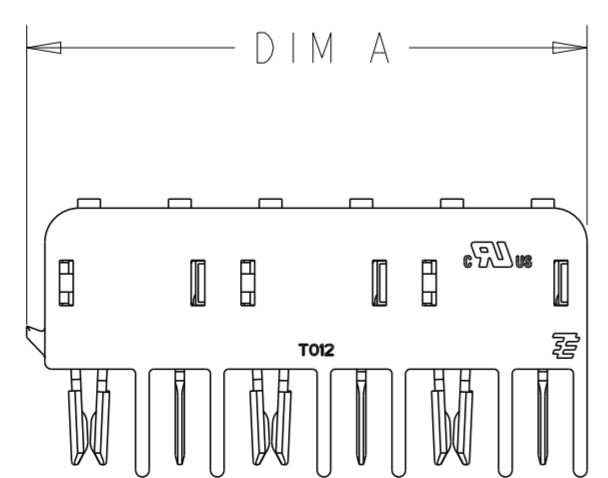

2213288-3/  
1-2213288-3  
SCALE 3:1

POSITION	COLOR	DIM A	PART NO.
6	BLACK	24.70	1-2213288-3
4	BLACK	16.70	1-2213288-2
2	BLACK	8.70	1-2213288-1
6	NATURAL	24.70	2213288-3
4	NATURAL	16.70	2213288-2
2	NATURAL	8.70	2213288-1

THIS DRAWING IS A CONTROLLED DOCUMENT.

DIMENSIONS:	TOLERANCES UNLESS OTHERWISE SPECIFIED:	DWN RAVLS 09APR2013	TE Connectivity
mm	0 PLC ±	CHK D. DECKER 09APR2013	
	1 PLC ±	APVD D. DECKER 09APR2013	
	2 PLC ±0.13	PRODUCT SPEC	
	3 PLC ±0.013	APPLICATION SPEC	108-2342
	4 PLC ±		114-13225
	ANGLES ±1°		
MATERIAL	FINISH	WEIGHT	SIZE CAGE CODE DRAWING NO RESTRICTED TO
			A200779 C-2213288
		Customer Drawing	SCALE 6:1 SHEET 1 OF 2 REV A

THIS DRAWING IS UNPUBLISHED. RELEASED FOR PUBLICATION 20  
 © COPYRIGHT 20 BY - ALL RIGHTS RESERVED.

LOC		DIST		REVISIONS			
P	LTR	DESCRIPTION	DATE	DWN	APVD		
-	-	SEE SHEET 1	-	-	-		

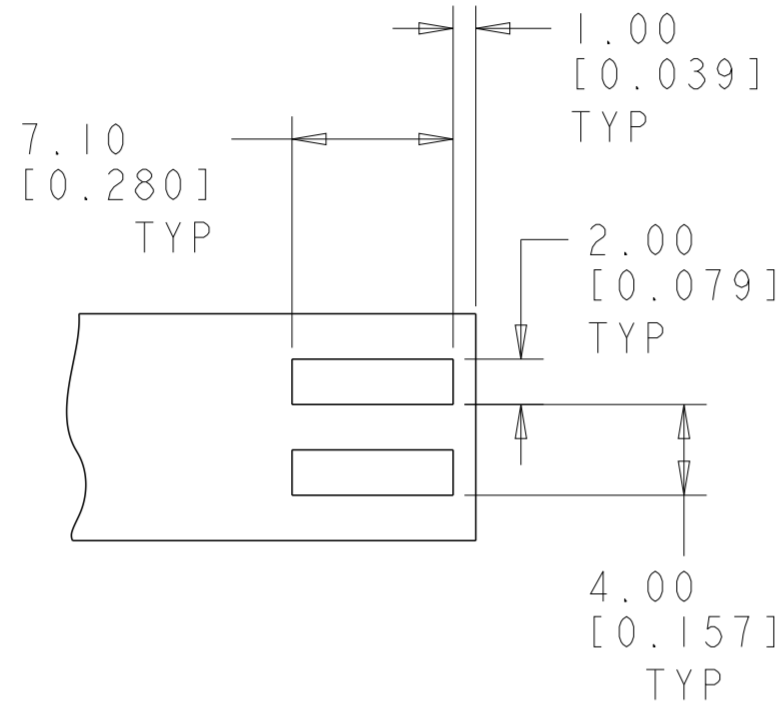

RECOMMENDED PCB LAYOUT FOR 2213288-1 & 1-2213288-1

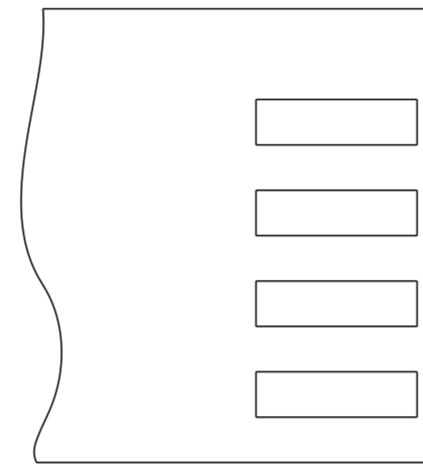

RECOMMENDED PCB LAYOUT FOR 2213288-2 & 1-2213288-2

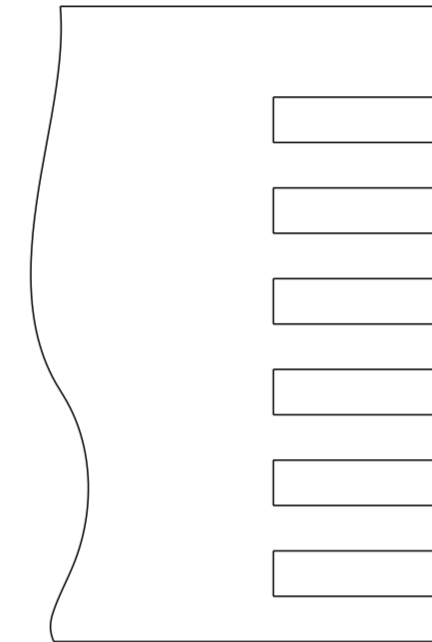

RECOMMENDED PCB LAYOUT FOR 2213288-3 & 1-2213288-3

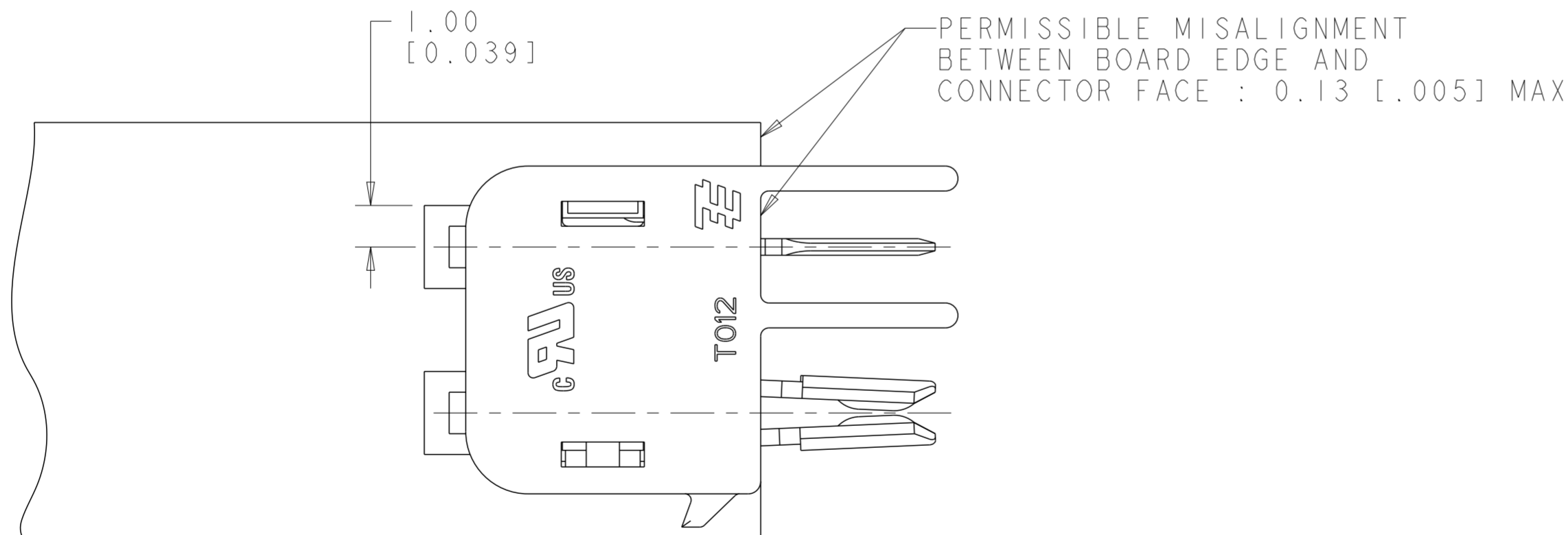

SCALE 8:1

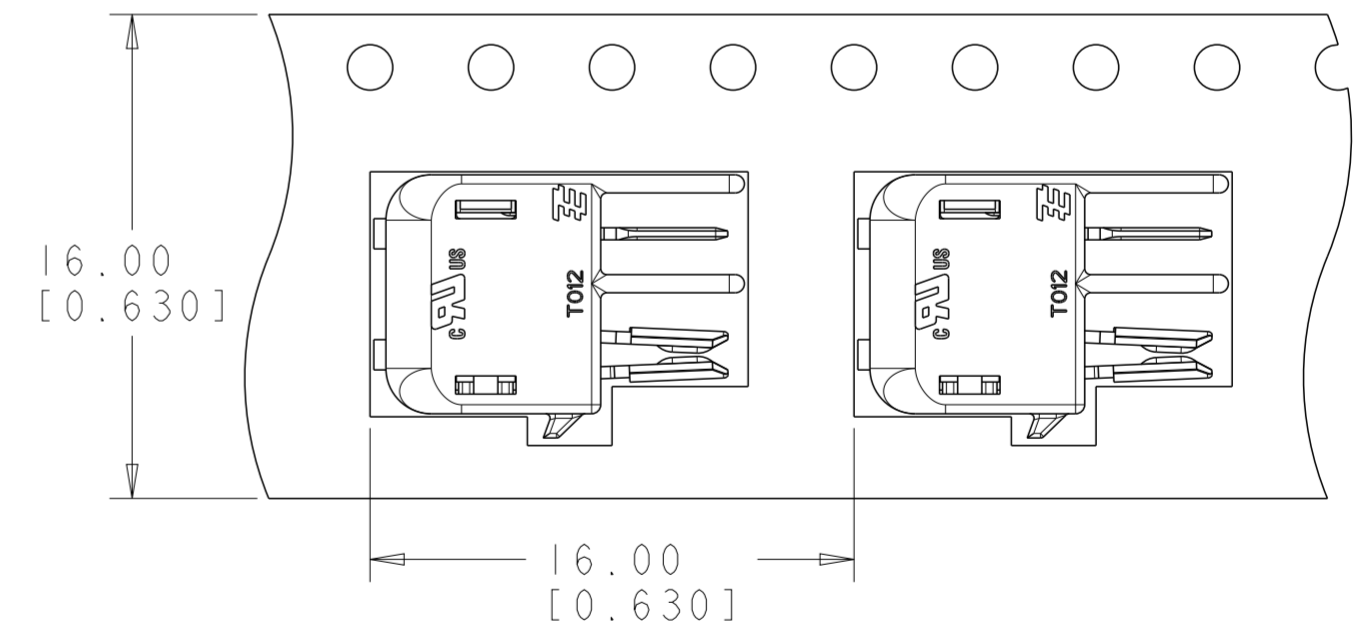

TO BE PACKAGED AS SHOWN SCALE 4:1

THIS DRAWING IS A CONTROLLED DOCUMENT.		DWN RAVLS 09APR2013	<b>STE</b> TE Connectivity	
DIMENSIONS: mm		CHK D. DECKER 09APR2013		
TOLERANCES UNLESS OTHERWISE SPECIFIED:		APVD D. DECKER 09APR2013	NAME CONNECTOR ASSEMBLY, HERMAPHRODITIC BLADE AND RECEPTACLE, WITH LATCH	
0 PLC ±	1 PLC ±	PRODUCT SPEC 108-2342	SIZE A200779	DRAWING NO C-2213288
2 PLC ±0.13	3 PLC ±0.013	APPLICATION SPEC 114-13225	RESTRICTED TO	
4 PLC ±	ANGLES ±1°	WEIGHT -	SCALE 6:1	SHEET 2 OF 2
MATERIAL FINISH		Customer Drawing	REV A	