



Chipsmall Limited consists of a professional team with an average of over 10 year of expertise in the distribution of electronic components. Based in Hongkong, we have already established firm and mutual-benefit business relationships with customers from,Europe,America and south Asia,supplying obsolete and hard-to-find components to meet their specific needs.

With the principle of “Quality Parts,Customers Priority,Honest Operation,and Considerate Service”,our business mainly focus on the distribution of electronic components. Line cards we deal with include Microchip,ALPS,ROHM,Xilinx,Pulse,ON,Everlight and Freescale. Main products comprise IC,Modules,Potentiometer,IC Socket,Relay,Connector.Our parts cover such applications as commercial,industrial, and automotives areas.

We are looking forward to setting up business relationship with you and hope to provide you with the best service and solution. Let us make a better world for our industry!



Contact us

Tel: +86-755-8981 8866 Fax: +86-755-8427 6832

Email & Skype: info@chipsmall.com Web: www.chipsmall.com

Address: A1208, Overseas Decoration Building, #122 Zhenhua RD., Futian, Shenzhen, China



THIS DRAWING IS UNPUBLISHED. RELEASED FOR PUBLICATION ,19 .
© COPYRIGHT 19 BY AMP INCORPORATED, HARRISBURG, PA. ALL INTERNATIONAL RIGHTS RESERVED. AMP PRODUCTS MAY BE COVERED BY U.S. AND FOREIGN PATENTS AND/OR PATENTS PENDING.

LOC	DIST	P	F	REVISIONS				
				ZONE	LTR	DESCRIPTION	DATE	APPROVED
AJ	16				F	REV PER OU20-0666-00	07DEC00	MO

D

C

B

A

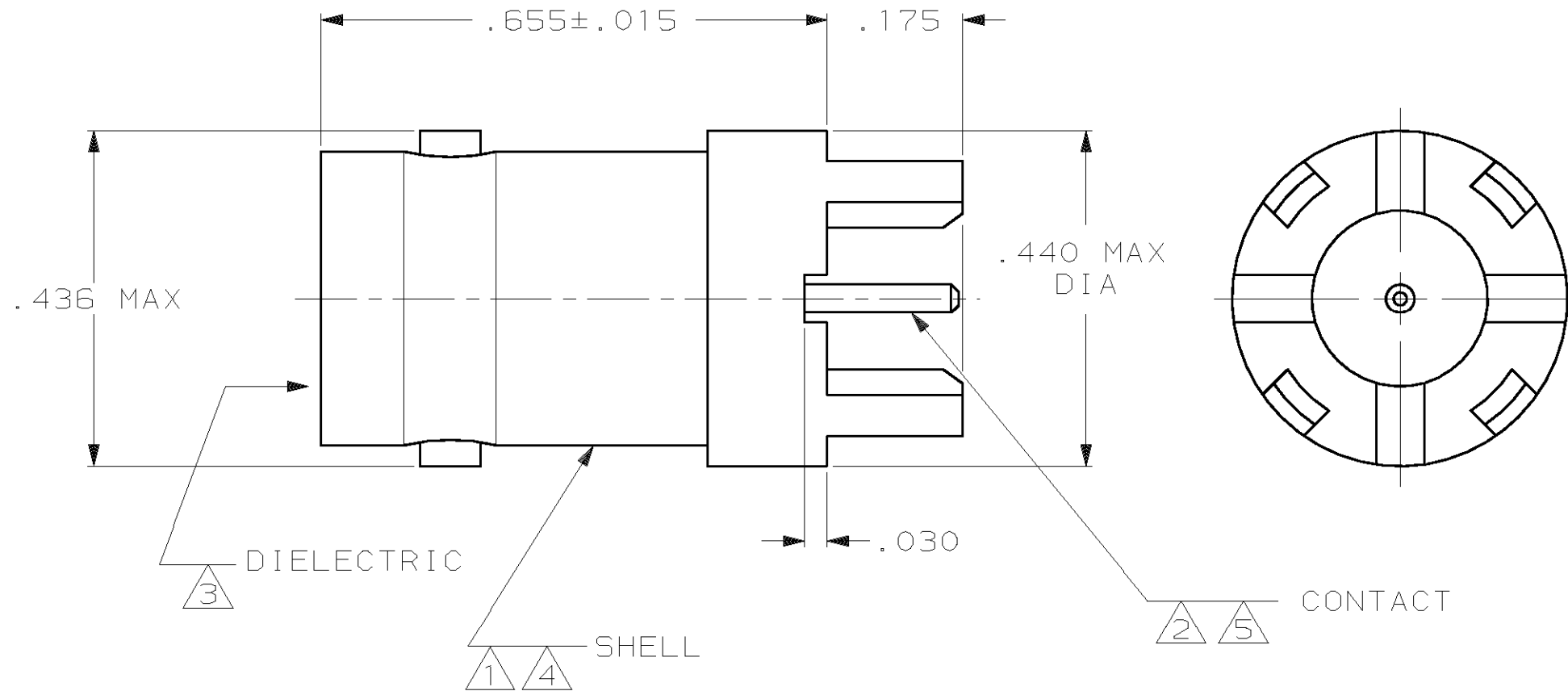

- 1 BRASS PER QQ-B-626.
- 2 PHOSPHOR BRONZE PER QQ-B-750.
- 3 POLYESTER, GENERAL PURPOSE.
- 4 NICKEL PL PER QQ-N-290.
- 5 SILVER PLATE PER QQ-S-365.
- 6. SEE INSTRUCTION SHEET 408-9889.

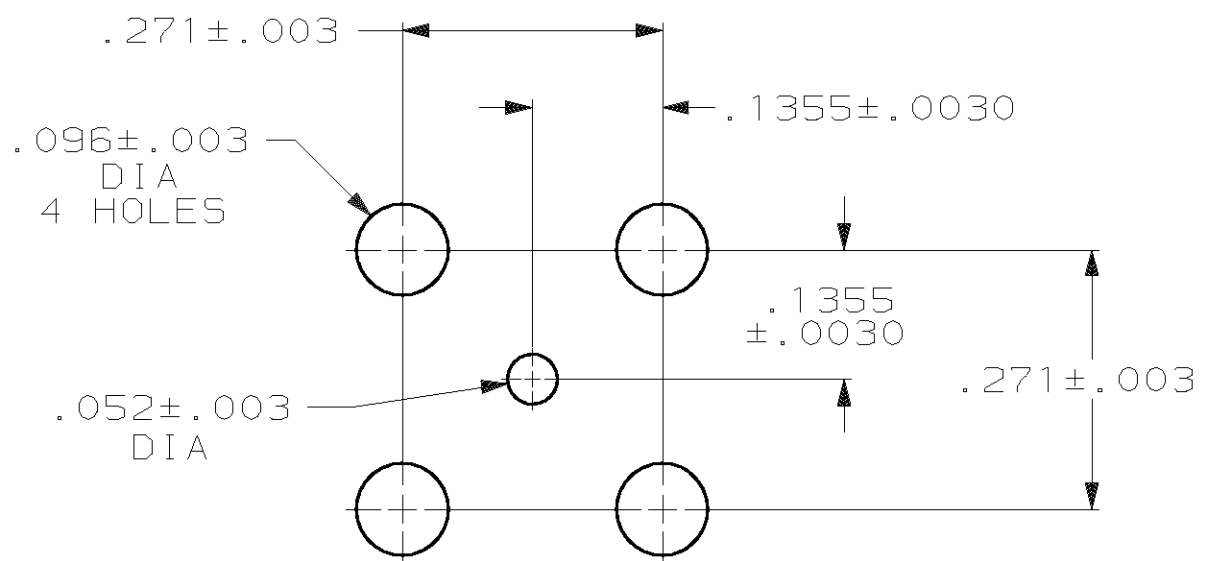

PCB CONFIGURATION

			222420-1	
			PART NO	
UNLESS OTHERWISE SPECIFIED DIMENSIONS ARE IN INCHES TOLERANCES ON: 2 PL DEC ± 3 PL DEC ± .008 ANGLES ±			AMP AMP INCORPORATED Harrisburg, Pa. 17105	
MATERIAL 1 2 3			NAME JACK, VERTICAL, PCB, COMMERCIAL BNC	
FINISH 4 5			SIZE B	FSCM NO 00779
			SCALE 5:1	DRAWING NO 222420
				SHEET 1 OF 1