



Chipsmall Limited consists of a professional team with an average of over 10 year of expertise in the distribution of electronic components. Based in Hongkong, we have already established firm and mutual-benefit business relationships with customers from,Europe,America and south Asia,supplying obsolete and hard-to-find components to meet their specific needs.

With the principle of “Quality Parts,Customers Priority,Honest Operation,and Considerate Service”,our business mainly focus on the distribution of electronic components. Line cards we deal with include Microchip,ALPS,ROHM,Xilinx,Pulse,ON,Everlight and Freescale. Main products comprise IC,Modules,Potentiometer,IC Socket,Relay,Connector.Our parts cover such applications as commercial,industrial, and automotives areas.

We are looking forward to setting up business relationship with you and hope to provide you with the best service and solution. Let us make a better world for our industry!



Contact us

Tel: +86-755-8981 8866 Fax: +86-755-8427 6832

Email & Skype: info@chipsmall.com Web: www.chipsmall.com

Address: A1208, Overseas Decoration Building, #122 Zhenhua RD., Futian, Shenzhen, China



Current transformer - PACT MCR-V2-6015- 85- 200-5A-1 - 2277873

Please be informed that the data shown in this PDF Document is generated from our Online Catalog. Please find the complete data in the user's documentation. Our General Terms of Use for Downloads are valid (<http://phoenixcontact.com/download>)



Window-type current transformer, 200 A AC primary current; 5 A AC secondary current; accuracy class 1; 2.5 VA rated power



Key Commercial Data

Packing unit	1 STK
Custom tariff number	85043129
Country of origin	Germany

Technical data

Dimensions

Primary round conductor (diameter)	52 mm
Primary round conductor (width)	60 mm
Primary round conductor (height)	15 mm
Note on dimensions	2
Primary round conductor (width)	50 mm
Primary round conductor (height)	10 mm
Width	30 mm
Height	108 mm
Depth	85 mm
Width with alternative assembly	85 mm
Height with alternative assembly	108 mm
Depth with alternative assembly	30 mm

Ambient conditions

Ambient temperature (operation)	-25 °C ... 40 °C
---------------------------------	------------------

Current transformer - PACT MCR-V2-6015- 85- 200-5A-1 - 2277873

Technical data

Ambient conditions

Ambient temperature (storage/transport)	-25 °C ... 40 °C
---	------------------

Input data

Thermal rated short-time current	$I_{th} = 60 * I_n$
Thermal rated continuous current	$I_d = 1.2 * I_n$
Rated surge current	$I_{dyn} = 2.5 * I_{th}$
Rated frequency: Standard converter	50 Hz ... 60 Hz
Rated frequency: Calibrated converter	50 Hz
Surge current limitation factor	FS 5
Rated power	2.5 VA
Primary rated current I_{pn}	0 A ... 200 A
Secondary rated current I_{sn}	5 A AC

General

Converter type	Plug-on converters
Accuracy class	1
Can be calibrated	no
Rated insulation voltage	1 kV (Phase/neutral conductor)
Standards/regulations	EN 50178
	EN 61869
Color	black
Housing material	WELLAMID 6600-PA66-GV 20 HWV0CP

Standards and Regulations

Standards/regulations	EN 50178
	EN 61869

Drawings

Dimensional drawing

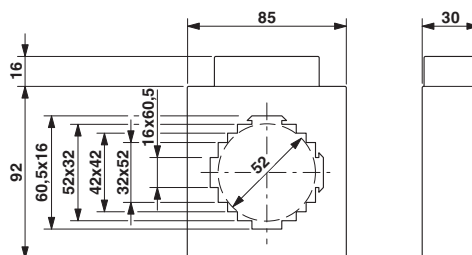

Current transformer - PACT MCR-V2-6015- 85- 200-5A-1 - 2277873

Classifications

eCl@ss

eCl@ss 4.0	27210902
eCl@ss 4.1	27210902
eCl@ss 5.0	27210902
eCl@ss 5.1	27210902
eCl@ss 6.0	27210902
eCl@ss 7.0	27210902
eCl@ss 8.0	27210902
eCl@ss 9.0	27210902

ETIM

ETIM 2.0	EC001505
ETIM 3.0	EC001505
ETIM 4.0	EC002048
ETIM 5.0	EC002048

UNSPSC

UNSPSC 6.01	30211501
UNSPSC 7.0901	39121019
UNSPSC 11	39121006
UNSPSC 12.01	39121006
UNSPSC 13.2	39121006

Accessories

Accessories

Mounting material

Mounting material - PACT-FAST-MNT-W16-L65 - 2276641



The transformer quick-action mechanism enables the lightning-fast mounting of PACT current transformers on the power rail. The installation can be completed easily by hand without the use of tools. Fixing pins: 65 mm, holding latches: 16 mm

Current transformer - PACT MCR-V2-6015- 85- 200-5A-1 - 2277873

Accessories

Mounting material - PACT-FAST-MNT-W16-L40 - 2276638



The transformer quick-action mechanism enables the lightning-fast mounting of PACT current transformers on the power rail. The installation can be completed easily by hand without the use of tools. Fixing pins: 40 mm, holding latches: 16 mm