



Chipsmall Limited consists of a professional team with an average of over 10 year of expertise in the distribution of electronic components. Based in Hongkong, we have already established firm and mutual-benefit business relationships with customers from,Europe,America and south Asia,supplying obsolete and hard-to-find components to meet their specific needs.

With the principle of “Quality Parts,Customers Priority,Honest Operation,and Considerate Service”,our business mainly focus on the distribution of electronic components. Line cards we deal with include Microchip,ALPS,ROHM,Xilinx,Pulse,ON,Everlight and Freescale. Main products comprise IC,Modules,Potentiometer,IC Socket,Relay,Connector.Our parts cover such applications as commercial,industrial, and automotives areas.

We are looking forward to setting up business relationship with you and hope to provide you with the best service and solution. Let us make a better world for our industry!



## Contact us

Tel: +86-755-8981 8866 Fax: +86-755-8427 6832

Email & Skype: info@chipsmall.com Web: www.chipsmall.com

Address: A1208, Overseas Decoration Building, #122 Zhenhua RD., Futian, Shenzhen, China



4

3

2

1

THIS DRAWING IS UNPUBLISHED.

RELEASED FOR PUBLICATION

20

© COPYRIGHT 20 BY -

ALL RIGHTS RESERVED.

LOC	DIST	REVISIONS			
P	LTR	DESCRIPTION	DATE	DWN	APVD
-	-	B1	REVISED PER ECR-17-002252	16-Feb-17	R.Z. C.W.

NOTES

1

MATERIAL:

HOUSING: HIGH TEMPERATURE THERMAL PLASTIC.  
CONTACT: COPPER ALLOY.

2

PLATING:

CONTACT: 0.30um MIN Pd/Ni , 0.05um MIN GOLD  
PLATING AT CONTACT AREA,  
GOLD FLASH AT SOLDER AREA. 2um MIN. NICKEL UNDER PLATING.

3

COPLANARITY: 0.10mm MAX.

4

RECOMMENDED THICKNESS OF METAL MASK FOR SOLDER: 0.10mm MIN.

5

INDICATED DATE CODE MARK.

Top view dimensions: 9.6 (width), 2.2 (height), 3.3 (height), 2.2 (height), 3.3 (height), 7.65 (height), 6.15 (height), 0.35 (width), 4.4 (width), 0.35 (width), 4.4 (width), 3X0.3 (width).

Side view dimensions: 0.33±0.03 (width), 0.71 (height), 0.49±0.05 (8X) (width).

Dimensions: 3.84 (width), 0.45±0.02 (width), 0.10 (width), 0.10 (width), 1.1 (width), 0.08 (radius).

Tolerances: 0.10 X Y Z, 0.10 X Y Z.

Dimensions: 6.975 (2X) (height), 1.45 (width), 1.45 (width).

2286981-1: AS SHOWN

DIMENSIONS:		TOLERANCES UNLESS OTHERWISE SPECIFIED:		APVD		NAME	
mm		0 PLC ±0.2		MURRAY.LU 28-Feb-15		BLOCK MICRO SD CARD CONNECTOR	
		1 PLC ±0.15		CHK SIMON LI 28-Feb-15		-	
		2 PLC ±0.1		APVD COREI WANG 28-Feb-15		-	
		3 PLC ±-		PRODUCT SPEC 108-115084		SIZE CAGE CODE DRAWING NO RESTRICTED TO	
		4 PLC ±-		APPLICATION SPEC -		A3 00779 C-2286981	
		ANGLES ±-		WEIGHT 0.04g		SCALE - SHEET 1 OF 2 REV B1	
MATERIAL 1		FINISH 2		Customer Drawing			

1470-19 (3/11)

THIS DRAWING IS UNPUBLISHED.

RELEASED FOR PUBLICATION

20

© COPYRIGHT 20 BY -

ALL RIGHTS RESERVED.

LOC - DIST -

REVISIONS

P	LTR	DESCRIPTION	DATE	DWN	APVD
B1		REVISED PER ECR-17-002252	16-Feb-17	R.Z.	C.W.

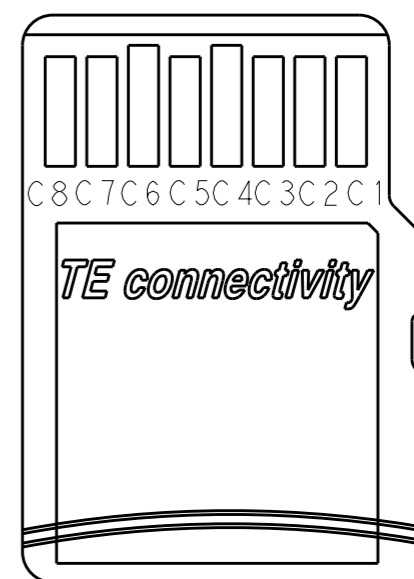
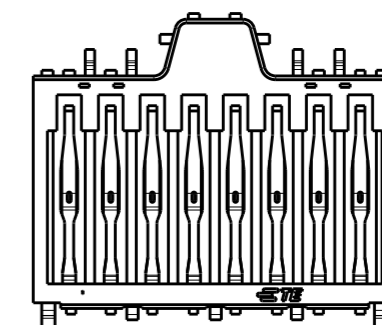
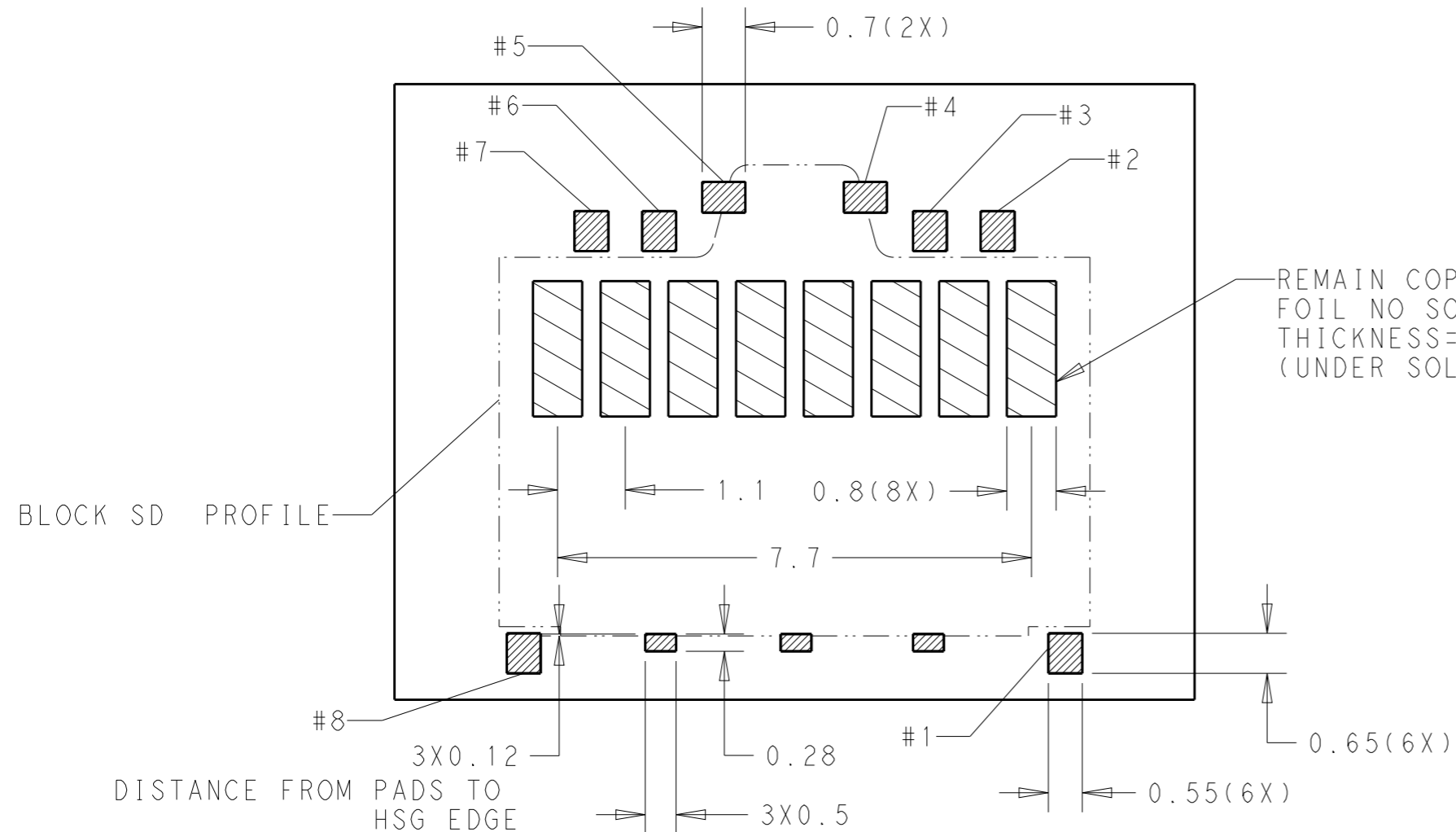

RECOMMENDED PWB LAYOUT  
ALL DIMENSION TOLERANCE ±0.05

THIS DRAWING IS A CONTROLLED DOCUMENT.

DIMENSIONS:  
mm

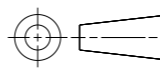

TOLERANCES UNLESS OTHERWISE SPECIFIED:

0 PLC	±0.2
1 PLC	±0.15
2 PLC	±0.1
3 PLC	±-
4 PLC	±-
ANGLES	±-

MATERIAL

FINISH

DWN 28-Feb-15

MURRAY.LU

CHK 28-Feb-15

SIMON.LI

APVD 28-Feb-15

COREI.WANG

PRODUCT SPEC  
108-115084

APPLICATION SPEC

WEIGHT 0.04g

Customer Drawing



TE Connectivity

NAME  
BLOCK MICRO SD CARD CONNECTOR

SIZE	CAGE CODE	DRAWING NO	RESTRICTED TO
------	-----------	------------	---------------

A3	00779	C-2286981	-
----	-------	-----------	---

SCALE	SHEET	OF	REV
-	2	2	B1