



Chipsmall Limited consists of a professional team with an average of over 10 year of expertise in the distribution of electronic components. Based in Hongkong, we have already established firm and mutual-benefit business relationships with customers from,Europe,America and south Asia,supplying obsolete and hard-to-find components to meet their specific needs.

With the principle of “Quality Parts,Customers Priority,Honest Operation,and Considerate Service”,our business mainly focus on the distribution of electronic components. Line cards we deal with include Microchip,ALPS,ROHM,Xilinx,Pulse,ON,Everlight and Freescale. Main products comprise IC,Modules,Potentiometer,IC Socket,Relay,Connector.Our parts cover such applications as commercial,industrial, and automotives areas.

We are looking forward to setting up business relationship with you and hope to provide you with the best service and solution. Let us make a better world for our industry!



Contact us

Tel: +86-755-8981 8866 Fax: +86-755-8427 6832

Email & Skype: info@chipsmall.com Web: www.chipsmall.com

Address: A1208, Overseas Decoration Building, #122 Zhenhua RD., Futian, Shenzhen, China



THIS DRAWING IS UNPUBLISHED. RELEASED FOR PUBLICATION 20
 © COPYRIGHT 20 BY - ALL RIGHTS RESERVED.

REVISIONS				
P	LTR	DESCRIPTION	DATE	APVD
A		THE OFFICIAL VERSION RELEASED	27-Feb-15	E.F. C.W.

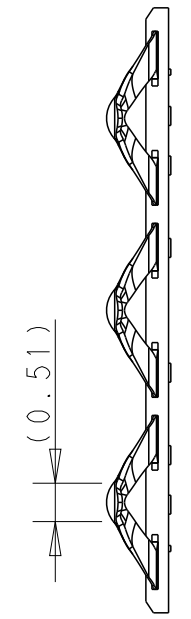
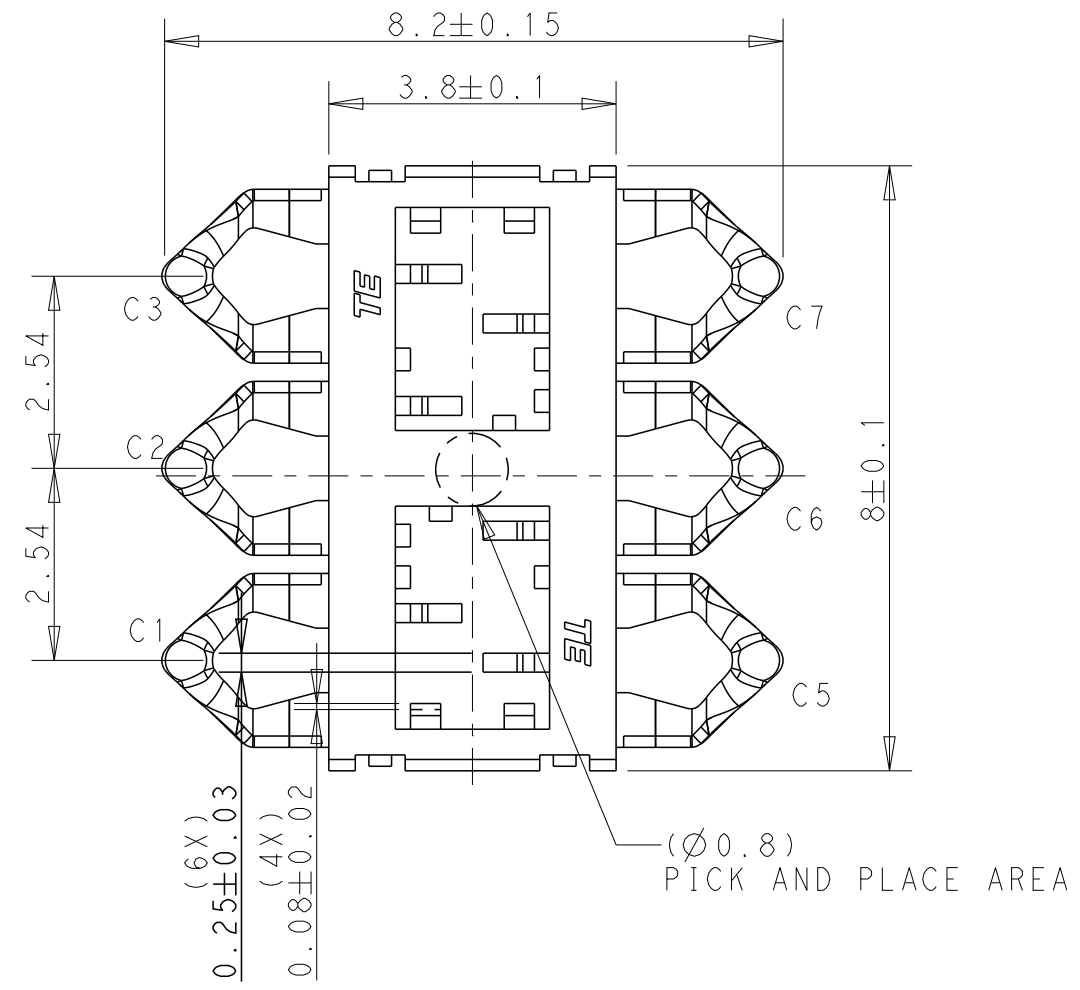

- NOTES:
- 1 HOUSING MATERIAL: THERMO PLASTIC RESIN.
 - 2 CONTACT MATERIAL: COPPER ALLOY.
 - 2 FINISH :
 50u" MIN. NICKEL UNDERPLATING ALL OVER,
 GOLD PLATING 2u" MIN. ON CONTACT AREA
 12u" MIN. Pd/Ni ON CONTACT AREA
 GOLD PLATING 1u" MIN. ON SOLDER AREA
 - 3 COPLANARITY: 0.08MAX. (BEFORE IR)
 - 4 DATE CODE:
 YWWDSSL (YEAR, WEEK, DAY, SHIFT, LINE)

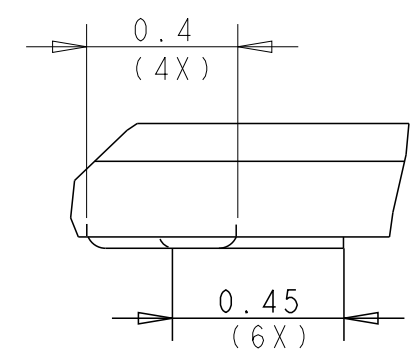
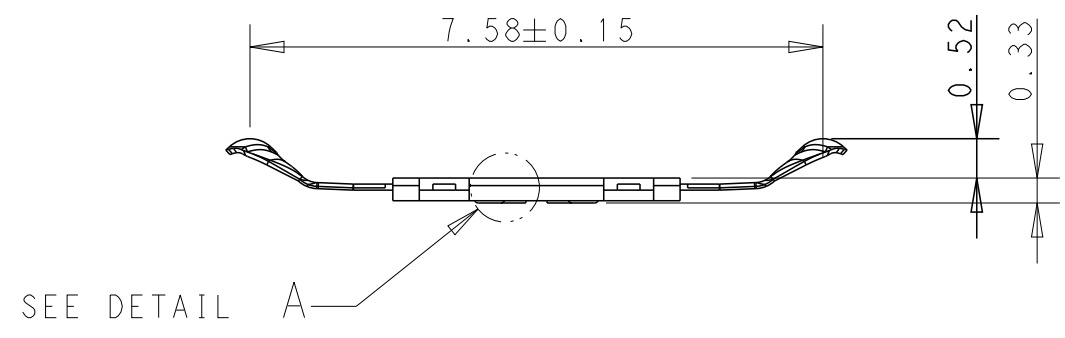
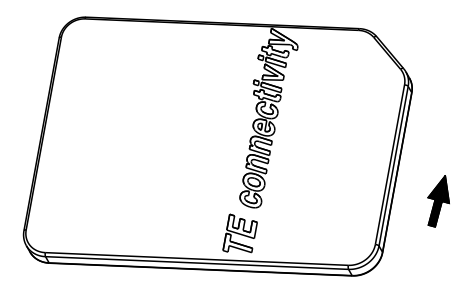
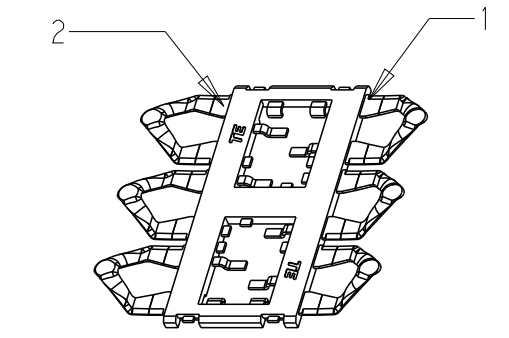

DETAIL A
SCALE 50:1

2287217-1	2	CONTACT	2
	1	HOUSING	1
P/N	ITEM	COMPONENT	MATERIAL/FINISH

THIS DRAWING IS A CONTROLLED DOCUMENT.		DWN E.F.	27-Feb-15		
DIMENSIONS: mm		CHK S.L.	27-Feb-15		
TOLERANCES UNLESS OTHERWISE SPECIFIED:		APVD C.W.	27-Feb-15		
0 PLC ±- 1 PLC ±0.1 2 PLC ±0.05 3 PLC ±0.02 4 PLC ±- ANGLES ±-		NAME	ANTI-BUCKLING BLOCK SIM CONNECTOR SIDE ENTRY TYPE		
MATERIAL	FINISH	PRODUCT SPEC	108-115090	SIZE	A3
		APPLICATION SPEC	-	CAGE CODE	00779
		WEIGHT	0.026g	DRAWING NO	C-2287217
CUSTOMER DRAWING			SCALE	10:1	SHEET 1 OF 2
					REV A

THIS DRAWING IS UNPUBLISHED. RELEASED FOR PUBLICATION 20
 © COPYRIGHT 20 BY - ALL RIGHTS RESERVED.

REVISIONS					
P	LTR	DESCRIPTION	DATE	DWN	APVD
A		THE OFFICIAL VERSION RELEASED	27-Feb-15	E.F.	C.W.

D

D

C

C

B

B

A

A

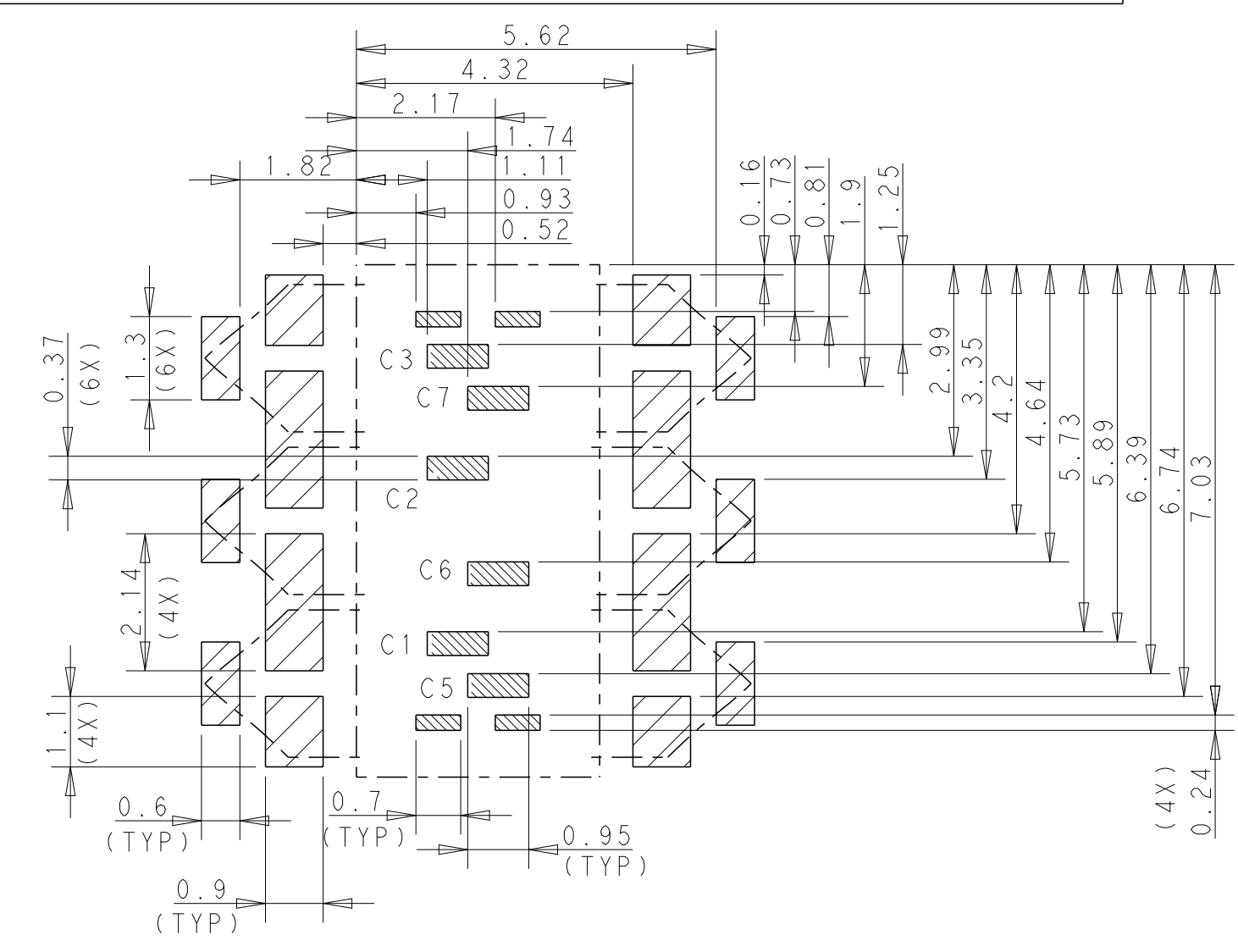

REFERENCE P.C. BOARD LAYOUT
 (P.C.B. TOLERANCE: ±0.05)

- SOLDER AREA
- COPPER FOIL REMOVE & SOLDER MASK KEEP OUT (DEPTH: 0.05~0.10MM)
- CONNECTOR BOUNDARY

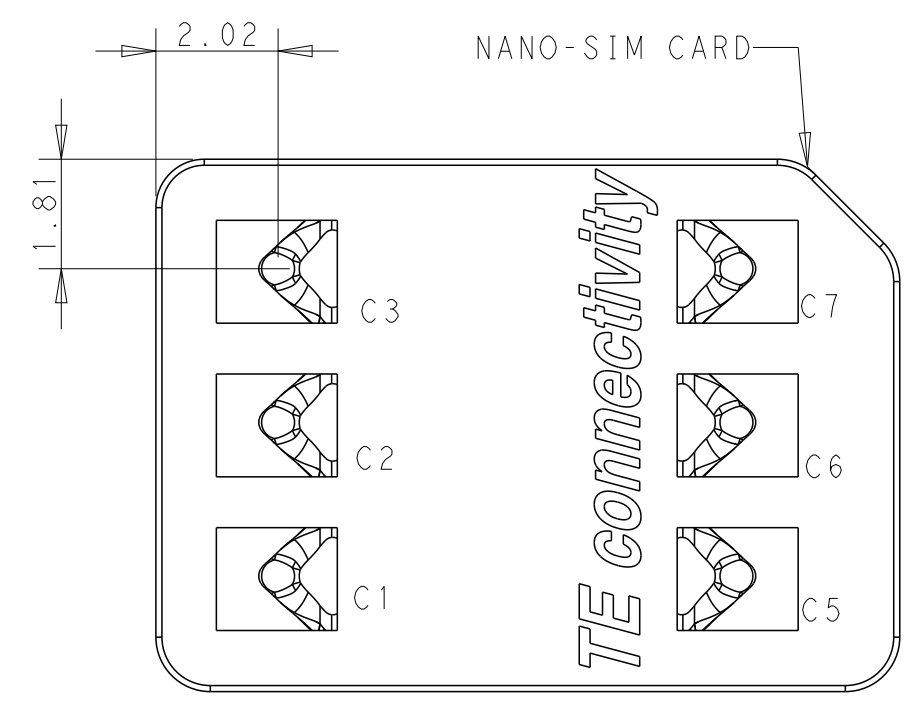

REFERENCE INSERTION SITUATION
 NANO-SIM CARD

THIS DRAWING IS A CONTROLLED DOCUMENT.		DWN E.F.	27-Feb-15		
DIMENSIONS: mm		CHK S.L.	27-Feb-15		
		APVD C.W.	27-Feb-15		
		NAME ANTI-BUCKLING BLOCK SIM CONNECTOR SIDE ENTRY TYPE			
TOLERANCES UNLESS OTHERWISE SPECIFIED:		PRODUCT SPEC 108-115090		RESTRICTED TO	
0 PLC ±- 1 PLC ±0.1 2 PLC ±0.05 3 PLC ±0.02 4 PLC ±- ANGLES ±-		APPLICATION SPEC -		SIZE A3	CAGE CODE 00779
MATERIAL -		WEIGHT 0.026g		DRAWING NO C-2287217	
FINISH -		CUSTOMER DRAWING		SCALE 10:1	SHEET 2 OF 2
				REV A	