



Chipsmall Limited consists of a professional team with an average of over 10 year of expertise in the distribution of electronic components. Based in Hongkong, we have already established firm and mutual-benefit business relationships with customers from,Europe,America and south Asia,supplying obsolete and hard-to-find components to meet their specific needs.

With the principle of “Quality Parts,Customers Priority,Honest Operation,and Considerate Service”,our business mainly focus on the distribution of electronic components. Line cards we deal with include Microchip,ALPS,ROHM,Xilinx,Pulse,ON,Everlight and Freescale. Main products comprise IC,Modules,Potentiometer,IC Socket,Relay,Connector.Our parts cover such applications as commercial,industrial, and automotives areas.

We are looking forward to setting up business relationship with you and hope to provide you with the best service and solution. Let us make a better world for our industry!



Contact us

Tel: +86-755-8981 8866 Fax: +86-755-8427 6832

Email & Skype: info@chipsmall.com Web: www.chipsmall.com

Address: A1208, Overseas Decoration Building, #122 Zhenhua RD., Futian, Shenzhen, China



| LOC | | DIST | | REVISIONS | | | |
|-----|--|------|-----|-------------|-----------|-----|------|
| | | P | LTN | DESCRIPTION | DATE | DMN | APVD |
| | | A | | RELEASE | 01NOV2016 | JY | SH |

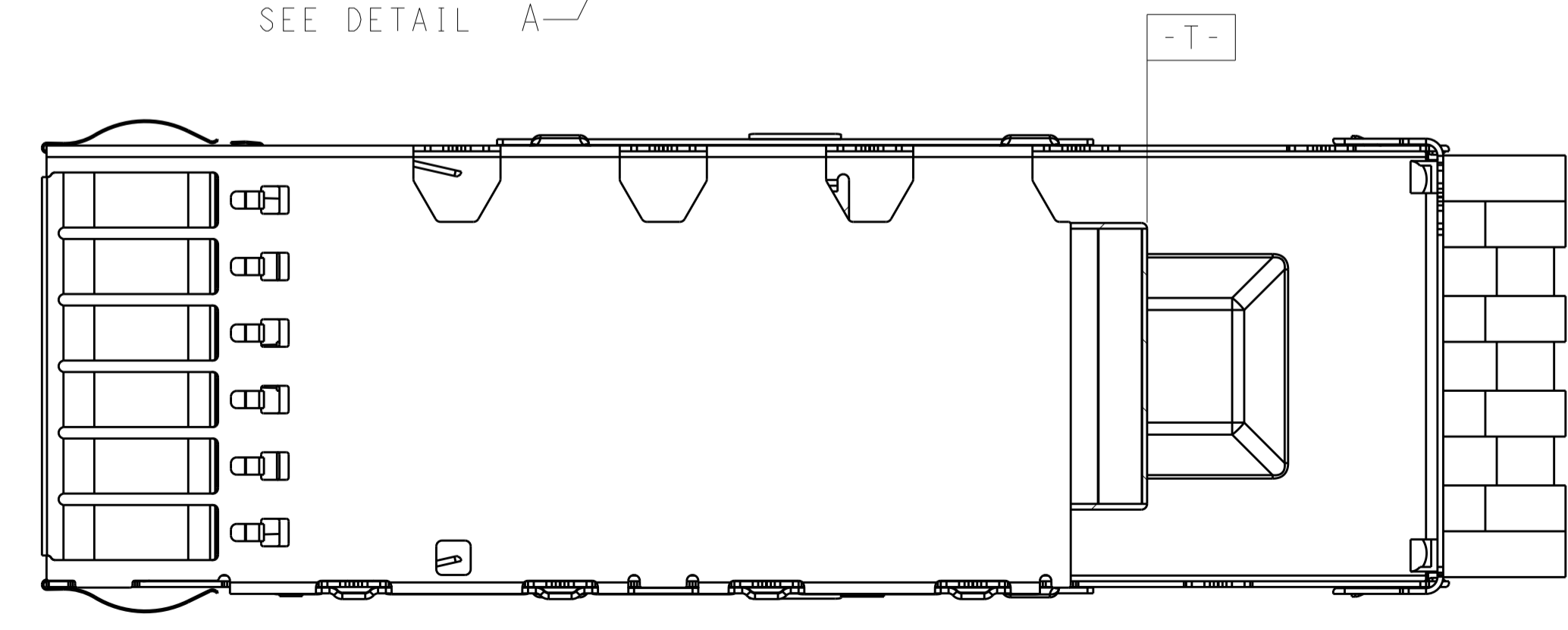
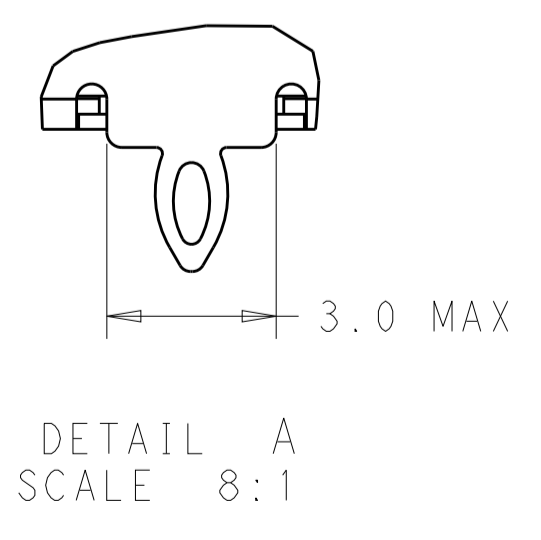
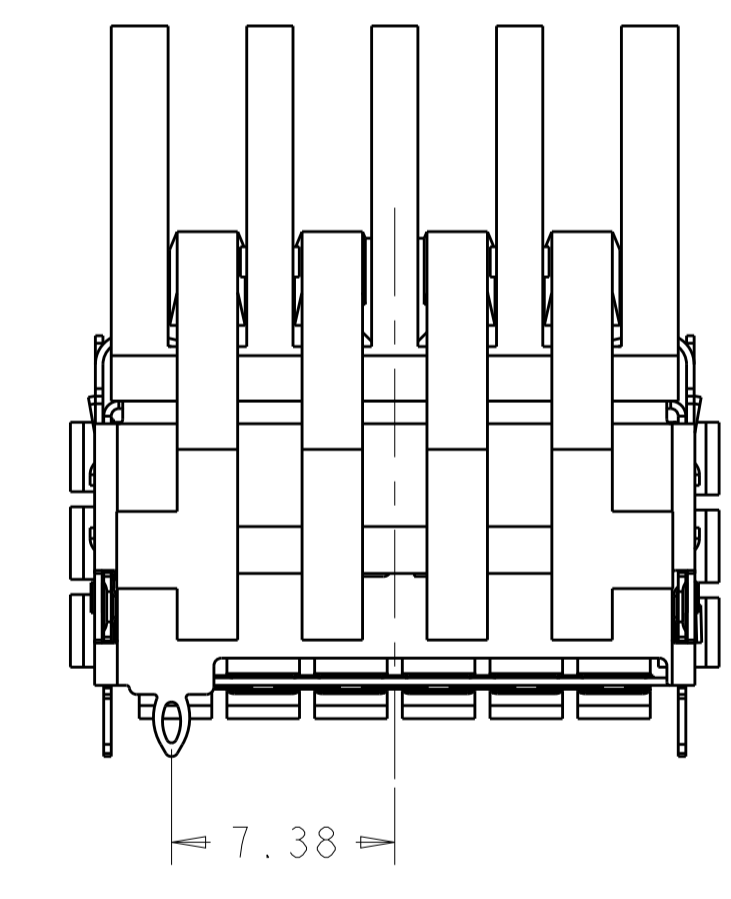
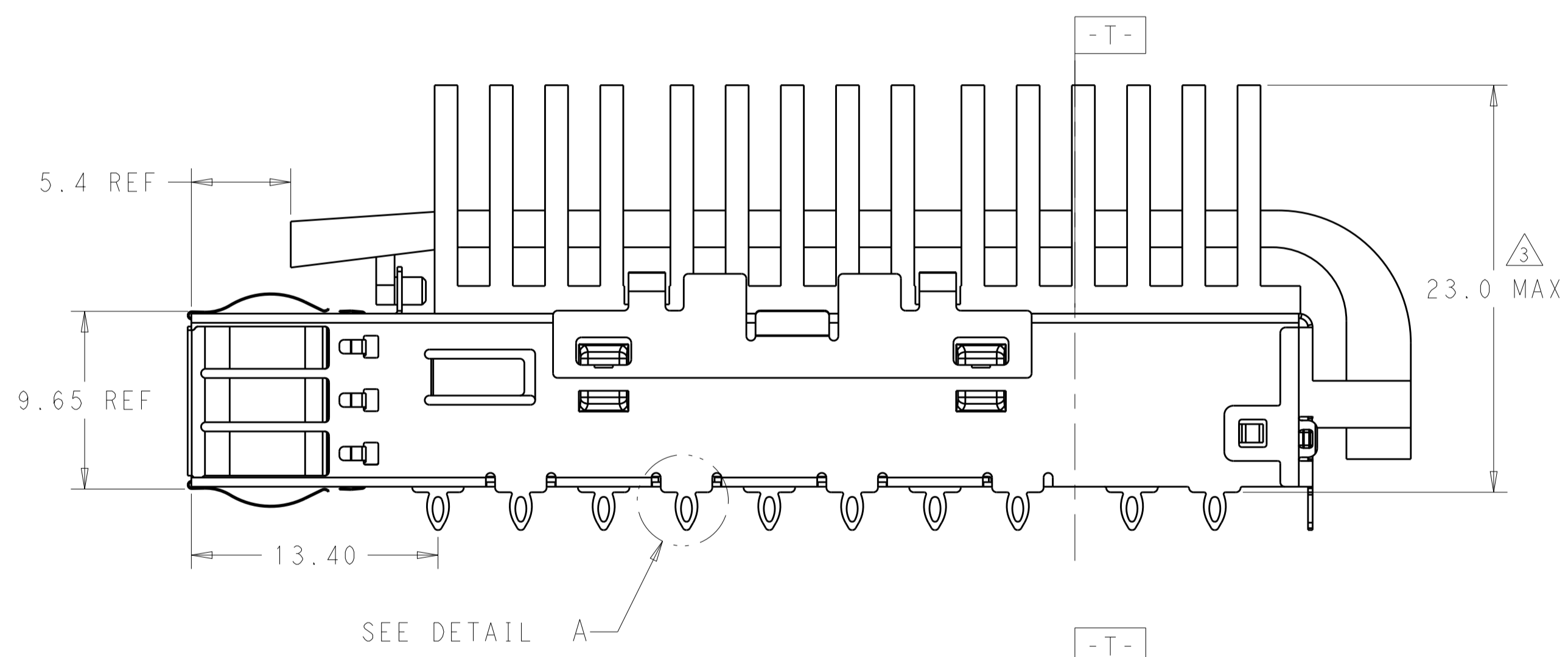
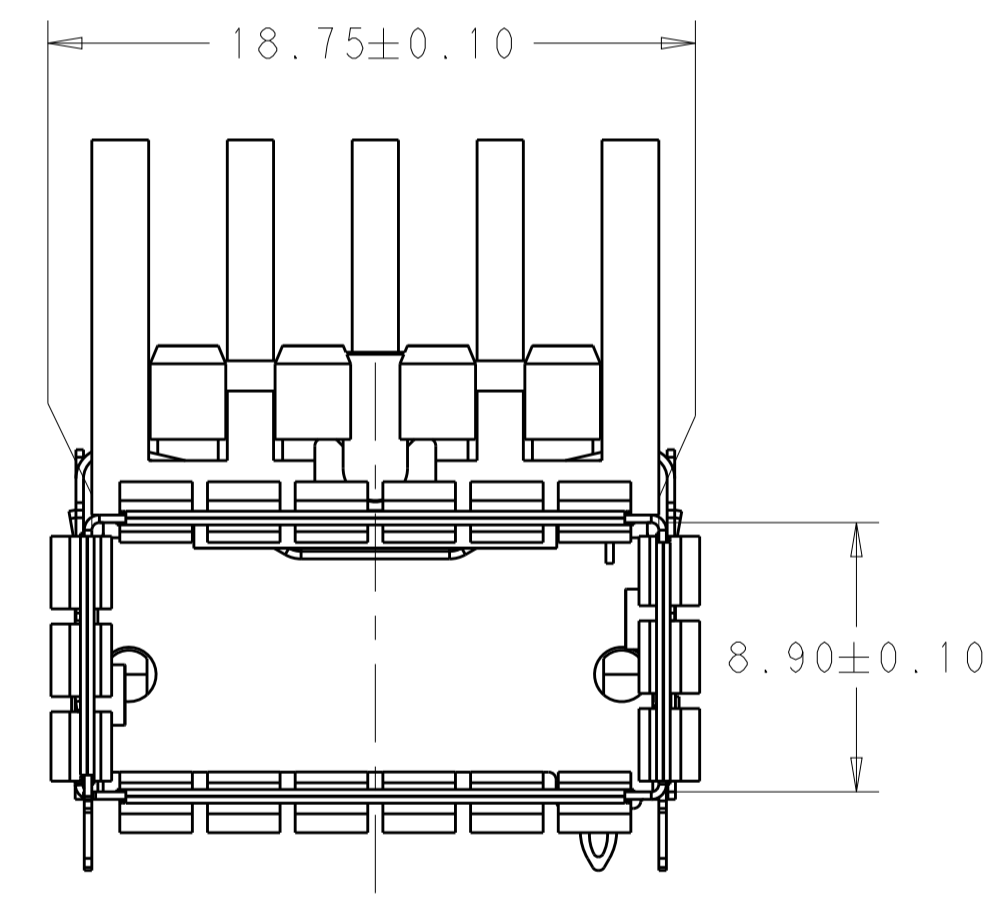
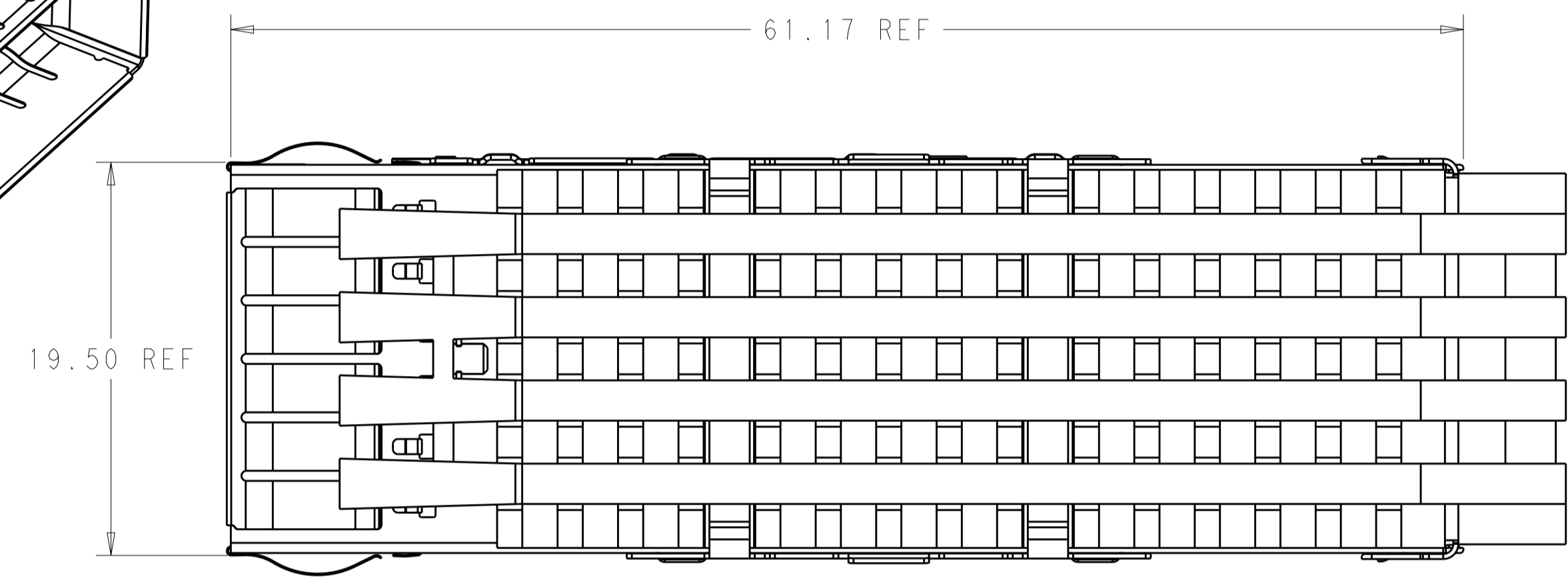
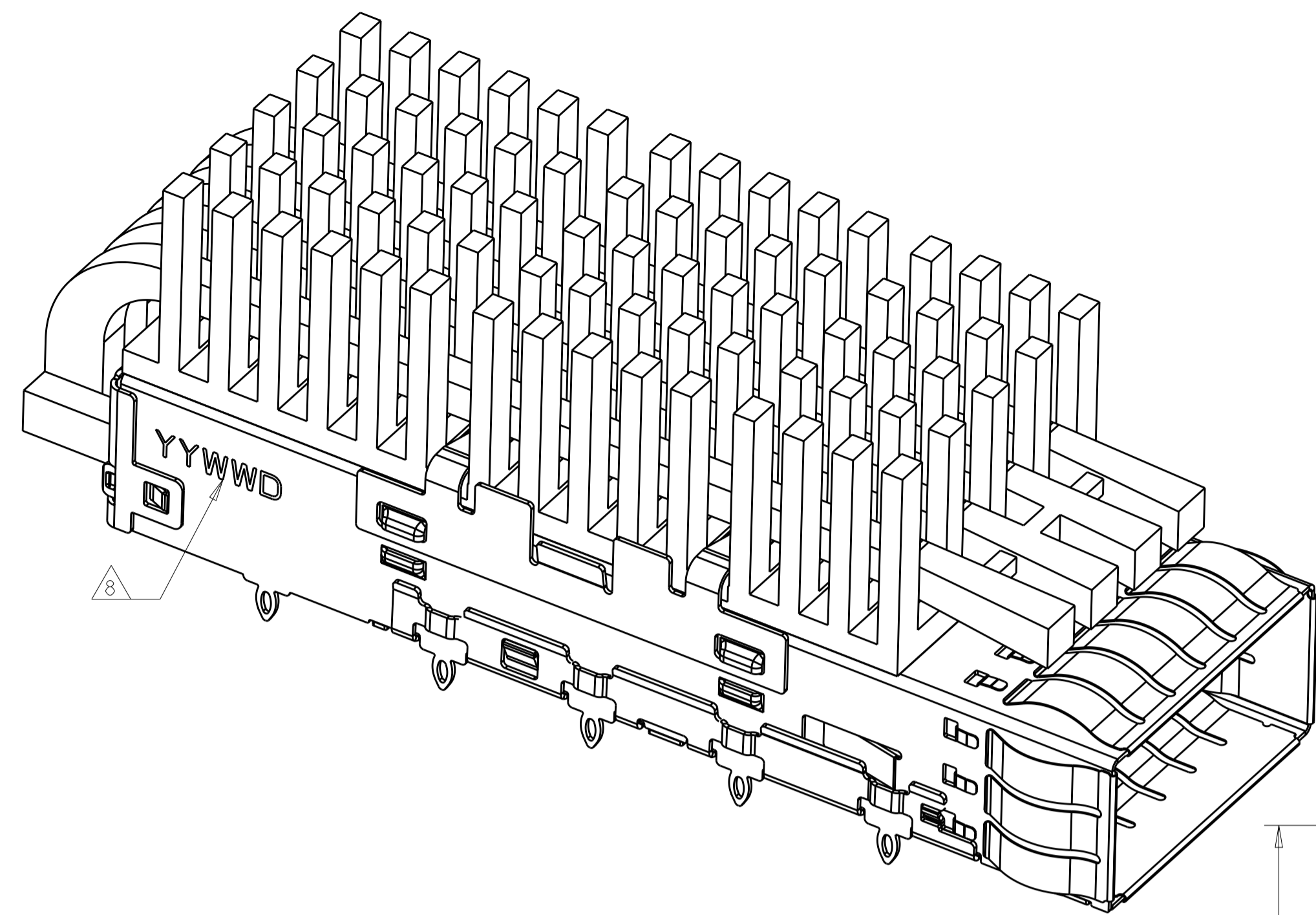

- MATERIAL:
 CAGE MATERIAL : 0.25 THICK NICKEL SILVER.
 SPRING MATERIAL : COPPER ALLOY
 HEAT SINK MATERIAL : ALUMINUM
 CLIP MATERIAL : STAINLESS STEEL
 LIGHT PIPE MATERIAL : POLYCARBONATE WITH 94 V-0
- FINISH:
 SPRING : NICKEL PLATING
 HEAT SINK : BLACK ANODIZE
- DIMENSION APPLIES WITH MODULE INSTALLED IN THE CAGE TO TOP OF HEAT SINK.
- REFERENCE APPLICATION SPEC 114-32023 FOR RECOMMENDED DRILL HOLE DIAMETER AND PLATING THICKNESS.
- DATUM AND BASIC DIMENSIONS ESTABLISHED BY CUSTOMERS.
- MINIMUM PC BOARD THICKNESS :
 SINGLE SIDED : 1.57 MIN
 DOUBLE SIDED : 2.20 MIN
- DATUM -A- IS TOP SURFACE OF THE HOST BOARD.
- DATE CODE (YYWWDD) MARKED APPROXIMATELY AS SHOWN
- MATES WITH QSFP28 MSA COMPATIBLE TRANSCEIVER.

| | |
|--|-------------------------------|
| NET WORKING | 2293574-1 |
| APPLICATION (HEAT SINK OPTION) | PART NUMBER |
| STE TE Connectivity | |
| NAME: CAGE ASSEMBLY, QSFP28, THRU BEZEL WITH EMI SPRING FINGER HEAT SINK, LIGHT PIPE | |
| SIZE: A1 | CAGE CODE: 00779 |
| DRAWING NO: C=2293574 | RESTRICTED TO: - |
| CUSTOMER DRAWING | SCALE: 2:1 SHEET 1 OF 4 REV A |

| | | |
|--|--------|-------------------------------|
| THIS DRAWING IS A CONTROLLED DOCUMENT. | | DMN: JASON YANG 09JUN2015 |
| DIMENSIONS: mm | | CHK: SEAN HAN 09JUN2015 |
| TOLERANCES UNLESS OTHERWISE SPECIFIED: | | APVD: MARSHALL CHEN 09JUN2015 |
| 0 PLC | ±0.25 | PRODUCT SPEC: 108-19428 |
| 1 PLC | ±0.25 | APPLICATION SPEC: 114-32023 |
| 2 PLC | ±0.20 | WEIGHT: - |
| 3 PLC | ±0.100 | FINISH: - |
| 4 PLC | ± | |
| ANGLES | ± | |

| LOC | DIST | REV | DATE | BY | APPV |
|-----|------|-----|------|----|------|
| | | 1 | | | |

| REVISIONS | | DATE | BY | APPV |
|-----------|-------------|------|----|------|
| P | LTN | | | |
| - | SEE SHEET 1 | - | - | - |

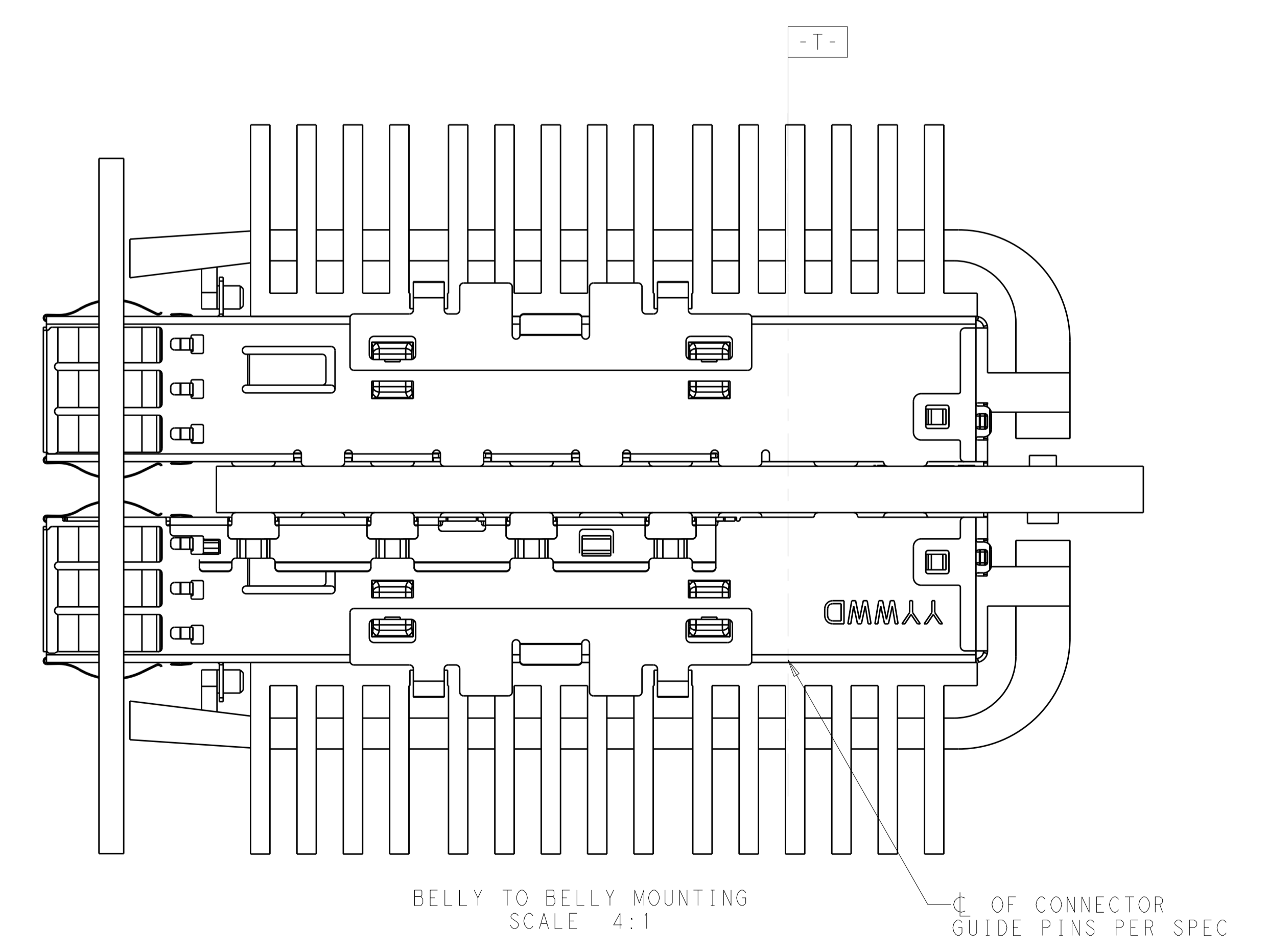
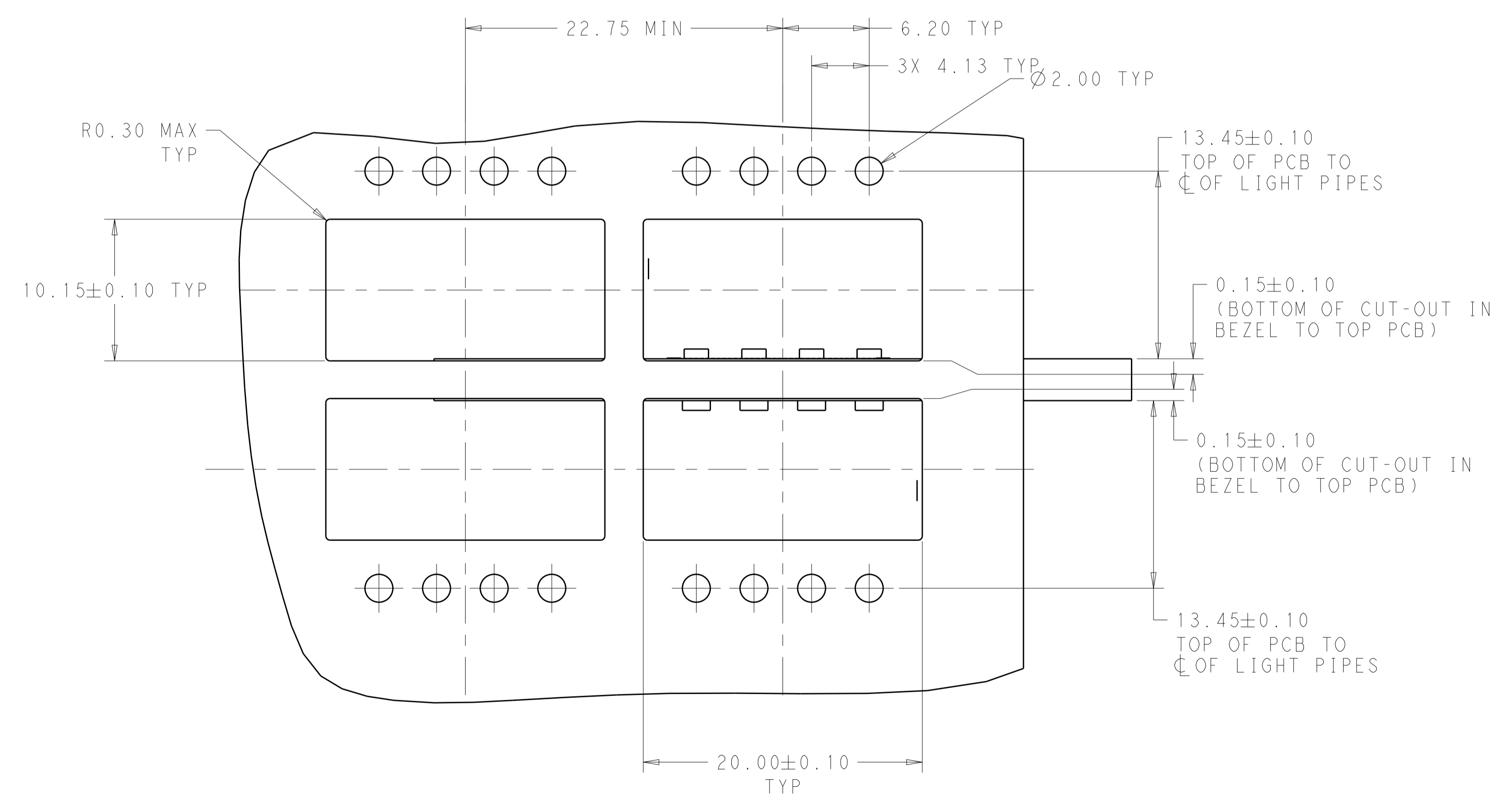
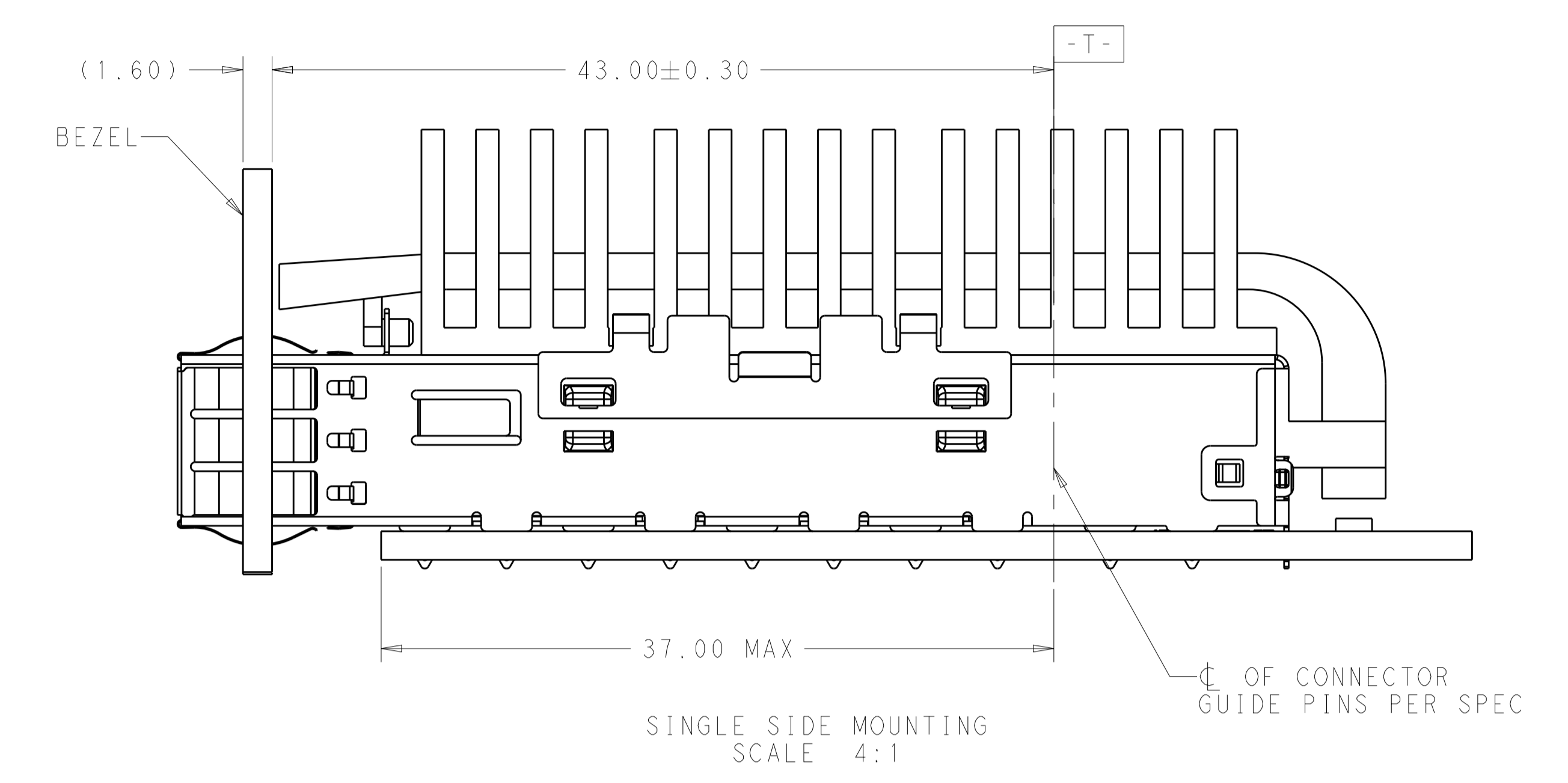
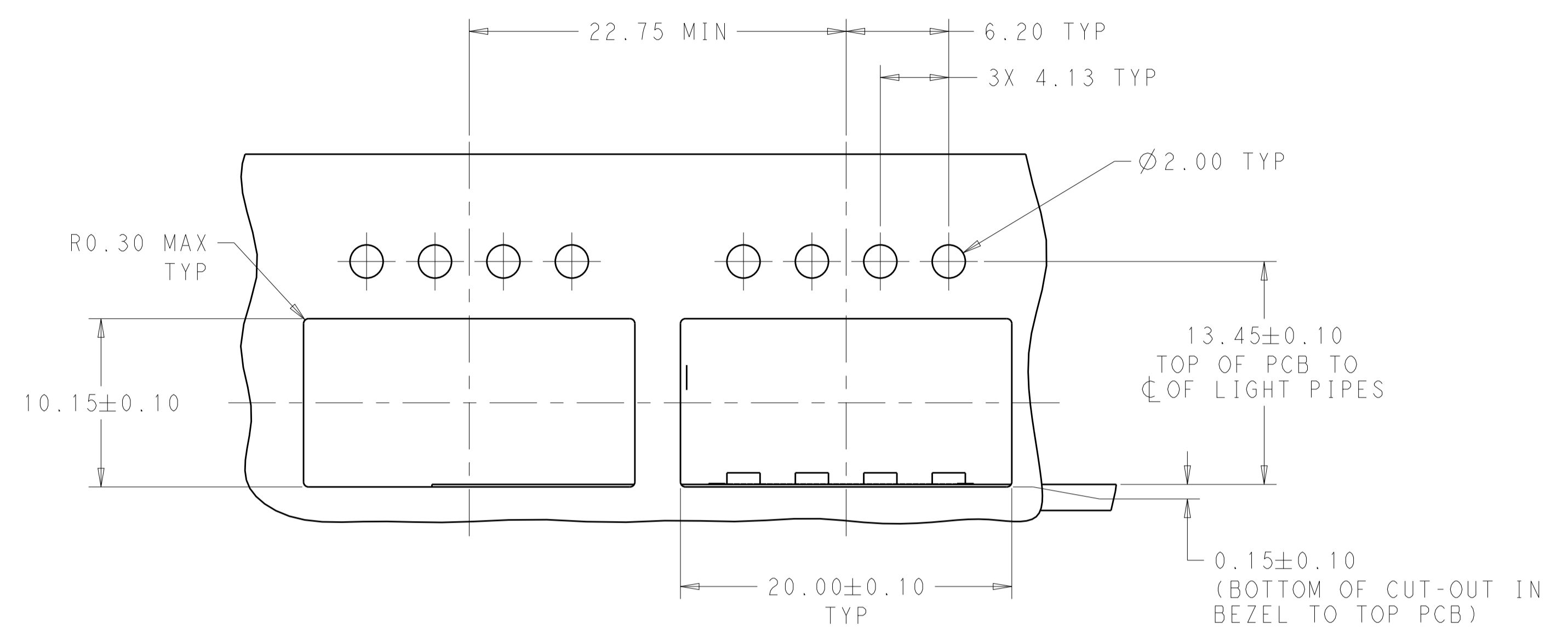

| | | | |
|--|--------|------------------------------|--|
| THIS DRAWING IS A CONTROLLED DOCUMENT. | | OWN: JASON YANG 09JUN2015 | TE Connectivity |
| DIMENSIONS: mm | | CHK: SEAN HAN 09JUN2015 | |
| TOLERANCES UNLESS OTHERWISE SPECIFIED: | | APV: MARSHALL CHEN 09JUN2015 | NAME: CAGE ASSEMBLY, QSFP28, THRU BEZEL WITH EMI SPRING FINGER HEAT SINK, LIGHT PIPE |
| 0 PLC | ±0.25 | PRODUCT SPEC | 108-19428 |
| 1 PLC | ±0.25 | APPLICATION SPEC | 114-32023 |
| 2 PLC | ±0.20 | SIZE: CAGE CODE DRAWING NO | A100779 |
| 3 PLC | ±0.100 | WEIGHT | C=2293574 |
| 4 PLC | ± | CUSTOMER DRAWING | SCALE 2:1 SHEET 2 OF 4 REV A |
| ANGLES | ± | | |
| FINISH | | | |

| LOC | DIST | REV | DATE | BY | APPV |
|-----|------|-------------|------|----|------|
| - | - | SEE SHEET 1 | - | - | - |

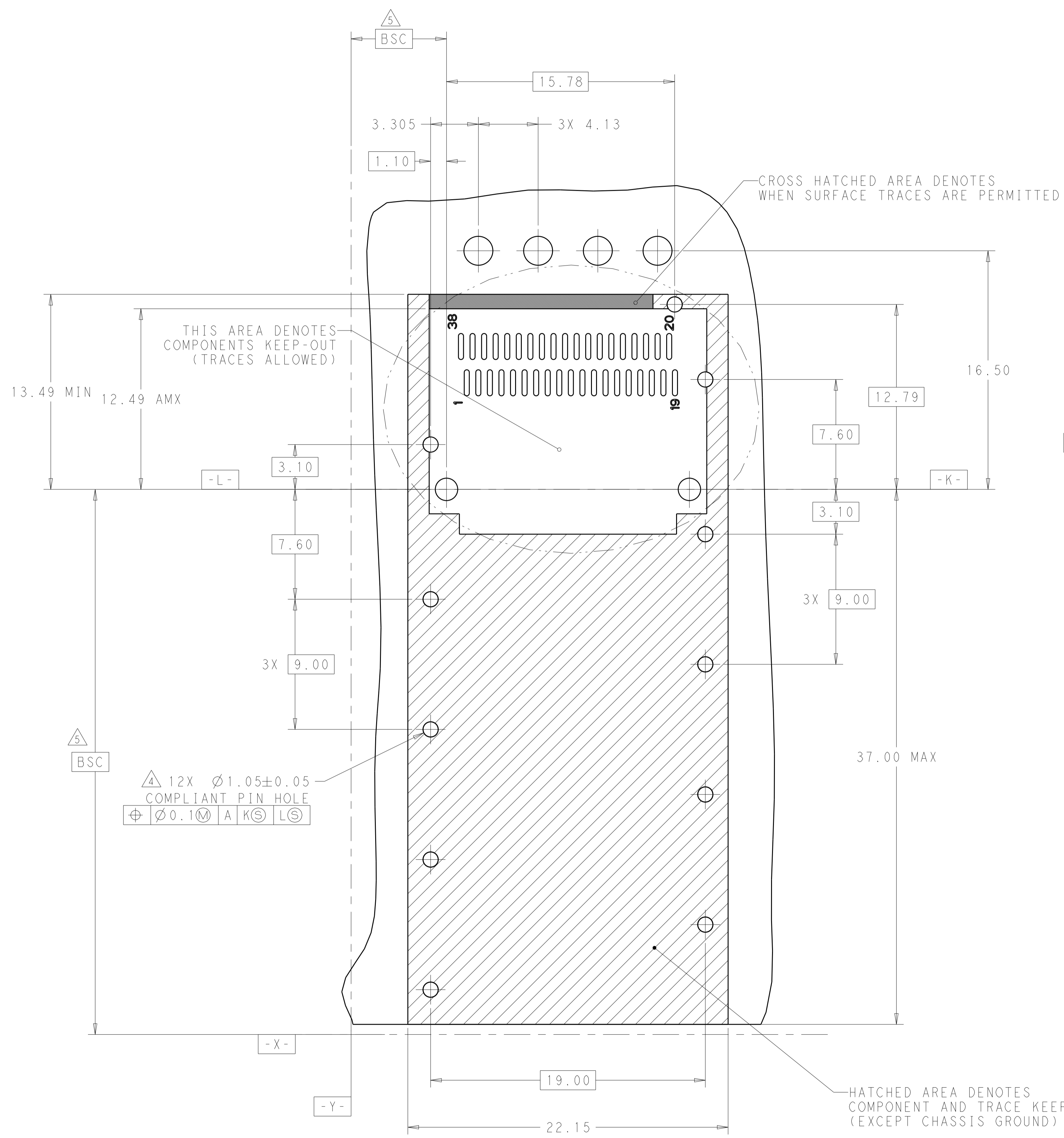

RECOMMENDED PCB LAYOUT
 SINGLE TYPE OF 2 REAR HOLES OF LEGS
 PCB TOLERANCE: ±0.05
 SCALE 6:1

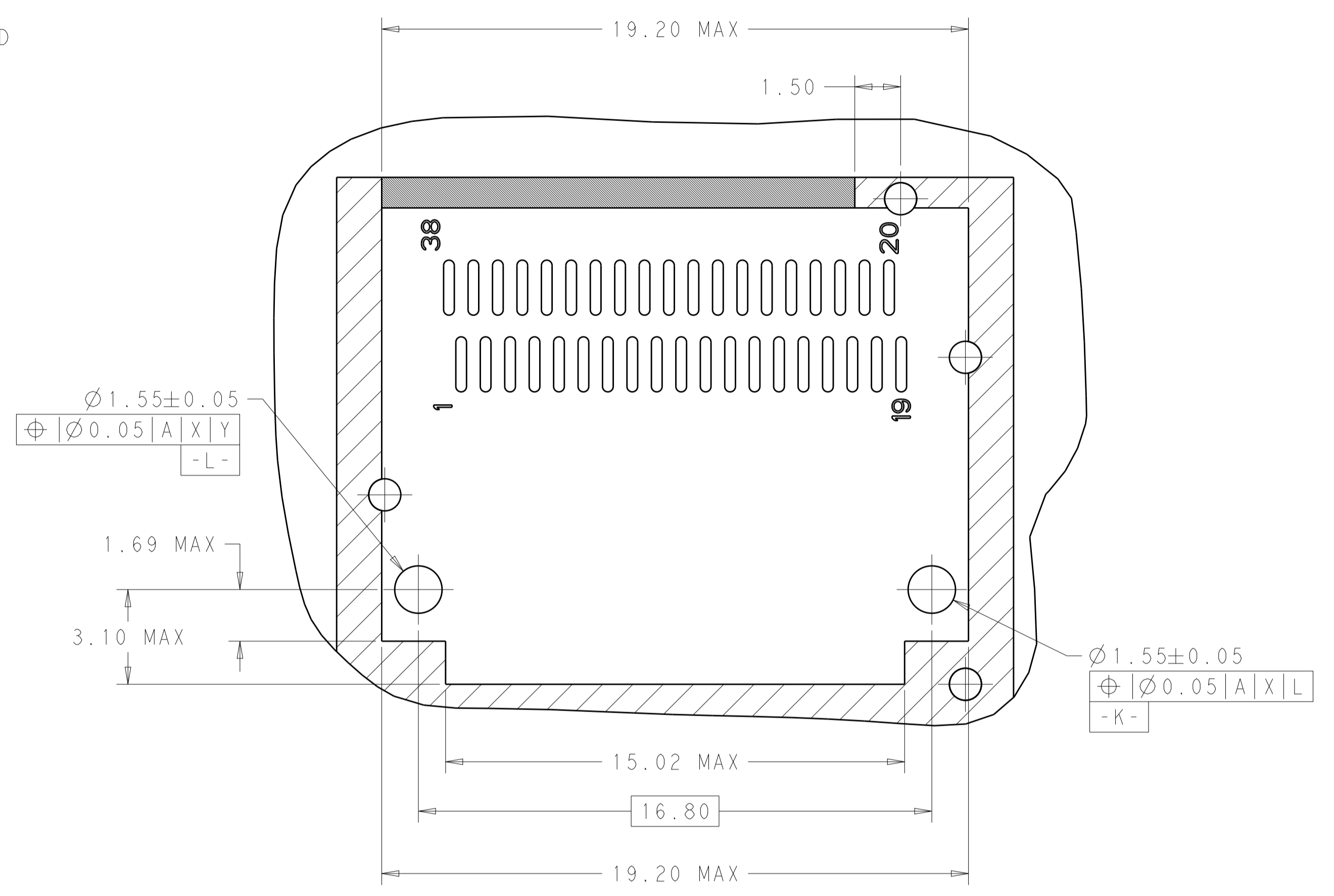

DETAIL B
 SCALE 8:1

| | | | |
|--|--------------|-------------------------------|--|
| THIS DRAWING IS A CONTROLLED DOCUMENT. | | DWN: JASON YANG 09JUN2015 | TE Connectivity |
| DIMENSIONS: mm | | CHK: SEAN HAN 09JUN2015 | |
| TOLERANCES UNLESS OTHERWISE SPECIFIED: | | APVD: MARSHALL CHEN 09JUN2015 | NAME: CAGE ASSEMBLY, QSPF28, THRU BEZEL WITH EMI SPRING FINGER HEAT SINK, LIGHT PIPE |
| 0 PLC ±0.25 | 1 PLC ±0.25 | PRODUCT SPEC: 108-19428 | SIZE: A100779 |
| 2 PLC ±0.20 | 3 PLC ±0.100 | APPLICATION SPEC: 114-32023 | CAGE CODE: C=2293574 |
| 4 PLC ±0.100 | ANGLES ±° | WEIGHT: - | RESTRICTED TO: - |
| MATERIAL: - | FINISH: - | CUSTOMER DRAWING | SCALE: 2:1 SHEET 3 OF 4 REV A |

| LOC | | DIST | | REVISIONS | | | |
|-----|-----|-------------|------|-----------|------|--|--|
| P | LTN | DESCRIPTION | DATE | DWN | APVD | | |
| - | | SEE SHEET 1 | | | | | |

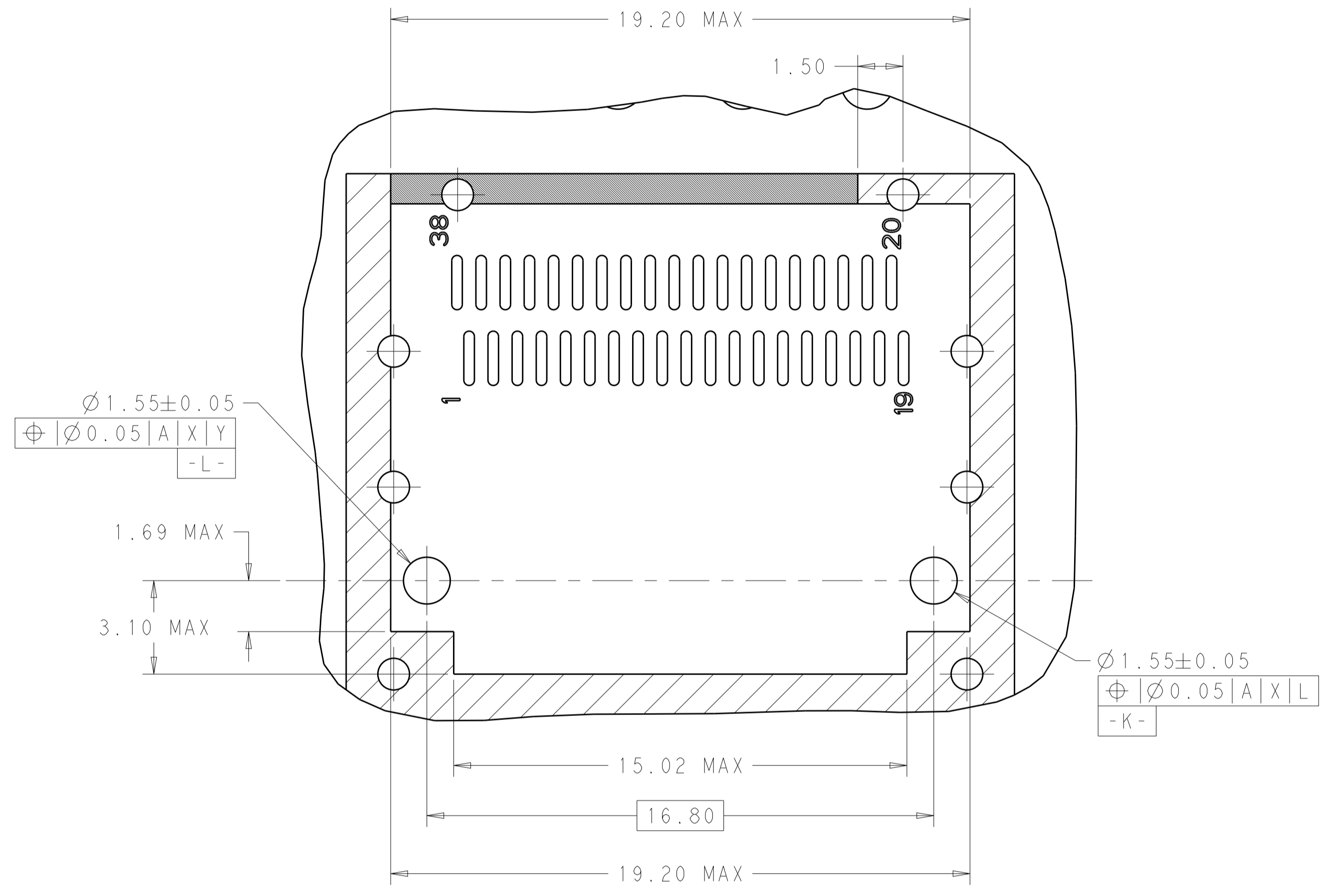
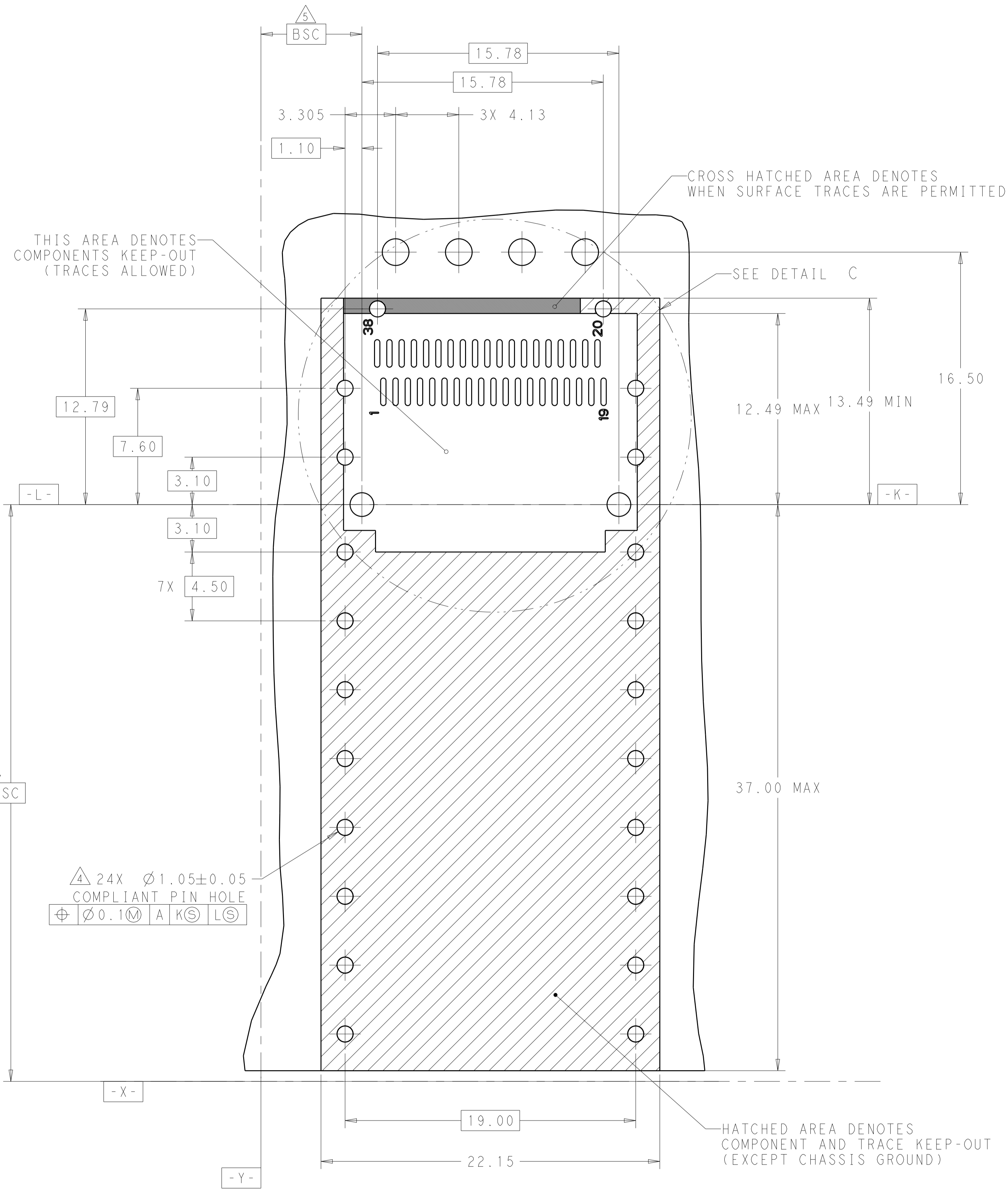

DETAIL C
SCALE 8:1

RECOMMENDED PCB LAYOUT
BELLY TO BELLY TYPE OF 2 REAR HOLES OF LEGS
PCB TOLERANCE: ± 0.05
SCALE 6:1

| | | | |
|--|-------------|-------------------------------|--|
| THIS DRAWING IS A CONTROLLED DOCUMENT. | | DWN: JASON YANG 09JUN2015 | TE Connectivity |
| DIMENSIONS: mm | | CHK: SEAN HAN 09JUN2015 | |
| TOLERANCES UNLESS OTHERWISE SPECIFIED: | | APVD: MARSHALL CHEN 09JUN2015 | NAME: CAGE ASSEMBLY, QSPF28, THRU BEZEL WITH EMI SPRING FINGER HEAT SINK, LIGHT PIPE |
| 0 PLC | ± 0.25 | PRODUCT SPEC | SIZE: CAGE CODE DRAWING NO |
| 1 PLC | ± 0.25 | 108-19428 | RESTRICTED TO |
| 2 PLC | ± 0.20 | APPLICATION SPEC | A100779C=2293574 |
| 3 PLC | ± 0.100 | 114-32023 | SCALE 2:1 SHEET 4 OF 4 REV A |
| 4 PLC | \pm | WEIGHT | |
| ANGLES | \pm | CUSTOMER DRAWING | |
| MATERIAL | | | |
| FINISH | | | |