



Chipsmall Limited consists of a professional team with an average of over 10 year of expertise in the distribution of electronic components. Based in Hongkong, we have already established firm and mutual-benefit business relationships with customers from,Europe,America and south Asia,supplying obsolete and hard-to-find components to meet their specific needs.

With the principle of “Quality Parts,Customers Priority,Honest Operation,and Considerate Service”,our business mainly focus on the distribution of electronic components. Line cards we deal with include Microchip,ALPS,ROHM,Xilinx,Pulse,ON,Everlight and Freescale. Main products comprise IC,Modules,Potentiometer,IC Socket,Relay,Connector.Our parts cover such applications as commercial,industrial, and automotives areas.

We are looking forward to setting up business relationship with you and hope to provide you with the best service and solution. Let us make a better world for our industry!



## Contact us

Tel: +86-755-8981 8866 Fax: +86-755-8427 6832

Email & Skype: [info@chipsmall.com](mailto:info@chipsmall.com) Web: [www.chipsmall.com](http://www.chipsmall.com)

Address: A1208, Overseas Decoration Building, #122 Zhenhua RD., Futian, Shenzhen, China



D

C

B

A

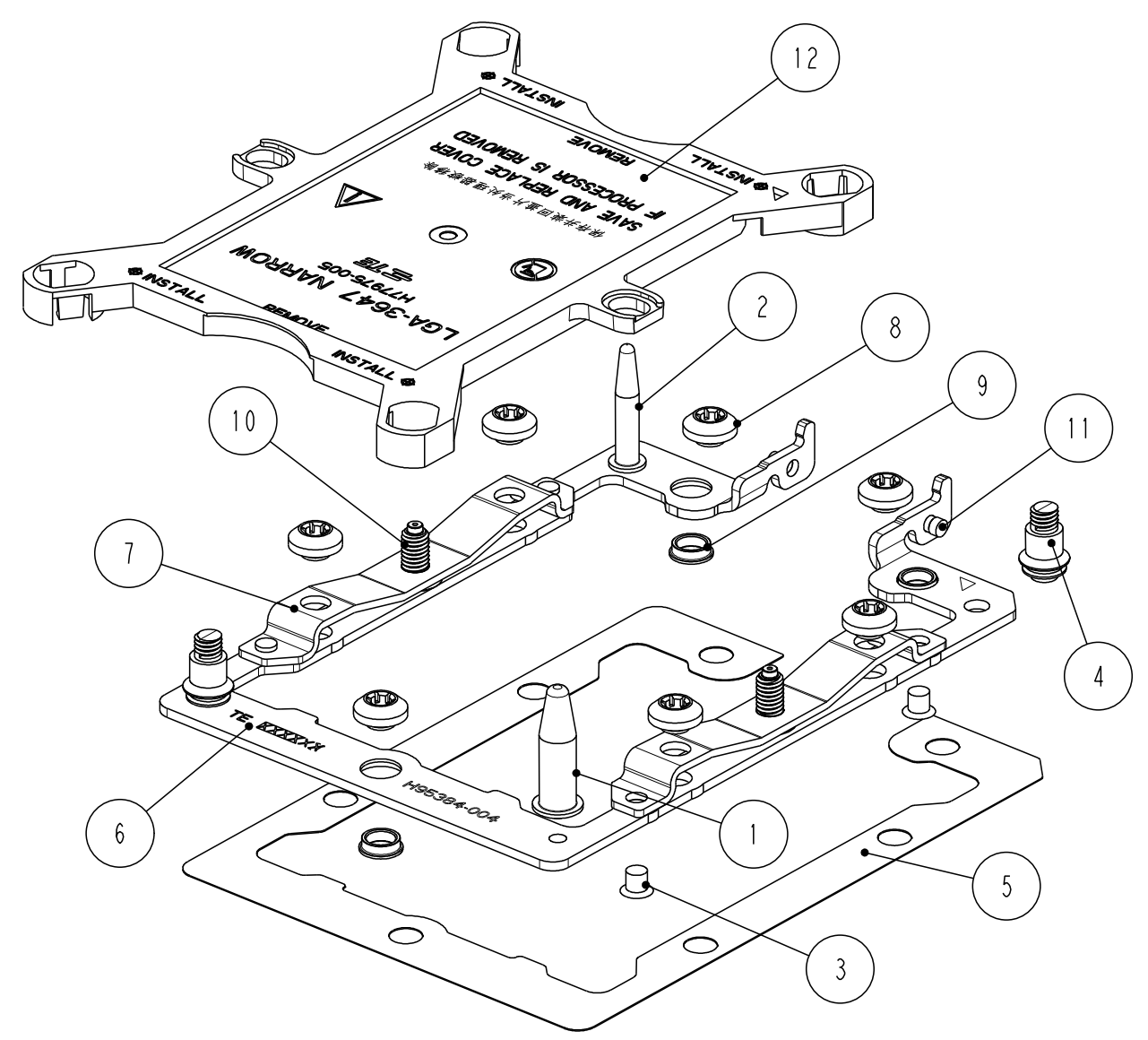
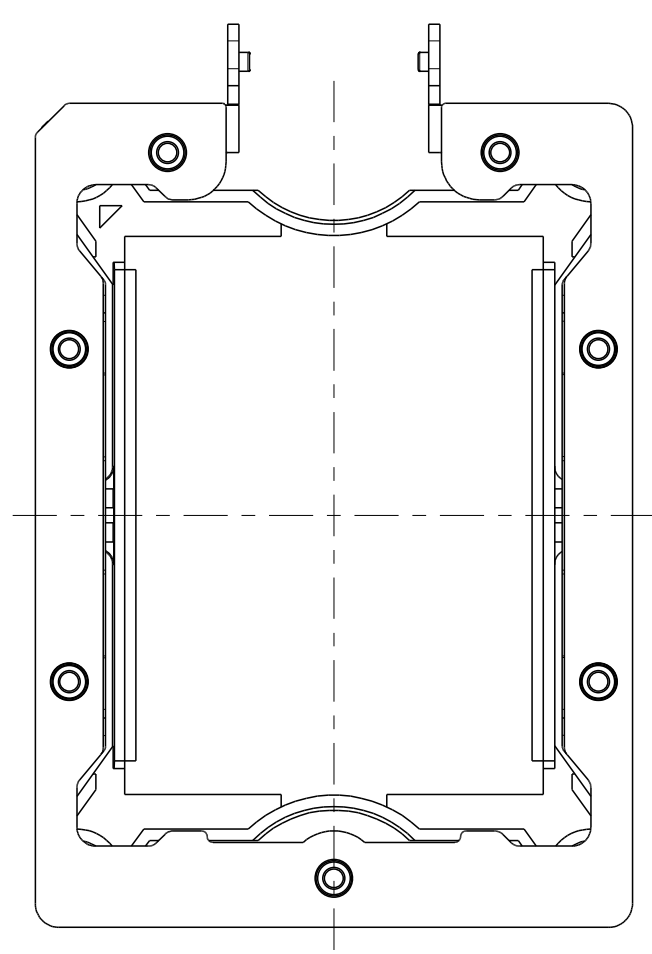
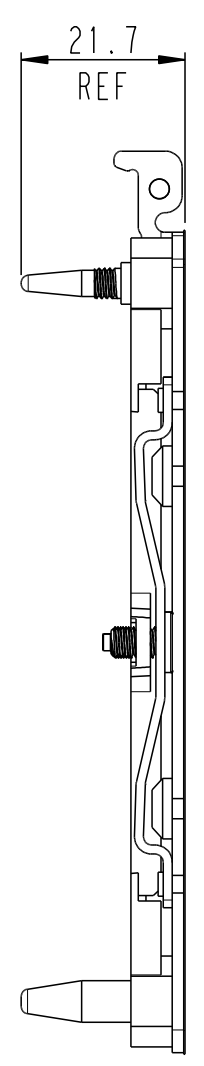
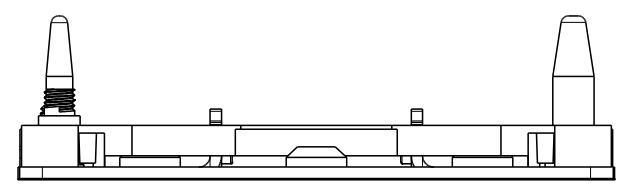
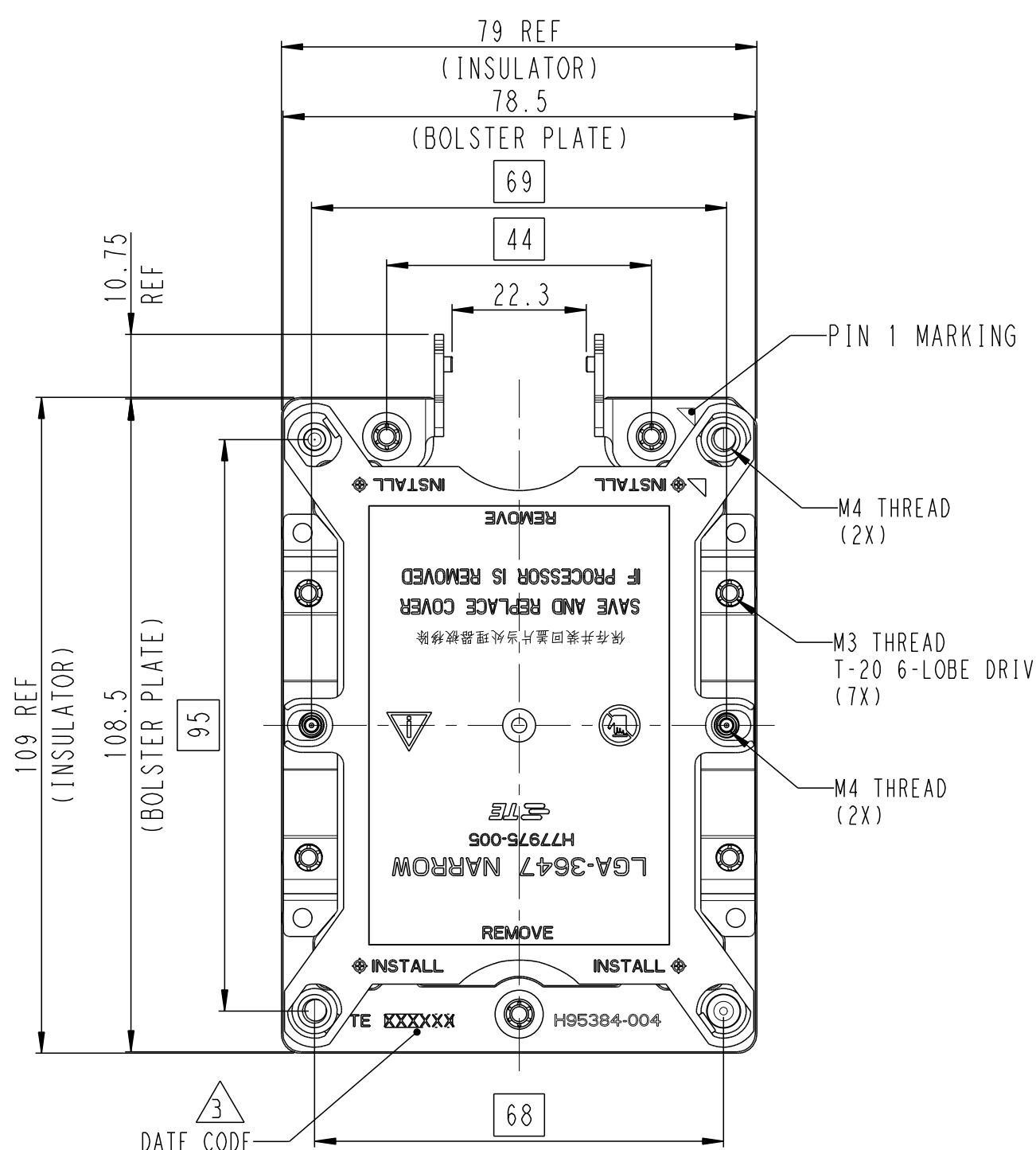

- NOTES:
- MATERIAL:
    - BOLSTER LARGE GUIDE POST: STAINLESS STEEL
    - BOLSTER SMALL GUIDE POST: STAINLESS STEEL
    - SKT-P-KNL, SPRING RIVET: STAINLESS STEEL
    - SKX BOLSTER CORNER STANDOFF: STAINLESS STEEL
    - SKX NRW NON FABRIC BOLSTER INSULATOR:  
-POLYCARBONATE FILM PLUS ACRYLIC ADHESIVE LAYER
    - SKX NRW NON FABRIC BOLSTER PLATE: STAINLESS STEEL
    - SKX-EP NRW SPRING: STAINLESS STEEL
    - SOCKET P M3 BOLSTER CAPTIVE NUT: CARBON STEEL, NICKEL PLATING
    - SOCKET P M3 BOLSTER CAPTIVE NUT COLLAR: CARBON STEEL, NICKEL PLATING
    - SKT-EP SPRING STUD: STAINLESS STEEL
    - KNL BOLSTER LEC GUIDE PIN: STAINLESS STEEL
    - NRW DUST COVER: THERMO-PLASTIC, UL94V-0, BLACK
  - ASSEMBLED WITH BOLSTER ASSEMBLY P/N: 2299805 SERIES
  - INDICATED DATE CODE ON THE BOLSTER PLATE

P/N: 2310924-1 AS SHOW  
(NRW FABRIC TYPE WITH COVER)

1	NRW DUST COVER	12
2	KNL BOLSTER LEC GUIDE PIN	11
2	SKT-EP SPRING STUD	10
3	SOCKET P M3 BOLSTER CAPTIVE NUT COLLAR	9
7	SOCKET P M3 BOLSTER CAPTIVE NUT	8
2	SKX-EP NRW SPRING	7
1	SKX NRW FABRIC BOLSTER PLATE	6
1	SKX NRW NON FABRIC BOLSTER INSULATOR	5
2	SKX BOLSTER CORNER STANDOFF	4
4	SKT-P-KNL, SPRING RIVET	3
1	KNL BOLSTER SMALL GUIDE POST	2
1	KNL BOLSTER LARGE GUIDE POST	1
Q'TY	DESCRIPTION	ITEM

THIS DRAWING IS A CONTROLLED DOCUMENT.

DIMENSIONS:  
mm

MATERIAL  
-

TOLERANCES UNLESS OTHERWISE SPECIFIED:

0 PLC	±0.3
1 PLC	±0.3
2 PLC	±0.3
3 PLC	±0.3
4 PLC	±0.3
ANGLES	±3
FINISH	-

DWN  
JEFF WANG  
14-Nov-2016

CHK  
SIMON LI  
14-Nov-2016

APVD  
COREL WANG  
14-Nov-2016

PRODUCT SPEC  
108-115115

APPLICATION SPEC  
114-115011

WEIGHT  
-

CUSTOMER DRAWING

TE Connectivity

NAME  
SKX-EP NRW FABRIC BOLSTER PLATE ASSY

SIZE A2	CAGE CODE -	DRAWING NO C=2310924	RESTRICTED TO -
------------	----------------	-------------------------	--------------------

SCALE 1:1	SHEET 1 OF 2	REV A
--------------	-----------------	----------

P	LTR	DESCRIPTION	DATE	DWN	APVD
	-	SEE SHEET 1	-	-	-

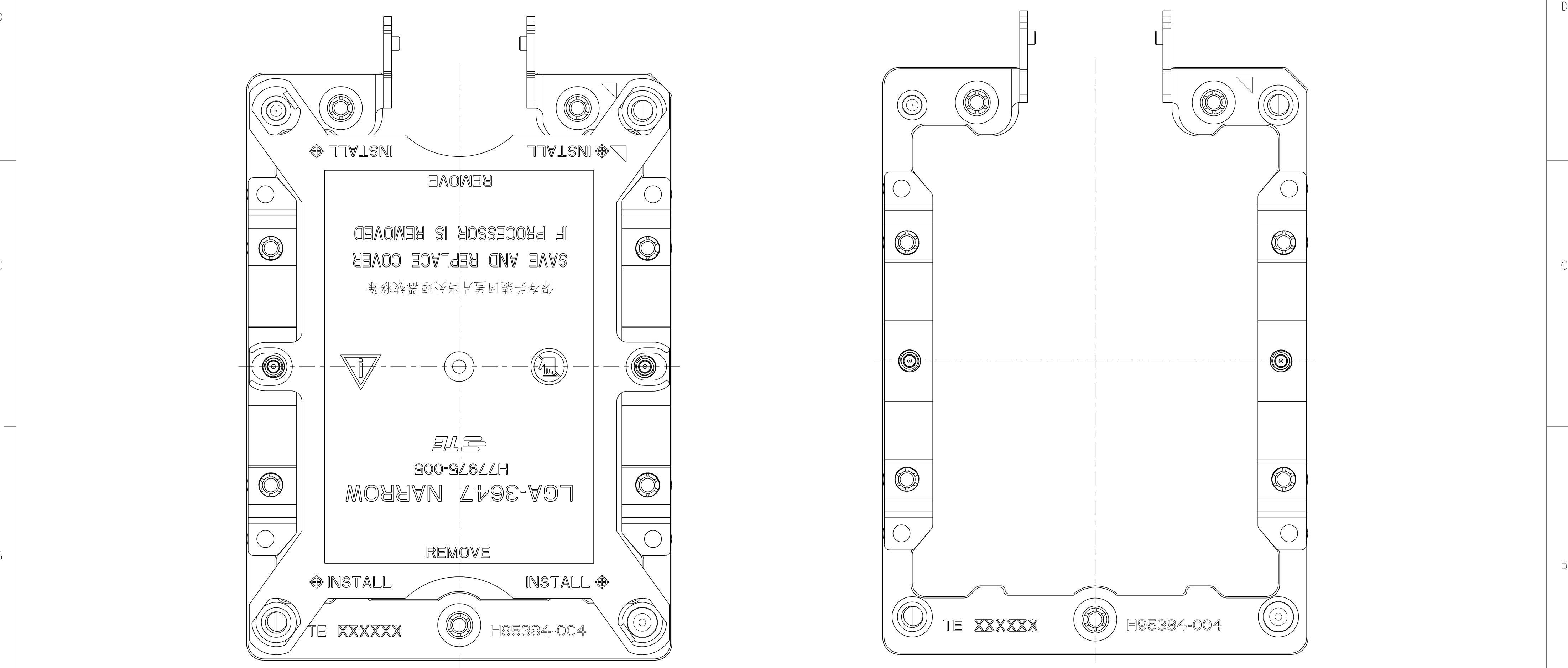

NRW FABRIC TYPE WITH COVER  
P/N: 2310924-1

NRW FABRIC TYPE WITHOUT COVER  
P/N: 2310924-3  
ALL DIMENSIONS SAME WITH -1

THIS DRAWING IS A CONTROLLED DOCUMENT.

DIMENSIONS:  
mm

MATERIAL  
-

TOLERANCES UNLESS OTHERWISE SPECIFIED:

0 PLC	±0.3
1 PLC	±0.3
2 PLC	±0.3
3 PLC	±0.3
4 PLC	±0.3
ANGLES	±3
FINISH	-

DWN  
JEFF WANG  
14-Nov-2016

CHK  
SIMON LI  
14-Nov-2016

APVD  
COREL WANG  
14-Nov-2016

PRODUCT SPEC  
108-115115

APPLICATION SPEC  
114-115011

WEIGHT  
-

CUSTOMER DRAWING

TE Connectivity

NAME  
SKX-EP NRW FABRIC BOLSTER PLATE ASSY

SIZE A2	CAGE CODE -	DRAWING NO C-2310924	RESTRICTED TO -
SCALE 2:1	SHEET 2	OF 2	REV A