



Chipsmall Limited consists of a professional team with an average of over 10 year of expertise in the distribution of electronic components. Based in Hongkong, we have already established firm and mutual-benefit business relationships with customers from,Europe,America and south Asia,supplying obsolete and hard-to-find components to meet their specific needs.

With the principle of “Quality Parts,Customers Priority,Honest Operation,and Considerate Service”,our business mainly focus on the distribution of electronic components. Line cards we deal with include Microchip,ALPS,ROHM,Xilinx,Pulse,ON,Everlight and Freescale. Main products comprise IC,Modules,Potentiometer,IC Socket,Relay,Connector.Our parts cover such applications as commercial,industrial, and automotives areas.

We are looking forward to setting up business relationship with you and hope to provide you with the best service and solution. Let us make a better world for our industry!



## Contact us

Tel: +86-755-8981 8866 Fax: +86-755-8427 6832

Email & Skype: info@chipsmall.com Web: www.chipsmall.com

Address: A1208, Overseas Decoration Building, #122 Zhenhua RD., Futian, Shenzhen, China



**THERMOFIT • SPECIFICATION CONTROL DRAWING • MOLDED PARTS**

**NOTES**

- All dimensions are in inches.
- Dimensions appearing in table are as follows:  
a - AS SUPPLIED    b - AFTER UNRESTRICTED RECOVERY
- The following coatings are optional:  
S-1017 (I/42) adhesive and  
S-1048 (I/86) adhesive  
for -3 or -4 material only  
Dimensions appearing in table are for uncoated parts. When coating is added entry diameters will be reduced .06 max.
- Molding ports are optional. When -00 modification number is specified they will be located as shown.
- Weight shown in table of dimensions is based on polyolefin part.

**ORDERING INFORMATION**

Matl. No.	Description	Raychem RT Spec
-3	Polyolefin, Semi-Rigid	RT-301
-4	Polyolefin, Flexible	RT-1304
-8	Polyolefin, Space	RT-1308
-25	Elastomer, Semi-Rigid	RT-1325

Add material dash number as suffix to part number;  
Example 1 - Order 234A711-3 when polyolefin, semi-rigid is required.

Add coating slash number as suffix to material dash number when coating is required.  
Example 2 - Order 234A752-XI/42 when S-1017 adhesive is required.

Example 3 - Order 234A732-3-00 when molding ports are required.

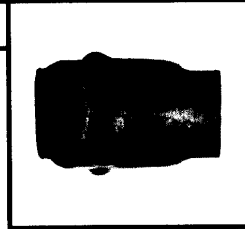
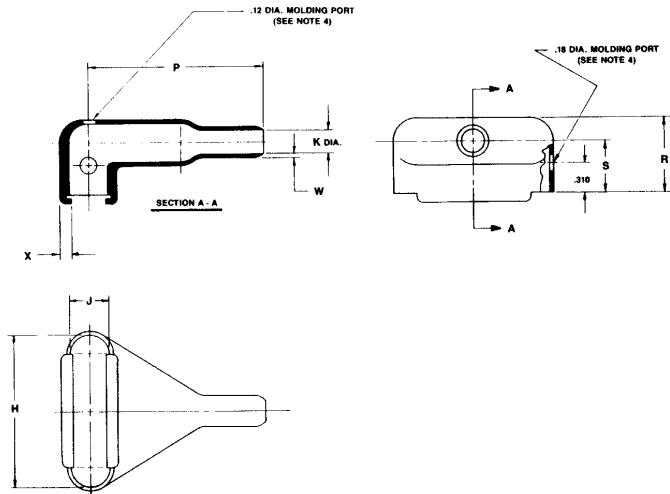

AS SUPPLIED

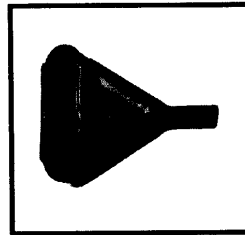

AFTER UNRESTRICTED RECOVERY

If this document is printed it becomes uncontrolled.  
Check for the latest revision.

**TABLE OF DIMENSIONS**

PART NUMBER	H		J		K		P	R	S	W	X	Weight lbs ±10%	This Boot Fits Cannon
	Min a	±5% b	Min a	±5% b	Min a	Max b	±10% b	±10% b	±10% b	±20% b	±20% b		
234A711	.63	.80	.63	.42	.63	.16	1.10	.73	.50	.04	.12	.0059	DE-9
234A721	.75	1.11	.75	.42	.75	.21	1.38	.74	.50	.04	.12	.0086	DA-15
234A732	1.15	1.66	1.15	.42	1.15	.25	1.87	.79	.56	.04	.12	.0143	DB-25
234A742	1.35	2.31	1.35	.42	1.35	.31	2.35	.79	.56	.04	.12	.0220	DC-37
234A752	1.48	2.28	1.48	.54	1.48	.36	2.49	1.04	.69	.04	.12	.0260	DD-50

**Raychem**

Raychem Corporation  
300 Constitution Drive  
Menlo Park, CA 94025-1164  
415) 361 6055

E.O.	REV	DATE	DESCRIPTION

DRN	JC
CHK'D	JSC
AUTH	RKG
AUTH	DDR

PART DESCRIPTION  
BOOT, RECTANGULAR,  
SUBMINIATURE, 90° SIDE ENTRY,  
OVEREXPANDED

PART NO.	REV LTR
<b>234A711 thru 752</b>	<b>F</b>
DATE:	September 3, 1987