



Chipsmall Limited consists of a professional team with an average of over 10 year of expertise in the distribution of electronic components. Based in Hongkong, we have already established firm and mutual-benefit business relationships with customers from,Europe,America and south Asia,supplying obsolete and hard-to-find components to meet their specific needs.

With the principle of “Quality Parts,Customers Priority,Honest Operation,and Considerate Service”,our business mainly focus on the distribution of electronic components. Line cards we deal with include Microchip,ALPS,ROHM,Xilinx,Pulse,ON,Everlight and Freescale. Main products comprise IC,Modules,Potentiometer,IC Socket,Relay,Connector.Our parts cover such applications as commercial,industrial, and automotives areas.

We are looking forward to setting up business relationship with you and hope to provide you with the best service and solution. Let us make a better world for our industry!



## Contact us

Tel: +86-755-8981 8866 Fax: +86-755-8427 6832

Email & Skype: info@chipsmall.com Web: www.chipsmall.com

Address: A1208, Overseas Decoration Building, #122 Zhenhua RD., Futian, Shenzhen, China



REV.	DATE	DESCRIPTION
A	03/27/05	UPDATE DRAWING FORMAT
B	05/12/05	MODIFY BODY DIMENSIONS

STAMP 4 POINTS (SEE REMARKS 1,2)

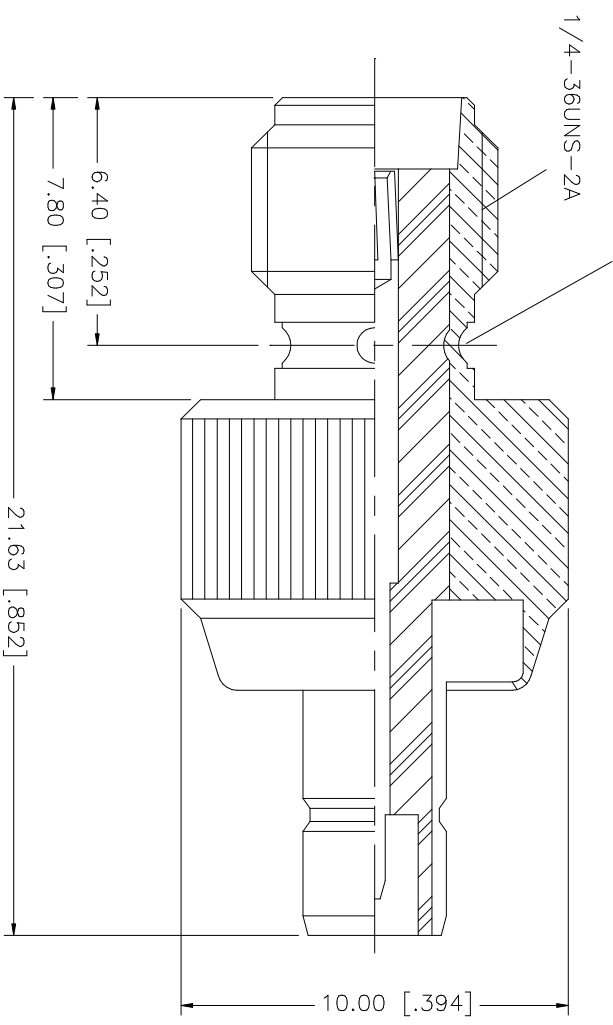

REMARKS:

- NO.2 MUST WITHSTAND A 6LBS. MIN. PUSHOUT FORCE FROM NO.2 AFTER STAMPING OPERATION.
- REMARK 1. IS MAINTAINED BY STAMPING THE FOUR POINTS SHOWN ON THE DRAWING WITHOUT PUNCTURING NO.1

NO.	DESCRIPTION	MATERIAL	FINISH	QTY	UNLESS OTHERWISE SPECIFIED DIMENSIONS ARE IN INCHES AND FOR CUSTOMER REFERENCE ONLY. TOLERANCES FOR MILLIMETERS ARE: 0.5 - 8mm ± 0.20mm 8 - 30mm ± 0.40mm 30 - 120mm ± 0.50mm UNLESS OTHERWISE SPECIFIED TOLERANCES FOR INCHES ARE: .020 - .315 = ± 0.007" .315 - 1.180 = ± 0.015" 1.180 - 4.724 = ± 0.020"	DO NOT SCALE DRAWING	APPROVALS	DATE	PART DESCRIPTION							
8							DRAWN	G.R.S.	05/12/05	<p><b>Amphenol Connex</b></p> <p>SMA JACK TO SMB JACK ADAPTER</p> <p>242147</p>						
7							CHECKED									
6							ISSUED									
5							SHEET	1 OF 1								
4	CONTACT PIN	BER. COPPER	GOLD	1												
3	INSULATOR	TEFLON	NATURAL	1												
2	BODY	BRASS	GOLD	1												
1	DESCRIPTION	MATERIAL	FINISH	QTY			CAD FILE	C:/242/242147.DWG	DWG. NO.	242147.DWG	REV.	B	SIZE	A	SCALE	NA