



Chipsmall Limited consists of a professional team with an average of over 10 year of expertise in the distribution of electronic components. Based in Hongkong, we have already established firm and mutual-benefit business relationships with customers from,Europe,America and south Asia,supplying obsolete and hard-to-find components to meet their specific needs.

With the principle of “Quality Parts,Customers Priority,Honest Operation,and Considerate Service”,our business mainly focus on the distribution of electronic components. Line cards we deal with include Microchip,ALPS,ROHM,Xilinx,Pulse,ON,Everlight and Freescale. Main products comprise IC,Modules,Potentiometer,IC Socket,Relay,Connector.Our parts cover such applications as commercial,industrial, and automotives areas.

We are looking forward to setting up business relationship with you and hope to provide you with the best service and solution. Let us make a better world for our industry!



Contact us

Tel: +86-755-8981 8866 Fax: +86-755-8427 6832

Email & Skype: info@chipsmall.com Web: www.chipsmall.com

Address: A1208, Overseas Decoration Building, #122 Zhenhua RD., Futian, Shenzhen, China



REV.	DATE	DESCRIPTION
A	03/27/05	UPDATE DRAWING FORMAT

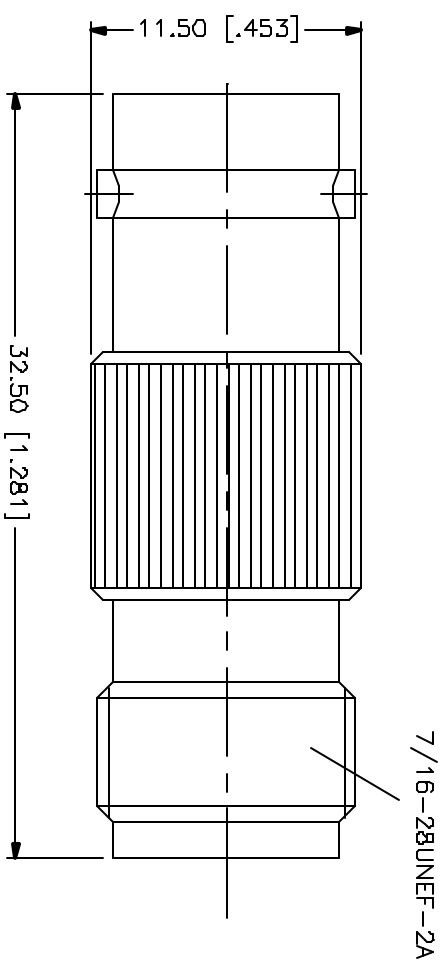

QTY	FINISH	MATERIAL	DESCRIPTION
1	GOLD	PHOS. BRONZE	CONTACT FIN
1	NATURAL	TEFLON	INSULATOR
1	NICKEL	BRASS	BODY

APPROVALS	DATE
DRAWN G.R.S.	03/27/05
CHECKED	
ISSUED	
SHEET 1 OF 1	

Amphenol Connex PART DESCRIPTION BNC FEMALE TO TNC FEMALE ADAPTER PART NO. 242150		DWG. NO. 242150.DWG REV. A SIZE A SCALE NA
---	--	---

UNLESS OTHERWISE SPECIFIED DIMENSIONS ARE IN MILLIMETERS (DIMENSIONS IN [] ARE IN INCHES AND THE DIMENSION REFERENCE DATA.) UNLESS OTHERWISE SPECIFIED TOLERANCES FOR ALL DIMENSIONS ARE: 0.5 - 8mm ± 0.20mm 8 - 50mm ± 0.40mm 50 - 125mm ± 0.50mm UNLESS OTHERWISE SPECIFIED TOLERANCES FOR HOLE DIA. ARE: .020 - .315 ± 0.0075 .315 - 1.180 ± 0.015 1.180 - 4.724 ± 0.020	DO NOT SCALE DRAWING
--	----------------------