



Chipsmall Limited consists of a professional team with an average of over 10 year of expertise in the distribution of electronic components. Based in Hongkong, we have already established firm and mutual-benefit business relationships with customers from,Europe,America and south Asia,supplying obsolete and hard-to-find components to meet their specific needs.

With the principle of “Quality Parts,Customers Priority,Honest Operation,and Considerate Service”,our business mainly focus on the distribution of electronic components. Line cards we deal with include Microchip,ALPS,ROHM,Xilinx,Pulse,ON,Everlight and Freescale. Main products comprise IC,Modules,Potentiometer,IC Socket,Relay,Connector.Our parts cover such applications as commercial,industrial, and automotives areas.

We are looking forward to setting up business relationship with you and hope to provide you with the best service and solution. Let us make a better world for our industry!



## Contact us

Tel: +86-755-8981 8866 Fax: +86-755-8427 6832

Email & Skype: info@chipsmall.com Web: www.chipsmall.com

Address: A1208, Overseas Decoration Building, #122 Zhenhua RD., Futian, Shenzhen, China



REV.	DATE	DESCRIPTION
NC	06/16/04	UPDATE DRAWING FORMAT

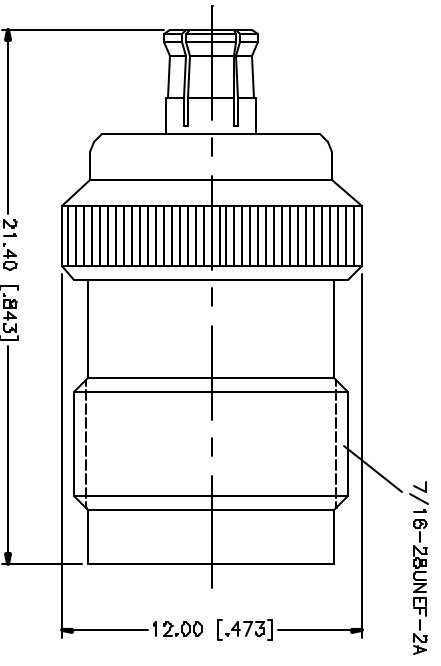

REV.	DATE	DESCRIPTION	MATERIAL	FINISH	QTY
8					
7					
6					
5					
4					
3		CONTACT PIN	PHOS. BRONZE	GOLD	1
2		INSULATOR	TEFLON	NATURAL	1
1		BODY	BER. COPPER	NICKEL	1
		DESCRIPTION	MATERIAL	FINISH	QTY

UNLESS OTHERWISE SPECIFIED DIMENSIONS ARE IN MILLIMETERS, DIMENSIONS IN [ ] ARE IN INCHES AND FOR DATUMS REVERSE ONLY.	
USING DIMENSIONS SPECIFIED TOLERANCES FOR MILLIMETERS ARE:	
0.5 - 30mm ± 0.20mm	
30 - 120mm ± 0.30mm	
120mm AND ABOVE SPECIFIED TOLERANCES FOR INCHES ARE:	
.0750 - .315 ± 0.0075	
.315 - 1.180 ± 0.015	
1.180 - 4.724 ± 0.020	

DO NOT SCALE DRAWINGS	APPROVALS	DATE
	G.R.S.	06/16/04
	DRAWN	
	CHECKED	
	ISSUED	
	BIHET	1 OF 1

<p><b>Amphenol Connex</b></p> <p>TNC JACK TO MCX PLUG ADAPTER</p> <p>2422209</p>	<p>PART DESCRIPTION</p> <p>PART NO.</p> <p>2422209</p>	<p>DWG. NO.</p> <p>2422209DWG</p>	<p>REV.</p> <p>NC</p>	<p>SIZE</p> <p>A</p>	<p>SCALE</p> <p>NA</p>
--	--	-----------------------------------	-----------------------	----------------------	------------------------