



Chipsmall Limited consists of a professional team with an average of over 10 year of expertise in the distribution of electronic components. Based in Hongkong, we have already established firm and mutual-benefit business relationships with customers from,Europe,America and south Asia,supplying obsolete and hard-to-find components to meet their specific needs.

With the principle of “Quality Parts,Customers Priority,Honest Operation,and Considerate Service”,our business mainly focus on the distribution of electronic components. Line cards we deal with include Microchip,ALPS,ROHM,Xilinx,Pulse,ON,Everlight and Freescale. Main products comprise IC,Modules,Potentiometer,IC Socket,Relay,Connector.Our parts cover such applications as commercial,industrial, and automotives areas.

We are looking forward to setting up business relationship with you and hope to provide you with the best service and solution. Let us make a better world for our industry!



Contact us

Tel: +86-755-8981 8866 Fax: +86-755-8427 6832

Email & Skype: info@chipsmall.com Web: www.chipsmall.com

Address: A1208, Overseas Decoration Building, #122 Zhenhua RD., Futian, Shenzhen, China





Series 24 Lok Tainer

WEIGHT

.97g/cm (.087 oz/in)

MATERIALS AND FINISH

HOUSING

Material:

.025-in. (.64-mm) thick Beryllium Copper per QQ-C-533 or .024-in. (.61-mm) thick Cold Rolled Steel per ASTM A-366

Finish:

See finish table on opposite page

CAM

Material:

Beryllium Copper per QQ-C-533

LEVER

Material:

Cold Rolled Steel per ASTM A-366
Note: Beryllium Copper lever furnished when housing is unplated

Finish:

See finish table on opposite page

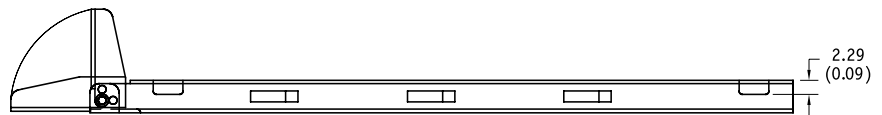
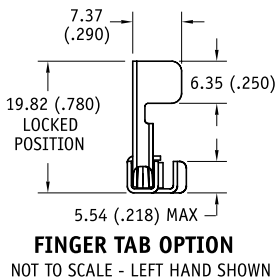
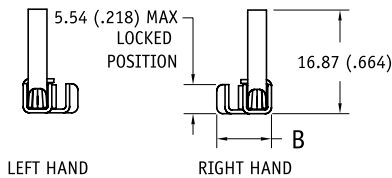
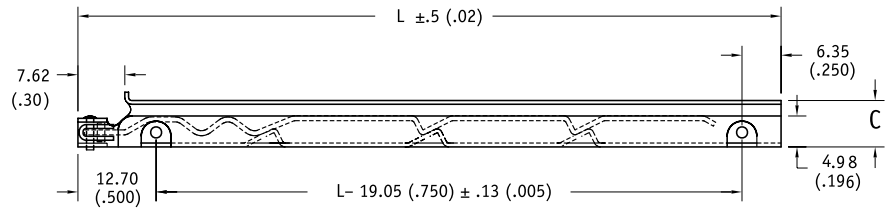
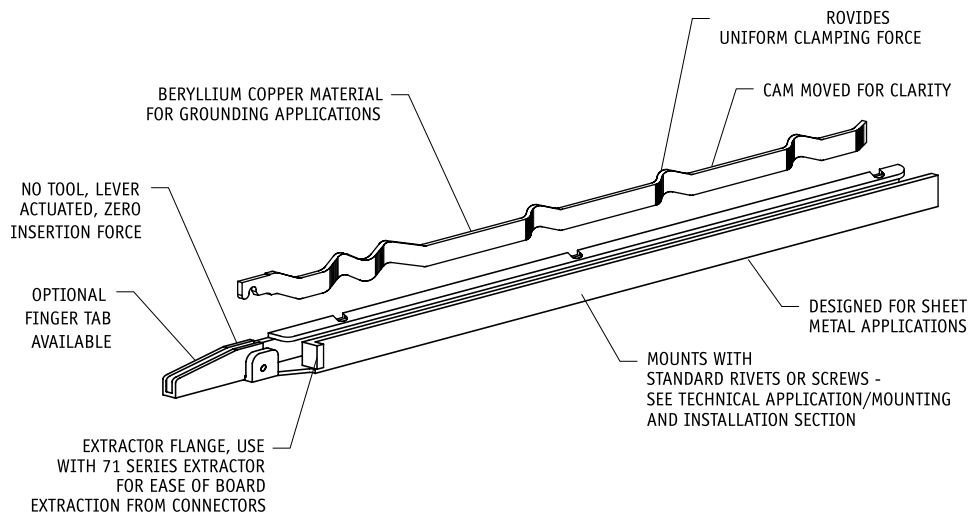

Units: mm(in)
unless specified otherwise,
.xx = ± .25, .x = ± .5
(.xxx = ± .010, .xx = ± .02)

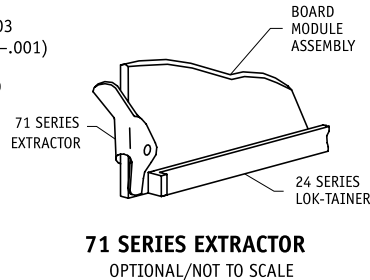
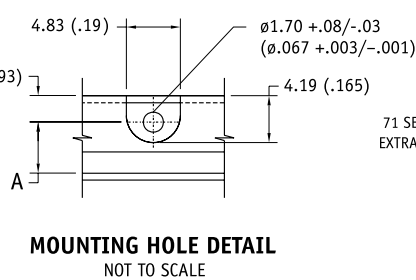

MOUNTING HOLE DIMENSIONS

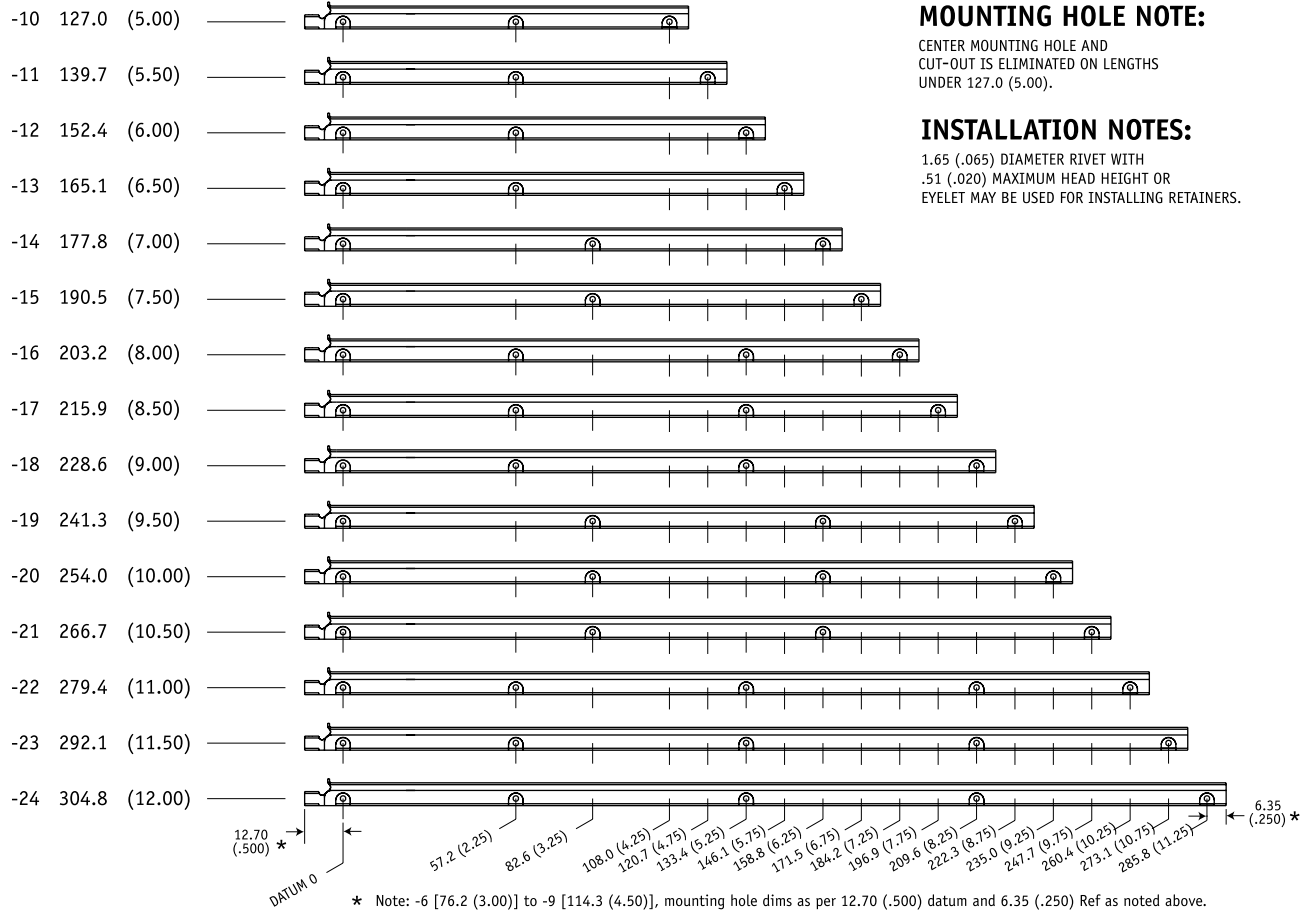

MOUNTING HOLE NOTE:

CENTER MOUNTING HOLE AND CUT-OUT IS ELIMINATED ON LENGTHS UNDER 127.0 (5.00).

INSTALLATION NOTES:

1.65 (.065) DIAMETER RIVET WITH .51 (.020) MAXIMUM HEAD HEIGHT OR EYELET MAY BE USED FOR INSTALLING RETAINERS.

Part Number Code example: 24BX-3-10-6-L

Series 24 Lever-actuated LOK-TAINER, Beryllium Copper housing with flange, 2.39-mm (.094-in.) thick board, 127.2-mm (5.00-in.) long, nickel plate finish and left hand lever action

Part Number Code	
Series 24 LOK-TAINER Lever Actuated	T 24 B X - 2 - 10 - 5 - L
Finger Tab	
Finger tab _____ T	
None _____ [Blank]	
Housing Material	
Beryllium Copper _____ B	
or select from Materials Table	
Extractor Flange	
(Standard) _____ X	
None _____ [Blank]	
Board Thickness	
1.60 (.063) PCB Thickness _____ 2	
or select from Board Thickness Table	
Length	
Length in 12.7 (.50) increments _____ 6 [76.2 (3.00)]	
_____ to 24 [304.8 (12.00)]	
Finish	
Gold Plate _____ 5	
or select from Finish Table	
Lever Action	
Left hand _____ L	
Right hand _____ R	

MATERIALS TABLE

CODE LETTER	
B	BERYLLIUM COPPER, 1/4H PER ASTM-B-194
S	STEEL PER ASTM-A-366

BOARD THICKNESS TABLE

DASH #	THICKNESS			
	A	B	C	
+127/-0.000				
+0.005/-0.000				
-1	0.79 (.031)	4.58 (.180)	8.89 (.350)	7.55 (.297)
-2	1.60 (.063)	4.58 (.180)	8.89 (.350)	7.55 (.297)
-3	2.39 (.094)	5.34 (.210)	9.66 (.380)	8.31 (.327)

FINISH TABLE

DASH #	
[blank]	SILVER PLATE PER QQ-S-365, TYPE III, GRADE A
-1	NONE
-2	EBANOL PER MIL-F-495 FOR BERYLLIUM COPPER PER MIL-C-13924 FOR STEEL
-3	CADMIUM PER QQ-P-416, TYPE 2, CLASS 2
-4	COPPER PLATE PER MIL-C-14550, CLASS 2
-5	GOLD PLATE PER MIL-G-45204, TYPE 1, GLASS 1
-6	NICKEL PLATE PER QQ-N-290, CLASS 1, GRADE G, BRIGHT
-7	ZINC PLATE CLEAR CHROMATE, PER ASTM-B-633, Fe/Zn 8
-8	ZINC PLATE YELLOW CHROMATE, PER ASTM-B-633, Fe/Zn 8

NOTE: NO FINISH (-1) NOT AVAILBLE WITH "S" STEEL MATERIAL