



Chipsmall Limited consists of a professional team with an average of over 10 year of expertise in the distribution of electronic components. Based in Hongkong, we have already established firm and mutual-benefit business relationships with customers from,Europe,America and south Asia,supplying obsolete and hard-to-find components to meet their specific needs.

With the principle of “Quality Parts,Customers Priority,Honest Operation,and Considerate Service”,our business mainly focus on the distribution of electronic components. Line cards we deal with include Microchip,ALPS,ROHM,Xilinx,Pulse,ON,Everlight and Freescale. Main products comprise IC,Modules,Potentiometer,IC Socket,Relay,Connector.Our parts cover such applications as commercial,industrial, and automotives areas.

We are looking forward to setting up business relationship with you and hope to provide you with the best service and solution. Let us make a better world for our industry!



Contact us

Tel: +86-755-8981 8866 Fax: +86-755-8427 6832

Email & Skype: info@chipsmall.com Web: www.chipsmall.com

Address: A1208, Overseas Decoration Building, #122 Zhenhua RD., Futian, Shenzhen, China



PART NUMBER	CABLE TYPE	COLOR	MATERIAL
25-B58TN	RG-58,141	BLACK	PVC

受控 CONTROLLED DOCUMENT			
编号 P/N	25-B58TN	版本 Rev	0B
日期 Rel'd Date	Mar 24,08		

DRAWING NO.		25-B58TN	
REVISIONS			
A RELEASE FOR QUOTATION			
01-20-06	W	W	T
ADD NOTES.			
B			
12-26-06	L	Y	T

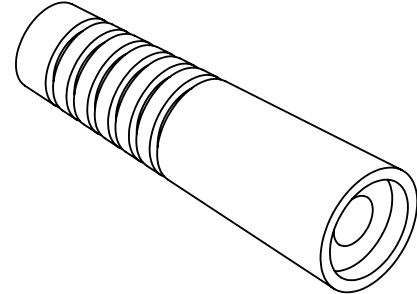
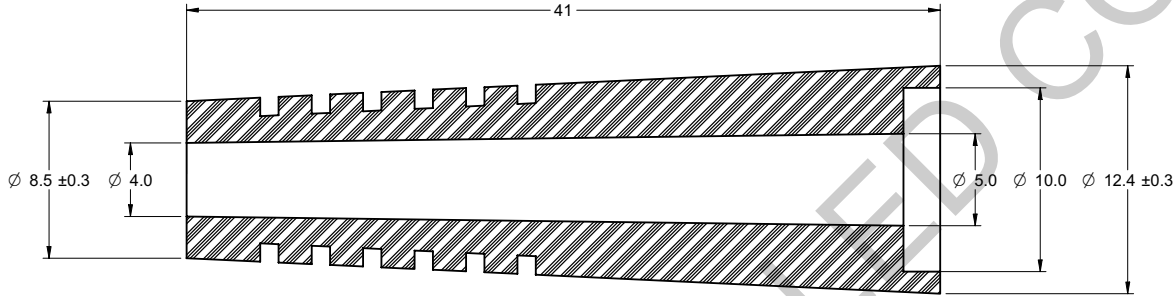

NOTES:

1. PRODUCT SHOULD BE RoHS COMPLIANCE.
2. PACKAGING REQUIREMTN FOLLOWS ENGINEERING DOCUMENT P/ N 836-40200001XX.

TOLERANCE UNLESS OTHERWISE SPECIFIED		DRAWN BY	DATE
		LINDA.WU	12-26-06
DECIMALS	mm	CHECKED BY	DATE
X	± 0.5	BETTY.YU	12-26-06
X.X	± 0.2	APPROVED BY	DATE
X.XX	± 0.1	THOMAS	12-26-06
ANGLES	± 0.5°	U/M	mm

 cinch <small>CONNECTIVITY SOLUTIONS</small> <small>a bel group</small>	
TITLE	
BNC BOOTS	
SHEET	SIZE
1 OF 1	C

THIS DRAWING WAS PRODUCED BY COMPUTER, DO NOT SCALE DRAWING OR UPDATE MANUALLY.

THIS DRAWING TO BE INTERPRETED PER ANSI Y 14.5M - 1994

COMPANY CONFIDENTIAL

DRAWING NO.	SIZE
25-B58TN	C