



Chipsmall Limited consists of a professional team with an average of over 10 year of expertise in the distribution of electronic components. Based in Hongkong, we have already established firm and mutual-benefit business relationships with customers from,Europe,America and south Asia,supplying obsolete and hard-to-find components to meet their specific needs.

With the principle of “Quality Parts,Customers Priority,Honest Operation,and Considerate Service”,our business mainly focus on the distribution of electronic components. Line cards we deal with include Microchip,ALPS,ROHM,Xilinx,Pulse,ON,Everlight and Freescale. Main products comprise IC,Modules,Potentiometer,IC Socket,Relay,Connector.Our parts cover such applications as commercial,industrial, and automotives areas.

We are looking forward to setting up business relationship with you and hope to provide you with the best service and solution. Let us make a better world for our industry!



## Contact us

Tel: +86-755-8981 8866 Fax: +86-755-8427 6832

Email & Skype: [info@chipsmall.com](mailto:info@chipsmall.com) Web: [www.chipsmall.com](http://www.chipsmall.com)

Address: A1208, Overseas Decoration Building, #122 Zhenhua RD., Futian, Shenzhen, China



REV.	DATE	DESCRIPTION
NC	10/03/03	INITIAL RELEASE

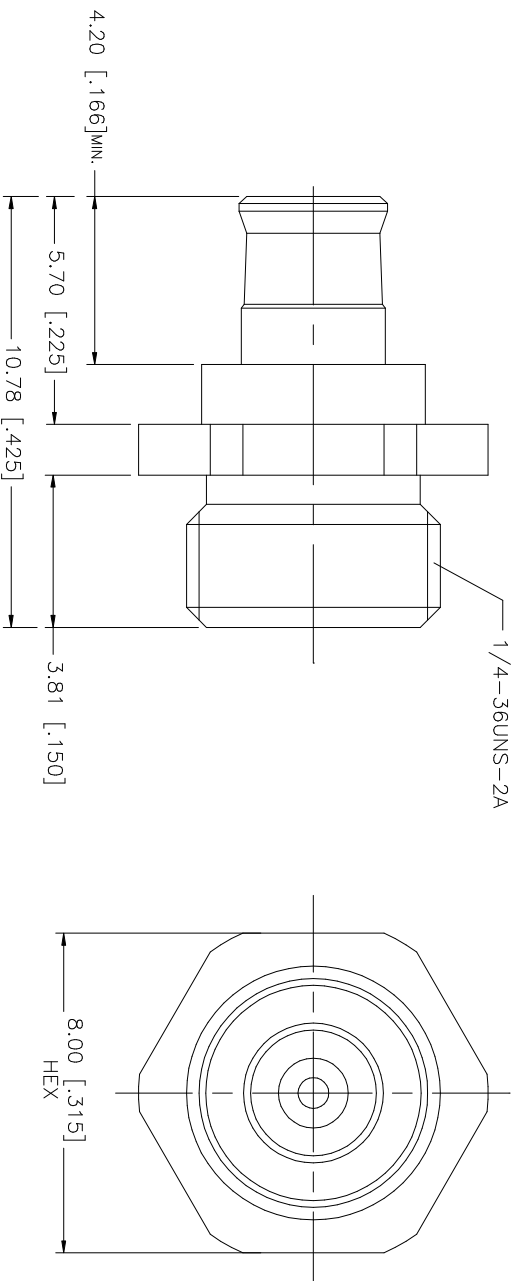

<div>Amphenol Connex</div>									
PART DESCRIPTION									
MCX PLUG TO MCX JACK ADAPTER									
PART NO. 252186									
DWG. NO. 252186.DWG									
REV. NC SIZE A SCALE NA									
APPROVALS		DATE							
DRAWN G.R.S.		10/03/03							
UNLESS OTHERWISE SPECIFIED DIMENSIONS ARE IN MILLIMETERS. DIMENSIONS IN [ ] ARE IN INCHES AND FOR CUSTOMER REFERENCE ONLY.									
UNLESS OTHERWISE SPECIFIED TOLERANCES FOR MILLIMETERS ARE:									
0.5 - 8mm ± 0.20mm									
8 - 30mm ± 0.40mm									
30 - 120mm ± 0.50mm									
UNLESS OTHERWISE SPECIFIED TOLERANCES FOR INCHES ARE:									
.020 - .315 = ± 0.007"									
.315 - 1.180 = ± 0.015"									
1.180 - 4.724 = ± 0.020"									
DO NOT SCALE DRAWING				C:/252/252186.DWG					
CD FILE									
SHEET 1 OF 1									
PART NO.									
DWG. NO.									
DESCRIPTION									
MATERIAL									
FINISH									
QTY									
CONTACT PIN		BER. COPPER							
INSULATOR		TEFLON							
BODY		BRASS							
DESCRIPTION									