



Chipsmall Limited consists of a professional team with an average of over 10 year of expertise in the distribution of electronic components. Based in Hongkong, we have already established firm and mutual-benefit business relationships with customers from,Europe,America and south Asia,supplying obsolete and hard-to-find components to meet their specific needs.

With the principle of "Quality Parts,Customers Priority,Honest Operation,and Considerate Service",our business mainly focus on the distribution of electronic components. Line cards we deal with include Microchip,ALPS,ROHM,Xilinx,Pulse,ON,Everlight and Freescale. Main products comprise IC,Modules,Potentiometer,IC Socket,Relay,Connector.Our parts cover such applications as commercial,industrial, and automotives areas.

We are looking forward to setting up business relationship with you and hope to provide you with the best service and solution. Let us make a better world for our industry!



Contact us

Tel: +86-755-8981 8866 Fax: +86-755-8427 6832

Email & Skype: info@chipsmall.com Web: www.chipsmall.com

Address: A1208, Overseas Decoration Building, #122 Zhenhua RD., Futian, Shenzhen, China



MALE PCB PINS

SOLDER TERMINALS PIN TYPE

2319

2319-X-00-XX-00-00-07-0

Swage mount in .076 hole

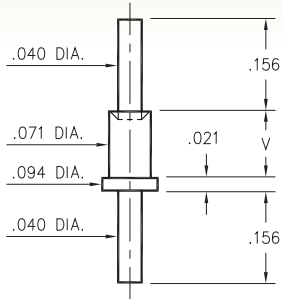

Basic Part Number	Board Thickness	Length V
2319-1	.031	.051
2319-2	.062	.082
2319-3	.094	.113

2313

2313-X-00-XX-00-00-07-0

Swage mount in .076 hole

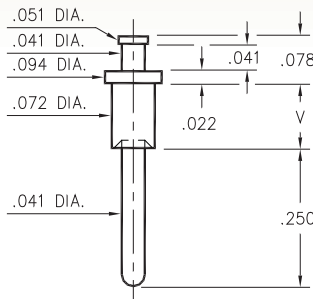

Basic Part Number	Board Thickness	Length V
2313-1	.031	.051
2313-2	.062	.084
2313-3	.094	.113
2313-4	.125	.145

2321

2321-X-00-XX-00-00-07-0

Swage mount in .076 hole

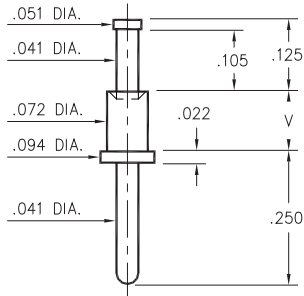

Basic Part Number	Board Thickness	Length V
2321-1	.031	.051
2321-2	.062	.082
2321-3	.094	.113
2321-4	.125	.145

2706

2706-X-00-XX-00-00-07-0

Swage mount in .120 hole

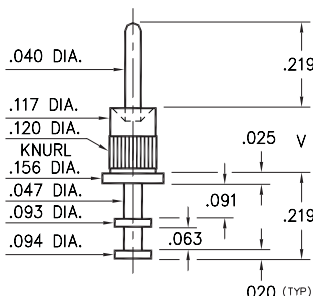

Basic Part Number	Board Thickness	Length V
2706-1	.031	.063
2706-2	.062	.093
2706-3	.094	.125
2706-4	.125	.156

2530

2530-X-00-XX-00-00-07-0

Swage mount in .094 hole

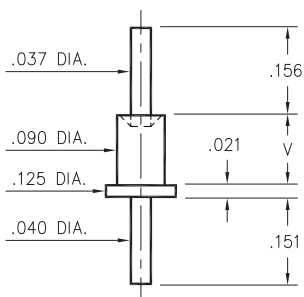

Basic Part Number	Board Thickness	Length V
2530-2	.062	.094
2530-3	.094	.125
2530-4	.125	.156

3156

3156-X-00-XX-00-00-08-0

Swage mount in .076 hole

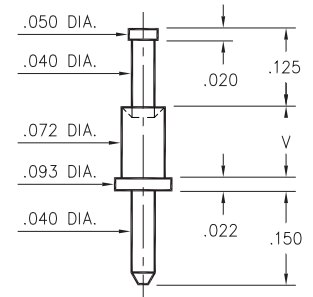

Basic Part Number	Board Thickness	Length V
3156-1	.031	.051
3156-2	.062	.082
3156-3	.094	.113
3156-4	.125	.145

SPECIFICATIONS:

Pin Material: Brass Alloy 360, 1/2 Hard
(Swage pins are annealed)

Dimensions: Inches

Tolerances On: Lengths: $\pm .005$
Diameters: $\pm .002$
Angles: $\pm 2^\circ$



ORDER CODE: XXXX - X - 00 - XX - 00 - 00 - XX - 0

BASIC PART #

SPECIFY PIN FINISH:

- 01 200 μ " TIN/LEAD OVER NICKEL
- ◆ 80 200 μ " TIN OVER NICKEL (RoHS)
- ◆ 44 300 μ " SILVER OVER COPPER (RoHS)
- 50 300 μ " ELECTRO-SOLDER
(60/40 SnPb)

