



Chipsmall Limited consists of a professional team with an average of over 10 year of expertise in the distribution of electronic components. Based in Hongkong, we have already established firm and mutual-benefit business relationships with customers from,Europe,America and south Asia,supplying obsolete and hard-to-find components to meet their specific needs.

With the principle of “Quality Parts,Customers Priority,Honest Operation,and Considerate Service”,our business mainly focus on the distribution of electronic components. Line cards we deal with include Microchip,ALPS,ROHM,Xilinx,Pulse,ON,Everlight and Freescale. Main products comprise IC,Modules,Potentiometer,IC Socket,Relay,Connector.Our parts cover such applications as commercial,industrial, and automotives areas.

We are looking forward to setting up business relationship with you and hope to provide you with the best service and solution. Let us make a better world for our industry!



Contact us

Tel: +86-755-8981 8866 Fax: +86-755-8427 6832

Email & Skype: info@chipsmall.com Web: www.chipsmall.com

Address: A1208, Overseas Decoration Building, #122 Zhenhua RD., Futian, Shenzhen, China



ENG1108

DWG. NO. 25M5044

ALL REVISIONS TO THIS DRAWING
MUST BE MADE ON THE CAD SYSTEM

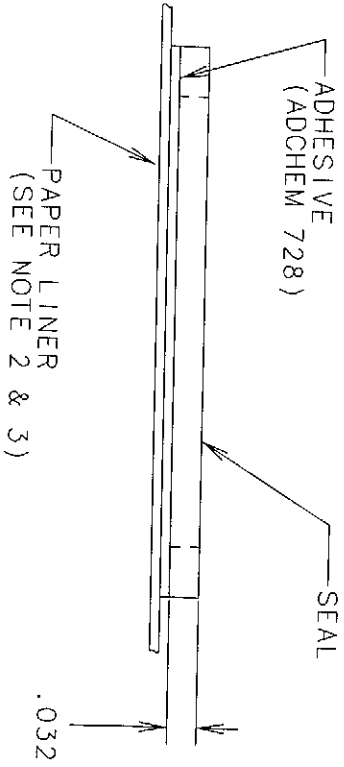
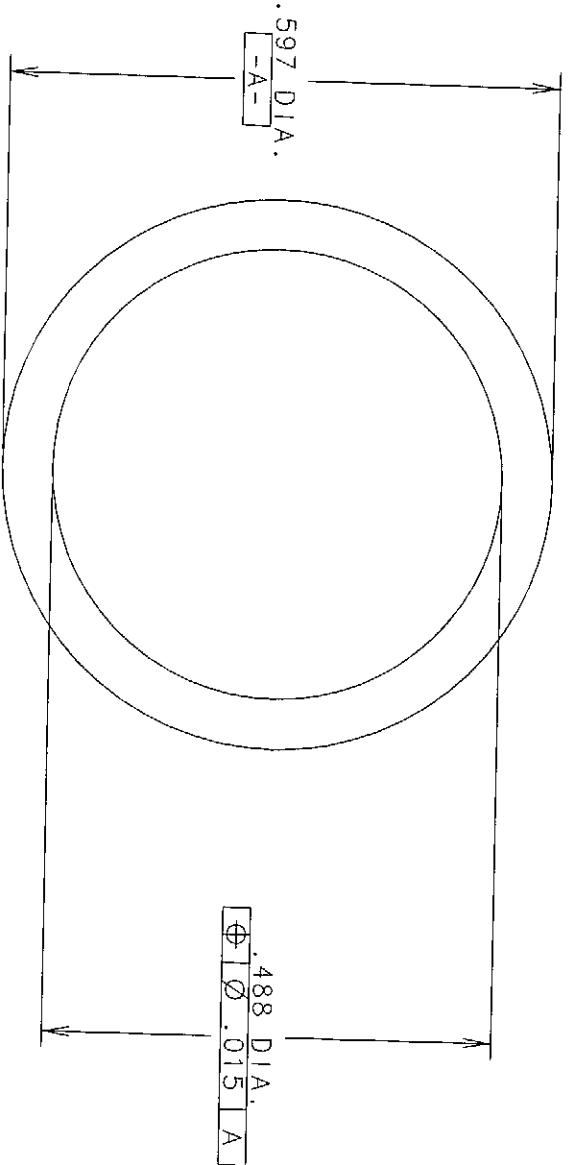

NOTES:

1. SEALS WILL BE RED IN COLOR AND SUPPLIED IN STRIPS.
2. SEALS WILL BE TOTALLY CUT THROUGH WITH I.D.'S INTACT.
3. NICKS ON EITHER EDGE ARE ACCEPTABLE IF DIMENSIONS REMAIN WITHIN PRINT TOLERANCE.
4. SURFACE SCRATCHES ARE ACCEPTABLE IF THEY DO NOT COMPLETELY CROSS BETWEEN THE I.D AND O.D.

ISSUE	APP/DATE	DESCRIPTION
A	KKK	ORIGINAL
		DWS
		EON 514342 5-14-96

REVISIONS



GRAYHILL, INC.
561 HILLGROVE AVE.
LA GRANGE, IL 60525
PHONE (708) 354-1040

UNLESS OTHERWISE SPECIFIED TOLERANCES AND DIMENSIONS ARE IN INCHES
 LINEAR ±.005 DIAMETERS ±.015
 ANGULAR ± ---
 LIMITS APPLY BEFORE FINISHING
 DO NOT SCALE THIS PRINT

MFG. INSTR.
 Q.C. INSTR.

FINISH	APPROVED DATE
KKK	5-14-96

MATERIAL	CHECKED DATE
DURO SILICONE	CJG 5-14-96

NAME	DRAWN DATE
GASKET	DWS 5-14-96

CAGE NO.	CADAM DRAWING
81073	25M5044, A.01, 1, 1

DWG. NO. 25M5044
 A
 SCALE 5:1 (R) SHEET 1 OF 1