



Chipsmall Limited consists of a professional team with an average of over 10 year of expertise in the distribution of electronic components. Based in Hongkong, we have already established firm and mutual-benefit business relationships with customers from,Europe,America and south Asia,supplying obsolete and hard-to-find components to meet their specific needs.

With the principle of “Quality Parts,Customers Priority,Honest Operation,and Considerate Service”,our business mainly focus on the distribution of electronic components. Line cards we deal with include Microchip,ALPS,ROHM,Xilinx,Pulse,ON,Everlight and Freescale. Main products comprise IC,Modules,Potentiometer,IC Socket,Relay,Connector.Our parts cover such applications as commercial,industrial, and automotives areas.

We are looking forward to setting up business relationship with you and hope to provide you with the best service and solution. Let us make a better world for our industry!



Contact us

Tel: +86-755-8981 8866 Fax: +86-755-8427 6832

Email & Skype: info@chipsmall.com Web: www.chipsmall.com

Address: A1208, Overseas Decoration Building, #122 Zhenhua RD., Futian, Shenzhen, China



Flat Cable EMI Suppression Cores (2643167551)



Part Number: 2643167551

43 SPLIT FLAT CABLE CORE

Explanation of Part Numbers:

- Digits 1 & 2 = Product Class
- Digits 3 & 4 = Material Grade

Flat cable suppression core can accommodate multi- conductors flat cables, in widths from 12.7 mm (0.500") up to 77 mm (3.0"). These flat cable cores are available in two ferrite material grades to reduce conducted EMI from 1 MHz to hundreds of MHz.

Our Expanded Cable & Suppressor Kit (part number 0199000005) contains a selection of these flat cable cores and clips.

Flat Cable Cores are available in selected sizes in the Flex Circuit & Ribbon Cable Core Kit (part number 0199000038).

Assembly clips are available for most of the split flat cable cores. See section Flat Cable Cores Assembly clips.

Weight: 170 (g)

Dim	mm	mm tol	nominal inch	inch misc.
A	52.9	±1.00	2.083	
B	33	±0.70	1.299	
C	63.5	±1.80	2.5	
D	12.5	±0.40	0.492	
E	3.5	±0.40	0.138	

Cable Information			
Max Diameter	Max Dimension	Solid Equivalent	Flat Cable Cores
0	32.30 x 6.20		

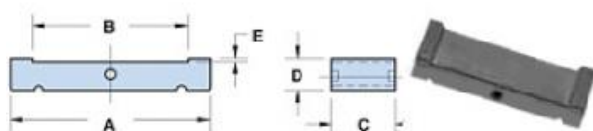

Figure 1

Chart Legend

+ Test frequency

•For assembly clips see Flat Cable Cores Assembly Clips

Typical Impedance (Ω)	
10 MHz	150
25 MHz ⁺	270
100 MHz ⁺	480
250 MHz	370

Flat cable suppression cores, split or single cores, are controlled for impedances only. Minimum impedance values are specified for the + marked frequencies. The minimum impedance is typically the listed impedance less 20%.

Centered, single turn impedance tests for the 31 and 43 material parts are performed on the 4193A Vector Impedance Analyzer. All tests are made with the shortest practical wire length.

2643167551

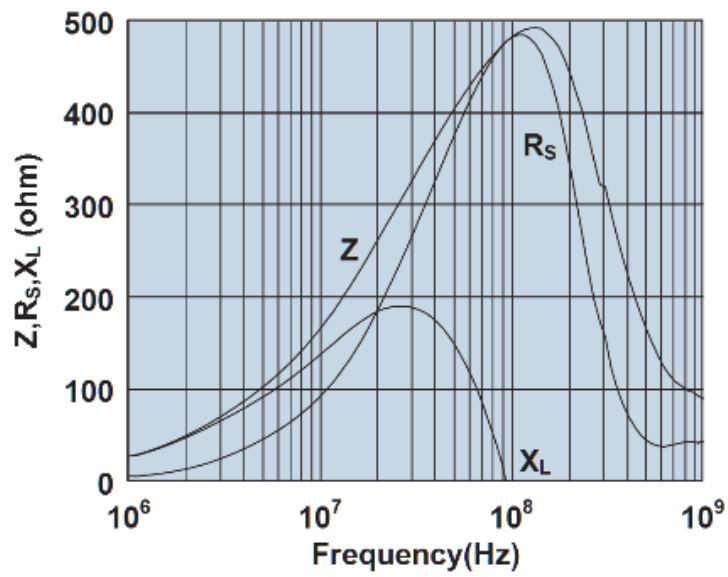

Impedance, reactance, and resistance vs. frequency.