



Chipsmall Limited consists of a professional team with an average of over 10 year of expertise in the distribution of electronic components. Based in Hongkong, we have already established firm and mutual-benefit business relationships with customers from,Europe,America and south Asia,supplying obsolete and hard-to-find components to meet their specific needs.

With the principle of "Quality Parts,Customers Priority,Honest Operation,and Considerate Service",our business mainly focus on the distribution of electronic components. Line cards we deal with include Microchip,ALPS,ROHM,Xilinx,Pulse,ON,Everlight and Freescale. Main products comprise IC,Modules,Potentiometer,IC Socket,Relay,Connector.Our parts cover such applications as commercial,industrial, and automotives areas.

We are looking forward to setting up business relationship with you and hope to provide you with the best service and solution. Let us make a better world for our industry!



## Contact us

Tel: +86-755-8981 8866 Fax: +86-755-8427 6832

Email & Skype: info@chipsmall.com Web: www.chipsmall.com

Address: A1208, Overseas Decoration Building, #122 Zhenhua RD., Futian, Shenzhen, China



**P – PANEL MOUNTING ADAPTER**

This panel adapter is a rugged, black, auto extinguishable polycarbonate material. It is mounted with two 6/32 screws. A timer is mounted by clipping to the adapter or panel. Order part number P ADAPT.

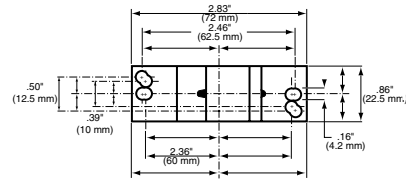

**DR – DIN-RAIL**

The DR-DIN-Rail material is an extruded aluminum material of the standard configuration, 35mm. Timers and Controls conveniently snap onto the track. Order part number "DR" which is available in 1 meter (39") lengths. Shown with S08, S11 and K11 sockets.

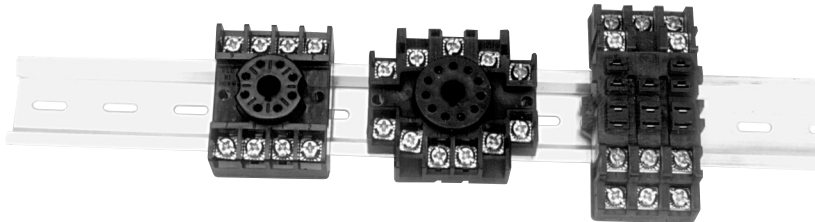

**S08, S11 & SCREW TERMINAL SOCKETS**

The S08, and S11 are 8 and 11 pin sockets fabricated from a rugged, durable polycarbonate.\* The color is grey to match the majority of accessories available. Mounting is with two 6/32 screws .250 or on .30 DIN-Rail, DR. Order part "S08" or "S11."

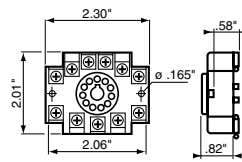

S11

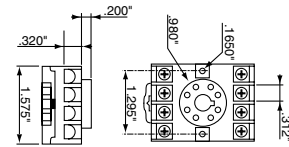

S08

**S08-600:** 600V, 10A rated 8 pin socket-UL and CSA

**S12 & S15 SOLDER TERMINAL SOCKETS**

The S12 and S15 are 11 and 8 pin solder terminal sockets fabricated from a rugged, durable polycarbonate. They are black and connections are made by soldering to the tabs or by 3/16" (4.8mm) push-on connectors. Order Part Number "S12" (11 pin) and "S15" (8 pin)

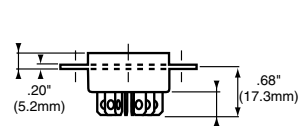
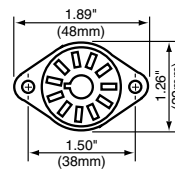

**SA8 & SA11 - Back connecting Socket**

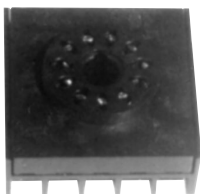

SA11NN

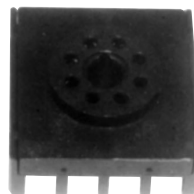
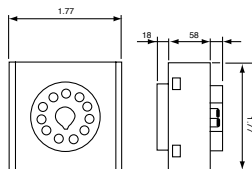

SA8NN

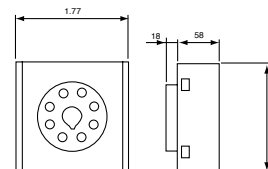

Products and specifications subject to change without notice.

Order/Technical Support – Tel: (800) 677-5311 / FAX: (800) 677-3865 / www.crouzet-usa.com

# ACCESSORIES FOR RTM TIMER

## SOCKETS PC Board Sockets (mm)

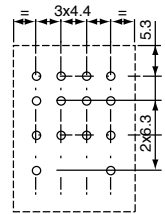
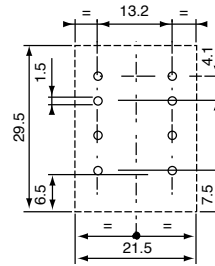
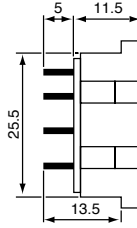
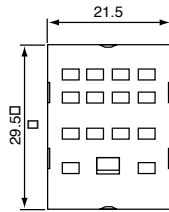
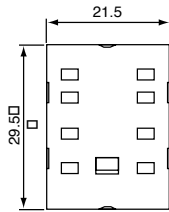

2 Poles  
Ref: 26532709

4 Poles  
Ref: 26532708

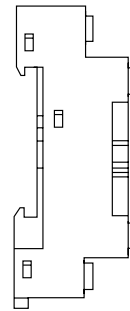
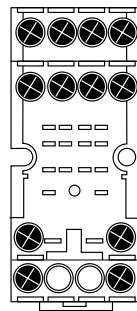
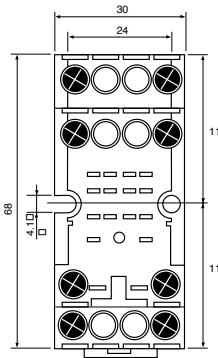

2 Poles  
Ref: 26532707

4 Poles  
Ref: 26532706

### Mounting Clip for DIN-Rail Sockets

Ref: 26532702

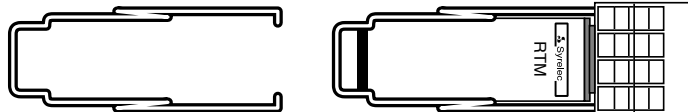

**79 238 250 (Part Number)**  
**PANEL MOUNT REMOTE POTENTIOMETER**  
 470K Ohm ±10% / 0.2 W / linearity ±10%

### DIMENSIONS: inches (mm)

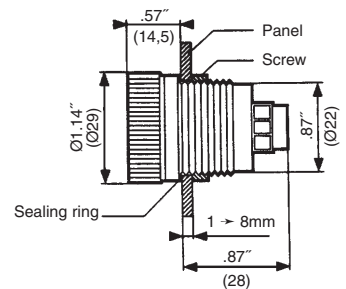

Products and specifications subject to change without notice.

Order/Technical Support – Tel: (800) 677-5311 / FAX: (800) 677-3865 / www.crouzet-usa.com