



Chipsmall Limited consists of a professional team with an average of over 10 year of expertise in the distribution of electronic components. Based in Hongkong, we have already established firm and mutual-benefit business relationships with customers from,Europe,America and south Asia,supplying obsolete and hard-to-find components to meet their specific needs.

With the principle of "Quality Parts,Customers Priority,Honest Operation,and Considerate Service",our business mainly focus on the distribution of electronic components. Line cards we deal with include Microchip,ALPS,ROHM,Xilinx,Pulse,ON,Everlight and Freescale. Main products comprise IC,Modules,Potentiometer,IC Socket,Relay,Connector.Our parts cover such applications as commercial,industrial, and automotives areas.

We are looking forward to setting up business relationship with you and hope to provide you with the best service and solution. Let us make a better world for our industry!



Contact us

Tel: +86-755-8981 8866 Fax: +86-755-8427 6832

Email & Skype: info@chipsmall.com Web: www.chipsmall.com

Address: A1208, Overseas Decoration Building, #122 Zhenhua RD., Futian, Shenzhen, China



5

4

3

2

1

DRAWING NO. 27-8471-CUST	
REVISIONS	
01 OFFICIAL RELEASE	
03-11-09	J J T T Thomas s Chow



Description: Adapter assembly, isolated dual BNC chassis MT
 Part No: 27-8471
 Application: Adapter
 Crimp Tool: N/A
 Impedance: 50 Ohms
 Frequency Range: 0-4 GHz
 Material: Body Zinc Nickel plated
 Contact Beryllium Gold plated
 Insulator Delrin
 Mounting nut Brass Nickel plated
 Washer Steel Nickel plated
 Gasket Delrin
 RoHS Compliance: Yes
 Technical Detail: Refer to Emerson Document P/N 27-0000

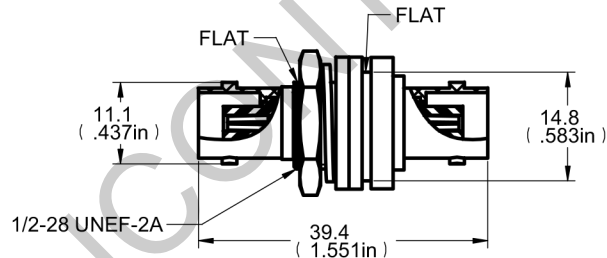
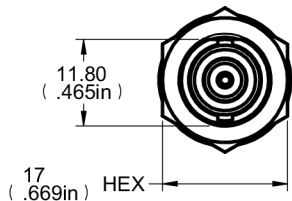

DIM OUTLINE

CUSTOMER COPY



TOLERANCE UNLESS OTHERWISE SPECIFIED		DRAWN BY JEAN.JIN	DATE 03-11-09
DECIMALS	mm	CHECKED BY TERRY.W	DATE 03-11-09
X	± 0.5	APPROVED BY THOMAS	DATE 03-12-09
X.X	± 0.3	U/M	mm
X.XX	± 0.1		
ANGLES	± 0.5°		

TITLE
**ADAPTER ASSEMBLY,
ISOLATED DUAL BNC CHASSIS MT**

受控 CONTROLLED DOCUMENT					
编号 P/N	27-8471-CUST	版本 Rev	01	日期 Rel'd Date	Apr29,09

THIS DRAWING WAS PRODUCED BY COMPUTER,
DO NOT SCALE DRAWING OR UPDATE MANUALLY.

SHEET 1 OF 1	DRAWING NO. 27-8471-CUST	SIZE A
-----------------	------------------------------------	-----------

5

4

3

2

1