



Chipsmall Limited consists of a professional team with an average of over 10 year of expertise in the distribution of electronic components. Based in Hongkong, we have already established firm and mutual-benefit business relationships with customers from,Europe,America and south Asia,supplying obsolete and hard-to-find components to meet their specific needs.

With the principle of "Quality Parts,Customers Priority,Honest Operation,and Considerate Service",our business mainly focus on the distribution of electronic components. Line cards we deal with include Microchip,ALPS,ROHM,Xilinx,Pulse,ON,Everlight and Freescale. Main products comprise IC,Modules,Potentiometer,IC Socket,Relay,Connector.Our parts cover such applications as commercial,industrial, and automotives areas.

We are looking forward to setting up business relationship with you and hope to provide you with the best service and solution. Let us make a better world for our industry!



Contact us

Tel: +86-755-8981 8866 Fax: +86-755-8427 6832

Email & Skype: info@chipsmall.com Web: www.chipsmall.com

Address: A1208, Overseas Decoration Building, #122 Zhenhua RD., Futian, Shenzhen, China



Electronic housing - ME MAX 22.5 2-2 KMGY - 2713625

Please be informed that the data shown in this PDF Document is generated from our Online Catalog. Please find the complete data in the user's documentation. Our General Terms of Use for Downloads are valid (<http://download.phoenixcontact.com>)



Electronic housing consisting of: Housing shells left and right, front plate, transparent cover, metal foot catch and spring, open housing, 16-pos. (4 x 4 pos.), width: 22.5 mm, color: Light gray

The illustration shows the housing versions

Why buy this product

- Plug-in connection with screw, spring-cage or fast connection technology
- DIN rail bus connector as an option
- Labels for additional labeling as an option
- Large PCB surface despite compact housing dimensions
- Large front surface for high-pos. plugs or operating and setting elements
- Easy module replacement without interrupting the contact chain
- The fitted cover is easy to adapt and print
- Fixed or plug-in connection technology can be combined on up to three connection levels, with different pitches
- Functional earth ground contact as an option
- Transparent front cover can be swiveled



Key commercial data

Packing unit	1
Minimum order quantity	10
Catalog page	Page 620 (CC-2011)
GTIN	 4 017918 917401
Custom tariff number	85369010
Country of origin	GERMANY

Technical data

General

Housing type	Complete housing
Housing material	Polyamide
Color	light gray

Dimensions / positions

Electronic housing - ME MAX 22.5 2-2 KMGY - 2713625

Technical data

Dimensions / positions

Length	99 mm
Constructional height	114.5 mm
Width	22.5 mm
Number of positions	16

Technical data

Ambient temperature (operation)	-40 °C ... 105 °C
Inflammability class according to UL 94	V0
Power dissipation at 20°C in the horizontal mounting position	6.1 W 12.1 W

Classifications

ETIM

ETIM 2.0	EC001031
ETIM 3.0	EC001031
ETIM 4.0	EC001031
ETIM 5.0	EC001031

UNSPSC

UNSPSC 11	31261501
UNSPSC 12.01	31261501
UNSPSC 13.2	31261501
UNSPSC 6.01	31261501
UNSPSC 7.0901	31261501

eCl@ss

eCl@ss 4.0	27180401
eCl@ss 4.1	27180401
eCl@ss 5.0	27180506
eCl@ss 5.1	27180506
eCl@ss 6.0	27180802
eCl@ss 7.0	27182702

Approvals

Approvals

Approvals

UL Recognized / cUL Recognized / cULus Recognized

Ex Approvals

Electronic housing - ME MAX 22.5 2-2 KMGY - 2713625

Approvals

Approvals submitted

Approval details

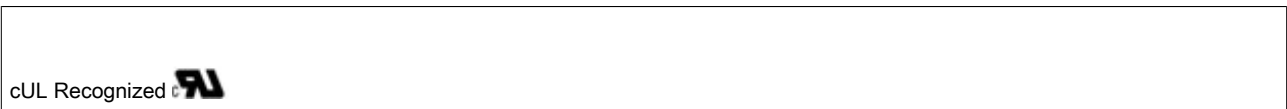

Accessories

Accessories

Plug/Adapter

Electronic housing - ME FE-CONTACT - 2908294



Functional earth ground contact, for intermediate elements.

Drawings

Electronic housing - ME MAX 22.5 2-2 KMGY - 2713625

Dimensioned drawing

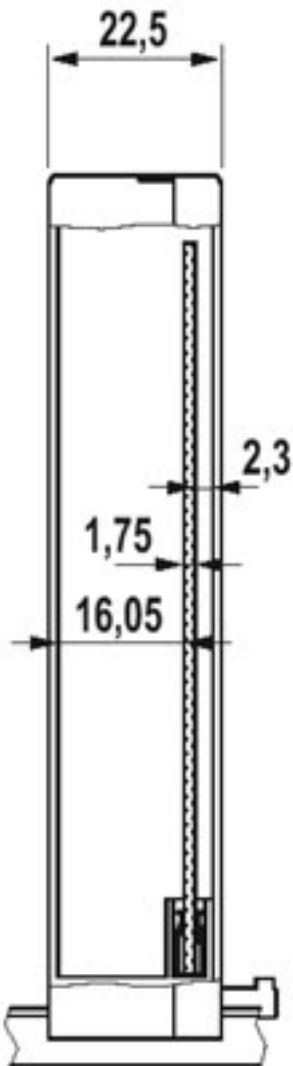

Dimensioned drawing

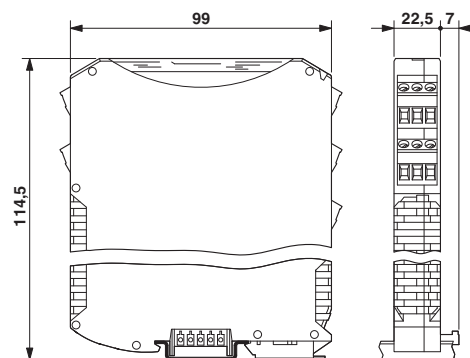

Electronic housing - ME MAX 22.5 2-2 KMGY - 2713625

Explosion drawing

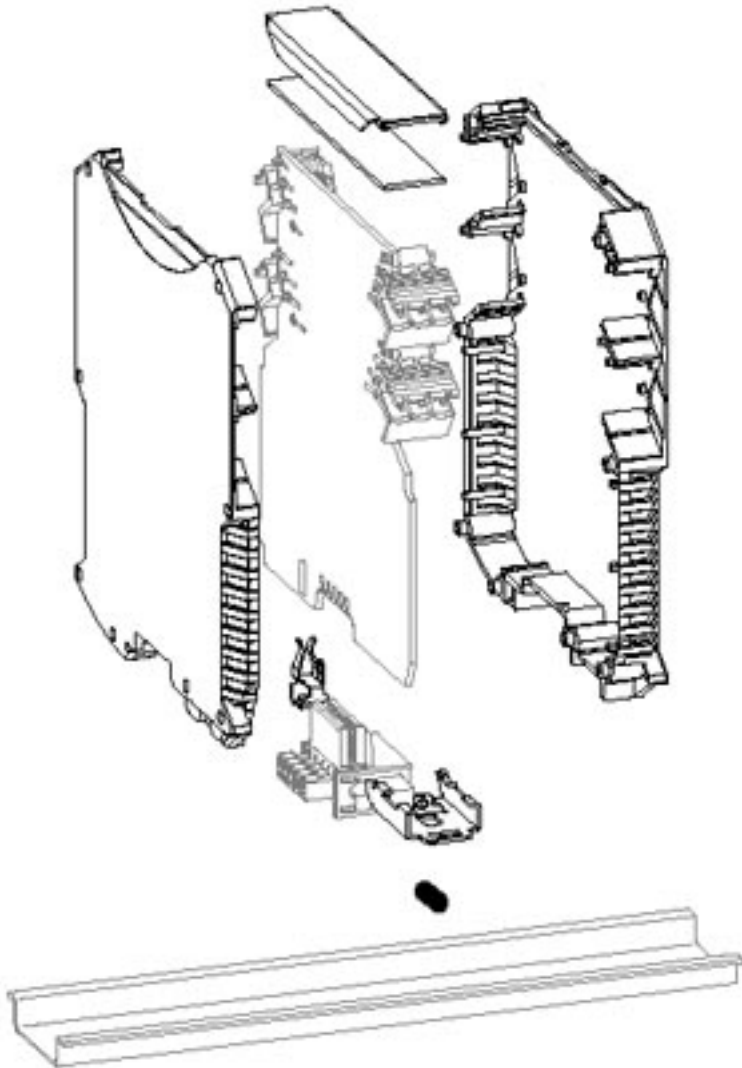

The illustration shows a version of the product (open housing) with accessories

Electronic housing - ME MAX 22.5 2-2 KMGY - 2713625

Dimensioned drawing

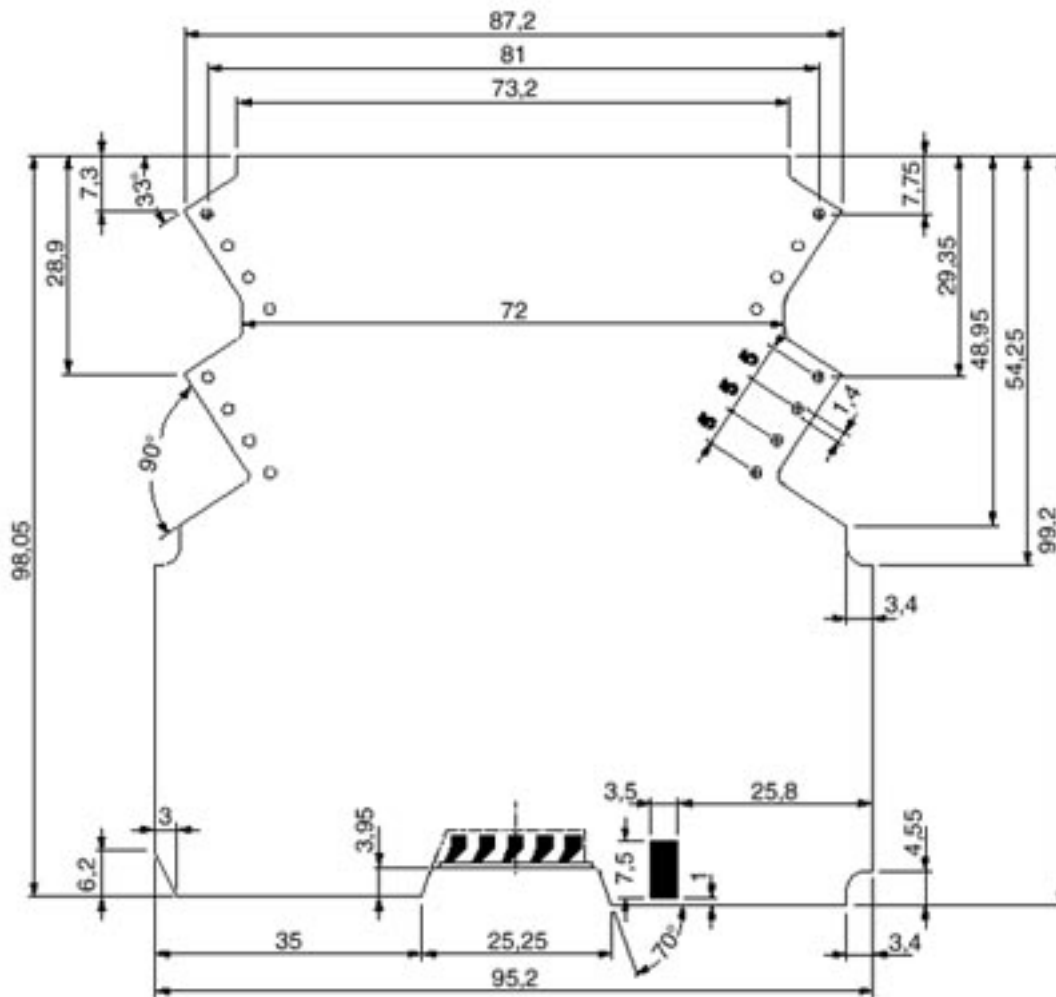

Dimensional drawing of the ME MAX 2-2 printed circuit board, for printed circuit terminal block connection (MKDSO), view: component side

Electronic housing - ME MAX 22.5 2-2 KMGY - 2713625

Dimensioned drawing

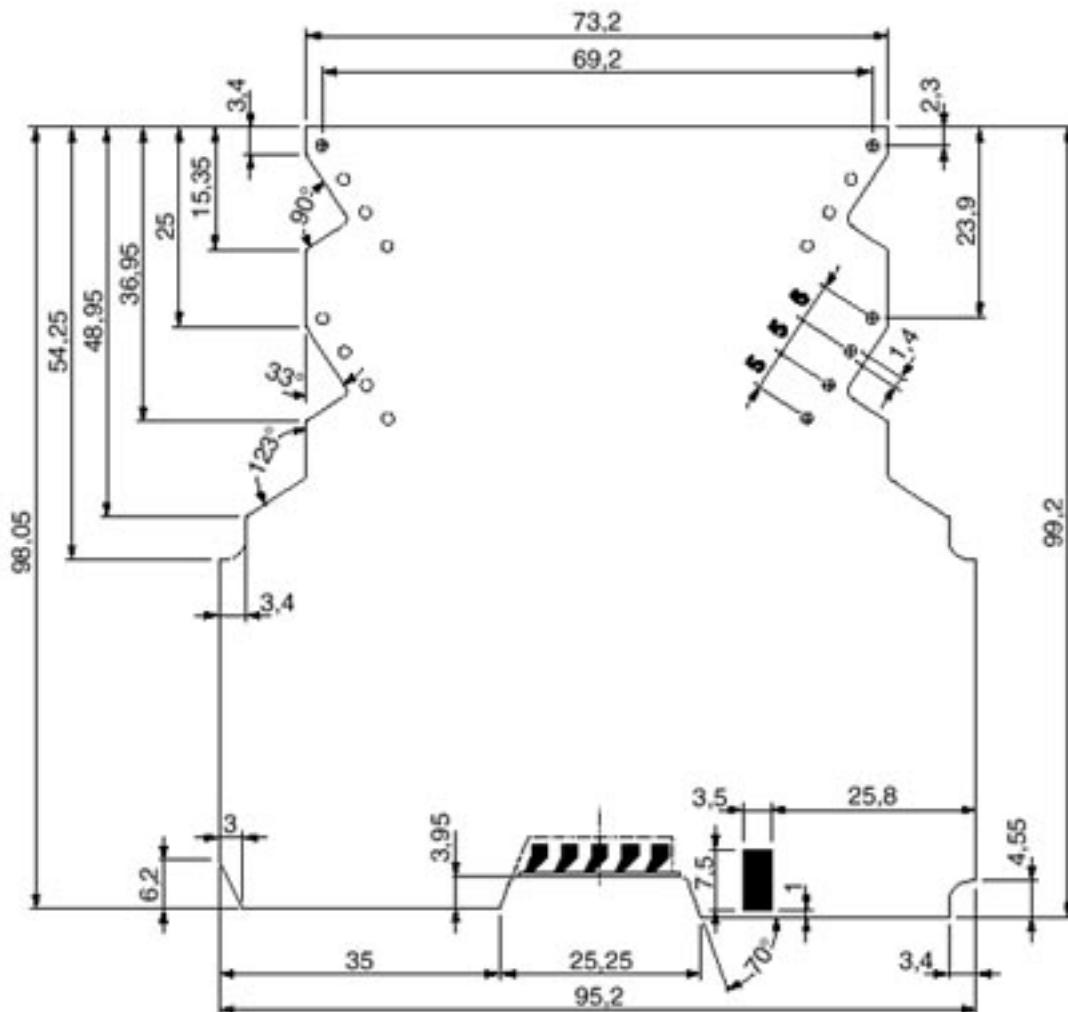

Dimensional drawing of the ME MAX 2-2 printed circuit board for plug connection (MSTBO), view: component side

Electronic housing - ME MAX 22.5 2-2 KMGY - 2713625

Drilling diagram

