



Chipsmall Limited consists of a professional team with an average of over 10 year of expertise in the distribution of electronic components. Based in Hongkong, we have already established firm and mutual-benefit business relationships with customers from,Europe,America and south Asia,supplying obsolete and hard-to-find components to meet their specific needs.

With the principle of "Quality Parts,Customers Priority,Honest Operation,and Considerate Service",our business mainly focus on the distribution of electronic components. Line cards we deal with include Microchip,ALPS,ROHM,Xilinx,Pulse,ON,Everlight and Freescale. Main products comprise IC,Modules,Potentiometer,IC Socket,Relay,Connector.Our parts cover such applications as commercial,industrial, and automotives areas.

We are looking forward to setting up business relationship with you and hope to provide you with the best service and solution. Let us make a better world for our industry!



Contact us

Tel: +86-755-8981 8866 Fax: +86-755-8427 6832

Email & Skype: info@chipsmall.com Web: www.chipsmall.com

Address: A1208, Overseas Decoration Building, #122 Zhenhua RD., Futian, Shenzhen, China



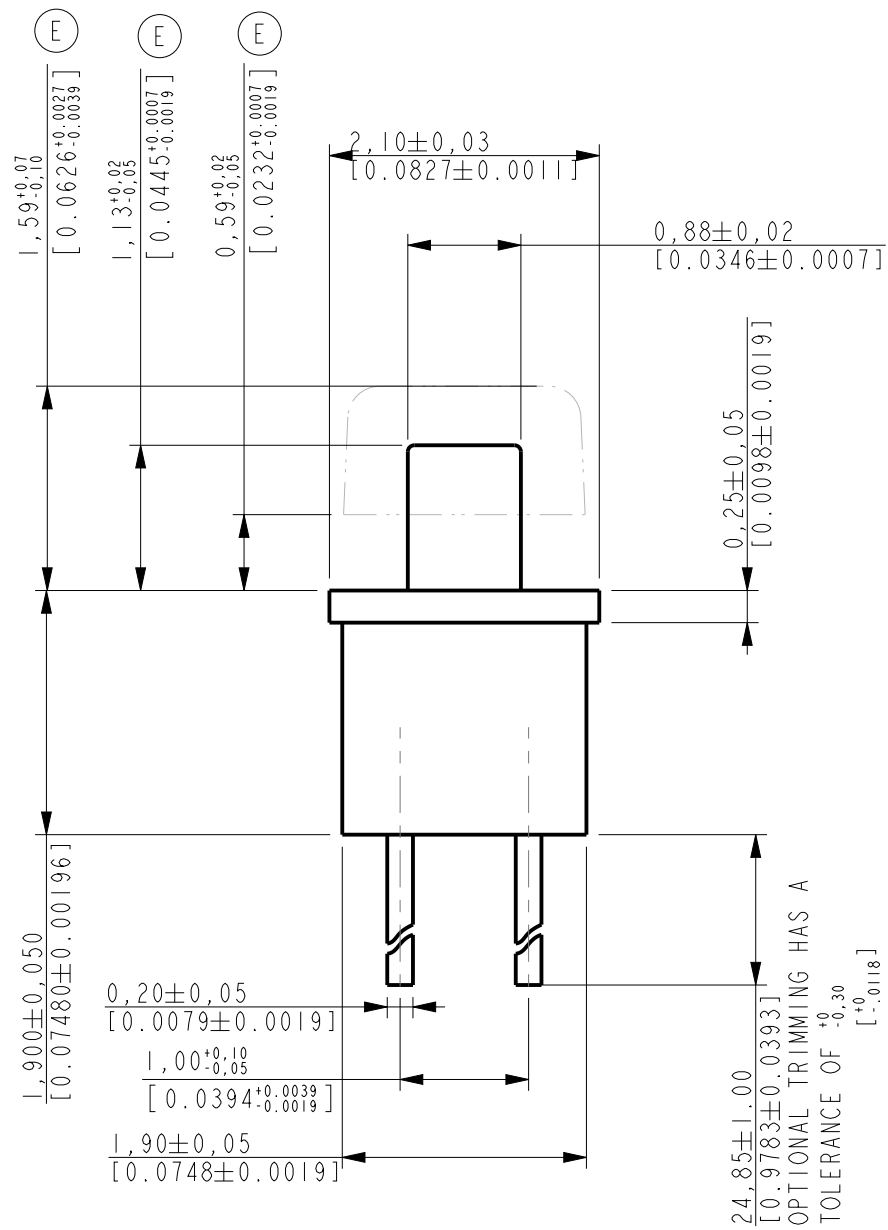

SCALE 10:1

ENVIRONMENTAL DATA	4.7	RECOMMENDED GLUE	CYANOACRYLATE (NON-BLOOMING)
	4.6	OPERATIONAL HUMIDITY CONDITIONS	10% RH TO 95% RH
	4.5	OPERATIONAL TEMPERATURE CONDITIONS	-25°C TO +55°C
	4.4	STORAGE TEMPERATURE	-40°C TO +60°
	4.3	CLEANING	AQUA WASH (ALPHA 2100), BENZINE AMMONIA, 10% SOLUTION WITH DEMINERALIZED WATER.
	4.2	SOLDERING DISTANCE (D)	0.5mm/0.02" FROM BASE, NO MECHANICAL STRESS TO BE APPLIED TO THE COMPONENT DURING SOLDERING
MATERIAL DATA	3.3	SWITCH CONTACT	NICKEL GOLD PLATED ALLOY COPPER
	3.2	SOLDER TERMINAL	GOLD PLATED SILVER ALLOY
	3.1	PLASTIC PARTS	GLASS FILLED NYLON
ELECTRICAL DATA	2.3	KNOB DEFLECTION FOR SWITCH CONTACT	>0,10mm < 0,33mm / 0,16mm OVERTRAVEL MIN.
	2.2	CONTINUOUS CURRENT	< 500 mA / 9V
	2.1	SWITCH CONTACT RESISTANCE	< 150 mΩ
MECHANICAL DATA	1.9.1	ALL MATERIALS (D)	COMPLIANCE WITH EU DIRECTIVE 2002/95/EC (RoHS)
	1.9	KNOB RETENTION FORCE	>10N
	1.8	SWITCH FORCE AT MAX. TRAVEL(OVER TRAVEL)	>115cN to <130cN
	1.7	KNOB TRAVEL	0,50mm
	1.6	MAX. ALLOWED FORCE TO BE APPLIED IN A 45° ANGLE TO SWITCH OPERATIONAL DIRECTION WITHOUT DAMAGES (MAX. 20 TIMES)	500 cN
	1.5	MAX. ALLOWED FORCE TO BE APPLIED IN OPERATIONAL DIRECTION WITHOUT DAMAGES	500 cN
	1.4	OPERATIONAL LIFE TIME	> 100.000 CYCLES
	1.3	SWITCH OPERATIONAL FORCE	>30 cN to <90 cN
	1.2	BENDING OF SOLDERING TERMINALS	> 4 CYCLES 90°
	1.1	PULL STRENGTH OF SOLDERING TERMINALS	> 500 cN INITIAL

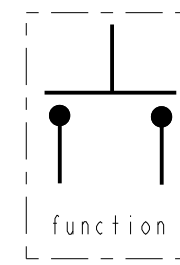

SCALE: 17:1				MATERIAL:	
FUNDAMENTAL TOLERANCE: ± 0,03 [0,001]				HEAT TREATMENT:	
ANGLE TOLERANCE: ± 1°				FINISH: refer to detail prints	
MISMATCH TOLERANCE: ± 0,03 [0,001]				TITLE: Model 2900 PRODUCTION	
E	C10111584	09/23/10	00	DATE	NAME
D	C10104073	04/03/06	BCS	6-23-08	SJ
C	C10103104	09/08/05	BCS	6-30-08	GJP
B	C10102732	06/10/05	BCS	6-30-08	GJP
A	A10100099	05/22/03	BCS	6-30-08	GJP
REV.	CHANGE #	DATE	NAME	RELEASED	
PROPRIETARY NOTE: THIS DOCUMENT CONTAINS INFORMATION WHICH IS THE PROPRIETARY PROPERTY OF KNOWLES ELECTRONICS, LLC. OR ITS AFFILIATED ENTITIES. IT IS ISSUED IN STRICT CONFIDENCE AND SHALL NOT BE REPRODUCED, COPIED, USED, OR DISCLOSED TO ANY THIRD PARTY PARTIALLY OR WHOLLY IN ANY MANNER WITHOUT PRIOR WRITTEN PERMISSION OF, AND MUST BE RETURNED UPON REQUEST BY, KNOWLES ELECTRONICS, LLC.				RELEASED LEVEL: Active DRAWING NUMBER: 2900-400	
				REVISION: E SHEETS: 1 of 1	