



Chipsmall Limited consists of a professional team with an average of over 10 year of expertise in the distribution of electronic components. Based in Hongkong, we have already established firm and mutual-benefit business relationships with customers from,Europe,America and south Asia,supplying obsolete and hard-to-find components to meet their specific needs.

With the principle of "Quality Parts,Customers Priority,Honest Operation,and Considerate Service",our business mainly focus on the distribution of electronic components. Line cards we deal with include Microchip,ALPS,ROHM,Xilinx,Pulse,ON,Everlight and Freescale. Main products comprise IC,Modules,Potentiometer,IC Socket,Relay,Connector.Our parts cover such applications as commercial,industrial, and automotives areas.

We are looking forward to setting up business relationship with you and hope to provide you with the best service and solution. Let us make a better world for our industry!



Contact us

Tel: +86-755-8981 8866 Fax: +86-755-8427 6832

Email & Skype: info@chipsmall.com Web: www.chipsmall.com

Address: A1208, Overseas Decoration Building, #122 Zhenhua RD., Futian, Shenzhen, China



4

3

2

1

THIS DRAWING IS UNPUBLISHED.

RELEASED FOR PUBLICATION

20

LOC

DIST

REVISIONS

© COPYRIGHT 20 BY -

ALL RIGHTS RESERVED.

P	LTR	DESCRIPTION	DATE	DWN	APVD
	E	UPDATED	20FEB2013	MZ	JC
	F	PARTS -1, -2, -3 RELEASED FOR PRODUCTION	27JUN2013	KR	JC

VISUAL INDICATOR
FOR PE CONDUCTOR

NOTES:

1) MATERIAL: POLYAMIDE GLASS FILLED
NATURAL COLOUR

2) PACKAGING: SEE TE PACKAGING SPECIFICATION
107-20294

△ 3 N CODE

△ 4 L CODE

△ 5 PE CODE

△ 6 TE CODE

△ 7 RATED VOLTAGE

△ 8 RATED CURRENT

△ 9 PART NOT YET RELEASED FOR PRODUCTION

NOTE	POL. KEYING	COLOUR	DESCRIPTION	REV.	PART NUMBER
△ 9	F	NATURAL	SOCKET CONN. PCB VERTICAL NECTOR* M-LINE	E	293602-6
△ 9	E	NATURAL	SOCKET CONN. PCB VERTICAL NECTOR* M-LINE	E	293602-5
△ 9	D	NATURAL	SOCKET CONN. PCB VERTICAL NECTOR* M-LINE	E	293602-4
	C	NATURAL	SOCKET CONN. PCB VERTICAL NECTOR* M-LINE	F	293602-3
	B	NATURAL	SOCKET CONN. PCB VERTICAL NECTOR* M-LINE	F	293602-2
	A	NATURAL	SOCKET CONN. PCB VERTICAL NECTOR* M-LINE	F	293602-1

3D VIEWS, FOR REFERENCE ONLY

SCALE 1:1

THIS DRAWING IS A CONTROLLED DOCUMENT.

DIMENSIONS:	TOLERANCES UNLESS OTHERWISE SPECIFIED:
mm	
0 PLC	±
1 PLC	±0.3
2 PLC	±0.20
3 PLC	±
4 PLC	±
ANGLES	±3°
MATERIAL	FINISH
-	-

DWN	M. ZUCCA	28OCT2009
CHK	M. ZUCCA	28OCT2009
APVD	G. TURCO	28OCT2009
PRODUCT SPEC	108-20304	
APPLICATION SPEC	114-20152	
WEIGHT	-	

TE Connectivity

NAME	SIZE	CAGE CODE	DRAWING NO	RESTRICTED TO
SOCKET CONNECTOR PCB VERTICAL VERSION NECTOR* M-LINE 3 POS. UNSEALED	A3	00779	C-293602	-

Customer Drawing

SCALE 3:1

SHEET 1 OF 3

REV F

1470-19 (3/11)

THIS DRAWING IS UNPUBLISHED.

RELEASED FOR PUBLICATION

20

© COPYRIGHT 20 BY -

ALL RIGHTS RESERVED.

LOC 1 DIST -

REVISIONS

P	LTR	DESCRIPTION	DATE	DWN	APVD
-		SEE SHEET 1	-	-	-

POLARIZATION KEYS

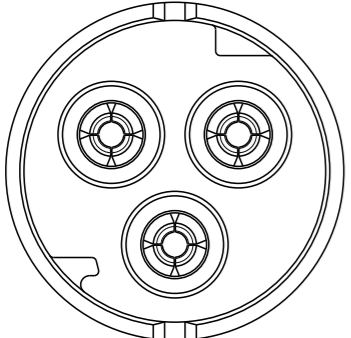
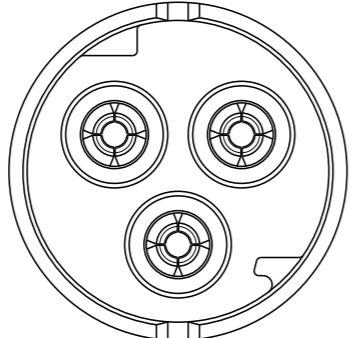
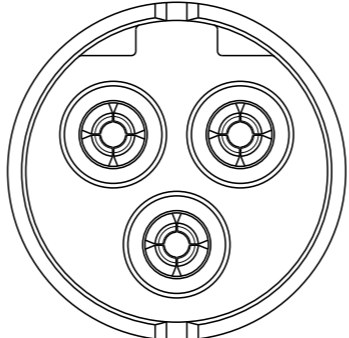
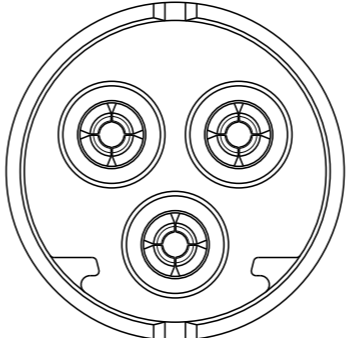
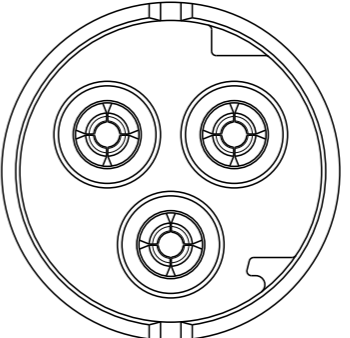
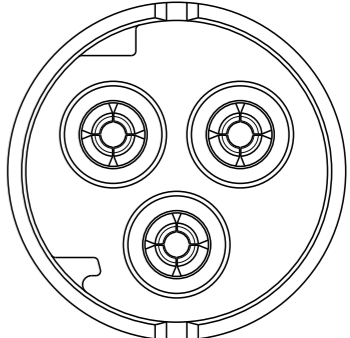
TYPE "A"	TYPE "B"	TYPE "C"	TYPE "D"	TYPE "E"	TYPE "F"
P/N 293602-1 AS SHOWN	P/N 293602-2 AS SHOWN	P/N 293602-3 AS SHOWN	P/N 293602-4 AS SHOWN	P/N 293602-5 AS SHOWN	P/N 293602-6 AS SHOWN
					

THIS DRAWING IS A CONTROLLED DOCUMENT.

DIMENSIONS:
mm

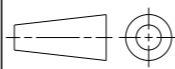

TOLERANCES UNLESS OTHERWISE SPECIFIED:

- 0 PLC ±-
- 1 PLC ±0.3
- 2 PLC ±0.20
- 3 PLC ±-
- 4 PLC ±-
- ANGLES ±3°

MATERIAL -

FINISH -

DWN M. ZUCCA 28OCT2009

CHK M. ZUCCA 28OCT2009

APVD G. TURCO 28OCT2009

PRODUCT SPEC 108-20304

APPLICATION SPEC 114-20152

WEIGHT -

Customer Drawing



TE Connectivity

NAME
SOCKET CONNECTOR PCB
VERTICAL VERSION
NECTOR* M-LINE 3 POS. UNSEALED

SIZE CAGE CODE DRAWING NO RESTRICTED TO

A300779 G-293602

SCALE 3:1 SHEET 2 OF 3 REV F

4

3

2

1

THIS DRAWING IS UNPUBLISHED.

RELEASED FOR PUBLICATION

20

© COPYRIGHT 20

BY -

ALL RIGHTS RESERVED.

LOC

DIST

REVISIONS

P	LTR	DESCRIPTION	DATE	DWN	APVD
-	-	SEE SHEET 1	-	-	-

PCB TOP VIEW

PCB TOP VIEW: Shows a vertical rectangular component with a central slot and two rectangular cutouts. Dimensions include a total height of 28.8 and a width of 3.4 (X2). A thickness of 1.60±0.10 is indicated. A 2.4 dimension is shown at the top left.

PCB BOTTOM VIEW: Shows the underside of the component with mounting tabs. Dimensions include a width of 3.4 (X2) and a 2.4 dimension at the bottom left.

SUGGESTED L, N AND PE TRACKS LAYOUT ON PCB

- BOTTOM VIEW -

- TOP VIEW -

- TOP VIEW -: Shows a top-down view of the PCB layout with dimensions: 60°±1° angle, 7.5±0.2 (X2) PATH WIDTH, and a hole diameter of Ø3.60±0.10 (X2).

- BOTTOM VIEW -: Shows a bottom-down view of the PCB layout with dimensions: 4.0±0.3, 6.55±0.05, Ø4.50±0.10 (X2), 1.9±0.10 (X2), 3.8±0.1, 7.50±0.20 PATH WIDTH, Ø4.5±0.1, and a 50°±1° angle.

SUGGESTED PCB LAYOUT

SCALE 5:1

Dimensions: 5.60±0.05 (TYP X3), 4.30±0.20 (TYP X2), R0.50 (TYP X6), 5.30±0.20, R0.50 (TYP X3), Ø6.47, Ø1.80±0.10 (TYP X3), Ø2.20±0.10.

THIS DRAWING IS A CONTROLLED DOCUMENT.

DWN M. ZUCCA 28OCT2009

CHK M. ZUCCA 28OCT2009

APVD G. TURCO 28OCT2009

PRODUCT SPEC 108-20304

APPLICATION SPEC 114-20152

WEIGHT -

Customer Drawing

STE

TE Connectivity

NAME SOCKET CONNECTOR PCB VERTICAL VERSION NECTOR* M-LINE 3 POS. UNSEALED

SIZE CAGE CODE DRAWING NO RESTRICTED TO

A300779 C-293602

SCALE 3:1 SHEET 3 OF 3 REV F

1470-19 (3/11)