



Chipsmall Limited consists of a professional team with an average of over 10 year of expertise in the distribution of electronic components. Based in Hongkong, we have already established firm and mutual-benefit business relationships with customers from,Europe,America and south Asia,supplying obsolete and hard-to-find components to meet their specific needs.

With the principle of “Quality Parts,Customers Priority,Honest Operation,and Considerate Service”,our business mainly focus on the distribution of electronic components. Line cards we deal with include Microchip,ALPS,ROHM,Xilinx,Pulse,ON,Everlight and Freescale. Main products comprise IC,Modules,Potentiometer,IC Socket,Relay,Connector.Our parts cover such applications as commercial,industrial, and automotives areas.

We are looking forward to setting up business relationship with you and hope to provide you with the best service and solution. Let us make a better world for our industry!



## Contact us

Tel: +86-755-8981 8866 Fax: +86-755-8427 6832

Email & Skype: info@chipsmall.com Web: www.chipsmall.com

Address: A1208, Overseas Decoration Building, #122 Zhenhua RD., Futian, Shenzhen, China



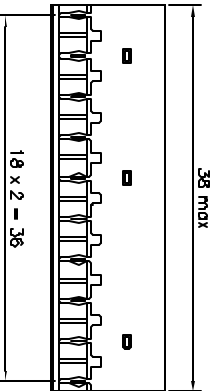
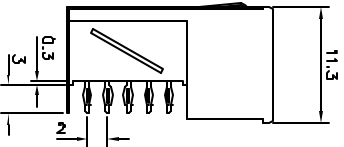
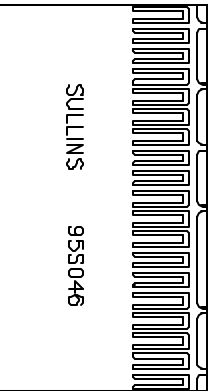
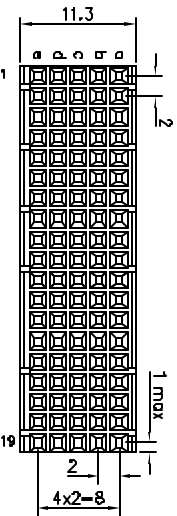

- NOTES:
- 1 MATERIAL: POLYESTER, UL94V-0
  - HOUSING: GLASS-FILLED POLYESTER, UL94V-0
  - CONTACTS: PHOSPHOR BRONZE
  - 2 FINISH
  - H = 30 " (0.75 mm) GOLD PLATING ON CONTACT AREA, TIN-PLATED ON TAIL UNDER PLATING ALL OVER NICKEL
  - 3 MARKING: SULLINS
- PART NUMBER  
MFG CODE/BATCH NUMBER  
ON THE APPROXIMATE AREA AS DRAWING

DESCRIPTION : 2.0mm FEMALE, TYPE B19

PRODUCT

NO.1	2B19F955F001-1-H				
NO.2		mm/mm	QWTF151A		
NO.3					
NO.4					TA0168

Sullins Electronics Corp