



Chipsmall Limited consists of a professional team with an average of over 10 year of expertise in the distribution of electronic components. Based in Hongkong, we have already established firm and mutual-benefit business relationships with customers from,Europe,America and south Asia,supplying obsolete and hard-to-find components to meet their specific needs.

With the principle of “Quality Parts,Customers Priority,Honest Operation,and Considerate Service”,our business mainly focus on the distribution of electronic components. Line cards we deal with include Microchip,ALPS,ROHM,Xilinx,Pulse,ON,Everlight and Freescale. Main products comprise IC,Modules,Potentiometer,IC Socket,Relay,Connector.Our parts cover such applications as commercial,industrial, and automotives areas.

We are looking forward to setting up business relationship with you and hope to provide you with the best service and solution. Let us make a better world for our industry!



Contact us

Tel: +86-755-8981 8866 Fax: +86-755-8427 6832

Email & Skype: info@chipsmall.com Web: www.chipsmall.com

Address: A1208, Overseas Decoration Building, #122 Zhenhua RD., Futian, Shenzhen, China



MICRO SWITCH

a Honeywell Division

FED. MFG. CODE 91929

ASSEMBLY— PUSHBUTTON SWITCH

CATALOG LISTING

2PB453-T

CATALOG LISTING
2PB453-T
PAGE 1 OF 1
REPLACES
RELEASE NO. PR-20681
CHECK
M
ISSUE
2

REVISIONS
A CO-1
93593
P P F
03 NOV 98

DDM/CAD
DRAWN
M A M 13 OCT 93
CHECK
J A F 03 NOV 98
CHECK

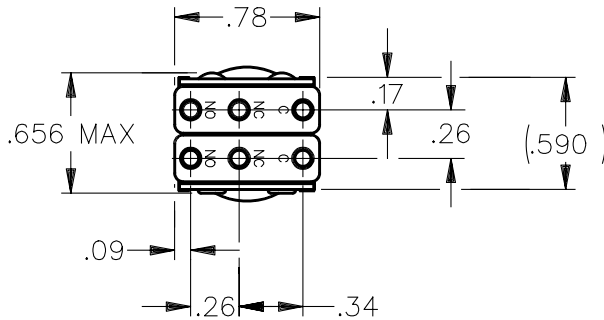
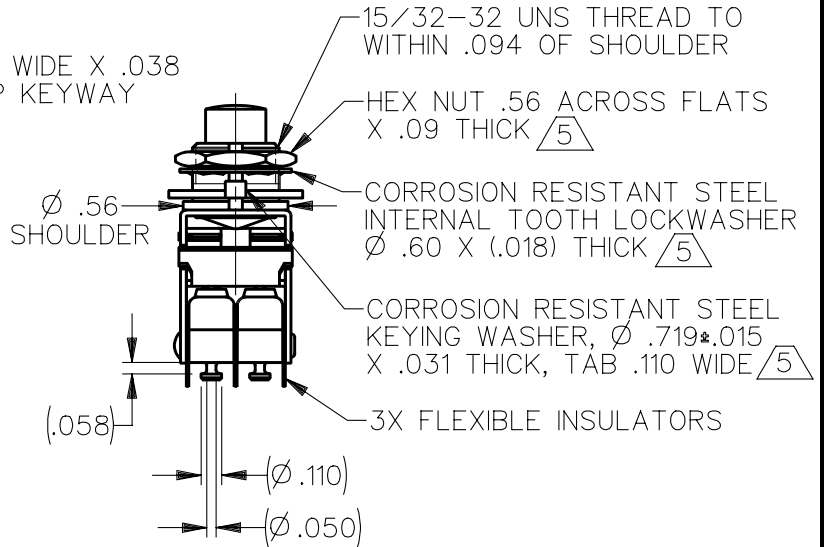
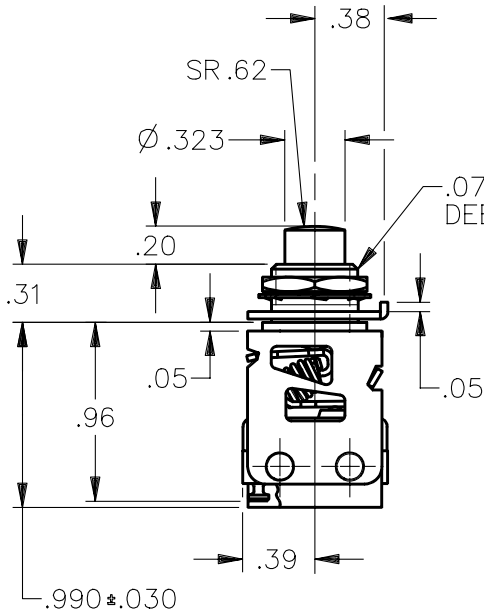

NOTES

- 1 - UNIT INCLUDES 2X "11SM" TYPE BASIC SWITCH
- 2 - SWITCHES DO NOT NECESSARILY OPERATE SIMULTANEOUSLY
- 3 - TERMINALS ARE GOLD PLATED
- 4 - BASIC SWITCHES HAVE 24K SOLID GOLD CONTACTS
- (5) MOUNTING HARDWARE FURNISHED UNASSEMBLED
- 6 - CORROSION RESISTANT STEEL PLUNGER, BUSHING AND BRACKET

ANSI Y14.5M-1982 APPLIES

THIS DRAWING COVERS A PROPRIETARY ITEM AND IS THE PROPERTY OF MICRO SWITCH, A DIVISION OF HONEYWELL. THIS DRAWING IS NOT TO BE COPIED OR USED WITHOUT THE APPROVAL OF MICRO SWITCH.

THIRD ANGLE PROJECTION

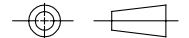

CHARACTERISTICS	ELECTRICAL DATA	SCALE FULL	DO NOT SCALE PRINT
OPERATING FORCE — — — — — 8-12 N	CONTACT ARRANGEMENT 2X S P D T	UNLESS OTHERWISE SPECIFIED TOLERANCES ARE	
TOTAL TRAVEL — — — — 3.2 mm APPROX	30 VOLTS DC RATING		
PRETRAVEL — — — — — 1.2 mm MIN	INDUCTIVE — — — — — SEA LEVEL — 1/2 AMP	ONE PLACE (.0)	±.030
DIFFERENTIAL TRAVEL — — — — 1.27 mm MAX	RESISTIVE — — — — — SEA LEVEL — 1 AMP	TWO PLACE (.00)	±.015
OVERTRAVEL — — — — — .8 mm MIN	MAXIMUM INRUSH — — — — — 2 AMP	THREE PLACE (.000)	±.005
		ANGLES	±
		WEIGHT	