



Chipsmall Limited consists of a professional team with an average of over 10 year of expertise in the distribution of electronic components. Based in Hongkong, we have already established firm and mutual-benefit business relationships with customers from,Europe,America and south Asia,supplying obsolete and hard-to-find components to meet their specific needs.

With the principle of “Quality Parts,Customers Priority,Honest Operation,and Considerate Service”,our business mainly focus on the distribution of electronic components. Line cards we deal with include Microchip,ALPS,ROHM,Xilinx,Pulse,ON,Everlight and Freescale. Main products comprise IC,Modules,Potentiometer,IC Socket,Relay,Connector.Our parts cover such applications as commercial,industrial, and automotives areas.

We are looking forward to setting up business relationship with you and hope to provide you with the best service and solution. Let us make a better world for our industry!



## Contact us

Tel: +86-755-8981 8866 Fax: +86-755-8427 6832

Email & Skype: [info@chipsmall.com](mailto:info@chipsmall.com) Web: [www.chipsmall.com](http://www.chipsmall.com)

Address: A1208, Overseas Decoration Building, #122 Zhenhua RD., Futian, Shenzhen, China



LOC	DIST	REVISIONS				
AD	00	P	LTR	DESCRIPTION	DATE	DWN
		A		EC 0G3C-0403-03	18AUG04	BSV
						APVD
						MZ

D

C

B

A

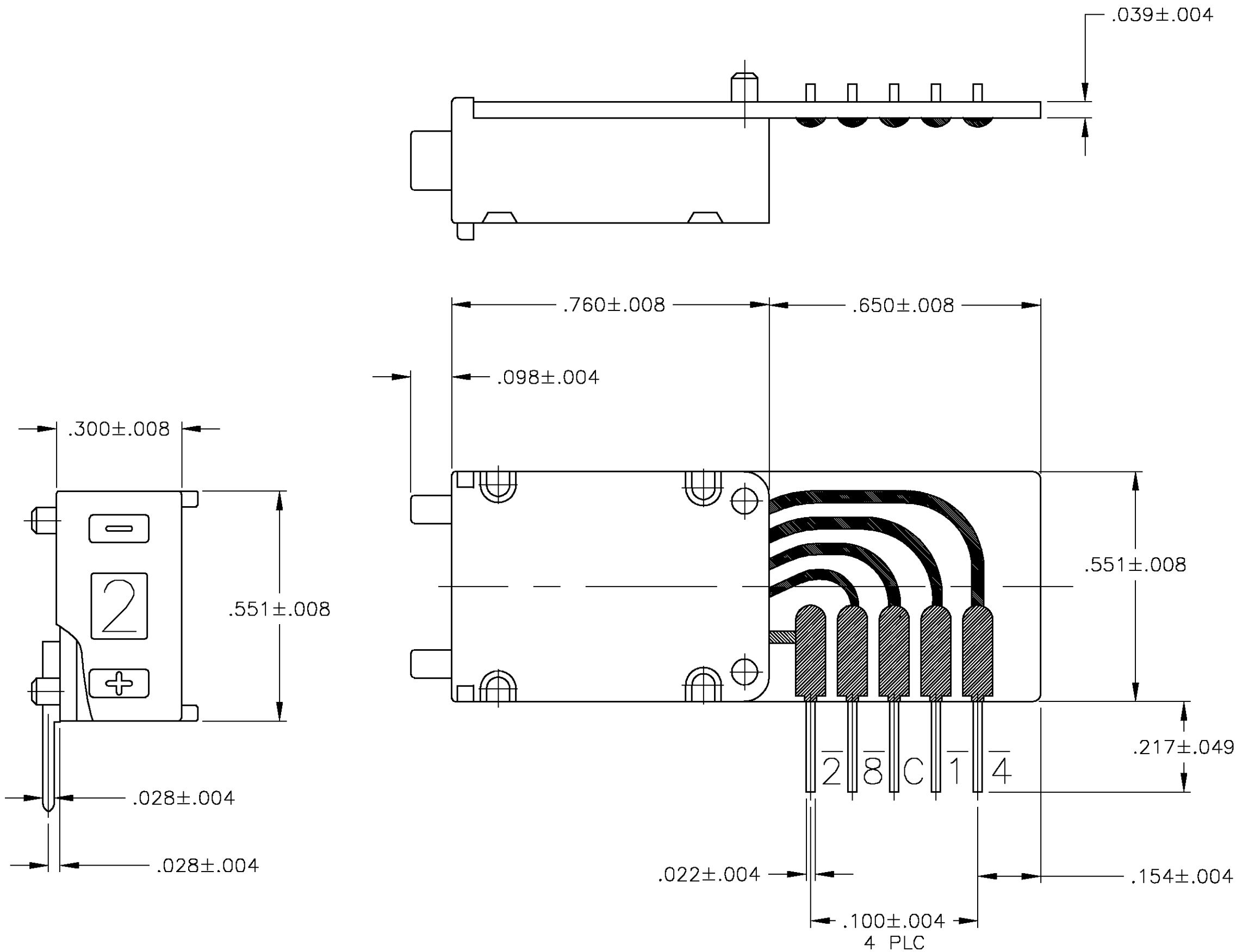

10 POSITION BCD COMPEMENT					
Pin connection					
	c	1	2	4	8
0	●	●	●	●	●
1	●		●	●	●
2	●	●		●	●
3	●			●	●
4	●	●	●		●
5	●		●		●
6	●	●			●
7	●				●
8	●	●	●	●	
9	●		●	●	

PICORD137ALULS  
3-1437601-2

Technical Data

Mechanical	
Permissible ambient temperature	-20°C to +60°C
Expected life (switching cycles)	> 10 <sup>5</sup>
Actuating force approx.	3N (305g)
Weight approx.	2g
Character height	.122" (10 Position), .094" (16 Position)
Click action	yes
Vibration	DIN EN 60068-2-6
Shock	DIN EN 60068-2-27

Electrical	
Operating voltage	max. 40V
Contact load, static	max. 0.5A
Contact load, dynamic (resistive)	max. 100mA
Contact resistance (measured from the supply line to the output)	< 100m0hm

Material	
Housing & Buttons	PPO, Black
PC board base material	FR4
Contact surface	Au over Ni on Cu
Sliding contact	Au over Ni on CuSn6

THIS DRAWING IS A CONTROLLED DOCUMENT.		DWN BSV	18AUG04	<b>tyco</b> Tyco Electronics Corporation	
DIMENSIONS: INCHES		CHK -	-	<b>Electronics</b> Harrisburg, Pa 17105-3608	
		APVD M ZITTO	-	NAME SWITCH, PUSHWHEEL, PICORDXXXALUS	
		PRODUCT SPEC	-		
		APPLICATION SPEC	-		
MATERIAL SEE TABLE		WEIGHT -	-	SIZE A2	RESTRICTED TO -
		CUSTOMER DRAWING	-	CAGE CODE 00779	
				DRAWING NO C=3-1437601-2	
				SCALE 4:1	SHEET 1 OF 1
				REV A	

3-1437601-2

B

A