



Chipsmall Limited consists of a professional team with an average of over 10 year of expertise in the distribution of electronic components. Based in Hongkong, we have already established firm and mutual-benefit business relationships with customers from,Europe,America and south Asia,supplying obsolete and hard-to-find components to meet their specific needs.

With the principle of “Quality Parts,Customers Priority,Honest Operation,and Considerate Service”,our business mainly focus on the distribution of electronic components. Line cards we deal with include Microchip,ALPS,ROHM,Xilinx,Pulse,ON,Everlight and Freescale. Main products comprise IC,Modules,Potentiometer,IC Socket,Relay,Connector.Our parts cover such applications as commercial,industrial, and automotives areas.

We are looking forward to setting up business relationship with you and hope to provide you with the best service and solution. Let us make a better world for our industry!



Contact us

Tel: +86-755-8981 8866 Fax: +86-755-8427 6832

Email & Skype: info@chipsmall.com Web: www.chipsmall.com

Address: A1208, Overseas Decoration Building, #122 Zhenhua RD., Futian, Shenzhen, China





Corcom H Series 20A Power Line Filters

The H Series filters are suitable for use in medical equipment and feature a 2 element circuit that provides general purpose performance above 1MHz with minimal leakage current. The new 20A versions are for chassis mount installations and offer either spade or threaded bolt terminations.

KEY FEATURES

- Minimal leakage current suitable for medical equipment
- Two element circuit provides basic EMI attenuation above 1MHz
- Low profile design allows for a space-saving design solution
- Compliant with internal spacing requirements for UL60601-1, 3rd edition for medical applications
- Capacitive input
- Designed for easy connection and installation

APPLICATIONS

- Dialysis machines
- Diagnostic equipment
- Medical laser
- CAT scanners
- MRT scanners
- Dentist equipment
- Operating room equipment
- Physical therapy equipment

ORDERING INFORMATION

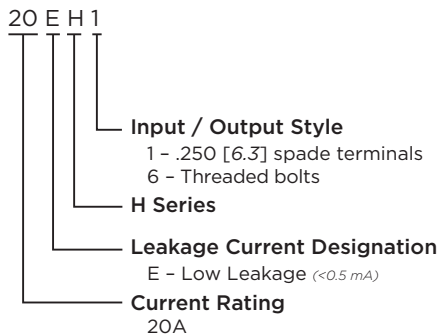

STANDARDS AND SPECIFICATIONS

- UL Recognized
- VDE Approved
- CSA Pending



ELECTRICAL SPECIFICATIONS

Hipot rating (one minute):	Line to Ground:	1500 VAC
	Line to Line:	1450 VDC
Rated Voltage:		250 VAC
Operating Frequency:		50/60 Hz
Rated Current:		20A max.

ELECTRICAL SCHEMATIC

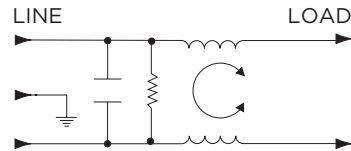

PRODUCT OFFERING

- 3-1609037-8:** 20EH1 20A H Series filter with spade terminals
4-1609037-3: 20EH6 20A H Series filter with threaded bolt terminals

Samples Available



CASE STYLES

20EH1

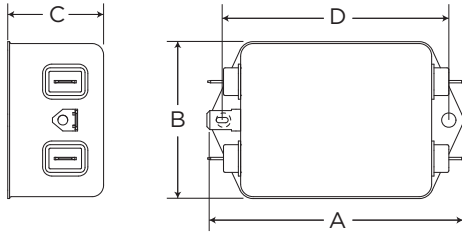

20EH6

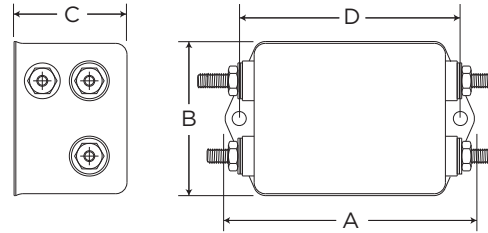

DIMENSIONS

Part Numbers	A (max)	B (max)	C (max)	D ± .015 ± .38
20EH1	3.35	2.07	1.31	2.94
	<i>85</i>	<i>52.6</i>	<i>33.3</i>	<i>74.63</i>
20EH6	3.35	2.07	1.53	2.94
	<i>85</i>	<i>52.6</i>	<i>38.9</i>	<i>74.63</i>

PERFORMANCE DATA

Minimum Insertion Loss - Measured in closed 50 Ohm system

Common Mode / Asymmetrical (Line to Ground)

Current Rating	Frequency — MHz					
	.15	.5	1	5	10	30
20A	10	20	21	15	15	15

Differential Mode / Symmetrical (Line to Line)

Current Rating	Frequency — MHz					
	.15	.5	1	5	10	30
20A	-	1	5	20	30	25

Dimensions in inches and millimeters unless otherwise shown. Values in italics are metric equivalents. Dimensions are shown for reference purposes only. Specifications subject to change. Customer drawing should be used for all design activity.

