



Chipsmall Limited consists of a professional team with an average of over 10 year of expertise in the distribution of electronic components. Based in Hongkong, we have already established firm and mutual-benefit business relationships with customers from,Europe,America and south Asia,supplying obsolete and hard-to-find components to meet their specific needs.

With the principle of "Quality Parts,Customers Priority,Honest Operation,and Considerate Service",our business mainly focus on the distribution of electronic components. Line cards we deal with include Microchip,ALPS,ROHM,Xilinx,Pulse,ON,Everlight and Freescale. Main products comprise IC,Modules,Potentiometer,IC Socket,Relay,Connector.Our parts cover such applications as commercial,industrial, and automotives areas.

We are looking forward to setting up business relationship with you and hope to provide you with the best service and solution. Let us make a better world for our industry!



## Contact us

Tel: +86-755-8981 8866 Fax: +86-755-8427 6832

Email & Skype: info@chipsmall.com Web: www.chipsmall.com

Address: A1208, Overseas Decoration Building, #122 Zhenhua RD., Futian, Shenzhen, China



THIS DRAWING IS UNPUBLISHED. RELEASED FOR PUBLICATION  
 © COPYRIGHT - By - ALL RIGHTS RESERVED.

LOC		DIST		REVISIONS			
P	LTR	DESCRIPTION		DATE	DWN	APVD	
FT	0	K	REVIS	PER ECO-13-018030	16NOV2013	KH	MZ

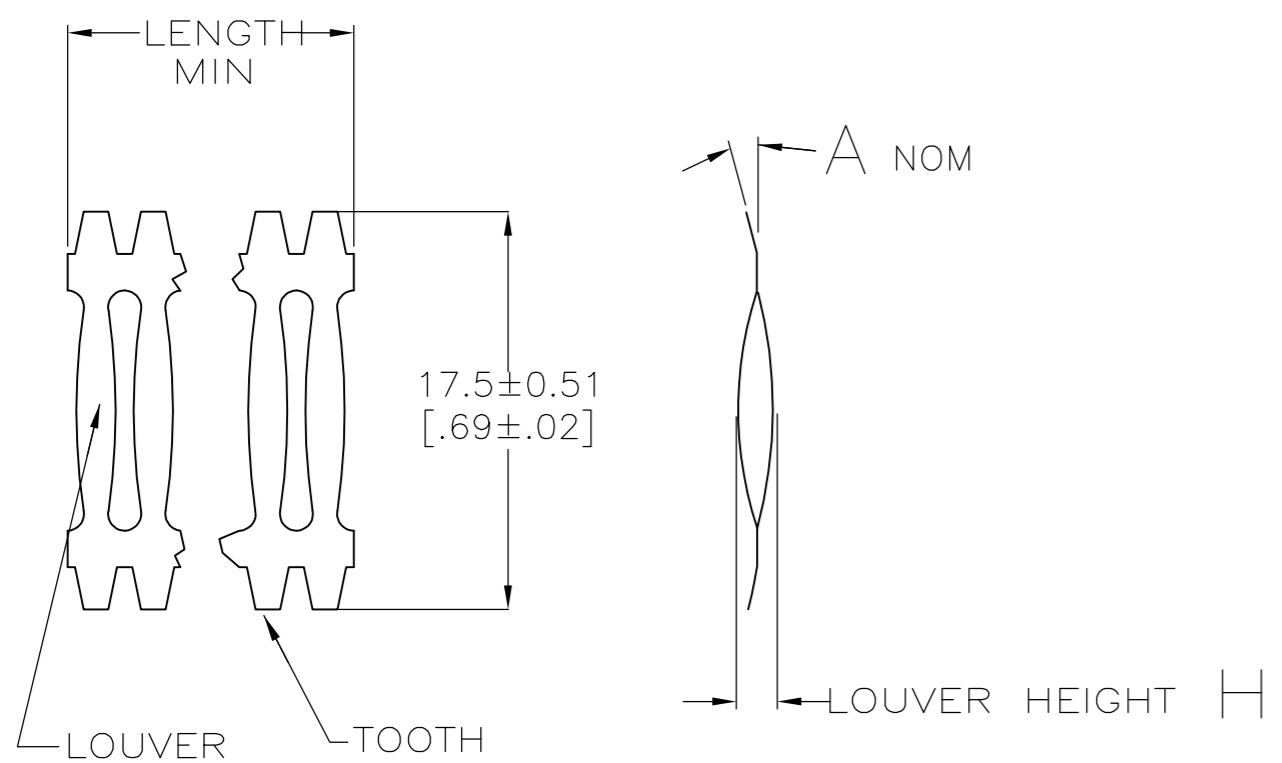

- 1 FINISH-SILVER PLATE 2.54μm[100μ"] THICK MIN
- 2 FINISH-SILVER PLATE 5.08μm[200μ"] THICK MIN
- 3 FINISH-NICKEL PLATE 2.54μm[100μ"] THICK MIN
- 4 FINISH-NICKEL PLATE 1.02μm[40μ"] THICK MIN
- 5 FINISH-GOLD PLATE .25μm[10μ"] THICK MIN
- 6 FINISH-GOLD PLATE 1.27μm[50μ"] THICK MIN
- 7 FINISH-TIN PLATE 7.62μm[300μ"] THICK MIN
- 8 LENGTH-23 LOUVERS (2.3 INCHES).
- 9
- 10
- 11 PLATING NOTES TO BE INTERPRETED AS FOLLOWS: 1-4 AS 1 OVER 4.
- 12 PRODUCT IS SOLD BY THE FOOT.
- 14 10 LOUVERS 25.4mm (1.0).
- 15 PRELIMINARY PART NUMBER.
- 16 P/N 3-192004-0 IS CUT TO A LENGTH OF 19.50 INCHES
- 17 6 LOUVERS 15.2mm(.60 IN)
- 18 OBSOLETE PARTS: OBSOLETE CIS STREAMLINING PER D.RENAUD/D.SINISI
- 19 3 LOUVERS 7.62±0.25[.300±.010] IN LENGTH. EDGES OF CONTACT WHERE STRIPS WERE CUT TO LENGTH WILL BE PLATED.

LOUVER HEIGHT H	LENGTH	MAT'L	PLATING (NOTE NO.)	TOOTH ANGLE A	MAT'L THK T	REF	PART NUMBER
1.19/1.34[.047/.053]	SEE NOTE 19	BeCu	6-4	15°	0.15[.006]	--	3-192004-2
1.19/1.34[.047/.053]	SEE NOTE 17	BeCu	2-4	15°	0.15[.006]	--	3-192004-1
1.19/1.34[.047/.053]	SEE NOTE 16	BeCu	2-4	45°	0.15[.006]	--	3-192004-0
1.19/1.34[.047/.053]	SEE NOTE 12	BeCu	7	15°	0.15[.006]	--	2-192004-9
1.19/1.34[.047/.053]	SEE NOTE 14	BeCu	2-4	15°	0.15[.006]	--	2-192004-8
1.24/1.40[.049/.055]	SEE NOTE 8	BeCu	2-4	15°	0.20[.008]	--	2-192004-7
1.24/1.40[.049/.055]	SEE NOTE 12	BeCu	7	15°	0.20[.008]	--	2-192004-6
1.19/1.34[.047/.053]	20.1m[792"]	BeCu	1-4	15°	0.10[.004]	--	2-192004-5
1.19/1.34[.047/.053]	20.1m[792"]	BeCu	1-4	15°	0.15[.006]	--	2-192004-4
1.19/1.34[.047/.053]	20.1m[792"]	BeCu	UNPL	15°	0.15[.006]	--	2-192004-3
--	--	--	--	--	--	--	2-192004-2
--	--	--	--	--	--	--	2-192004-1
1.19/1.34[.047/.053]	20.1m[792"]	BeCu	UNPL	15°	0.10[.004]	01323	2-192004-0
1.24/1.40[.049/.055]	SEE NOTE 12	BeCu	2-4	15°	0.20[.008]	01029	1-192004-9
1.24/1.40[.049/.055]	SEE NOTE 12	BeCu	UNPL	15°	0.20[.008]	01322	1-192004-8
1.14[.045] MIN	SEE NOTE 12	CNCL	UNPL	45°	0.15[.006]	01066	1-192004-7
1.19/1.34[.047/.053]	SEE NOTE 12	BeCu	6-4	45°	0.15[.006]	01023	1-192004-6
1.19/1.34[.047/.053]	SEE NOTE 12	BeCu	5-4	45°	0.15[.006]	01037	1-192004-5
1.19/1.34[.047/.053]	SEE NOTE 12	BeCu	2-4	45°	0.15[.006]	01013	1-192004-4
1.19/1.34[.047/.053]	SEE NOTE 12	BeCu	UNPL	45°	0.15[.006]	01011	1-192004-3
1.14[.045] MIN	SEE NOTE 12	CNCL	UNPL	15°	0.15[.006]	01022	1-192004-2
1.19/1.34[.047/.053]	SEE NOTE 12	BeCu	6-4	15°	0.15[.006]	01015	1-192004-1
1.19/1.34[.047/.053]	SEE NOTE 12	BeCu	5-4	15°	0.15[.006]	01036	1-192004-0
1.19/1.34[.047/.053]	SEE NOTE 12	BeCu	3	15°	0.15[.006]	01020	192004-9
1.19/1.34[.047/.053]	SEE NOTE 12	BeCu	2-4	15°	0.15[.006]	01005	192004-8
1.19/1.34[.047/.053]	SEE NOTE 12	BeCu	UNPL	15°	0.15[.006]	01003	192004-7
1.19/1.34[.047/.053]	SEE NOTE 12	BeCu	2-4	45°	0.10[.004]	01049	192004-6
1.19/1.34[.047/.053]	SEE NOTE 12	BeCu	3	15°	0.10[.004]	01058	192004-5
1.19/1.34[.047/.053]	SEE NOTE 12	BeCu	2-4	15°	0.10[.004]	01002	192004-4
1.19/1.34[.047/.053]	SEE NOTE 12	BeCu	UNPL	15°	0.10[.004]	01017	192004-3
1.09/1.24[.043/.049]	SEE NOTE 12	BeCu	2-4	15°	0.08[.003]	01001	192004-2
1.09/1.24[.043/.049]	SEE NOTE 12	BeCu	UNPL	15°	0.08[.003]	01021	192004-1

THIS DRAWING IS A CONTROLLED DOCUMENT.

DWN 08-12-91	RA JAYNE	<b>STE</b> TE Connectivity
CHK 08-12-91	RA JAYNE	
APVD -	NAME	CONTACT BAND,FEM STRIP
PRODUCT SPEC -	APPLICATION SPEC -	SIZE CAGE CODE DRAWING NO RESTRICTED TO
WEIGHT -	A2 00779	C=192004
CUSTOMER DRAWING	SCALE NTS	SHEET 1 OF 1 REV K