



Chipsmall Limited consists of a professional team with an average of over 10 year of expertise in the distribution of electronic components. Based in Hongkong, we have already established firm and mutual-benefit business relationships with customers from,Europe,America and south Asia,supplying obsolete and hard-to-find components to meet their specific needs.

With the principle of "Quality Parts,Customers Priority,Honest Operation,and Considerate Service",our business mainly focus on the distribution of electronic components. Line cards we deal with include Microchip,ALPS,ROHM,Xilinx,Pulse,ON,Everlight and Freescale. Main products comprise IC,Modules,Potentiometer,IC Socket,Relay,Connector.Our parts cover such applications as commercial,industrial, and automotives areas.

We are looking forward to setting up business relationship with you and hope to provide you with the best service and solution. Let us make a better world for our industry!



Contact us

Tel: +86-755-8981 8866 Fax: +86-755-8427 6832

Email & Skype: info@chipsmall.com Web: www.chipsmall.com

Address: A1208, Overseas Decoration Building, #122 Zhenhua RD., Futian, Shenzhen, China



THIS DRAWING IS UNPUBLISHED.		BY AMP INCORPORATED.		RELEASED FOR PUBLICATION		ALL RIGHTS RESERVED.		19		
COPYRIGHT 19		ENTRE		N'ENTRE PAS		UTILISATION				
NUMERO	Y +0,01 0	X MAX.	R MAX.	Y ±0,005	X MAX.	R MAX.				
	OBSOLETE, SUPERSEDED BY 525440-7									
481552-1	2,959	2,540	1,524	3,111	2,540	1,524	69646			
481552-2	4,597	4,572	2,286	4,851	4,572	2,286	220045-2			
1-481552-6										
1-481552-8										
2-481552-3										
2-481552-4	2,799	2,692	1,346	2,921	2,692	1,346	220020-4			
2-481552-5	4,242	3,810	2,032	4,367	3,810	2,032	483127-1			
3-481552-1	2,845	2,692	1,346	2,972	2,692	1,346	220015(E)			
4-481552-2										
4-481552-3										
8-481552-3	3,251	3,946	1,473	3,404	3,946	1,473	69307-1			
483468-4	1,333	3,048	1,524	1,511	3,048	1,524	90222-5			
483468-7	1,575	2,540	1,270	1,880	2,540	1,270	90274			
2-483498-9	6,426	6,299	3,150	6,574	6,299	3,150	69477-1			
5-483468-7	1,245	0,533	1,118	1,321	0,533	1,118	220061-1			
5-483468-8	2,743	2,235	1,118	2,921	2,235	1,118	220066-1			
5-483468-9	2,337	2,184	1,321	2,565	2,184	1,321	220066-1			
6-483468-0	5,486	4,623	2,311	5,690	4,623	2,311	220066-1			
6-483468-1	4,623	4,470	2,718	4,851	4,470	2,718	220066-1			
7-483468-2										
9-483468-3	4,978	4,343	2,311	5,131	4,343	2,311	69205-1			
9-483468-4	4,013	3,810	1,905	4,166	3,810	1,905	69246-2			
949038-1	2,845	2,690	1,340	2,951	2,690	1,340	402660			
949038-2										
949038-3										
949038-4										

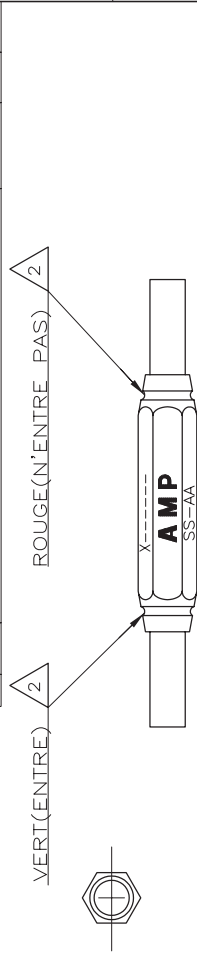

MANCHE (ech.1)

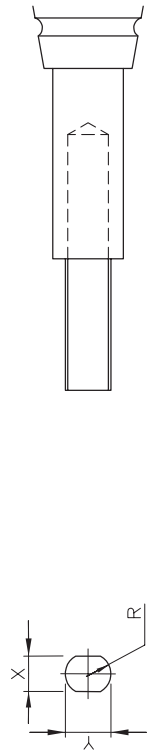

EMBOUT

△ FILET DE PEINTURE DANS LA GORGE,
DE LA COULEUR INDIQUEE

THIS DRAWING IS A CONTROLLED DOCUMENT FOR AMP INCORPORATED. IT IS SUBJECT TO CHANGE AND THE CONTROLLING ENGINEERING ORGANIZATION SHOULD BE CONTACTED FOR THE LATEST REVISION.		DWN C:KNOEPELE 13-NOV-95		AMP DE FRANCE 95301 PONTOISE	
DIMENSIONS: mm		CHK C:KNOEPELE 04-APR-00		DRAWING NO A3 00779	
TOLERANCES UNLESS OTHERWISE SPECIFIED: 0 PLC ± 1 PLC ± 2 PLC ± 3 PLC ± 4 PLC ± FINISH		P:RANSON PRODUCT SPEC		SCALE 1:1	
MATERIAL		APPLICATION SPEC		UNIFORMEMENT POUR REFERENCE	
MATERIAL		WEIGHT		CLIENT A3	
MATERIAL		CUSTOMER DRAWING/PLAN		SHEET 1 OF 1	
MATERIAL		DRAWING NO		REV 1	
MATERIAL		CAGE CODE		REV 1	
MATERIAL		SIZE		REV 1	
MATERIAL		CALIBRE DE CONTROLE TYPE "L"		REV 1	
MATERIAL		AMP		REV 1	