



Chipsmall Limited consists of a professional team with an average of over 10 year of expertise in the distribution of electronic components. Based in Hongkong, we have already established firm and mutual-benefit business relationships with customers from,Europe,America and south Asia,supplying obsolete and hard-to-find components to meet their specific needs.

With the principle of “Quality Parts,Customers Priority,Honest Operation,and Considerate Service”,our business mainly focus on the distribution of electronic components. Line cards we deal with include Microchip,ALPS,ROHM,Xilinx,Pulse,ON,Everlight and Freescale. Main products comprise IC,Modules,Potentiometer,IC Socket,Relay,Connector.Our parts cover such applications as commercial,industrial, and automotives areas.

We are looking forward to setting up business relationship with you and hope to provide you with the best service and solution. Let us make a better world for our industry!



Contact us

Tel: +86-755-8981 8866 Fax: +86-755-8427 6832

Email & Skype: info@chipsmall.com Web: www.chipsmall.com

Address: A1208, Overseas Decoration Building, #122 Zhenhua RD., Futian, Shenzhen, China



THIS DRAWING IS UNPUBLISHED. RELEASED FOR PUBLICATION
 © COPYRIGHT - By - ALL RIGHTS RESERVED.

LOC	DIST	REVISIONS					
		P	LTR	DESCRIPTION	DATE	DWN	APVD
CM	00	U		REVISED PER ECO-12-007610	25JUL12	KH	SM

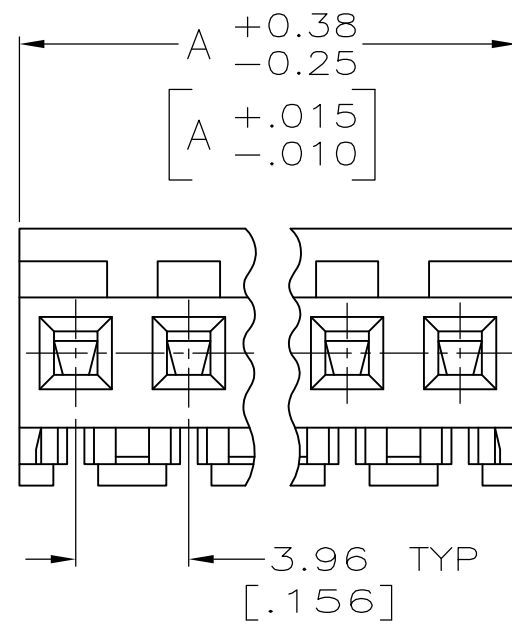
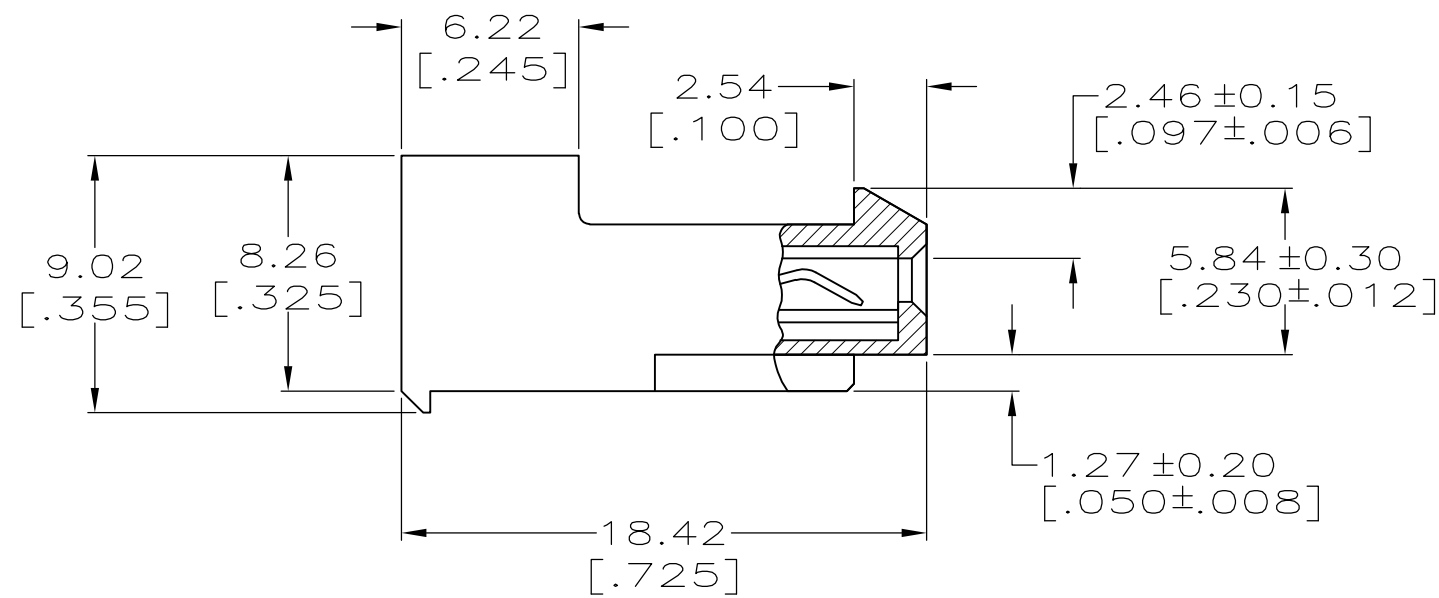
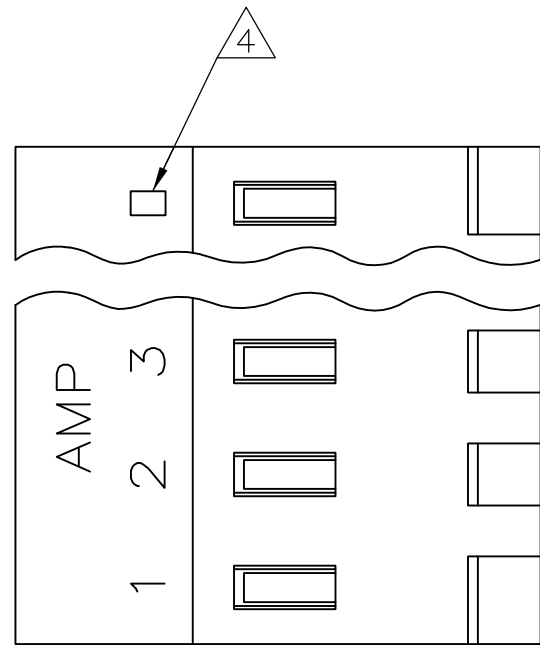

1 MATERIAL: CONNECTOR - NYLON UL94V-2 .
 CONTACTS - 0.00076[.000030] GOLD THK OR 0.00008[.000003] MIN THK
 GOLD FLASH OVER 0.00068[.000027] THK PALLADIUM NICKEL,
 PER TE CONNECTIVITY'S DISCRETION, IN CONTACT
 AREA WITH BRIGHT TIN-LEAD FOR -2 THRU -28, MATTE
 WHISKER MITIGATED TIN FOR 3-641217-2 THRU
 5-641217-4 OVER NICKEL UNDERPLATE.

2 CONTACTS ACCEPT 18 AWG WIRE WITH 2.41[.095] MAX INSULATION DIAMETER.

3 CONTACTS MUST ACCEPT 1.14±0.03[.045±.001] SQUARE
 POST AND REMAIN LOCKED IN POSITION.

4 IDENTIFICATION NUMBER FOR LAST CIRCUIT MAY
 NOT APPEAR ON ALL ASSEMBLIES.

5 DIMENSIONS IN BRACKETS ARE IN INCHES.

6 HOUSING FEATURES ARE: CLOSED END WITH LOCKING
 RAMP.

7 OBSOLETE PARTS: OBSOLETE CIS STREAMLINING PER D.RENAUD/D.SINISI

8 ORANGE COLOR STRIPE ON HOUSING (NOT SHOWN) MAY RUN DOWN BETWEEN RIBS

YES	95.10[3.744]	24	5-641217-4
YES	91.13[3.588]	23	5-641217-3
YES	87.17[3.432]	22	5-641217-2
YES	83.21[3.276]	21	5-641217-1
YES	79.25[3.120]	20	5-641217-0
YES	75.29[2.964]	19	4-641217-9
YES	71.32[2.808]	18	4-641217-8
YES	67.36[2.652]	17	4-641217-7
YES	63.40[2.496]	16	4-641217-6
YES	59.44[2.340]	15	4-641217-5
YES	55.47[2.184]	14	4-641217-4
YES	51.51[2.028]	13	4-641217-3
YES	47.55[1.872]	12	4-641217-2
YES	43.59[1.716]	11	4-641217-1
YES	39.62[1.560]	10	4-641217-0
YES	35.66[1.404]	9	3-641217-9
YES	31.70[1.248]	8	3-641217-8
YES	27.74[1.092]	7	3-641217-7
YES	23.77[.936]	6	3-641217-6
YES	19.81[.780]	5	3-641217-5
YES	15.85[.624]	4	3-641217-4
YES	11.89[.468]	3	3-641217-3
YES	7.92[.312]	2	3-641217-2
NO	95.10[3.744]	24	2-641217-4
NO	91.13[3.588]	23	2-641217-3
NO	87.17[3.432]	22	2-641217-2
NO	83.21[3.276]	21	2-641217-1
NO	79.25[3.120]	20	2-641217-0
NO	75.29[2.964]	19	1-641217-9
NO	71.32[2.808]	18	1-641217-8
NO	67.36[2.652]	17	1-641217-7
NO	63.40[2.496]	16	1-641217-6
NO	59.44[2.340]	15	1-641217-5
NO	55.47[2.184]	14	1-641217-4
NO	51.51[2.028]	13	1-641217-3
NO	47.55[1.872]	12	1-641217-2
NO	43.59[1.716]	11	1-641217-1
NO	39.62[1.560]	10	1-641217-0
NO	35.66[1.404]	9	641217-9
NO	31.70[1.248]	8	641217-8
NO	27.74[1.092]	7	641217-7
NO	23.77[.936]	6	641217-6
NO	19.81[.780]	5	641217-5
NO	15.85[.624]	4	641217-4
NO	11.89[.468]	3	641217-3
NO	7.92[.312]	2	641217-2
LEADFREE	DIM A	NO. OF CIRCUITS	PART NO.

7	SUPERCEDED BY 5-641217-4	NO	95.10[3.744]	24	2-641217-4
7	SUPERCEDED BY 5-641217-3	NO	91.13[3.588]	23	2-641217-3
7	SUPERCEDED BY 5-641217-2	NO	87.17[3.432]	22	2-641217-2
7	SUPERCEDED BY 5-641217-1	NO	83.21[3.276]	21	2-641217-1
7	SUPERCEDED BY 5-641217-0	NO	79.25[3.120]	20	2-641217-0
7	SUPERCEDED BY 4-641217-9	NO	75.29[2.964]	19	1-641217-9
7	SUPERCEDED BY 4-641217-8	NO	71.32[2.808]	18	1-641217-8
7	SUPERCEDED BY 4-641217-7	NO	67.36[2.652]	17	1-641217-7
7	SUPERCEDED BY 4-641217-6	NO	63.40[2.496]	16	1-641217-6
7	SUPERCEDED BY 4-641217-5	NO	59.44[2.340]	15	1-641217-5

THIS DRAWING IS A CONTROLLED DOCUMENT.

DWN K. WHITAKER 15MAR2004
 CHK D. BOSSI 15-MAR-04
 APVD D. BOSSI 15-MAR-04

TE Connectivity

NAME MTA-156 CONNECTOR ASSEMBLY, 18 AWG STANDARD

PRODUCT SPEC 108-1051
 APPLICATION SPEC 114-1020

SIZE A2 CAGE CODE 00779 DRAWING NO C-641217 RESTRICTED TO -

SCALE 1:1 SHEET 1 OF 1 REV U

MATERIAL 1 FINISH 1

CUSTOMER DRAWING

METRIC