



Chipsmall Limited consists of a professional team with an average of over 10 year of expertise in the distribution of electronic components. Based in Hongkong, we have already established firm and mutual-benefit business relationships with customers from,Europe,America and south Asia,supplying obsolete and hard-to-find components to meet their specific needs.

With the principle of “Quality Parts,Customers Priority,Honest Operation,and Considerate Service”,our business mainly focus on the distribution of electronic components. Line cards we deal with include Microchip,ALPS,ROHM,Xilinx,Pulse,ON,Everlight and Freescale. Main products comprise IC,Modules,Potentiometer,IC Socket,Relay,Connector.Our parts cover such applications as commercial,industrial, and automotives areas.

We are looking forward to setting up business relationship with you and hope to provide you with the best service and solution. Let us make a better world for our industry!



Contact us

Tel: +86-755-8981 8866 Fax: +86-755-8427 6832

Email & Skype: info@chipsmall.com Web: www.chipsmall.com

Address: A1208, Overseas Decoration Building, #122 Zhenhua RD., Futian, Shenzhen, China



LOC	DIST	REVISIONS			
CM	00	REV	DATE	BY	APPV
G		REVISED PER ECO-12-007492	03AUG12	KH	SM

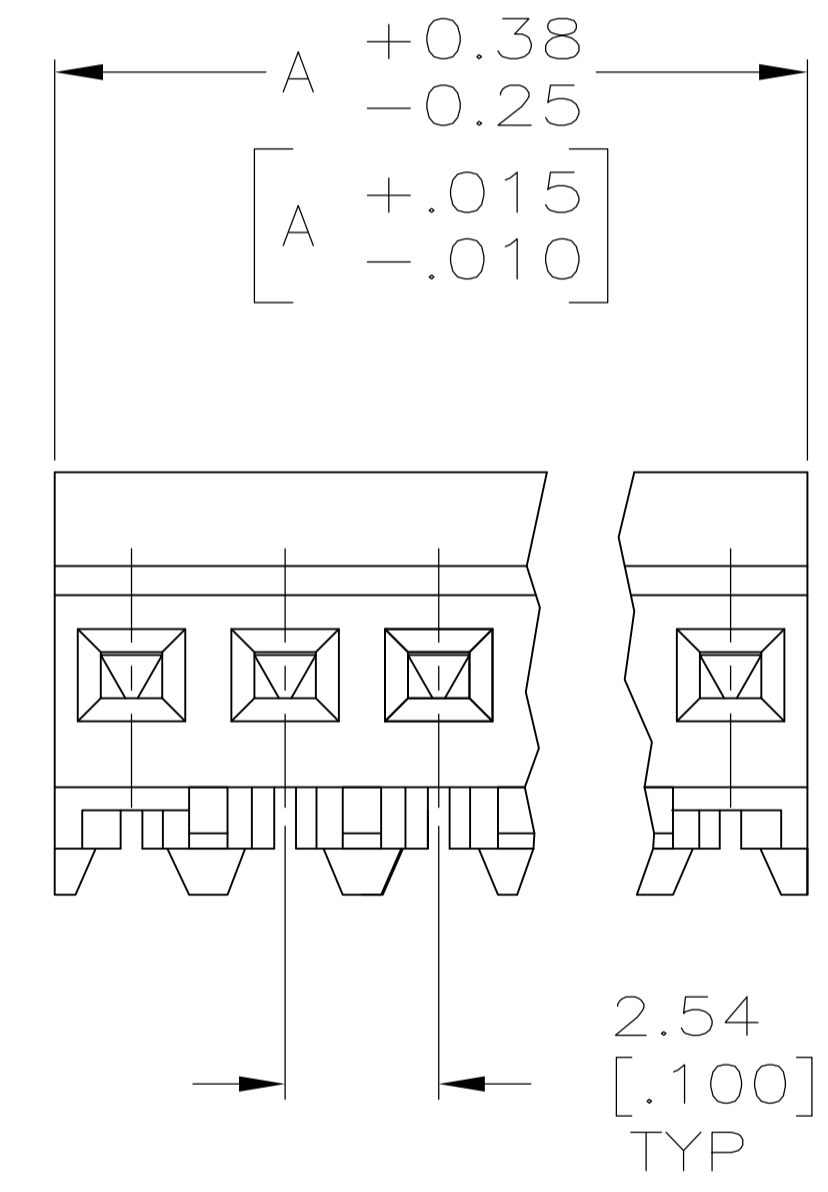
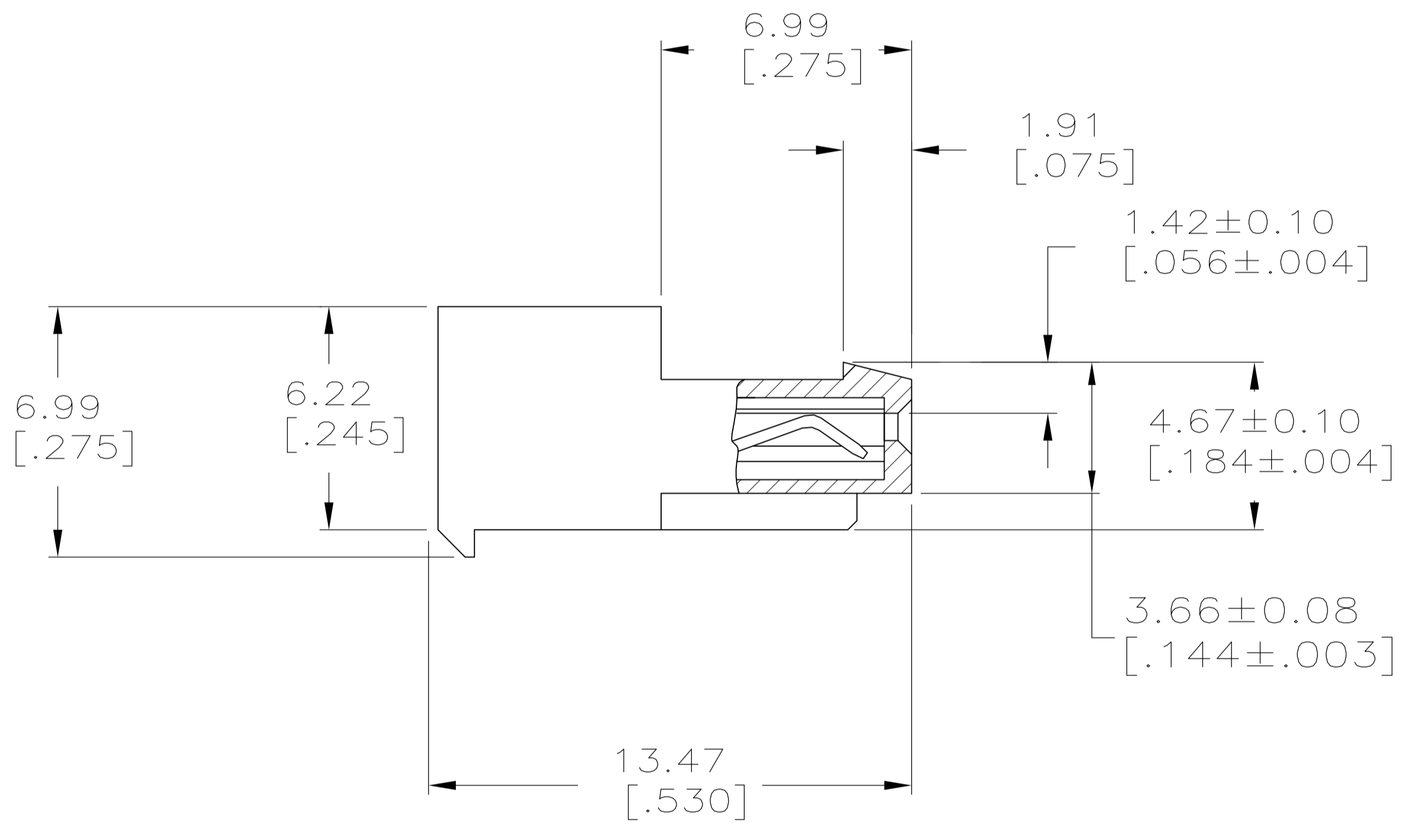
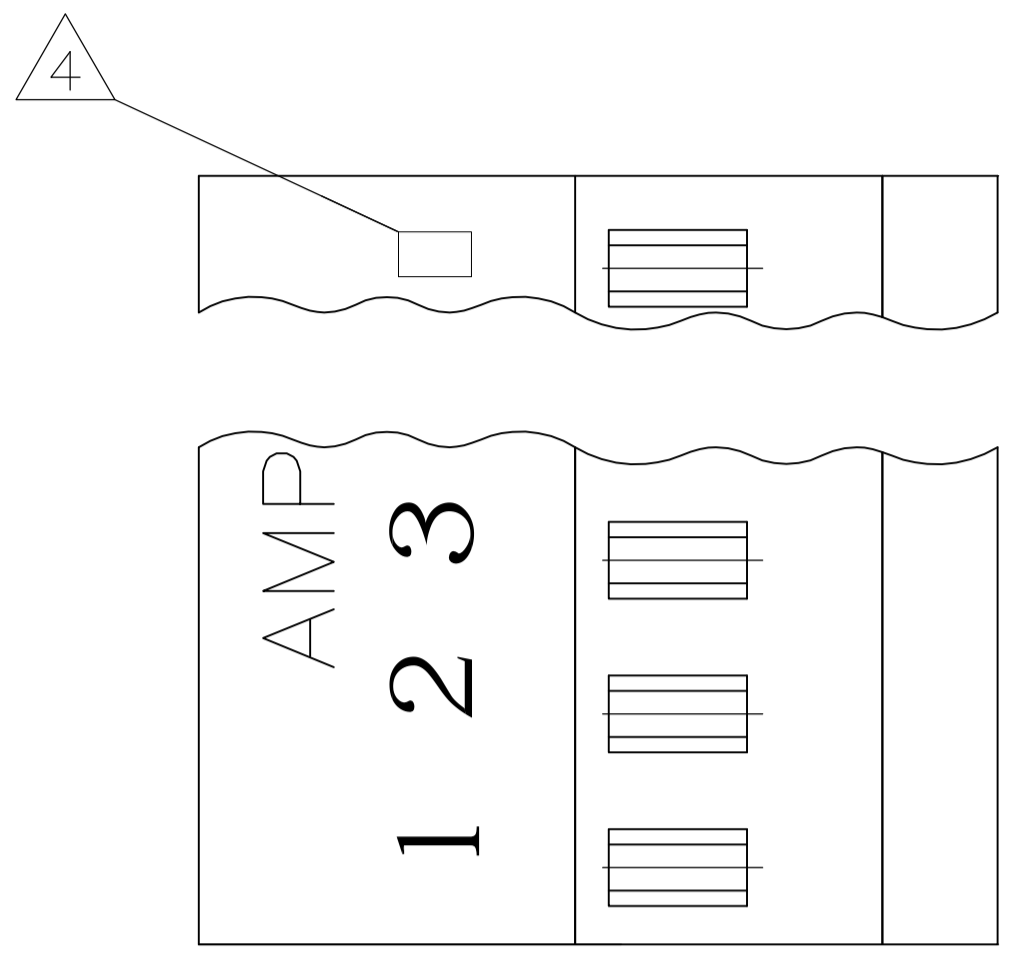

- 1 MATERIAL: CONNECTOR-NYLON UL94V-2.
CONTACTS-0.30 [.012] THICK COPPER ALLOY
BRIGHT TIN-LEAD 0.00203 [.000080] MINIMUM THICK FOR CONTACTS 641534-2 THRU 641534-8,
MATTE WHISKER MITIGATED TIN PLATE 0.00203 [.000080] MINIMUM THICK OVER NICKEL UNDERPLATE FOR CONTACTS 3-641534-2 THRU 3-641534-8.
- 2 CONTACTS ACCEPT 22 AWG WIRE WITH 1.52 [.060] MAXIMUM INSULATION DIAMETER.
- 3 CONTACTS MUST ACCEPT 0.36-0.51 [.014-.020] SQUARE OR ROUND POST AND REMAINED LOCKED IN POSITION.
- 4 IDENTIFICATION NUMBER FOR LAST CIRCUIT MAY NOT APPEAR ON ALL ASSEMBLIES.
- 5 DIMENSIONS IN BRACKETS ARE IN INCHES.
- 6 HOUSING FEATURES ARE: CLOSED END WITH LOCKING RAMP & LED CONTACT.
- 7 OBSOLETE PARTS: OBSOLETE CIS STREAMLINING PER D.RENAUD/D.SINISI
- 8 RED COLOR STRIPE ON HOUSING (NOT SHOWN) MAY RUN DOWN BETWEEN RIBS.

LEAD FREE	DIM A	NO.OF POSN	ASSEMBLY
20.32 [.800]	8	3-641534-8	
10.16 [.400]	4	3-641534-4	
7.62 [.300]	3	3-641534-3	
5.08 [.200]	2	3-641534-2	

CONTAINS LEAD	DIM A	NO.OF POSN	ASSEMBLY
20.32 [.800]	8	641534-8	
10.16 [.400]	4	641534-4	
7.62 [.300]	3	641534-3	
5.08 [.200]	2	641534-2	

7 SUPERSEDED

METRIC

THIS DRAWING IS A CONTROLLED DOCUMENT.

DIMENSIONS: mm [INCHES]	TOLERANCES UNLESS OTHERWISE SPECIFIED:	DIN S. HOOVER 10-DEC-2004	TE Connectivity
0. PLC ±	±	CHK: D. ROSSI 10-DEC-2004	NAME: MTA-100 CONNECTOR ASSEMBLY, 22 AWG, FOR .014 TO .020 POST, SPECIAL
1. PLC ±	±	APPV: D. ROSSI 10-DEC-2004	PRODUCT SPEC: 108-1050
2. PLC ±	± 0.13 [.005]	APPLICATION SPEC: 114-1019	SIZE: A1
3. PLC ±	±	WEIGHT: 00779	CAGE CODE: 641534
4. PLC ±	±	CUSTOMER DRAWING	SCALE: 8:1
ANGLES ±	±		SHEET: 1 OF 1
FINISH ±	±		REV: G