



Chipsmall Limited consists of a professional team with an average of over 10 year of expertise in the distribution of electronic components. Based in Hongkong, we have already established firm and mutual-benefit business relationships with customers from,Europe,America and south Asia,supplying obsolete and hard-to-find components to meet their specific needs.

With the principle of "Quality Parts,Customers Priority,Honest Operation,and Considerate Service",our business mainly focus on the distribution of electronic components. Line cards we deal with include Microchip,ALPS,ROHM,Xilinx,Pulse,ON,Everlight and Freescale. Main products comprise IC,Modules,Potentiometer,IC Socket,Relay,Connector.Our parts cover such applications as commercial,industrial, and automotives areas.

We are looking forward to setting up business relationship with you and hope to provide you with the best service and solution. Let us make a better world for our industry!



Contact us

Tel: +86-755-8981 8866 Fax: +86-755-8427 6832

Email & Skype: info@chipsmall.com Web: www.chipsmall.com

Address: A1208, Overseas Decoration Building, #122 Zhenhua RD., Futian, Shenzhen, China



8

7

6

5

4

3

2

1

VICOR CONFIDENTIAL

THIS DOCUMENT AND THE DATA DISCLOSED HEREIN OR HEREWITH IS NOT TO BE REPRODUCED, USED OR DISCLOSED IN WHOLE OR IN PART TO ANYONE WITHOUT THE PERMISSION OF VICOR CORP.

REVISIONS

REV	DESCRIPTION	DATE	APPROVED
1	RELEASED PER E060496	2/15/06	LEK MB
2	REVISED PER E060064	12/6/06	GCK MB
3	REVISED PER E080938	5/6/08	SA REJH
4	REVISED PER E101309	10/22/10	KUK AR

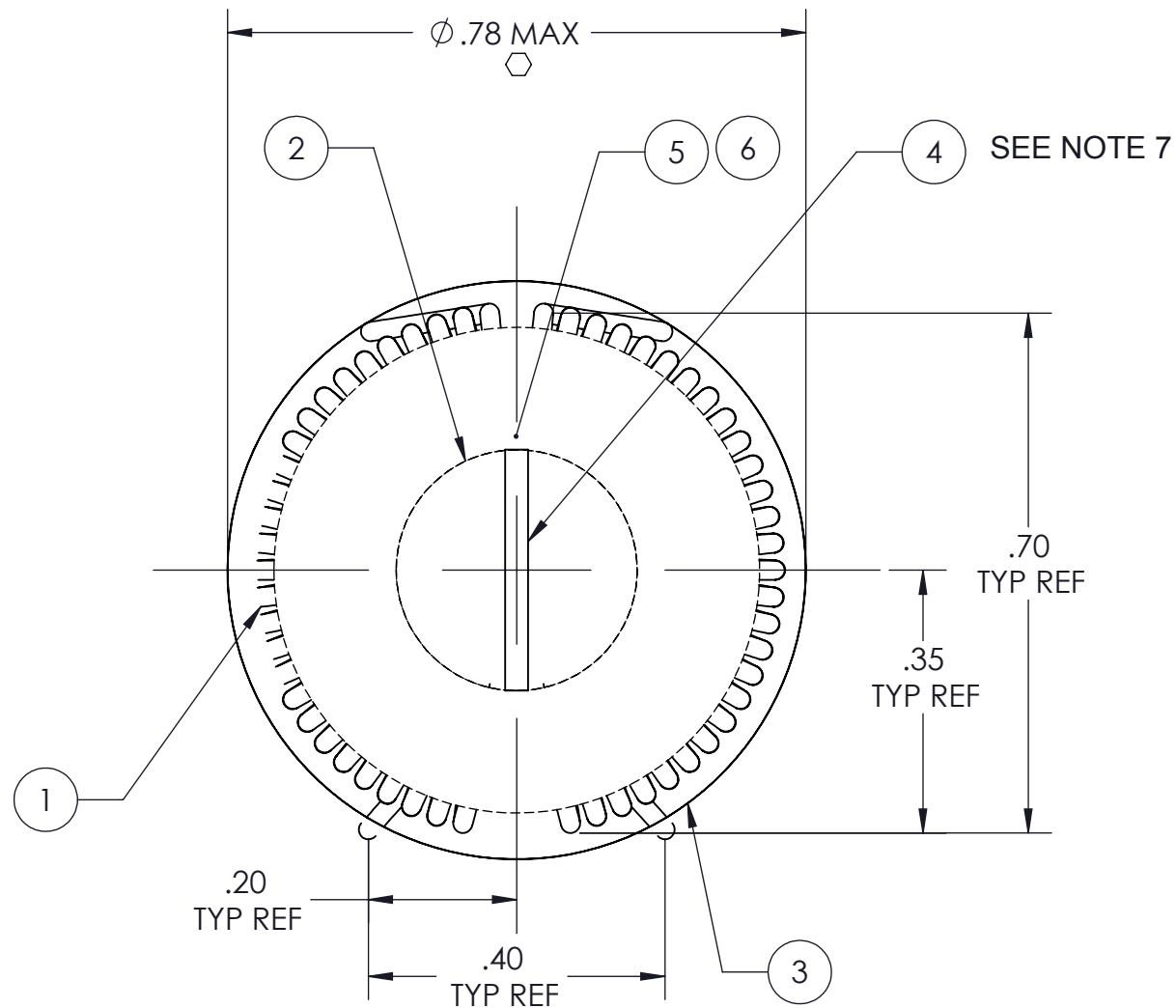

SEE NOTE 8

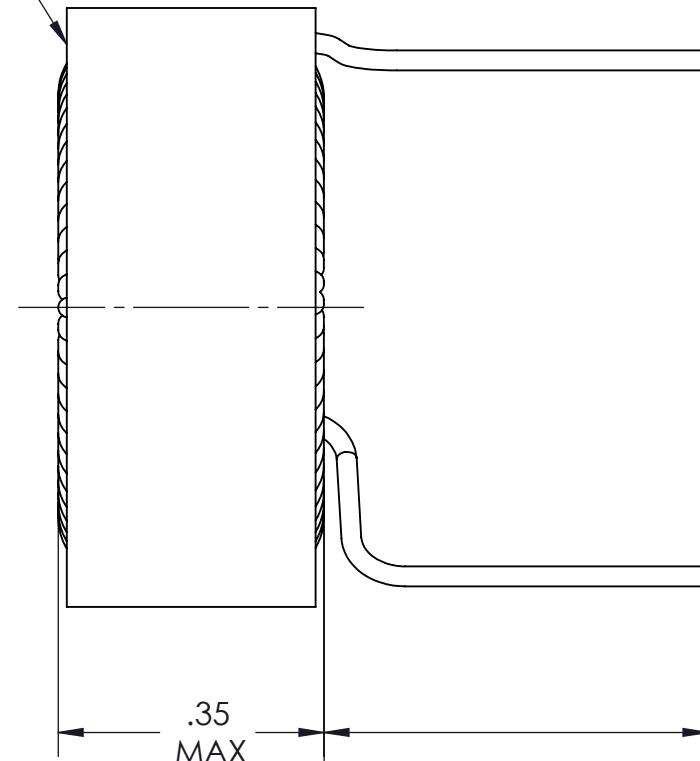

SEATING PLANE

REF P/N 31943
REF P/N 33884

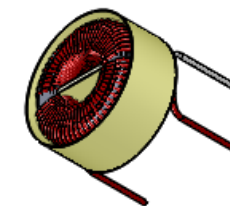

NOTES:

1. ASSEMBLY TO BE FREE OF NICKS.
2. WINDINGS TO BE EVENLY SPACED.
3. RoHS COMPLIANT. LEAD FREE PER CST-0001LATEST REVISION.
4. GENERAL WORKMANSHIP STANDARDS FOR MAGNETIC COMPONENTS PER WS-0002.
5. OVERWINDS PERMISSIBLE
6. LEADS CONFORMABLE TO LEAD DIMENSION
7. BOND SPACER (ITEM 4) TO CORE (ITEM 1) USING ADHESIVE (ITEMS 5 & 6) OR EQUIVALENT-ONE END ONLY-AS SHOWN.
8. WIND FINISHED ASSY WITH TWO WRAPS OF TAPE (ITEM 7).
9. \square DENOTES CRITICAL CHARACTERISTIC FOR LOT INSPECTION.

DRAWN	DATE
KNIGHT	2/15/06



MATERIAL	UNLESS OTHERWISE SPECIFIED DIMENSIONS ARE INCH [MM] TOLERANCES ARE: DECIMALS ANGLES X.XX [X.X] = ±0.01 [0.25] ±1° X.XXX [X.XX] = ±0.005 [0.127]
SEE NOTES	
FINISH	THIRD ANGLE PROJECTION
SEE NOTES	
DO NOT SCALE DRAWING	

IND TOROID .78 DIA 2W ASSY DWG			
SIZE	CAGE CODE	DWG NO	REV
B	67131	31947	4
SCALE 4 : 1		SHEET 1 OF 1	

8

7

6

5

4

3

2

1