



Chipsmall Limited consists of a professional team with an average of over 10 year of expertise in the distribution of electronic components. Based in Hongkong, we have already established firm and mutual-benefit business relationships with customers from,Europe,America and south Asia,supplying obsolete and hard-to-find components to meet their specific needs.

With the principle of “Quality Parts,Customers Priority,Honest Operation,and Considerate Service”,our business mainly focus on the distribution of electronic components. Line cards we deal with include Microchip,ALPS,ROHM,Xilinx,Pulse,ON,Everlight and Freescale. Main products comprise IC,Modules,Potentiometer,IC Socket,Relay,Connector.Our parts cover such applications as commercial,industrial, and automotives areas.

We are looking forward to setting up business relationship with you and hope to provide you with the best service and solution. Let us make a better world for our industry!



Contact us

Tel: +86-755-8981 8866 Fax: +86-755-8427 6832

Email & Skype: info@chipsmall.com Web: www.chipsmall.com

Address: A1208, Overseas Decoration Building, #122 Zhenhua RD., Futian, Shenzhen, China





A Tallysman Accutenna® TW2920 Wideband GPS/GLONASS/BeiDou/Galileo + L-Band Antenna

The TW2920 is an Accutenna technology antenna that covers GPS L1, GLONASS G1, BeiDou B1, Galileo E1, SBAS (WAAS, EGNOS, GAGAN, & MSAS) and the down-link L-Band (1525 – 1559MHz). The TW2920 provides superior multi-path signal rejection, a linear phase response, and tight Phase Centre Variation (PCV). This antenna is ideal for precision agriculture, autonomous vehicle tracking and guidance, and other applications where precision matters.

The TW2920 features a dual-feed wideband patch element, plus a low-loss pre-filter followed by a three stage Low Noise Amplifier (LNA) including an additional mid-section SAW. This configuration provides excellent axial ratio across the full frequency band and strong protection against high level sub-harmonic signals like LTE and near frequency signals such as WiFi.

The TW2920 has a compact, robust, magnetic mount housing with a metal base and a UV resistant, tough wide temperature range plastic radome, and is available with a variety of connectors. The housing includes a screw down option, and is available with an adhesive attachment, without a magnet,

The TW2920 is also available with an “armoured” cable option, with the cable encased in tough corrugated conduit having a temperature range of -40 to +120C, excellent chemical resistance, stable bending, high cold impact strength, and UL94HB flammability standard compliant.

Applications

- High Accuracy & Mission Critical GNSS
- Precision Agriculture, Mining & Construction
- Military & Security

Features

- Low loss Great axial ratio: 1 typ., 3 dB max
- Low noise LNA: ≤2.5 dB (including pre-filter)
- High rejection SAW filter
- Wide voltage input range: 2.5 to 16 VDC
- IP67 weather proof housing
- Economical price



Dimensions (mm)

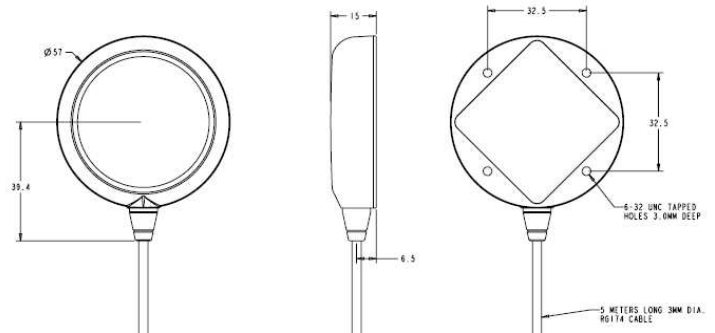

Dimensions (mm)

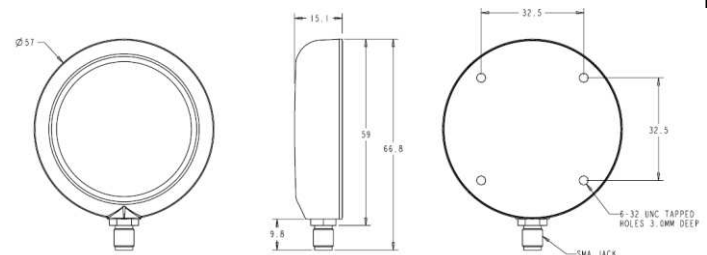

Benefits

- Excellent multipath rejection
- Increased system accuracy
- Excellent signal to noise ratio
- Great out of band signal rejection
- Ideal for harsh environments
- RoHS and REACH compliant



TW2920 Pre-filtered GPS/GLONASS/BeiDou/Galileo + L-Band Antenna Specifications $V_{cc} = 3V$, over full bandwidth, $T=25^{\circ}C$

Antenna

Architecture	Dual Feed Patch, Quadrature Feeds
1 dB Bandwidth	85 MHz
Antenna Zenith Gain (with 100mm ground plane)	4.25 dBic
Axial Ratio over Bandwidth @zenith	1 dB typ,

Electrical

Architecture	Pre-filter ->LNA ->SAW filter-> 2 stage LNA
Filtered LNA Frequency Bandwidth	1510 to 1610 MHz
Polarization	RHCP
LNA Gain	32 dB min., 1510 to 1610 MHz
Gain flatness	+/- 2 dB, 1510 to 1610 MHz
Out-of-Band Rejection <1465 MHz	>30 dB
>1700 MHz	>55 dB
VSWR (at LNA output)	<1.5:1 typ. 1.8:1 max.
Noise Figure	≤ 2.5 dB typ.
Supply Voltage Range (over coaxial cable)	+2.5 to 16 VDC nominal (12VDC recommended maximum)
Supply Current	18 mA typ, 25mA Q max (85°C).
ESD Circuit Protection	15 KV air discharge

Mechanicals & Environmental

Mechanical Size	57 mm dia. x 15 mm H
Cable	RG174
Operating Temp. Range	-40 to +85 °C
Enclosure	Radome: EXL9330, Base: Zamak white metal
Weight	100 g (+13g /m of cable)
Attachment Method	Magnet or permanent (pre-tapped 4 x 6-32 UNC)
Environmental	IP67, REACH, RED, and RoHS compliant
Shock	Vertical axis: 50 G, other axes: 30 G
Vibration	3 axis, sweep = 15 min, 10 to 200 Hz sweep: 3 G

Ordering Information

TW2920 – Pre-filtered Single Band GNSS antenna: 33-2920-xx-yyy

Where xx = connector type and yyyy = cable length in mm

Please refer to the Ordering Guide (<http://www.tallysman.com/wp-content/uploads/Current-Ordering-Guide.pdf>) for the current and complete list of available connectors.



36 Steacie Drive, Ottawa ON K2K 2A9 Canada

Tel 613 591 3131

Fax 613 591 3121

sales@tallysman.com

The information provided herein is intended as a guide only and is subject to change without notice. This document is not to be regarded as a guarantee of performance. Tallysman Wireless Inc. hereby disclaims any or all warranties and liabilities of any kind. © 2015 Tallysman Wireless Inc. All rights reserved.

Rev 1.2